

Loudon County Solid Waste Disposal Commission  
Voting Meeting  
June 15<sup>th</sup>, 2023  
6:00PM  
Loudon County Annex

- Public Comments
- Approval of May 18<sup>th</sup> Minutes
- Approval of Expenses – continual approval of stipend
- Workshops & Committee Meetings
- Financials
- Part time administrative assistant
- Drop Box Status
- Budget 2023-24
- Audit Verbiage Approval
- Client records from previous attorney
- Poplar Springs Update
  
- Regional Solid Waste Authority
- Part 1
- Operations
- Host & Security Fees Letter
- Airspace Utilization Report
- Annual PI Letter
- TDEC Inspection Reports
  
- Payment Options at Landfill
- Operating Contract – 5.1
- Attorney/Technical Advisor Updates
  
- Action Items
  
- Adjourn

**MINUTES**  
**LOUDON COUNTY SOLID WASTE DISPOSAL COMMISSION**  
**May 18, 2023**

The Loudon County Solid Waste Disposal Commission met on May 18th, 2023, at 6 p.m. at the Loudon County Annex Building. The commission was represented by Chairman Adam Waller, Mr. Henry Cullen, Mr. David Hall, and Ms. Pat Hunter. Along with the commissions appointed attorney Ms. Elizabeth Murphy. Other attendees included Republic services representees Mr. David Hollinshead, Ms. Teresa Fox, and Ms. Taylor Bobich.

Chairman Waller called the meeting to order at 6:00 p.m.

Chairman Waller opened the floor for items of public concern, the following spoke:

Richard Anklin Of Tellico Village- Regarding the C2 and C4 Cells being closed at Matlock Bend Landfill.

Attorneys Report: Regarding concerns on the Jackson Law and phase 1 update.

**MOTION:** Chairman Waller asked for a regarding commission pay to be lowered to \$75.00. Mr. Henry Cullen made a motion to approve, and Mr. David Hall seconded the motion.

**MOTION:** Chairman Mr. Waller asked for approval for reimbursements, office supplies, stipends, legal and misc. Ms. Pat Hunter made a motion to approve, and Mr. David Hall seconded the motion.

Ms. Bobich presented the cash activity report for the month of February. Ms. Bobich also presented the commission with the operations report as outlined in the packets distributed to the commission.

**MOTION:** Chairman Mr. Waller made a motion to adjourn Mr. Henry Cullen makes a motion to approve and Mr. David Hall seconded. Motion passed unanimously.

The next Loudon County Solid Waste Disposal Commission meeting will be May 18, 2023 @ 6:00pm at Loudon County Annex building.

Respectfully Submitted,

Adam Waller  
Loudon County Solid Waste Disposal Commission

## DRAFT - FOR DISCUSSION ONLY

The statement of revenue, expenses and change in net position presents LCSWDC's results of operations. The table below is a condensed statement of revenue and expenses:

### Condensed statements of revenue, expenses and change in net position

	<u>2022</u>	<u>2021</u>	<u>2020</u>	<u>2019</u>
Operating revenue	\$ 363,076	\$ 292,853	\$ 323,880	\$ 313,134
Operating expenses	(6,009,661)	(271,807)	(395,425)	(692,454)
Depreciation and amortization	<u>(2,367)</u>	<u>(2,367)</u>	<u>(2,367)</u>	<u>(2,367)</u>
Net operating income(loss)	(5,648,952)	18,679	(73,912)	(381,687)
Non-operating income	<u>15,391</u>	<u>51,848</u>	<u>99,297</u>	<u>182,134</u>
Change in net position	<u>\$ (5,633,561)</u>	<u>\$ 70,527</u>	<u>\$ 25,385</u>	<u>\$ (199,553)</u>

### Results of Operations

LCSWDC shows operating revenue of \$363,076, which represents an increase of \$70,223 from the previous year's operating revenue. At the same time, LCSWDC shows an increase in operating expenses of \$5,737,854 over the previous year's operating expenses. LCSWDC shows a positive change in net position due to lower costs related to Poplar Springs Landfill. The increased utilization of the landfill during the year resulted in a \$221,662 increase to the estimated future liability for closure and post closure costs. This increase to the estimated future liability for closure and post closure costs decreased by \$113,100 from the previous year's increase in estimated costs. As of June 30, 2022, LCSWDC completed its fourteenth full year of operations under its 20-year operations contract that commenced on October 1, 2007 and provides for the turn-key operation of Matlock Bend Landfill by the operator instead of LCSWDC.

The statement of cash flows in the accompanying financial statements is presented using the direct method. This method outlines the sources and uses of cash as it relates to operating income.

# DRAFT - FOR DISCUSSION ONLY

## Capital Assets

Capital asset levels stayed the same from the prior year. LCSWDC did not purchase capital assets during the year ended June 30, 2022.

## Future Events

LCSWDC has engaged in extensive negotiations with the Matlock Bend landfill operator to modify the current operating contract. Over the previous year, LCSWDC and the landfill operator have exchanged multiple drafts of a proposed contract modification. The proposed modifications address the anticipated shortfall of funds for covering the estimated future liability for closure and post-closure costs. Under the current contract, the operator is obligated to perform closure- and post-closure care of all cells in the Matlock Bend landfill which attain final elevation during the contract term. Under the present contract modification proposal, the operator has agreed to perform all closure- and post-closure care for the expanded landfill footprint under a phased closure plan implemented in conjunction with the contract modification. In addition to assuming additional closure and post-closure care obligations, the operator has agreed to provide LCSWDC with a performance bond to satisfy regulatory financial assurance requirements in lieu of Loudon County's annual pledge of its assets. We anticipate that the operator will ultimately perform all closure and post-closure care of the landfill during the extended contract term: this change will substantially reduce LCSWDC's long-term liability. The operator is presently in the process of being acquired by another entity, pending government approval. LCSWDC will further evaluate the proposed contract modification if and when this acquisition is completed. In the interim, the operator is submitting a phased closure plan for the landfill to the Tennessee Department of Environment and Conservation for approval. When implemented, the operator's phased closure plan should have some bearing on LCSWDC's estimated future liability for closure and post-closure costs.

## Request for Information

Questions concerning this report or other requests for additional information should be directed to Pat Hunter, Chairman at her office located at 100 River Road, #106, Loudon, Tennessee 37774.

Respectfully submitted,

Kelly Littleton-Brewster,  
Chairman

**DRAFT - FOR DISCUSSION ONLY**  
**LOUDON COUNTY SOLID WASTE DISPOSAL COMMISSION**

**NOTES TO THE FINANCIAL STATEMENTS**

(continued)

June 30, 2022

The liabilities were estimated based on information provided by the State of Tennessee Department of Environment and Conservation when the corresponding cells of the Landfill were initially permitted. Closure and postclosure costs related to Phase I were recognized by the Commission in prior periods based on Landfill capacity as of the date of each statement of net position. The liability for Phase II/IV represents the estimated cumulative amount of closure and postclosure care costs reported to date based on the use of 97.0% of the estimated capacity of the Landfill for that phase. The Commission will recognize the remaining estimated cost of \$392,247 as the remaining permitted capacity of the Landfill is filled. These amounts are based on what it would cost to perform all closure and postclosure care in 2022. The Commission expects to close Phase II/IV of the Landfill in August of 2030 (assuming 80,000 tons of waste per year). The Commission is seeking a permit modification which would extend the life of the landfill and result in a new phase. Actual costs of closure and postclosure may vary based on inflation, deflation, technology, or applicable laws and regulations.

Loudon County, Tennessee (the County) has entered into a Contracts in Lieu of Performance Bond with the State of Tennessee Department of Environment and Conservation for Phase I (dated February 24, 1994) and for Phase II/IV (dated September 1, 1997), which are amended from time to time. In the event the County fails to perform closure and postclosure care requirements pursuant to all applicable laws, statutes, rules and regulations as such laws, rules, statutes and regulations may be amended, the contracts pledge future revenues of the County, disbursed from the State of Tennessee to the County, up to the amount of \$13,380,389 (covering all phases of the Landfill) as of June 30, 2022, for closure and postclosure care.

**NOTE H – SUBSEQUENT EVENT**

In July 2022, the Commission and Republic modified their contract to extend the term of the contract to December 31, 2027 with automatic extensions up to December 31, 2038. In addition, the amended contract requires.....



Monthly Operations Report  
Matlock Bend Landfill  
June 15, 2023

Presented by:  
Republic Services, Inc.

- I. TDEC Solid Waste Part I Application
- II. OPERATIONS
  - A. Tonnage Report
  - B. Customer Activity Report
  - C. Materials Classification Report
  - D. Waste Characterization Report
  - E. Tire Report
- III. Host & Security Fees Letter
- IV. Airspace Utilization Report
- V. Annual PI Letter
- VI. TDEC Inspection - May 2023





STATE OF TENNESSEE  
 DEPARTMENT OF ENVIRONMENT AND CONSERVATION  
 DIVISION OF SOLID WASTE MANAGEMENT  
 WILLIAM R. SNODGRASS TENNESSEE TOWER  
 312 ROSA L. PARKS AVENUE, 14TH FLOOR  
 NASHVILLE, TN 37243  
**SOLID WASTE PART I APPLICATION**

1. TYPE OF FACILITY		2. TYPE(S) OF WASTE HANDLED		3. AMT HANDLED	TDEC USE ONLY	
<input checked="" type="checkbox"/> CLASS I	SITE ACREAGE	<input checked="" type="checkbox"/> MUNICIPAL	<input checked="" type="checkbox"/> DEMOLITION	500.00		
<input type="checkbox"/> CLASS II	152.40	<input checked="" type="checkbox"/> INDUSTRIAL	<input type="checkbox"/> MEDICAL	WEIGHT, TONS / DAY		
<input type="checkbox"/> CLASS III		<input checked="" type="checkbox"/> COMMERCIAL	<input checked="" type="checkbox"/> YARD WASTE	700.00		
<input type="checkbox"/> COMPOST		<input checked="" type="checkbox"/> OTHER Special waste with TDEC (SPECIFY: approval)		VOLUME, Cu YDS / DAY		
					FACILITY LOCATION COUNTY Loudon	
					LATITUDE (DECIMAL DEGREES) 36.748033	
					LONGITUDE (DECIMAL DEGREES) 84.411731	
<b>4. FACILITY INFORMATION</b>						
FULL LEGAL NAME OF FACILITY Loudon County Landfill aka Matlock Bend Landfill						
PHYSICAL LOCATION ADDRESS (GIVE DIRECTIONS IF NECESSARY) 21712 Highway 72 North				CITY Loudon	STATE TN	ZIP 37774
FACILITY MAILING ADDRESS 21712 Highway 72 North				CITY Loudon	STATE TN	ZIP 37774
<b>5. CONTACT PERSONS</b>						
FACILITY MANAGER OR SITE OPERATOR Michael Classen			(AREA CODE)+PHONE (678) 435-7218	EMAIL mclassen@republicservices.com		
RESPONSIBLE OFFICIAL Adam Waller, Chair			(AREA CODE)+PHONE (865) 458-1784	EMAIL lcswdc@loudoncounty-tn.gov		
RESPONSIBLE OFFICIAL MAILING ADDRESS 100 River Road #106				CITY Loudon	STATE TN	ZIP 37774
LANDOWNER NAME Loudon County Solid Waste Disposal Commission			(AREA CODE)+PHONE (865) 458-1784	EMAIL lcswdc@loudoncounty-tn.gov		
LANDOWNER MAILING ADDRESS 100 River Road #106				CITY Loudon	STATE TN	ZIP 37774
<div style="display: flex; justify-content: space-between; margin-top: 10px;"> <div style="width: 25%; border-bottom: 1px solid black; margin-bottom: 5px;"></div> <div style="width: 25%; border-bottom: 1px solid black; margin-bottom: 5px;"></div> <div style="width: 25%; border-bottom: 1px solid black; margin-bottom: 5px;"></div> <div style="width: 25%; border-bottom: 1px solid black; margin-bottom: 5px;"></div> </div>						
<b>6. ZONING AUTHORITY AND LOCAL APPROVAL</b>						
ZONING AUTHORITY NAME Loudon County Planning and Codes Department		ZONING STATUS A-1	(AREA CODE)+PHONE (865) 458-2055	EMAIL jenkins@loudoncounty-tn.gov		
ZONING AUTHORITY MAILING ADDRESS 101 Mulberry Street, Suite 101				CITY Loudon	STATE TN	ZIP 37774
<b>FOR ALL CLASS I &amp; CLASS III FACILITIES:</b>						
DATE APPLICATION SENT TO MUNICIPAL SOLID WASTE PLANNING BOARD (IF APPLICABLE) → _____				IS THIS FACILITY SUBJECT TO "THE JACKSON LAW"? <input type="checkbox"/> YES <input checked="" type="checkbox"/> NO		
<b>7. CERTIFICATION REQUIRED</b>						
I certify under penalty of law that this document and all attachments were prepared by me, or under my direction or supervision. The submitted information is to the best of my knowledge and belief, true, accurate, and complete. I am aware that there are significant penalties for submitting false information, including the possibility of fine and imprisonment. As specified in Tennessee Code Annotated Section 39-16-702(a)(4), this declaration is made under penalty of perjury.						
			Adam Waller			
			PRINTED NAME			
			DATE SIGNED			
			DATE COMMISSION EXPIRES			
			SIGNATURE OF RESPONSIBLE OFFICIAL			
			Chair, Loudon County Solid Waste Disposal Commission			
			TITLE			
			SIGNATURE OF NOTARY			
			(NOTARY SEAL)			

FD091620

**INSTRUCTIONS FOR SOLID WASTE PART I APPLICATION**

COMPLETE THIS FORM FOR EACH FACILITY THAT IS DISPOSING OR COMPOSTING SOLID WASTE IN TENNESSEE. IF MULTIPLE FACILITIES EXIST OR ARE PLANNED, DESCRIBE EACH FACILITY AND ITS WASTES ON A SEPARATE FORM. SUBMIT COMPLETED DOCUMENT(S) TO THE RESPECTIVE FIELD OFFICE IN YOUR AREA.

<b>1. TYPE OF FACILITY</b> CHECK TYPE OF FACILITY AND PROVIDE SITE ACREAGE AND FILL ACREAGE	
<b>2. TYPE(S) OF WASTE HANDLED</b> CHECK TYPE(S) OF WASTE HANDLED AT THIS FACILITY	
<b>3. AMT HANDLED</b> PROVIDE AN ESTIMATE OF THE DAILY WEIGHT (IN TONS) AND/OR VOLUME (IN CU YARDS/DAY) THAT WILL BE HANDLED AT THE FACILITY.	
<b>4. FACILITY INFORMATION</b> <b>FULL LEGAL NAME OF FACILITY</b> ENTER THE FULL LEGAL NAME FOR THIS SITE TO DISTINGUISH IT FROM ANY OTHER SITE THE APPLICANT OR ORGANIZATION MAY OWN OR OPERATE IN TENNESSEE. <b>PHYSICAL LOCATION</b> INFORMATION (ADDRESS, DIRECTIONS) THAT WILL AID IN FINDING THIS SITE (NO PO BOX NUMBERS!) PROVIDE COUNTY WHERE SITE IS LOCATED. PROVIDE LATITUDE AND LONGITUDE FOR SITE LOCATION IN DECIMAL DEGREES. <b>FACILITY MAILING ADDRESS</b> PROVIDE COMPLETE MAILING ADDRESS FOR THIS SITE	
<b>5. CONTACT PERSONS</b> <b>NAME OF FACILITY OR SITE MANAGER OR SITE OPERATOR</b> NAME AND PHONE NUMBER OF PERSON WHO IS RESPONSIBLE FOR THE DIRECTION OF ACTIVITIES AT THIS SITE <b>RESPONSIBLE OFFICIAL</b> PERSON AUTHORIZED TO COMPLETE THIS APPLICATION AND WHO MAY BE CONTACTED BY TDEC FOR ANY FURTHER INFORMATION. <b>LANDOWNER NAME</b> PERSON(S) OR ORGANIZATION(S) OF THE IMMEDIATE PROPERTY OWNER(S). ATTACH LETTER FROM LANDOWNER(S). <b>LANDOWNER SIGNATURE(S)</b> LANDOWNER(S) MUST SIGN AND DATE APPLICATION	
<b>6. ZONING AUTHORITY AND LOCAL APPROVAL</b> GIVE THE NAME AND PHONE NUMBER OF THE ZONING AUTHORITY PLUS THE CURRENT ZONING STATUS OF THE PROPERTY. PROVIDE THE COMPLETE MAILING ADDRESS OF THE ZONING AUTHORITY. ATTACH A STATEMENT WHETHER THIS FACILITY IS SUBJECT TO LOCAL APPROVAL AS PROVIDED BY TCA 68-211-701 (THE JACKSON LAW) OR PROVIDE JUSTIFICATION IF IT IS NOT. IF SUCH LOCAL APPROVAL IS REQUIRED, DEMONSTRATION OF THAT APPROVAL SHOULD BE ATTACHED. PROVIDE A STATEMENT WHETHER THE FACILITY IS SUBJECT TO A SOLID WASTE REGIONAL APPROVAL AS PROVIDED BY TCA 68-211-814(b)(1)(D). IF THIS APPLICATION IS SUBJECT TO THIS PROVISION, ATTACH STATEMENT THAT THE PART I APPLICATION WAS SENT TO THE BOARD AND THE DATE IT WAS SENT.	
<b>7. CERTIFICATION REQUIRED</b> AFTER ALL DOCUMENTS HAVE BEEN COMPILED FOR SUBMISSION TO THE DIVISION, THE MANAGER OR OWNER RESPONSIBLE FOR THE SITE MUST SIGN THE CERTIFICATION AND GIVE DATE AND TITLE. THIS SIGNATURE MUST BE NOTARIZED.	
<b>TDEC OFFICE USE ONLY</b>	
REVIEWER'S SIGNATURE _____ DATE _____	NOTES



**LOUDON COUNTY LANDFILL aka MATLOCK BEND LANDFILL  
LOCAL APPROVAL STATEMENTS**

**Applicability of Tenn. Code Ann. § 68-211-701 et seq.**

According to Rule 0400-11-01-.02(c)(2)(ii), the Jackson Law does not apply to facilities that existed on June 2, 1989 (the date the Jackson Law went into effect), and it does not apply to an expansion of those facilities. The Loudon County Landfill aka Matlock Bend Landfill (Permit SNL 53-0203) was originally issued a permit by the Tennessee Department of Environment and Conservation Division of Solid Waste Management on April 2, 1985, and therefore the Jackson Law does not apply to the Loudon County Landfill aka Matlock Bend Landfill.

**Approval under Tenn. Code Ann. § 68-211-814(b)**

The Loudon County Solid Waste Disposal Commission serves as the regional planning board for the single-county Loudon County, established under an intergovernmental agreement between the City of Lenoir City, County of Loudon, and the City of Loudon. By its vote to authorize the submittal of this application on its behalf, the Commission has determined that the proposed expansion of the Loudon County Landfill aka Matlock Bend Landfill is not inconsistent with the Loudon County Regional Solid Waste Management Plan.



State of Tennessee  
Department of Environment and Conservation  
Division of Solid Waste Management – Solid Waste Program  
312 Rosa L. Parks Avenue, 14<sup>th</sup> Floor  
Nashville, TN 37243

### APPLICANT DISCLOSURE STATEMENT

**INSTRUCTIONS:** Maintain a copy of your disclosure statement for your records. Submit the disclosure statement and supporting documentation to the address above.

APPLICANT'S COMPLETE NAME Loudon County Solid Waste Disposal Commission  
NAME OF APPLICANT'S BUSINESS Loudon County Landfill aka Matlock Bend Landfill  
STATE OF INCORPORATION (if applicable) n/a  
FEDERAL TAX I.D. NUMBER \_\_\_\_\_  
BUSINESS ADDRESS 21712 Highway 72 North, Loudon TN 37774  
MAILING ADDRESS 100 River Road #106, Loudon, TN 37774

2. Give a brief description of the structure of the business (e. g., partnership, sole proprietorship, corporation, association).  
**A Commission established by an intergovernmental agreement between the City of Lenoir City, the County of Loudon and the City of Loudon**
3. List the names, addresses, and titles of all officers, directors or partners of the applicant, of any parent or subsidiary corporation if the applicant is a corporation, and of any person owning 10% or more interest in the applicant company.  
**See Attachment 1**
4. List the name and address of all facilities in the field of solid or hazardous waste management in which the applicant business or any of its officers, directors, or partners, holds a 10% or greater interest and the name of the officer, director or partner holding such interest.  
**Loudon County Landfill a/k/a Matlock Bend Landfill, SNL 530000203**
5. List the names of all key personnel, including titles and positions held.  
**See Attachment 2**
6. List all permits and licenses relating to solid and/or hazardous waste management presently held by the applicant(s), including facility name, location, permit or license number and name of issuing authority or agency.  
**See Attachment 3**
7. List all permits and licenses relating to solid and/or hazardous waste management presently held by the applicant(s) within the last ten (10) years not listed previously. Include facility name, location, permit or license number and name of issuing authority or agency.  
**See Attachment 3**
8. List the name and address of solid and/or hazardous waste facilities constructed and operated by any parent or subsidiary corporation, if the applicant is a corporation.  
**N/A**
9. List all judicial and/or administrative orders issued for the violations of any state or federal environmental protection law which resulted in a fine or penalty within the five (5) year period immediately preceding the submission date of the applicant's permit application. Include in the description:  
**None**
  - a. the style of the complaint
  - b. the case file number
  - c. the forms in which the complaint was filed
  - d. the identity of each state or federal agency involved with or named in the complaint
  - e. the amount of the fine(s) or penalty(s)
  - f. whether the fine or penalty has been paid
  - g. the identity and description of each law or regulation violated or alleged to have been violated and upon which fine(s) or penalty(s) is/are based
  - h. state whether the fine was the result of a settlement or agreed order, an administrative order or a court judgment
  - i. if litigation is ongoing, describe any orders or judgments entered and describe the current status of litigation

- j. explain all corrective action measures performed to correct or mitigate the violations
10. List and explain all revocations, suspensions or denials of a license, permit, or equivalent authorization, which was issued within the past ten (10) years by any government entity and was issued pursuant to law, rule, or regulation relative to the collection, transportation, treatment, storage, or disposal of solid or hazardous waste. Include the date of the revocation, suspension, or denial and the name of the issuing agency or authority.  
None
11. List and describe all criminal felony convictions entered against the applicant for the violation of any state or federal environmental protection law or regulation within the ten (10) years preceding the submission date of applicant's permit application. Include in the description:  
None
- a. the style of the case
  - b. the case file number
  - c. the forum in which the conviction was entered
  - d. the date of judgment
  - e. the sentence imposed
  - f. the identity and a description of each law applicant was convicted of violating
  - g. whether the conviction was the result of a plea agreement of a trial
  - h. if currently on appeal, the status of the appeal

An individual, by executing this document on behalf of a corporation or other entity, certifies that she or he is duly authorized as defined in Rule 0400-11-01-.02(2)(a)7. and 8., to act on behalf of the corporation or other entity and provide the information contained herein.

I certify under penalty of law that this document and all attachments were prepared by me, or under my direction or supervision in accordance with a system designed to assure that qualified personnel properly gathered and evaluated the information submitted. Based on my inquiry of the person or persons who manage the system, or those persons directly responsible for gathering the information, the information submitted is, to the best of my knowledge and belief, true, and accurate, and complete. I am aware that there are significant penalties for submitting false information, including the possibility of fine and imprisonment. As specified in Tennessee Code Annotated Section 39-16-702(a)(4), this declaration is made under penalty of perjury.

PRINT NAME Adam Waller

TITLE Chair, Loudon County Solid Waste Disposal Commission

SIGNATURE \_\_\_\_\_ DATE \_\_\_\_\_

STATE OF \_\_\_\_\_

COUNTY OF \_\_\_\_\_

Subscribed and sworn to before me by \_\_\_\_\_ this the \_\_\_\_\_ day of \_\_\_\_\_, 20\_\_\_\_, )

\_\_\_\_\_  
NOTARY PUBLIC

My Commission Expires: \_\_\_\_\_

Any person who knowingly makes a false statement under oath or makes a false statement on an official document shall be guilty of a Class A misdemeanor, and upon conviction thereof shall be punished by a fine not to exceed TWO THOUSAND FIVE HUNDRED DOLLARS (\$2,500.00) or by imprisonment of not greater than eleven (11) months twenty-nine days, or by both fine and imprisonment.

**KEY PERSONNEL DISCLOSURE STATEMENT**  
**LOUDON COUNTY SOLID WASTE DISPOSAL COMMISSION**  
**APPLICANT'S NAME**

1. KEY PERSON'S COMPLETE NAME Adam Waller  
STATE OF INCORPORATION (if applicable) N/A  
FACILITY ADDRESS 21712 Highway 72 North, Loudon, TN 37774  
MAILING ADDRESS 100 River Road #106, Loudon, TN 37774

2. Describe the relationship of the person in item 1 to the applicant.  
**Chair of Commission**
3. List all permits or licenses relating to solid and for hazardous waste management presently held by person named in item 1.  
**None**
4. List all permits or licenses related to solid and/or hazardous waste management held by the person listed in item 1 within the last five (5) years not previously listed.  
**None**
5. List all judicial and/or administrative orders issued for the violations of any state or federal environmental protection law which resulted in a fine or penalty, within the five (5) years preceding the submission of this application for violation of any state or federal statute or local ordinance. Include the following information:  
**None**
- a. the style of the complaint
  - b. the case file number
  - c. the identity of all parties named in the complaint
  - d. the forum in which the complaint was filed
  - e. the identity of each state or federal agency involved with or named in the complaint
  - f. the amount of the fine(s) or penalty(s)
  - g. whether the fine or penalty has been paid
  - h. the identity and description of each law or regulation violated or alleged to have been violated and upon which the fine(s) or penalty(s) is/are based
  - i. state whether the fine was the result of a settlement or agreed order, an administrative order or a court judgment
  - j. if litigation is ongoing, describe any orders or judgments entered and describe the current status of litigation
6. Describe all judgments of a criminal conviction of a felony entered against the person named in item 1 for the violation of any state or federal environmental protection law within the ten (10) years preceding the submission of this application. Include the following information:  
**None**
- a. the style of the case
  - b. the case file number
  - c. the forum in which the conviction was entered
  - d. the date of judgment
  - e. the sentence imposed
  - f. the identity and a description of each law applicant was convicted of violating
  - g. whether the conviction was the result of a plea agreement or a trial
  - h. if currently on appeal, the status of the appeal
7. List the name and address of all waste sites, waste facilities and solid waste management facilities in which the person named in item 1 has a financial interest, an equitable interest, or in which the person is an officer, director, or manager, and identify the nature of the person's interest or investment.

Adam Waller is Chair of Loudon County Solid Waste Disposal Commission, owner and permittee of Loudon County Landfill aka Matlock Bend Landfill, located at 21712 Highway 72 North, Loudon, TN

The undersigned hereby affirms or swears under penalty of perjury that the information provided in this statement is complete, true, and accurate.

Adam Waller Chair  
PRINT NAME TITLE

\_\_\_\_\_  
SIGNATURE DATE

STATE OF \_\_\_\_\_

COUNTY OF \_\_\_\_\_

Subscribed and sworn to before me by \_\_\_\_\_ this \_\_\_\_\_ day  
of \_\_\_\_\_, 20\_\_\_\_\_.

\_\_\_\_\_  
NOTARY PUBLIC

My Commission Expires: \_\_\_\_\_

Any person who knowingly makes a false statement on an official document shall be guilty of a Class A misdemeanor and upon conviction thereof shall be punished by a fine not to exceed TWO THOUSAND FIVE HUNDRED DOLLARS (\$2,500.00) or by imprisonment of not greater than ELEVEN (11) MONTHS TWENTY-NINE (29) DAYS or by both fine and imprisonment.

## DISCLOSURE STATEMENT INSTRUCTIONS

1. All applicants for the issuance of a solid waste disposal facility permit and each person listed as key personnel by the applicant must complete the disclosure form.
2. Answer every question completely. If a question does not apply, enter "Not Applicable" or "N/A".
3. If you need additional space to answer a question, insert additional pages immediately following the page on which the question you are answering appears.
4. Please type or print your answer.
5. The following definitions will be used to define terms used in the Disclosure Statement:
  - A. Applicant – means any person seeking a permit for a solid waste disposal facility.
  - B. Application – means the forms and accompanying documents filed in connection with the applicant's request for a permit.
  - C. Business concern – means any corporation, association, firm, partnership, trust, sole proprietorship, or other form of commercial organization.
  - D. Debt liability – means bonds, debentures, notes, mortgages and loans of any kind, secured or unsecured, and other similar debt instruments.
  - E. Disclosure statement – means a statement submitted to the commissioner by the applicant which contains information concerning the past performance of the applicant(s) in waste management fields and persons owning or controlling or owned and controlled by the applicant.
  - F. Employed in a supervisory capacity – refers to any person, including a foreman, having been delegated authority which:
    1. is delegated in the interest of the employer,
    2. involves the exercise of the individual's independent judgment,
    3. is not merely authority to perform a routine or clerical task, and,
    4. is authority to perform or effectively to recommend any one or more of the following actions: hiring, firing, transferring, suspending, laying off, recalling, promotion, discharging, assigning, rewarding, disciplining, directing, or adjusting grievances of employees whose duties or responsibilities involve, in whole or in part, the management of (including but not limited to the evaluation of, identification of, labeling of, and monitoring of the effects of), handling of, disposal of, transportation of, storage of, or treatment of, solid waste, infectious waste or hazardous waste.
  - G. Empowered to make discretionary decisions – refers to any person, including a foreman, who has been delegated authority, which:
    1. is delegated in the interests of the employer,
    2. involves the exercise of that individual's independent judgment,
    3. is not merely authority to perform a routine or clerical task, and
    4. is authority which relates to any one or more of the following aspects of solid, infectious, or hazardous waste operations; the management of (including but not limited to evaluation of, identification of, labeling of, and monitoring of the effects of, handling of, disposal of, transportation of, storage of, or treatment of, solid waste, infectious waste or hazardous waste.
  - H. Equity – means any ownership interest in a business concern, including sole proprietorship, the shares of a partner, and stock in a corporation.

- I. **Facility** – means any site, location, tract of land, installation or building used, or to be used, for incineration, composting, landfilling, or other methods of disposal of solid wastes, for transfer of solid wastes, for the treatment or disposal of infectious wastes, or for the storage, treatment or disposal of hazardous waste, or any combination of these activities.
  - J. **Key personnel** – means any person:
    - 1. employed by the applicant in a supervisory capacity for the subject facility; or
    - 2. empowered to make discretionary decisions for the subject facility;
  - K. **Operator** – means the person responsible for the direct control or overall operation of a facility.
  - L. **Owns or Controls** – means holds or is able to control the purchase or sale of at least five (5) percent of the equity of a publicly traded corporation or twenty-five (25%) percent of the equity of any business concern, either directly or through a holding company or subsidiary.
  - M. **Partner** – means any person or persons who share profits and liability and have management powers of a partnership.
  - N. **Person** – means any person or persons who share profits and liability and have management powers of a partnership.
  - O. **Sole proprietorship** – means a form of business, other than a partnership or corporation, in which one person owns all the assets and is solely liable for all the debts of the business.
  - P. **Subject facility** – means the facility in the State of Tennessee for which the applicant seeks a permit.
6. Each disclosure statement must be supported by an affidavit attesting to the truth and completeness of the information disclosed. Any individual executing the disclosure statement on behalf of a corporation or other entity must certify that he or she is duly authorized to act on the behalf of the corporation or other entity.
7. The Disclosure Statement(s) is incorporated into and becomes a part of the Permit Application. Failure to disclose or misrepresentation of any relevant fact constitutes cause of permit revocation.



**ATTACHMENT 1**  
**Members of Loudon County Solid Waste Disposal Commission**

**Adam Waller, Chair**  
**Dave Hall, Vice Chair**  
**Henry Cullen, Secretary**  
**Bill Satterfield**  
**Larry Rolen**  
**Pat Hunter**

**ATTACHMENT 2**  
**Key Personnel**

**Adam Waller, Chair**  
**Loudon County Solid Waste Disposal Commission**

ATTACHMENT 3

### Permits Held by Applicant

#### Current Permits

Facility Name	Location	Permit Number	Type	Date Issued	Expiration	Issuing Authority or Agency
Matlock Bend Landfill	21712 Highway 72 in Loudon, Loudon County	TNR051889	Industrial NPDES Stormwater	7/19/2020	6/30/2025	TN Department of Environment & Conservation; Division of Water Resources
Matlock Bend Landfill	21712 Highway 72 in Loudon, Loudon County	579043	Title V	8/24/2022	8/23/2027	TN Department of Environment & Conservation; Division of Air Pollution Control
Matlock Bend Landfill	21712 Highway 72 in Loudon, Loudon County	09F	Industrial User Pretreatment	5/1/2021	4/30/2025	Loudon Utilities
Matlock Bend Landfill	21712 Highway 72 in Loudon, Loudon County	SNL 53-103-0203	Solid Waste	8/7/1997	Does not expire	TN Department of Environment & Conservation; Division of Solid Waste Management

#### Historic Permits within the last 10 years

Facility Name	Location	Permit Number	Type	Date Issued	Expiration	Issuing Authority or Agency
Matlock Bend Landfill	21712 Highway 72 in Loudon, Loudon County	TNR051889	Industrial NPDES Stormwater	6/5/2015	4/14/2020	TN Department of Environment & Conservation; Division of Water Resources
Matlock Bend Landfill	21712 Highway 72 in Loudon, Loudon County	569595	Title V	11/14/2016	11/13/2021	TN Department of Environment & Conservation; Division of Air Pollution Control
Matlock Bend Landfill	21712 Highway 72 in Loudon, Loudon County	09C	Industrial User Pretreatment	5/1/2009	4/30/2013	Loudon Utilities
Matlock Bend Landfill	21712 Highway 72 in Loudon, Loudon County	09D	Industrial User Pretreatment	5/1/2013	4/30/2017	Loudon Utilities
Matlock Bend Landfill	21712 Highway 72 in Loudon, Loudon County	09E	Industrial User Pretreatment	5/1/2017	4/30/2021	Loudon Utilities

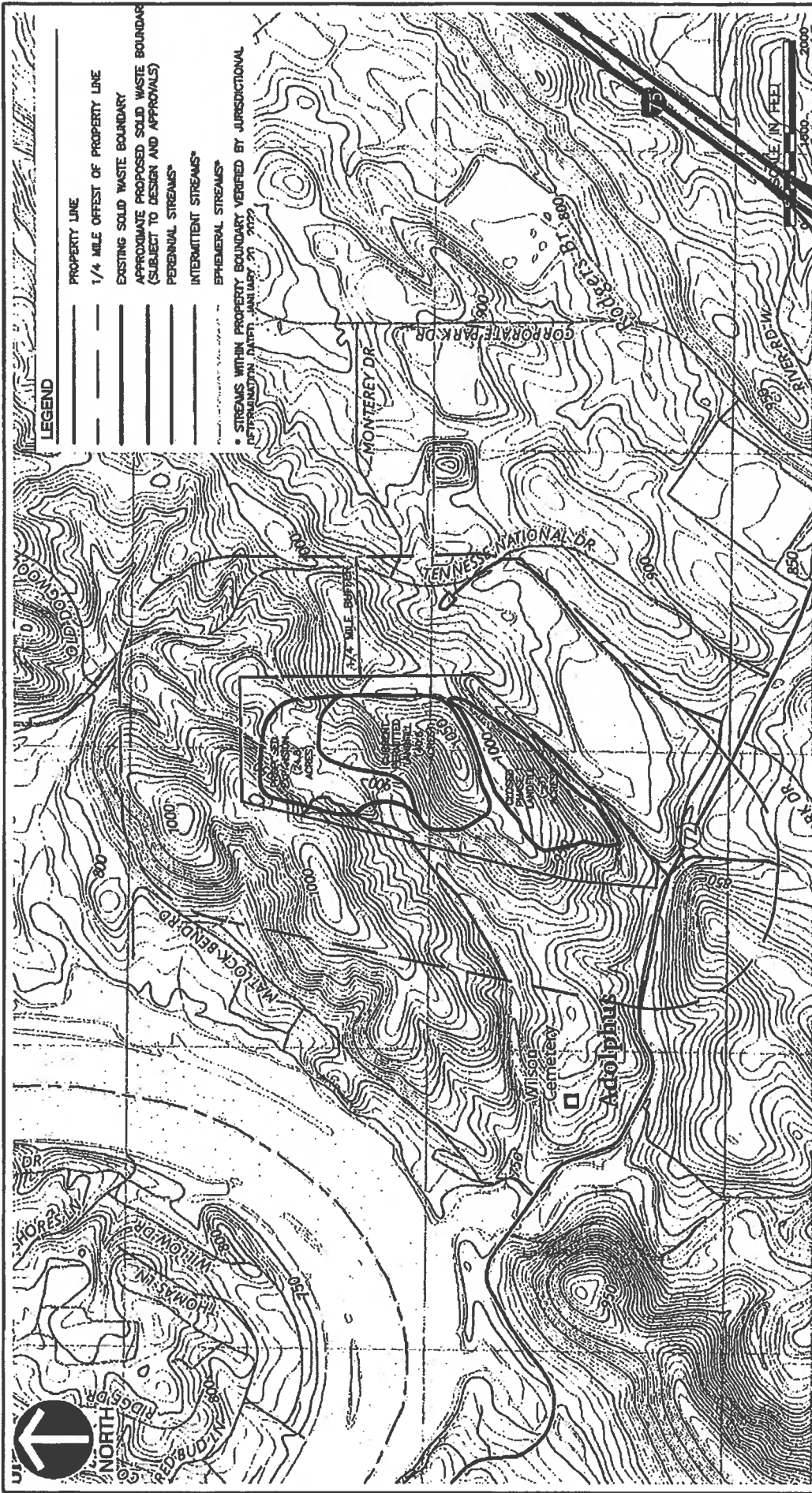

**LEGEND**

- PROPERTY LINE
- 1/4 MILE OFFSET OF PROPERTY LINE
- EXISTING SOLID WASTE BOUNDARY
- APPROXIMATE PROPOSED SOLID WASTE BOUNDARY (SUBJECT TO DESIGN AND APPROVALS)
- PERENNIAL STREAMS\*
- INTERMITTENT STREAMS\*
- EPHEMERAL STREAMS\*

\* STREAMS WITHIN PROPERTY BOUNDARY VERIFIED BY JURISDICTIONAL DETERMINATION DATED JANUARY 20, 2022

**CCE**

**Civil & Environmental Consultants, Inc.**  
 117 Seaboard Lane - Suite E-100 - Friendsville, TN 37607  
 615-335-7787 - 800-783-3268  
[www.cceinc.com](http://www.cceinc.com)

---

**REPUBLIC SERVICES, INC.**  
 LOUDON COUNTY LANDFILL/  
 MATLOCK BEND LANDFILL  
 LOUDON, TENNESSEE

---

**PART I APPLICATION EXHIBIT**

---

**DRAWN BY:** CDS **CHECKED BY:** BLW **APPROVED BY:** SIM **FIGURE NO.:** 1  
**DATE:** SEP 2022 **DWG SCALE:** 1"=1,000' **PROJECT NO.:** 317-474

- NOTES**
1. INFORMATION REPRESENTED ABOVE HAS BEEN ACQUIRED FROM VARIOUS SOURCES AND HAS NOT BEEN FIELD VERIFIED AND/OR CONCURRENCE WITH STREAM DETERMINATIONS HAS NOT BEEN RECEIVED. THIS INFORMATION IS NOT INTENDED FOR DETAILED DESIGN.
  2. AN ONLINE SEARCH OF THE TDEC DNR WATER WELLS RESULTED IN NO DRINKING WATER WELLS WITHIN 1/4 MILE OF THE PROPERTY BOUNDARY.

**REFERENCE**

1. U.S.G.S. 7.5' TOPOGRAPHIC MAP, EMILAPOLINA AND CAVE CREEK QUADRANGLE, TENNESSEE DATED: 2019.

## Loudon Landfill Monthly Tonnages Month Ending April 2023

Matlock Bend Landfill		2022	
Month	2022	2023	to 2023
Jan	12,023	10,967	(1,056)
Feb	12,084	10,899	(1,185)
Mar	14,656	13,080	(1,576)
Apr	13,413	12,504	(909)
May	13,597	13,954	357
Jun	13,486	0	
Jul	12,979	0	
Aug	13,293	0	
Sep	11,350	0	
Oct	11,310	0	
Nov	11,426	0	
Dec	10,354	0	
<b>Total</b>	<b>149,971</b>	<b>61,405</b>	<b>(4,368)</b>
<b>% of Total Tonnage</b>		<b>100%</b>	

Daily Avg. for any Running 30 Day Period **465**

Loudon County		2022	
Month	2022	2023	to 2023
Jan	546	458	(88)
Feb	447	462	15
Mar	553	568	15
Apr	552	522	(30)
May	531	604	73
Jun	563	0	
Jul	557	0	
Aug	585	0	
Sep	557	0	
Oct	502	0	
Nov	561	0	
Dec	513	0	
<b>Total</b>	<b>6,468</b>	<b>2,613</b>	<b>(16)</b>
<b>% of Total Tonnage</b>		<b>4%</b>	

Daily Avg. for any Running 22.5 Day Period **620**

Lenoir City		2022	
Month	2022	2023	to 2023
Jan	498	450	(48)
Feb	458	444	(14)
Mar	623	547	(76)
Apr	527	510	(17)
May	568	554	(14)
Jun	506	0	
Jul	464	0	
Aug	555	0	
Sep	467	0	
Oct	431	0	
Nov	452	0	
Dec	442	0	
<b>Total</b>	<b>5,990</b>	<b>2,506</b>	<b>(168)</b>
<b>% of Total Tonnage</b>		<b>4%</b>	

Loudon, City of		2022	
Month	2022	2023	to 2023
Jan	462	509	47
Feb	451	446	(5)
Mar	532	581	49
Apr	540	479	(61)
May	537	574	37
Jun	498	0	
Jul	483	0	
Aug	536	0	
Sep	465	0	
Oct	492	0	
Nov	460	0	
Dec	430	0	
<b>Total</b>	<b>5,886</b>	<b>2,588</b>	<b>66</b>
<b>% of Total Tonnage</b>		<b>4%</b>	

Republic Services, Inc.		2022	
Month	2022	2023	to 2023
Jan	2,906	2,786	(120)
Feb	2,831	2,607	(224)
Mar	3,355	3,114	(241)
Apr	2,982	2,797	(185)
May	3,097	3,066	(31)
Jun	2,992	0	
Jul	2,910	0	
Aug	3,097	0	
Sep	2,765	0	
Oct	2,750	0	
Nov	2,841	0	
Dec	2,813	0	
<b>Total</b>	<b>35,340</b>	<b>14,371</b>	<b>(800)</b>
<b>% of Total Tonnage</b>		<b>23%</b>	

Waste Management		2022	
Month	2022	2023	to 2023
Jan	2,564	1,920	(644)
Feb	2,617	2,044	(573)
Mar	2,639	2,347	(292)
Apr	2,427	2,175	(252)
May	2,399	2,292	(107)
Jun	2,352	0	
Jul	1,830	0	
Aug	2,268	0	
Sep	1,908	0	
Oct	1,978	0	
Nov	2,094	0	
Dec	1,739	0	
<b>Total</b>	<b>26,816</b>	<b>10,779</b>	<b>(1,867)</b>
<b>% of Total Tonnage</b>		<b>18%</b>	

Liberty Tire		2022	
Month	2022	2023	to 2023
Jan	0	0	0
Feb	0	0	0
Mar	0	246	246
Apr	0	862	862
May	0	910	910
Jun	0	0	
Jul	0	0	
Aug	0	0	
Sep	0	0	
Oct	0	0	
Nov	0	0	
Dec	0	0	
<b>Total</b>	<b>0</b>	<b>2,018</b>	<b>2,018</b>
<b>% of Total Tonnage</b>		<b>3%</b>	

All Other Tons		2022	
Month	2022	2023	to 2023
Jan	5,047	4,844	(203)
Feb	5,280	4,896	(384)
Mar	6,954	5,676	(1,278)
Apr	6,385	5,158	(1,227)
May	6,465	5,955	(510)
Jun	6,575	0	
Jul	6,735	0	
Aug	6,252	0	
Sep	5,188	0	
Oct	5,156	0	
Nov	5,018	0	
Dec	4,417	0	
<b>Total</b>	<b>69,472</b>	<b>26,530</b>	<b>(3,601)</b>
<b>% of Total Tonnage</b>		<b>43%</b>	

**Materials Classification Report**  
**Matlock Bend Landfill**  
**Monthly Tonnage Summary May 2023**

Material	Tonnage	2020 Sludge %		2021 Sludge %	
<b>MSW</b>		January	5%	January	3%
		February	4%	February	5%
<b>MSW</b>	<b>11,179</b>	March	4%	March	5%
		April	4%	April	6%
<b>Special Waste</b>		May	4%	May	6%
		June	5%	June	5%
Other	2,196	July	5%	July	7%
Ash	0	August	6%	August	4%
Sludge	580	September	5%	September	6%
<b>Total Special Waste</b>	<b>2,775</b>	October	3%	October	5%
		November	5%	November	3%
		December	7%	December	7%
<b>Total MSW &amp; SW</b>	<b>13,954</b>				
		January	7%	January	6%
Tires	0	February	6%	February	9%
		March	6%	March	7%
<b>Total Material</b>	<b>13,954</b>	April	5%	April	7%
		May	5%	May	4%
<b>% MSW</b>	<b>80%</b>	June	2%	June	
		July	10%	July	
<b>% Special Waste</b>	<b>20%</b>	August	4%	August	
		September	7%	September	
<b>% Sludge *</b>	<b>4%</b>	October	5%	October	
		November	5%	November	
		December	7%	December	

\* Sludge % is stand alone,  
 % Special Waste includes "Sludge"





**2022-2023 Matlock Bend Landfill Tire  
Report**

<b>Month</b>	<b>Tons (OB)</b>	<b>Each (IB)</b>
Jul-22	28.15	1,697
Aug-22	35.78	2,586
Sep-22	52.92	2,156
Oct-22	14.38	2,091
Nov-22	55.59	2,834
Dec-22	48.27	3,498
Jan-23	53.90	1,255
Feb-23	46.92	2,470
Mar-23	46.92	3,786
Apr-23	68.92	3,495
May-23	0.00	2,824
Jun-23	0.00	0
<b>Total</b>	<b>451.75</b>	<b>28,692</b>



June 2, 2023

Loudon County Solid Waste Disposal Commission  
Attn: Chief Deputy Clerk  
101 Mulberry Street Suite 203  
Loudon, TN 37774

Dear Trustee:

Pursuant to Section 10.6 and 10.7 of the Sanitary Landfill Operation Agreement between Loudon and Santek as of July 1, 2007, Second Amendment Section 10.6 dated July 12, 2022, Santek agreed to pay the Commission a host fee and security fee as defined in the agreement. The following recap reflects the calculation for the period of May 2023:

<u>Host Fees (Greater of below)</u>			
Total Tip Fees Billed	\$469,523.35	Total Tonnage Received	13,954.23
Host Fee Percentage	5.5%	Rate per Ton	<u>\$1.00</u>
	\$25,823.78		\$12,503.93
Minimum Fee	\$10,572.50		
	=====		

<u>Security Fees</u>	
Total Tip Fees Billed	\$469,523.35
Security Fee Percentage	<u>5%</u>
	\$23,476.17
	=====
Total amount to be received	\$49,299.95
	=====

Our checks in payment of the above fees have been remitted to the above address for the Commission. Should you have any questions or need additional information, please let me know.

Sincerely,

David L. Hollinshead  
Manager Municipal Sales  
Republic Services

## Matlock Bend Landfill 2023 Airspace Projection / Construction Schedule

DATE	SURVEYOR	DURATION (DAYS)	TONNAGE (DEplete TONS)	ACTUAL / PROJECTED <sup>1</sup>	PERIOD DENSITY (LBS/CY) <sup>2</sup>	VOLUME CONSUMED (CY) <sup>3</sup>	PERMITTED REMAINING AIRSPACE (CY) <sup>4</sup>
25-May-2020	Southern Resources			-	-	-	975,684
2-Apr-2021	Southern Resources	312	112,343	A	1,310	171,519	826,035
8-Nov-2021	Firmatek	220	83,430	A	1,469	113,617	736,497
19-Jan-2022	Firmatek	72	27,835	A	1,684	33,054	728,208
4-Apr-2022	Firmatek	75	32,651	A	1,510	43,236	695,111
23-Jun-2022	Firmatek	80	36,536	A	1,394	52,401	660,950
6-Jan-2023	Firmatek	197	75,537	A	1,498	100,824	434,800
22-Mar-2023	Firmatek	75	29,813	A	1,110	53,738	381,062
30-Jun-2023	-	100	43,806	P	1,445	60,631	320,431
30-Sep-2023	-	92	40,301	P	1,445	55,780	264,651
31-Dec-2023	-	92	40,301	P	1,445	55,780	208,871
30-Mar-2024	-	90	39,425	P	1,445	54,568	154,304
30-Jun-2024	-	92	40,301	P	1,445	55,780	98,523
30-Sep-2024	-	92	40,301	P	1,445	55,780	42,743
31-Dec-2024	-	92	40,301	P	1,445	55,780	<b>FULL</b>

Budgeted Tons/Calendar Day	438	Budgeted Density (LBS/CY)	1445	Full Date <sup>5</sup>	December-2024
----------------------------	-----	---------------------------	------	------------------------	---------------

<sup>1</sup> = Projected tonnages is based on previous quarter tonnage rate. Density is historic composite density used in Republic models.

<sup>2</sup> = Operational Density calculated from volume consumed within active area only and does not include settlement across entire site.

<sup>3</sup> = Actual Volume Consumed data only accounts for active/operational area and does not count settlement. Projected volume consumed uses budgeted long-term density and accounts for anticipated settlement across the entire site

<sup>4</sup> = Permitted remaining airspace accounts for remaining fill volume (includes Module J construction and overfills are subtracted out).

<sup>5</sup> = Full Date of the landfill is calculated based on estimated future values and will vary due to tonnage or compaction increases/decreases.



May 31, 2023

Mr. Adam Waller  
Chair Loudon Landfill Commission  
Loudon County, TN

Mr. Waller:

As specified in the Second Amendment to the Landfill Operating Agreement, effective July 1, 2023, there will be a contractual landfill disposal price increase to the stakeholders and customers of the Matlock Bend Loudon Landfill. The price increase is based on CPI Water/Sewer/Trash as of May 31. The May 31 CPI data has not been published, however in the interest of providing 30-day notice of the price increase, we are calculating an estimated number of 4.57% for planning purposes.

New disposal pricing will be as follows:

- Area Government Users - \$24.65 per ton (approximate)
- Non-Area Government Users - \$27.18 per ton (approximate)

Additionally, we will be doing calculated price increases to the customers of the Matlock Bend Loudon Landfill. Customers have been notified individually by letter as to the increase they will be receiving.

Pricing initiatives are never easy, but they are necessary. By giving proper notice to our customer base, we are hopeful that the impact can be as minimal as possible.

Thank you,

A handwritten signature in black ink, appearing to read "D. Hollinshead", written over the typed name.

David L. Hollinshead  
Manager Municipal Sales  
Matlock Bend Loudon Landfill

Initial Inspection



**TENNESSEE DIVISION OF SOLID WASTE MANAGEMENT  
CLASS I FACILITY INSPECTION DOCUMENT**

**CLASS I  
FACILITY**

SITE	DATE 5/26/2023	TIME 13:20	WEATHER 80F Sunny
Loudon County Landfill SNL530000203 21712 Highway 72 North Loudon			EFO KNOX <input type="checkbox"/>

\*SEE DISCLAIMER ON LAST PAGE

VIOLATION	REGULATION	OBSERVATION NVO AOC V1 V2
-----------	------------	------------------------------

**BUFFER ZONE STANDARDS FOR SITING LANDFILLS**

<b>8310</b>	<b>BUFFER ZONE STANDARD VIOLATED</b>	0400-11-01-.04(3)(a) <b>Citation</b>	? X	<input checked="" type="checkbox"/>	<input type="checkbox"/>	<input type="checkbox"/>	<input type="checkbox"/>
COMMENTS							

**COLLECTED LEACHATE**

<b>8330</b>	<b>LEACHATE IMPROPERLY MANAGED</b>	0400-11-01-.04(4)(a)8(i-iii) <b>Citation</b>	? X	<input checked="" type="checkbox"/>	<input type="checkbox"/>	<input type="checkbox"/>	<input type="checkbox"/>
COMMENTS	Leachate management plan was submitted to TDEC on May 24, 2023. Issues of leachate on site seem to have been brought under control. It is recommended that the pump system installed to curtail issue be left in place until issue is resolved. The leachate flow volume of said pump, the riser sump and the gravity drain should be reported to the KEFO weekly to ensure that issue has been resolved.						
<b>8340</b>	<b>INADEQUATE LEACHATE COLLECTION SYSTEM</b>	0400-11-01-.04(4)(a)7 <b>Citation</b>	? X	<input checked="" type="checkbox"/>	<input type="checkbox"/>	<input type="checkbox"/>	<input type="checkbox"/>
COMMENTS							

**COMMUNICATIONS**

<b>8130</b>	<b>NO COMMUNICATION DEVICES</b>	0400-11-01-.04(2)(f) <b>Citation</b>	? X	<input checked="" type="checkbox"/>	<input type="checkbox"/>	<input type="checkbox"/>	<input type="checkbox"/>
COMMENTS							

**COVER MATERIAL**

<b>8160</b>	<b>UNAVAILABILITY OF COVER MATERIAL.</b>	0400-11-01-.04(2)(h) <b>Citation</b>	? X	<input checked="" type="checkbox"/>	<input type="checkbox"/>	<input type="checkbox"/>	<input type="checkbox"/>
COMMENTS							

**DEAD ANIMALS**

<b>8250</b>	<b>DEAD ANIMALS IMPROPERLY HANDLED</b>	0400-11-01-.04(2)(k)5.(ii) (I-III) <b>Citation</b>	? X	<input checked="" type="checkbox"/>	<input type="checkbox"/>	<input type="checkbox"/>	<input type="checkbox"/>
COMMENTS							

**DUST CONTROL**

<b>8190</b>	<b>INADEQUATE DUST CONTROL</b>	0400-11-01-.04(2)(j) <b>Citation</b>	? X	<input checked="" type="checkbox"/>	<input type="checkbox"/>	<input type="checkbox"/>	<input type="checkbox"/>
COMMENTS							

**DUTY TO PROVIDE INFORMATION**

VIOLATION		REGULATION	OBSERVATION NVO AOC V1 V2	
<b>DUTY TO PROVIDE INFORMATION</b>				
<b>8530</b>	<b>UNSATISFACTORY RECORDS OR REPORTS</b>	SEE CITATION LIST LAST PAGE <b>Citation</b>	?	<input checked="" type="checkbox"/> <input type="checkbox"/> <input type="checkbox"/> <input type="checkbox"/>
COMMENTS				
<b>8590</b>	<b>PERMITS, PLANS, OPERATING MANUAL NOT AVAILABLE</b>	0400-11-01-.02(5)(a)(7) <b>Citation</b>	?	<input checked="" type="checkbox"/> <input type="checkbox"/> <input type="checkbox"/> <input type="checkbox"/>
COMMENTS				
<b>FIRE SAFETY</b>				
<b>8080</b>	<b>EVIDENCE OF OPEN BURNING</b>	0400-11-01-.04(2)(c)1 <b>Citation</b>	?	<input checked="" type="checkbox"/> <input type="checkbox"/> <input type="checkbox"/> <input type="checkbox"/>
COMMENTS				
<b>8090</b>	<b>INADEQUATE FIRE PROTECTION</b>	0400-11-01-.04(2)(c)2 <b>Citation</b>	?	<input checked="" type="checkbox"/> <input type="checkbox"/> <input type="checkbox"/> <input type="checkbox"/>
COMMENTS				
<b>GAS MIGRATION CONTROL STANDARDS</b>				
<b>8380</b>	<b>INADEQUATE GAS MIGRATION CONTROL SYSTEM</b>	0400-11-01-.04(5)(a) <b>Citation</b>	?	<input checked="" type="checkbox"/> <input type="checkbox"/> <input type="checkbox"/> <input type="checkbox"/>
COMMENTS				
<b>8390</b>	<b>INADEQUATE MAINTENANCE OF GAS MIGRATION CONTROL SYSTEM</b>	0400-11-01-.04(5)(a) <b>Citation</b>	?	<input checked="" type="checkbox"/> <input type="checkbox"/> <input type="checkbox"/> <input type="checkbox"/>
COMMENTS				
<b>GENERAL FACILITY STANDARDS</b>				
<b>8010</b>	<b>INADEQUATE VECTOR CONTROL</b>	0400-11-01-.04(2)(a)1 <b>Citation</b>	?	<input checked="" type="checkbox"/> <input type="checkbox"/> <input type="checkbox"/> <input type="checkbox"/>
COMMENTS				
<b>8020</b>	<b>ACCESS NOT LIMITED TO OPERATING HOURS</b>	0400-11-01-.04(2)(a)4 <b>Citation</b>	?	<input checked="" type="checkbox"/> <input type="checkbox"/> <input type="checkbox"/> <input type="checkbox"/>
COMMENTS				
<b>8030</b>	<b>INADEQUATE ARTIFICIAL OR NATURAL BARRIER</b>	0400-11-01-.04(2)(b)1 <b>Citation</b>	?	<input checked="" type="checkbox"/> <input type="checkbox"/> <input type="checkbox"/> <input type="checkbox"/>
COMMENTS				



VIOLATION		REGULATION	OBSERVATION			
			NVO	AOC	V1	V2
<b>GENERAL FACILITY STANDARDS</b>						
<b>8040</b>	<b>INADEQUATE INFORMATION SIGNS</b>	0400-11-01-.04(2)(b)2 TCA 68-211-703(h)	?	<input checked="" type="checkbox"/>	<input type="checkbox"/>	<input type="checkbox"/>
		<b>Citation</b>	X			
COMMENTS						
<b>8050</b>	<b>UNSATISFACTORY ACCESS ROAD(S)/PARKING AREA(S)</b>	0400-11-01-.04(2)(b)3	?	<input checked="" type="checkbox"/>	<input type="checkbox"/>	<input type="checkbox"/>
		<b>Citation</b>	X			
COMMENTS						
<b>8060</b>	<b>CERTIFIED PERSONNEL NOT PRESENT DURING OPERATING HOURS</b>	0400-11-01-.04(2)(b)5	?	<input checked="" type="checkbox"/>	<input type="checkbox"/>	<input type="checkbox"/>
		<b>Citation</b>	X			
COMMENTS						
<b>8070</b>	<b>UNAPPROVED SALVAGING OF WASTE</b>	0400-11-01-.04(2)(b)6	?	<input checked="" type="checkbox"/>	<input type="checkbox"/>	<input type="checkbox"/>
		<b>Citation</b>	X			
COMMENTS						
<b>LITTER CONTROL</b>						
<b>8110</b>	<b>UNSATISFACTORY LITTER CONTROL</b>	0400-11-01-.04(2)(d)	?	<input type="checkbox"/>	<input checked="" type="checkbox"/>	<input type="checkbox"/>
		<b>Citation</b>	X			
COMMENTS	Flagging litter needs to be addressed immediately, as several sections of landfill are in need of more cover to cover large amounts exposed waste.					
<b>OPERATING EQUIPMENT</b>						
<b>8140</b>	<b>INADEQUATE OPERATING EQUIPMENT</b>	0400-11-01-.04(2)(g)	?	<input type="checkbox"/>	<input type="checkbox"/>	<input checked="" type="checkbox"/>
		<b>Citation</b>	X			
COMMENTS	Compactor assigned to landfill was inoperable due to fire . Both bulldozers assigned to landfill were also inoperable. Additional (backup) compactor that had been on the landfill was removed to another site. The minimum amount of equipment detailed in facility permit, must be on site during operating hours.					
<b>8150</b>	<b>UNAVAILABILITY OF BACKUP EQUIPMENT</b>	0400-11-01-.04(2)(g)	?	<input type="checkbox"/>	<input type="checkbox"/>	<input checked="" type="checkbox"/>
		<b>Citation</b>	X			
COMMENTS	Compactor assigned to landfill was inoperable due to fire . Both bulldozers assigned to landfill were also inoperable. Additional (backup) compactor that had been on the landfill was removed to another site. The minimum amount of equipment detailed in facility permit, must be on site during operating hours.					
<b>OVERALL PERFORMANCE STANDARD</b>						
<b>8270</b>	<b>EXPOSED SOLID WASTE</b>	0400-11-01-.04(2)(a)(3)	?	<input checked="" type="checkbox"/>	<input type="checkbox"/>	<input type="checkbox"/>
		<b>Citation</b>	X			
COMMENTS						
<b>8320</b>	<b>INADEQUATE MAINTENANCE OF LEACHATE MANAGEMENT SYSTEM (INSPECTOR TO CHECK AND RECORD LEACHATE LEVELS AT EVERY LANDFILL SUMP)</b>	0400-11-01-.04(2)(a)(3) 0400-11-01-.04(4)(a)7	?	<input type="checkbox"/>	<input checked="" type="checkbox"/>	<input type="checkbox"/>
		<b>Citation</b>	X			
COMMENTS	Sump: 16.9"					

VIOLATION		REGULATION	OBSERVATION NVO AOC V1 V2					
<b>OVERALL PERFORMANCE STANDARD</b>								
8350	LEACHATE OBSERVED AT THE SITE	0400-11-01-.04(2)(a)(3) 0400-11-01-.04(4)(a)6 Citation	?	X	<input checked="" type="checkbox"/>	<input type="checkbox"/>	<input type="checkbox"/>	<input type="checkbox"/>
COMMENTS								
8360	LEACHATE ENTERING RUN-OFF	0400-11-01-.04(2)(a)(3) 0400-11-01-.04(4)(a)6 Citation	?	X	<input checked="" type="checkbox"/>	<input type="checkbox"/>	<input type="checkbox"/>	<input type="checkbox"/>
COMMENTS								
8370	LEACHATE ENTERING A WATER COURSE	0400-11-01-.04(2)(a)(3) 0400-11-01-.04(4)(a)6 Citation	?	X	<input checked="" type="checkbox"/>	<input type="checkbox"/>	<input type="checkbox"/>	<input type="checkbox"/>
COMMENTS								
8420	POTENTIAL FOR EXPLOSIONS OR UNCONTROLLED FIRES	0400-11-01-.04(2)(a)2 0400-11-01-.04(5)(a) Citation	?	X	<input checked="" type="checkbox"/>	<input type="checkbox"/>	<input type="checkbox"/>	<input type="checkbox"/>
COMMENTS								
8490	EXCESSIVE POOLING OF WATER	(CLOSURE/POST)0400-11-01-.04(2)(a)3 0400-11-01-.04(8)(c)4(iii) (ACTIVE) 0400-11-01-04 Citation	?	X	<input checked="" type="checkbox"/>	<input type="checkbox"/>	<input type="checkbox"/>	<input type="checkbox"/>
COMMENTS								
8520	DUMPING OF WASTE INTO WATER	0400-11-01-.04 (2)(a)3 Citation	?	X	<input checked="" type="checkbox"/>	<input type="checkbox"/>	<input type="checkbox"/>	<input type="checkbox"/>
COMMENTS								
<b>PERMANENT BENCHMARK</b>								
8280	NO PERMANENT BENCHMARK	0400-11-01-.04(2)(o) Citation	?	X	<input checked="" type="checkbox"/>	<input type="checkbox"/>	<input type="checkbox"/>	<input type="checkbox"/>
COMMENTS								
<b>PERSONNEL SERVICES</b>								
8120	INADEQUATE EMPLOYEE FACILITIES	0400-11-01-.04(2)(e) Citation	?	X	<input checked="" type="checkbox"/>	<input type="checkbox"/>	<input type="checkbox"/>	<input type="checkbox"/>
COMMENTS								
<b>PROPER OPERATION AND MAINTENANCE</b>								
8540	GROUNDWATER MONITORING SYSTEM IMPROPERLY MAINTAINED	0400-11-01-.02(5)(a)4 Citation	?	X	<input checked="" type="checkbox"/>	<input type="checkbox"/>	<input type="checkbox"/>	<input type="checkbox"/>
COMMENTS								

VIOLATION		REGULATION	OBSERVATION			
			NVO	AOC	V1	V2
<b>RANDOM INSPECTION PROGRAM</b>						
<b>8290</b>	<b>INADEQUATE RANDOM INSPECTION PROGRAM</b>	0400-11-01-.04(2)(s) <b>Citation</b>	?	<input checked="" type="checkbox"/>	<input type="checkbox"/>	<input type="checkbox"/>
COMMENTS						
<b>RECORDS OF ORIGIN AND AMOUNT OF SOLID WASTE</b>						
<b>8610</b>	<b>NO OPERATING SCALES AND/OR FAILURE TO MAINTAIN WASTE RECORDS</b>	TCA 68-211-862(a)(b)(1)(2) <b>Citation</b>	?	<input checked="" type="checkbox"/>	<input type="checkbox"/>	<input type="checkbox"/>
COMMENTS						
<b>RUN-ON, RUN-OFF, AND EROSION CONTROL</b>						
<b>8170</b>	<b>INADEQUATE MAINTENANCE OF RUN-ON/ RUN-OFF SYSTEM(S)</b>	0400-11-01-.04(2)(i)1-5 0400-11-01-.04(8)(c)4(i) <b>Citation</b>	?	<input checked="" type="checkbox"/>	<input type="checkbox"/>	<input type="checkbox"/>
COMMENTS						
<b>8180</b>	<b>INADEQUATE EROSION CONTROL</b>	0400-11-01-.04(2)(i)6 0400-11-01-.04(8)(c)4(i) <b>Citation</b>	?	<input type="checkbox"/>	<input checked="" type="checkbox"/>	<input type="checkbox"/>
COMMENTS Several locations showed visible erosion damage that needs to be addressed immediately.						
<b>SPECIAL WASTE APPROVAL PROCESS</b>						
<b>8300</b>	<b>MISHANDLING OF SPECIAL WASTE</b>	0400-11-01-.01(4)(d)1 <b>Citation</b>	?	<input checked="" type="checkbox"/>	<input type="checkbox"/>	<input type="checkbox"/>
COMMENTS						
<b>UNLAWFUL METHODS OF DISPOSAL</b>						
<b>8570</b>	<b>OPERATION DOES NOT CORRESPOND WITH ENGINEERING PLANS (EVALUATE AND RECORD THE APPROXIMATE INTERIOR AND EXTERIOR SLOPE OF THE LANDFILL)</b>	TCA68-211-104(3) TCA 68-211-105(b) <b>Citation</b>	?	<input checked="" type="checkbox"/>	<input type="checkbox"/>	<input type="checkbox"/>
COMMENTS						
<b>8580</b>	<b>OPERATION DOES NOT CORRESPOND WITH PERMIT CONDITIONS</b>	TCA 68-211-104(3) 0400-11-01-.02(5)(a)(1) <b>Citation</b>	?	<input type="checkbox"/>	<input checked="" type="checkbox"/>	<input type="checkbox"/>
COMMENTS Compactor assigned to landfill was inoperable due to fire . Both bulldozers assigned to landfill were also inoperable. Additional (backup) compactor that had been on the landfill was removed to another site. The minimum amount of equipment detailed in facility permit, must be on site during operating hours.						
<b>WASTE HANDLING AND COVER STANDARDS</b>						
<b>8430</b>	<b>WASTE NOT CONFINED TO A MANAGEABLE AREA</b>	0400-11-01-.04(6)(a)1 <b>Citation</b>	?	<input checked="" type="checkbox"/>	<input type="checkbox"/>	<input type="checkbox"/>
COMMENTS						

VIOLATION		REGULATION	OBSERVATION NVO AOC V1 V2				
<b>WASTE HANDLING AND COVER STANDARDS</b>							
<b>8440</b>	<b>IMPROPER SPREADING OF WASTE</b>	0400-11-01-.04(6)(a)2 <b>Citation</b>	?	<input checked="" type="checkbox"/>	<input type="checkbox"/>	<input type="checkbox"/>	<input type="checkbox"/>
COMMENTS							
<b>8450</b>	<b>IMPROPER COMPACTING OF WASTE</b>	0400-11-01-.04(6)(a)2 <b>Citation</b>	?	<input checked="" type="checkbox"/>	<input type="checkbox"/>	<input type="checkbox"/>	<input type="checkbox"/>
COMMENTS							
<b>8460</b>	<b>UNSATISFACTORY INITIAL COVER</b>	0400-11-01-.04(6)(a)3 0400-11-01-.04(6)(a)5 <b>Citation</b>	?	<input checked="" type="checkbox"/>	<input type="checkbox"/>	<input type="checkbox"/>	<input type="checkbox"/>
COMMENTS							
<b>8470</b>	<b>UNSATISFACTORY INTERMEDIATE COVER</b>	0400-11-01-.04(6)(a)4 0400-11-01-.04(6)(a)5 <b>Citation</b>	?	<input type="checkbox"/>	<input checked="" type="checkbox"/>	<input type="checkbox"/>	<input type="checkbox"/>
COMMENTS		Flagging litter needs to be addressed immediately, as several sections of landfill are in need of more cover to cover large amounts exposed waste.					
<b>8480</b>	<b>UNSATISFACTORY FINAL COVER</b>	0400-11-01-.04(6)(a)6 0400-11-01-.04(8)(c)3(i) <b>Citation</b>	?	<input checked="" type="checkbox"/>	<input type="checkbox"/>	<input type="checkbox"/>	<input type="checkbox"/>
COMMENTS							
<b>8510</b>	<b>UNSATISFACTORY STABILIZATION OF COVER</b>	0400-11-01-.04(6)(a)5,6 <b>Citation</b>	?	<input checked="" type="checkbox"/>	<input type="checkbox"/>	<input type="checkbox"/>	<input type="checkbox"/>
COMMENTS							
<b>WASTE RESTRICTIONS</b>							
<b>8210</b>	<b>UNAUTHORIZED WASTE ACCEPTED</b>	0400-11-01-.04(2)(k)1 0400-11-01-.04(2)(k)6 <b>Citation</b>	?	<input checked="" type="checkbox"/>	<input type="checkbox"/>	<input type="checkbox"/>	<input type="checkbox"/>
COMMENTS							
<b>8220</b>	<b>UNAPPROVED SPECIAL WASTE ACCEPTED</b>	0400-11-01-.01(4)(b) 0400-11-01-.01(4)(c)5 <b>Citation</b>	?	<input checked="" type="checkbox"/>	<input type="checkbox"/>	<input type="checkbox"/>	<input type="checkbox"/>
COMMENTS							

\*SEE DISCLAIMER ON LAST PAGE

VIOLATION		REGULATION	OBSERVATION				
WASTE RESTRICTIONS							
8230	TIRES IMPROPERLY HANDLED	0400-11-01-.04(2)(k)3(i)	?	<input checked="" type="checkbox"/>	<input type="checkbox"/>	<input type="checkbox"/>	<input type="checkbox"/>
COMMENTS		Citation		X			
8240	MEDICAL WASTE IMPROPERLY HANDLED	0400-11-01-.04(2)(k)4(i-iv)	?	<input checked="" type="checkbox"/>	<input type="checkbox"/>	<input type="checkbox"/>	<input type="checkbox"/>
COMMENTS		Citation		X			

LEACHATE LEVELS

*\*Disclaimer: The information contained in these documents (checklists/notes, etc.) is not intended to be all inclusive and is subject to change. These documents are intended solely for use by DSWM staff. These documents are not a substitute for evaluation of compliance in accordance with applicable laws and regulations. These documents are not intended for, nor can they be relied upon, to create any rights, substantive or procedural, enforceable or useable by any party in litigation with the State of Tennessee or its employees.*

**SAVE FORM**

Follow-Up Inspection Date

Inspector Name Lewis L Haynes IV Digitally signed by Lewis L Haynes IV  
Date: 2023.05.30 14:55:32 -04'00'

**ADDITIONAL COMMENTS**

Please contact Knoxville Environmental field office as soon as inoperable equipment is returned to serviceable status and new compactor is on site.

See photo log attached,



## Unsatisfactory records or reports

[BACK TO TOP](#)

Citation Reference: 0400-11-01-.02(5)(a)7

[CITATION](#)

Citation Reference: TCA 68-211-862(a)

[CLOSE](#)

Citation Reference: 0400-11-01-.04(7)(a)4(vii)

[CLOSE](#)

Citation Reference: 0400-11-01-.04(2)(k)3(i)(II)VI

[CLOSE](#)

Citation Reference: 0400-11-01-.04(2)(s)

[CLOSE](#)

Citation Reference: 0400-11-01-.01(4)(d)2

[CITATION](#)

Citation Reference: 0400-11-01-.02(3)(a)4

[CLOSE](#)

Citation Reference: 0400-11-01-.02(5)(a)9

[CLOSE](#)

Citation Reference: 0400-11-01-.08(3)

[CLOSE](#)





## Sustainability in Action

May 24, 2023

Mr. Lewis Haynes IV, PhD, CHMM  
Tennessee Department of Environment & Conservation  
Solid Waste/Environmental Response/Knoxville Field Office  
3711 Middlebrook Pike, Knoxville, TN 37921  
Delivered Electronically to: [Lew.Haynes@tn.gov](mailto:Lew.Haynes@tn.gov)

**Re: Matlock Bend Landfill – Response to Tennessee Department of Environment and Conservation (TDEC) Inspection on April 21, 2023  
Loudon County, Tennessee**

Dear Mr. Haynes:

At the request of TDEC, Santek Environmental, LLC (Santek) has prepared this letter response to the TDEC monthly inspection that occurred on April 21, 2023. During the inspection, the observations below were made related to Facility operations. Below each observation, a response/status has been provided by Santek which shows corrective action for the subject items. In addition, a conference call was held between representatives of Santek, TDEC, and the Loudon County Solid Waste Disposal Commission on May 9, 2023 to discuss these corrective actions and provide the basis for this response.

### **Leachate Improperly Managed and Inadequate Maintenance of Leachate Management System/Leachate Observed at the Site**

- TDEC observed several leachate outbreaks. TDEC noted that seeps have been worked on but said that further work is required which may involve alternative methodologies to get the seeps to drain properly.

Response/Corrective Action: 3<sup>rd</sup> party help was hired to assist. A solar-powered Blackhawk pump with a casing and river rock has been installed in the excavation of a lingering leachate seep on the East Slope to address this area. Pumped liquid is currently being facilitated into a nearby leachate collection system cleanout with a 2-inch HDPE pipe. Remaining seeps have been redirected into the landfill and properly covered.

### **Unsatisfactory Litter Control**

- TDEC noted that flagging litter needs to be addressed immediately and that additional cover is required to cover exposed waste.
  - Response/Corrective Action: Additional help in the form of two temporary and one full-time employee were hired for litter control/addressing cover. The temporary employees are addressing litter control and the full-time employee is aggressively addressing cover.

#### **Inadequate Erosion Control**

- TDEC observed several areas containing erosion damage and noted that they need to be addressed immediately.
  - Response/Corrective Action: Santek is actively in the process of addressing erosion. Seeding and temporary stabilization of slopes are currently underway per our stormwater management plan. A diversion berm has been installed on the Eastern slope and another diversion berm is currently being installed on the Western slope. Stormwater down drains are being installed to facilitate collected stormwater to sediment ponds. This work is expected to be complete by the end of May 2023.

#### **Unsatisfactory Intermediate Cover**

- TDEC said that flagging litter needs to be addressed immediately and requires more intermediate cover.
  - Response/Corrective Action: One full-time employee has been hired for addressing cover which has been addressed as of May 5, 2023.

#### **Unsatisfactory Final Cover**

- TDEC noted that trees/rooting plant located in the final cap closed area are very close to gas vents and need to be removed.
  - Response/Corrective Action: Routine vegetative maintenance was scheduled to address this area. This routine maintenance was conducted early than originally planned and the problematic area was addressed as of May 5, 2023.

We are committed to resolving these issues in a timely manner and returning the Facility to compliance. Should you have questions or comments, please contact me by email at [bhaney@republicservices.com](mailto:bhaney@republicservices.com) or by phone at (423) 994-3133.

Sincerely,



Ben Haney, E.I.T.  
Environmental Manager  
Matlock Bend Landfill

cc: Mike Classen, P.E. – Matlock Bend Landfill  
Teresa Fox – Matlock Bend Landfill  
Revendra Awasthi – Tennessee Department of Environment & Conservation  
Adam Waller – Loudon County Solid Waste Disposal Commission

Initial Inspection



TENNESSEE DIVISION OF SOLID WASTE MANAGEMENT  
CLASS I FACILITY INSPECTION DOCUMENT

**CLASS I  
FACILITY**

SITE	DATE 6/8/2023	TIME 13:38	WEATHER 85F Sunny
------	------------------	---------------	----------------------

Loudon County Landfill SNL530000203 21712 Highway 72 North Loudon	EFO KNOX
---	-------------

\*SEE DISCLAIMER ON LAST PAGE

VIOLATION	REGULATION	OBSERVATION NVO AOC V1 V2
-----------	------------	------------------------------

**BUFFER ZONE STANDARDS FOR SITING LANDFILLS**

8310	BUFFER ZONE STANDARD VIOLATED	0400-11-01-.04(3)(a) Citation	? X	<input checked="" type="checkbox"/>	<input type="checkbox"/>	<input type="checkbox"/>	<input type="checkbox"/>
------	-------------------------------	----------------------------------	--------	-------------------------------------	--------------------------	--------------------------	--------------------------

COMMENTS	
----------	--

**COLLECTED LEACHATE**

8330	LEACHATE IMPROPERLY MANAGED	0400-11-01-.04(4)(a)8(i-iii) Citation	? X	<input checked="" type="checkbox"/>	<input type="checkbox"/>	<input type="checkbox"/>	<input type="checkbox"/>
------	-----------------------------	--	--------	-------------------------------------	--------------------------	--------------------------	--------------------------

COMMENTS	Leachate management plan was submitted to TDEC on May 24, 2023. Issues of leachate on site seem to have been brought under control. It is recommended that the pump system installed to curtail issue be left in place until issue is resolved. The leachate flow volume of said pump, the riser sump and the gravity drain should be reported to the KEFO weekly to ensure that issue has been resolved.
----------	---

8340	INADEQUATE LEACHATE COLLECTION SYSTEM	0400-11-01-.04(4)(a)7 Citation	? X	<input checked="" type="checkbox"/>	<input type="checkbox"/>	<input type="checkbox"/>	<input type="checkbox"/>
------	---------------------------------------	-----------------------------------	--------	-------------------------------------	--------------------------	--------------------------	--------------------------

COMMENTS	
----------	--

**COMMUNICATIONS**

8130	NO COMMUNICATION DEVICES	0400-11-01-.04(2)(f) Citation	? X	<input checked="" type="checkbox"/>	<input type="checkbox"/>	<input type="checkbox"/>	<input type="checkbox"/>
------	--------------------------	----------------------------------	--------	-------------------------------------	--------------------------	--------------------------	--------------------------

COMMENTS	
----------	--

**COVER MATERIAL**

8160	UNAVAILABILITY OF COVER MATERIAL.	0400-11-01-.04(2)(h) Citation	? X	<input checked="" type="checkbox"/>	<input type="checkbox"/>	<input type="checkbox"/>	<input type="checkbox"/>
------	-----------------------------------	----------------------------------	--------	-------------------------------------	--------------------------	--------------------------	--------------------------

COMMENTS	
----------	--

**DEAD ANIMALS**

8250	DEAD ANIMALS IMPROPERLY HANDLED	0400-11-01-.04(2)(k)5.(ii) (I-III) Citation	? X	<input checked="" type="checkbox"/>	<input type="checkbox"/>	<input type="checkbox"/>	<input type="checkbox"/>
------	---------------------------------	--	--------	-------------------------------------	--------------------------	--------------------------	--------------------------

COMMENTS	
----------	--

**DUST CONTROL**

8190	INADEQUATE DUST CONTROL	0400-11-01-.04(2)(j) Citation	? X	<input checked="" type="checkbox"/>	<input type="checkbox"/>	<input type="checkbox"/>	<input type="checkbox"/>
------	-------------------------	----------------------------------	--------	-------------------------------------	--------------------------	--------------------------	--------------------------

COMMENTS	
----------	--

**DUTY TO PROVIDE INFORMATION**

VIOLATION		REGULATION	OBSERVATION			
			NVO	AOC	V1	V2
<b>DUTY TO PROVIDE INFORMATION</b>						
<b>8530</b>	<b>UNSATISFACTORY RECORDS OR REPORTS</b>	SEE CITATION LIST LAST PAGE <b>Citation</b>	?	<input checked="" type="checkbox"/>	<input type="checkbox"/>	<input type="checkbox"/>
COMMENTS						
<b>8590</b>	<b>PERMITS, PLANS, OPERATING MANUAL NOT AVAILABLE</b>	0400-11-01-.02(5)(a)(7) <b>Citation</b>	?	<input checked="" type="checkbox"/>	<input type="checkbox"/>	<input type="checkbox"/>
COMMENTS						
<b>FIRE SAFETY</b>						
<b>8080</b>	<b>EVIDENCE OF OPEN BURNING</b>	0400-11-01-.04(2)(c)1 <b>Citation</b>	?	<input checked="" type="checkbox"/>	<input type="checkbox"/>	<input type="checkbox"/>
COMMENTS						
<b>8090</b>	<b>INADEQUATE FIRE PROTECTION</b>	0400-11-01-.04(2)(c)2 <b>Citation</b>	?	<input checked="" type="checkbox"/>	<input type="checkbox"/>	<input type="checkbox"/>
COMMENTS						
<b>GAS MIGRATION CONTROL STANDARDS</b>						
<b>8380</b>	<b>INADEQUATE GAS MIGRATION CONTROL SYSTEM</b>	0400-11-01-.04(5)(a) <b>Citation</b>	?	<input checked="" type="checkbox"/>	<input type="checkbox"/>	<input type="checkbox"/>
COMMENTS						
<b>8390</b>	<b>INADEQUATE MAINTENANCE OF GAS MIGRATION CONTROL SYSTEM</b>	0400-11-01-.04(5)(a) <b>Citation</b>	?	<input checked="" type="checkbox"/>	<input type="checkbox"/>	<input type="checkbox"/>
COMMENTS						
<b>GENERAL FACILITY STANDARDS</b>						
<b>8010</b>	<b>INADEQUATE VECTOR CONTROL</b>	0400-11-01-.04(2)(a)1 <b>Citation</b>	?	<input checked="" type="checkbox"/>	<input type="checkbox"/>	<input type="checkbox"/>
COMMENTS						
<b>8020</b>	<b>ACCESS NOT LIMITED TO OPERATING HOURS</b>	0400-11-01-.04(2)(a)4 <b>Citation</b>	?	<input checked="" type="checkbox"/>	<input type="checkbox"/>	<input type="checkbox"/>
COMMENTS						
<b>8030</b>	<b>INADEQUATE ARTIFICIAL OR NATURAL BARRIER</b>	0400-11-01-.04(2)(b)1 <b>Citation</b>	?	<input checked="" type="checkbox"/>	<input type="checkbox"/>	<input type="checkbox"/>
COMMENTS						

VIOLATION		REGULATION	OBSERVATION			
			NVO	AOC	V1	V2
<b>GENERAL FACILITY STANDARDS</b>						
<b>8040</b>	<b>INADEQUATE INFORMATION SIGNS</b>	0400-11-01-.04(2)(b)2 TCA 68-211-703(h)	?	<input checked="" type="checkbox"/>	<input type="checkbox"/>	<input type="checkbox"/>
		<b>Citation</b>	X			
COMMENTS						
<b>8050</b>	<b>UNSATISFACTORY ACCESS ROAD(S)/PARKING AREA(S)</b>	0400-11-01-.04(2)(b)3	?	<input checked="" type="checkbox"/>	<input type="checkbox"/>	<input type="checkbox"/>
		<b>Citation</b>	X			
COMMENTS						
<b>8060</b>	<b>CERTIFIED PERSONNEL NOT PRESENT DURING OPERATING HOURS</b>	0400-11-01-.04(2)(b)5	?	<input checked="" type="checkbox"/>	<input type="checkbox"/>	<input type="checkbox"/>
		<b>Citation</b>	X			
COMMENTS						
<b>8070</b>	<b>UNAPPROVED SALVAGING OF WASTE</b>	0400-11-01-.04(2)(b)6	?	<input checked="" type="checkbox"/>	<input type="checkbox"/>	<input type="checkbox"/>
		<b>Citation</b>	X			
COMMENTS						
<b>LITTER CONTROL</b>						
<b>8110</b>	<b>UNSATISFACTORY LITTER CONTROL</b>	0400-11-01-.04(2)(d)	?	<input type="checkbox"/>	<input checked="" type="checkbox"/>	<input type="checkbox"/>
		<b>Citation</b>	X			
COMMENTS	Flagging litter is being addressed on site, efforts need to be continued to completion.					
<b>OPERATING EQUIPMENT</b>						
<b>8140</b>	<b>INADEQUATE OPERATING EQUIPMENT</b>	0400-11-01-.04(2)(g)	?	<input checked="" type="checkbox"/>	<input type="checkbox"/>	<input type="checkbox"/>
		<b>Citation</b>	X			
COMMENTS	Equipment was on site and operating on June 5, 2023. Violation has been removed.					
<b>8150</b>	<b>UNAVAILABILITY OF BACKUP EQUIPMENT</b>	0400-11-01-.04(2)(g)	?	<input checked="" type="checkbox"/>	<input type="checkbox"/>	<input type="checkbox"/>
		<b>Citation</b>	X			
COMMENTS	Equipment was on site and operating on June 5, 2023. Violation has been removed.					
<b>OVERALL PERFORMANCE STANDARD</b>						
<b>8270</b>	<b>EXPOSED SOLID WASTE</b>	0400-11-01-.04(2)(a)(3)	?	<input checked="" type="checkbox"/>	<input type="checkbox"/>	<input type="checkbox"/>
		<b>Citation</b>	X			
COMMENTS						
<b>8320</b>	<b>INADEQUATE MAINTENANCE OF LEACHATE MANAGEMENT SYSTEM (INSPECTOR TO CHECK AND RECORD LEACHATE LEVELS AT EVERY LANDFILL SUMP)</b>	0400-11-01-.04(2)(a)(3) 0400-11-01-.04(4)(a)7	?	<input checked="" type="checkbox"/>	<input type="checkbox"/>	<input type="checkbox"/>
		<b>Citation</b>	X			
COMMENTS	Sump: 16.7"					

VIOLATION		REGULATION	OBSERVATION			
			NVO	AOC	V1	V2
<b>OVERALL PERFORMANCE STANDARD</b>						
8350	LEACHATE OBSERVED AT THE SITE	0400-11-01-.04(2)(a)(3) 0400-11-01-.04(4)(a)6 <b>Citation</b>	?	<input checked="" type="checkbox"/>	<input type="checkbox"/>	<input type="checkbox"/>
COMMENTS			X			
8360	LEACHATE ENTERING RUN-OFF	0400-11-01-.04(2)(a)(3) 0400-11-01-.04(4)(a)6 <b>Citation</b>	?	<input checked="" type="checkbox"/>	<input type="checkbox"/>	<input type="checkbox"/>
COMMENTS			X			
8370	LEACHATE ENTERING A WATER COURSE	0400-11-01-.04(2)(a)(3) 0400-11-01-.04(4)(a)6 <b>Citation</b>	?	<input checked="" type="checkbox"/>	<input type="checkbox"/>	<input type="checkbox"/>
COMMENTS			X			
8420	POTENTIAL FOR EXPLOSIONS OR UNCONTROLLED FIRES	0400-11-01-.04(2)(a)2 0400-11-01-.04(5)(a) <b>Citation</b>	?	<input checked="" type="checkbox"/>	<input type="checkbox"/>	<input type="checkbox"/>
COMMENTS			X			
8490	EXCESSIVE POOLING OF WATER	(CLOSURE/POST)0400-11-01-.04(2)(a)3 0400-11-01-.04(8)(c)4(iii) (ACTIVE) 0400-11-01-04 <b>Citation</b>	?	<input checked="" type="checkbox"/>	<input type="checkbox"/>	<input type="checkbox"/>
COMMENTS			X			
8520	DUMPING OF WASTE INTO WATER	0400-11-01-.04 (2)(a)3 <b>Citation</b>	?	<input checked="" type="checkbox"/>	<input type="checkbox"/>	<input type="checkbox"/>
COMMENTS			X			
<b>PERMANENT BENCHMARK</b>						
8280	NO PERMANENT BENCHMARK	0400-11-01-.04(2)(o) <b>Citation</b>	?	<input checked="" type="checkbox"/>	<input type="checkbox"/>	<input type="checkbox"/>
COMMENTS			X			
<b>PERSONNEL SERVICES</b>						
8120	INADEQUATE EMPLOYEE FACILITIES	0400-11-01-.04(2)(e) <b>Citation</b>	?	<input checked="" type="checkbox"/>	<input type="checkbox"/>	<input type="checkbox"/>
COMMENTS			X			
<b>PROPER OPERATION AND MAINTENANCE</b>						
8540	GROUNDWATER MONITORING SYSTEM IMPROPERLY MAINTAINED	0400-11-01-.02(5)(a)4 <b>Citation</b>	?	<input checked="" type="checkbox"/>	<input type="checkbox"/>	<input type="checkbox"/>
COMMENTS			X			

VIOLATION		REGULATION	OBSERVATION			
			NVO	AOC	V1	V2
<b>RANDOM INSPECTION PROGRAM</b>						
<b>8290</b>	<b>INADEQUATE RANDOM INSPECTION PROGRAM</b>	0400-11-01-.04(2)(s) <b>Citation</b>	?	<input checked="" type="checkbox"/>	<input type="checkbox"/>	<input type="checkbox"/>
COMMENTS						
<b>RECORDS OF ORIGIN AND AMOUNT OF SOLID WASTE</b>						
<b>8610</b>	<b>NO OPERATING SCALES AND/OR FAILURE TO MAINTAIN WASTE RECORDS</b>	TCA 68-211-862(a)(b)(1)(2) <b>Citation</b>	?	<input checked="" type="checkbox"/>	<input type="checkbox"/>	<input type="checkbox"/>
COMMENTS						
<b>RUN-ON, RUN-OFF, AND EROSION CONTROL</b>						
<b>8170</b>	<b>INADEQUATE MAINTENANCE OF RUN-ON/ RUN-OFF SYSTEM(S)</b>	0400-11-01-.04(2)(i)1-5 0400-11-01-.04(8)(c)4(i) <b>Citation</b>	?	<input checked="" type="checkbox"/>	<input type="checkbox"/>	<input type="checkbox"/>
COMMENTS						
<b>8180</b>	<b>INADEQUATE EROSION CONTROL</b>	0400-11-01-.04(2)(i)6 0400-11-01-.04(8)(c)4(ii) <b>Citation</b>	?	<input type="checkbox"/>	<input checked="" type="checkbox"/>	<input type="checkbox"/>
COMMENTS	Several locations showed visible erosion damage that needs to be addressed immediately.					
<b>SPECIAL WASTE APPROVAL PROCESS</b>						
<b>8300</b>	<b>MISHANDLING OF SPECIAL WASTE</b>	0400-11-01-.01(4)(d)1 <b>Citation</b>	?	<input checked="" type="checkbox"/>	<input type="checkbox"/>	<input type="checkbox"/>
COMMENTS						
<b>UNLAWFUL METHODS OF DISPOSAL</b>						
<b>8570</b>	<b>OPERATION DOES NOT CORRESPOND WITH ENGINEERING PLANS (EVALUATE AND RECORD THE APPROXIMATE INTERIOR AND EXTERIOR SLOPE OF THE LANDFILL)</b>	TCA68-211-104(3) TCA 68-211-105(b) <b>Citation</b>	?	<input checked="" type="checkbox"/>	<input type="checkbox"/>	<input type="checkbox"/>
COMMENTS						
<b>8580</b>	<b>OPERATION DOES NOT CORRESPOND WITH PERMIT CONDITIONS</b>	TCA 68-211-104(3) 0400-11-01-.02(5)(a)(1) <b>Citation</b>	?	<input checked="" type="checkbox"/>	<input type="checkbox"/>	<input type="checkbox"/>
COMMENTS						
<b>WASTE HANDLING AND COVER STANDARDS</b>						
<b>8430</b>	<b>WASTE NOT CONFINED TO A MANAGEABLE AREA</b>	0400-11-01-.04(6)(a)1 <b>Citation</b>	?	<input checked="" type="checkbox"/>	<input type="checkbox"/>	<input type="checkbox"/>
COMMENTS						

VIOLATION		REGULATION	OBSERVATION			
			NVO	AOC	V1	V2
<b>WASTE HANDLING AND COVER STANDARDS</b>						
<b>8440</b>	<b>IMPROPER SPREADING OF WASTE</b>	0400-11-01-.04(6)(a)2 <b>Citation</b>	?	<input checked="" type="checkbox"/>	<input type="checkbox"/>	<input type="checkbox"/>
COMMENTS						
<b>8450</b>	<b>IMPROPER COMPACTING OF WASTE</b>	0400-11-01-.04(6)(a)2 <b>Citation</b>	?	<input checked="" type="checkbox"/>	<input type="checkbox"/>	<input type="checkbox"/>
COMMENTS						
<b>8460</b>	<b>UNSATISFACTORY INITIAL COVER</b>	0400-11-01-.04(6)(a)3 0400-11-01-.04(6)(a)5 <b>Citation</b>	?	<input checked="" type="checkbox"/>	<input type="checkbox"/>	<input type="checkbox"/>
COMMENTS						
<b>8470</b>	<b>UNSATISFACTORY INTERMEDIATE COVER</b>	0400-11-01-.04(6)(a)4 0400-11-01-.04(6)(a)5 <b>Citation</b>	?	<input type="checkbox"/>	<input checked="" type="checkbox"/>	<input type="checkbox"/>
COMMENTS	Flagging litter is being addressed on site, efforts need to be continued to completion.					
<b>8480</b>	<b>UNSATISFACTORY FINAL COVER</b>	0400-11-01-.04(6)(a)6 0400-11-01-.04(8)(c)3(i) <b>Citation</b>	?	<input checked="" type="checkbox"/>	<input type="checkbox"/>	<input type="checkbox"/>
COMMENTS						
<b>8510</b>	<b>UNSATISFACTORY STABILIZATION OF COVER</b>	0400-11-01-.04(6)(a)5,6 <b>Citation</b>	?	<input checked="" type="checkbox"/>	<input type="checkbox"/>	<input type="checkbox"/>
COMMENTS						
<b>WASTE RESTRICTIONS</b>						
<b>8210</b>	<b>UNAUTHORIZED WASTE ACCEPTED</b>	0400-11-01-.04(2)(k)1 0400-11-01-.04(2)(k)6 <b>Citation</b>	?	<input checked="" type="checkbox"/>	<input type="checkbox"/>	<input type="checkbox"/>
COMMENTS						
<b>8220</b>	<b>UNAPPROVED SPECIAL WASTE ACCEPTED</b>	0400-11-01-.01(4)(b) 0400-11-01-.01(4)(c)5 <b>Citation</b>	?	<input checked="" type="checkbox"/>	<input type="checkbox"/>	<input type="checkbox"/>
COMMENTS						



\*SEE DISCLAIMER ON LAST PAGE

VIOLATION		REGULATION	OBSERVATION				
WASTE RESTRICTIONS							
8230	TIRES IMPROPERLY HANDLED	0400-11-01-.04(2)(k)3(i)	?	<input checked="" type="checkbox"/>	<input type="checkbox"/>	<input type="checkbox"/>	<input type="checkbox"/>
COMMENTS		Citation		X			
8240	MEDICAL WASTE IMPROPERLY HANDLED	0400-11-01-.04(2)(k)4(i-iv)	?	<input checked="" type="checkbox"/>	<input type="checkbox"/>	<input type="checkbox"/>	<input type="checkbox"/>
COMMENTS		Citation		X			

LEACHATE LEVELS

*\*Disclaimer: The information contained in these documents (checklists/notes, etc.) is not intended to be all inclusive and is subject to change. These documents are intended solely for use by DSWM staff. These documents are not a substitute for evaluation of compliance in accordance with applicable laws and regulations. These documents are not intended for, nor can they be relied upon, to create any rights, substantive or procedural, enforceable or useable by any party in litigation with the State of Tennessee or its employees.*

**SAVE FORM**

Follow-Up Inspection Date

Inspector Name Lewis L Haynes IV Digitally signed by Lewis L Haynes IV  
Date: 2023.06.09 11:45:04 -04'00'

ADDITIONAL COMMENTS



## Unsatisfactory records or reports

[BACK TO TOP](#)

Citation Reference: 0400-11-01-.02(5)(a)7

[CITATION](#)

Citation Reference: TCA 68-211-862(a)

[CLOSE](#)

Citation Reference: 0400-11-01-.04(7)(a)4(vii)

[CLOSE](#)

Citation Reference: 0400-11-01-.04(2)(k)3(i)(II)VI

[CLOSE](#)

Citation Reference: 0400-11-01-.04(2)(s)

[CLOSE](#)

Citation Reference: 0400-11-01-.01(4)(d)2

[CITATION](#)

Citation Reference: 0400-11-01-.02(3)(a)4

[CLOSE](#)

Citation Reference: 0400-11-01-.02(5)(a)9

[CLOSE](#)

Citation Reference: 0400-11-01-.08(3)

[CLOSE](#)