

**LOUDON COUNTY COMMISSION**  
**REGULAR MEETING**  
**January 09, 2006**

- |      |  |                            |
|------|--|----------------------------|
| (1)  | Public Hearing                                       |                            |
| (2)  | Opening Of Meeting                                   |                            |
| (3)  | Roll Call  |                            |
| (4)  | Agenda Adopted                                       |                            |
| (5)  | Minutes for December 05, 2005 Approved               |                            |
| (6)  | Comments: Agenda Items                               |                            |
| (7)  | Pine Grove Providence Road Rezoning Denied           | <u>Exhibit A</u>           |
| (8)  | Jackson Bend Road Rezoning Resolution Adopted        | <u>Resolution 010906-B</u> |
| (9)  | Road List 2006 Adopted                               | <u>Exhibit C</u>           |
| (10) | EDA Public Act 1101 Resolution Adopted               | <u>Resolution 010906-D</u> |
| (11) | Hospital Traffic Light Resolution Adopted            | <u>Resolution 010906-E</u> |
| (12) | General Fund 101 Budget Amendments Approved          | <u>Exhibit F</u>           |
| (13) | Capital Projects Fund 171 Budget Amendments Approved | <u>Exhibit G</u>           |
| (14) | Debt Service Fund 151 Budget Amendments Approved     | <u>Exhibit H</u>           |
| (15) | School Fund Budget Amendments Approved               | <u>Exhibit I</u>           |
| (16) | Attorney Report                                      |                            |
| (17) | Notaries Approved                                    |                            |
| (18) | Comments: Non-Agenda Items                           |                            |
| (19) | Adjournment  |                            |

**LOUDON COUNTY COMMISSION  
STATE OF TENNESSEE  
COUNTY OF LOUDON**

**January 09, 2006**

**6:00 PM**

**PUBLIC HEARING**

**(1)  
Public  
Hearing**

1. Request consideration of rezoning approximately 85 acres of property located at Pine Grove Providence Road and Estes Road, from A-1, Agriculture-Forestry District, to R-1, Suburban-Residential District, referenced by Tax Map 18, part of Parcel 52.01, 5<sup>th</sup> Legislative District. Owner: Extreme Properties.  
**James L. McAnally, Ken Hayse, Steve Smith, Bryan West, Stewart Crane and Shane Frank**, area property owners, came forward to speak in opposition of this request.  
**Commissioners Duff and Shaver** made comments regarding proposed development.
2. Request consideration of rezoning approximately 5.55 acres of property located on Jackson Bend Road, from R-1, Suburban-Residential District, to C-2, General Commercial District, referenced by Tax Map 27, Parcel 106.00, 3<sup>rd</sup> Legislative District. Owner: Frances Scott.  
**No one** came forward to speak.

**REGULAR MEETING**

**(2)  
Opening  
Of Meeting**

**BE IT REMEMBERED** that the Board of Commissioners of Loudon County convened in regular session in Loudon, Tennessee on the 9<sup>th</sup> day of January, 2006.  
The **Honorable Roy Bledsoe** called the meeting to order.  
**Officer Sonny Routson** opened Court, led the Pledge of Allegiance to the Flag of the United States of America and gave the invocation.

**(3)  
Roll Call**

Present were the following Commissioners: **Marcus, Meers, Jenkins, Maples, Bledsoe, Duff, Shaver, Harold and Miller: (9).**  
The following Commissioner was absent: **Franke: (1).**  
Thereupon **Chairman Bledsoe** announced the presence of a quorum. Also present were the **Honorable George Miller, County Mayor** and **Loudon County Attorney Harvey Sproul.**

**(4)  
Agenda  
Adopted**

**Chairman Bledsoe** requested that the January 09, 2006 agenda be adopted.  
**Mayor Miller** stated that the Cable TV Authority requested that budget amendment consideration relating to their department be deferred, no action was taken.  
**Mayor Miller** requested that Item 6A1, "*Consideration of adopting a resolution honoring our members of the Tennessee National Guard*" be deferred until February.  
**Commissioner Shaver** requested that items under 6D, "*Loudon County Planning and Community Development – Russ Newman*" be moved to the beginning of the agenda.  
A **motion** was made by **Commissioner Shaver** with a second by **Commissioner Miller** to adopt agenda with requested two (2) changes.  
Upon voice vote the motion **Passed** unanimously.

**(5)  
Minutes for  
December 05,  
2005  
Approved**

**Chairman Bledsoe** requested that the December 05, 2005 County Commission Meeting minutes be approved and accepted.  
A **motion** was made by **Commissioner Shaver** with a second by **Commissioner Maples** to adopt minutes as presented.  
Upon voice vote the motion **Passed** unanimously.

**(6)  
Comments:  
Agenda  
Items**

**Chairman Bledsoe** asked for any visitor wishing to address the Commission regarding items on the planned agenda to come forward.  
**No one** came forward to speak.



(7)  
Pine Grove  
Providence  
Road  
Rezoning  
Denied

**Russ Newman, Loudon County Planning and Community Development**, requested discussion and possible action on the following items:

1. Consideration of adopting a resolution rezoning property located at Pine Grove Providence Road and Estes Road (Public Hearing Item 1).

A **motion** was made by **Commissioner Shaver** with a second by **Commissioner Duff** to deny this resolution.

Upon voice vote the motion **Passed** unanimously.

**Exhibit A** (Recess 6:53 pm – 6:58 pm)

(8)  
Jackson  
Bend Road  
Rezoning  
Resolution  
Adopted

2. Consideration of adopting a resolution rezoning property located on Jackson Bend Road (Public Hearing Item 2).

A **motion** was made by **Commissioner Shaver** with a second by **Commissioner Duff** to adopt this resolution.

Upon voice vote the motion **Passed** unanimously.

**Resolution 010906-B**

(9)  
Road List  
2006  
Adopted

**George Miller, Loudon County Mayor**, requested consideration of adopting the 2006 Loudon County Road List.

A **motion** was made by **Commissioner Shaver** with a second by **Commissioner Meers** to adopt the 2006 Loudon County Road List.

Upon voice vote the motion **Passed** unanimously.

**Exhibit C**

(10)  
EDA Public  
Act 1101  
Resolution  
Adopted

**Kathy Knight, Loudon County Economic Development Agency**, requested consideration of adopting a resolution certifying the Loudon County Economic Development Agency as the local Joint Economic and Community Development Board as required by Public Act 1101.

A **motion** was made by **Commissioner Marcus** with a second by **Commissioner Meers** to adopt this resolution.

Upon voice vote the motion **Passed** unanimously.

**Resolution 010906-D**

(11)  
Hospital  
Traffic Light  
Resolution  
Adopted

**Chairman Bledsoe** gave chair to **Chair Pro Tempore Maples**.

A **motion** was made by **Commissioner Bledsoe** with a second by **Commissioner Jenkins** to adopt a resolution in support of traffic light at Fort Loudoun Medical Center Drive and Highway 321 to safeguard public health.

Upon voice vote the motion **Passed** unanimously.

**Resolution 010906-E**

**Chairman Maples** returned chair to **Chairman Bledsoe**.

(12)  
General  
Fund 101  
Budget  
Amendments  
Approved

**Tracy Blair, Loudon County Director of Accounts and Budgets**, requested consideration and possible action on the following items:

1. Consideration of approving budget amendments to County General Fund 101 (Sheriff's Department, Library Board, Employee Insurance and Cable TV).

A **motion** was made by **Commissioner Shaver** with a second by **Commissioner Jenkins** to approve budget amendments.

Upon roll call vote the following Commissioners voted **Aye: Marcus, Meers, Jenkins, Maples, Bledsoe, Duff, Shaver, Harold and Miller: (9).**

The following Commissioners voted **Nay: (0).**

The following Commissioner was **Absent: Franke: (1).**

Thereupon the Chairman announced the motion **Passed: (9-0-1).**

**Exhibit F**

*Note: Listed on the agenda was "Building Commissioner (pending recommendation from January 05 Special Called Budget Committee meeting). There was no Budget Committee recommendation for this item, and no action was taken.*

(13)  
Capital  
Projects  
Fund 171  
Budget  
Amendments  
Approved

2. Consideration of approving budget amendments to General Capital Projects Fund 171.

A **motion** was made by **Commissioner Maples** with a second by **Commissioner Meers** to approve budget amendments.

Upon roll call vote the following Commissioners voted **Aye: Marcus, Meers, Jenkins, Maples, Bledsoe, Duff, Shaver, Harold and Miller: (9).**

The following Commissioners voted **Nay: (0).**

The following Commissioner was **Absent: Franke: (1).**

Thereupon the Chairman announced the motion **Passed: (9-0-1).**

**Exhibit G**



(14)  
Debt Service  
Fund 151  
Budget  
Amendments  
Approved

3. Consideration of approving budget amendments to General Debt Service Fund 151.  
A **motion** was made by **Commissioner Marcus** with a second by **Commissioner Meers** to approve budget amendments.  
Upon roll call vote the following Commissioners voted **Aye: Marcus, Meers, Jenkins, Maples, Bledsoe, Duff, Shaver, Harold and Miller: (9).**  
The following Commissioners voted **Nay: (0).**  
The following Commissioner was **Absent: Franke: (1).**  
Thereupon the Chairman announced the motion **Passed: (9-0-1).**

**Exhibit H**

(15)  
School Fund  
Budget  
Amendments  
Approved

4. Consideration of approving budget amendments to General Purpose School Fund.  
A **motion** was made by **Commissioner Duff** with a second by **Commissioner Meers** to approve budget amendments.  
Upon roll call vote the following Commissioners voted **Aye: Marcus, Meers, Jenkins, Maples, Bledsoe, Duff, Shaver, Harold and Miller: (9).**  
The following Commissioners voted **Nay: (0).**  
The following Commissioner was **Absent: Franke: (1).**  
Thereupon the Chairman announced the motion **Passed: (9-0-1).**

**Exhibit I**

(16)  
Attorney  
Report

**Harvey Sproul, Loudon County Attorney**, had no report.

(17)  
Notaries  
Approved

A **motion** was made by **Commissioner Meers** with a second by **Commissioner Shaver** to approve the following notaries: *Whitney L. Cardin, Joel D. Malone, Michelle Lynn Coggins, Janice T. Parks, Edward Gene Stiltner, Aimee A. Camp, Rhonda Kay Shelton, Megan Marie Migliallio, Alfonso Oscar Marquez, Judith D. White, Jeanie Watson, Tammy Watkins.*  
Upon voice vote the motion **Passed** unanimously.

(18)  
Comments:  
Non-Agenda  
Items

**Chairman Bledsoe** asked for any visitor wishing to address the Commission regarding items not on the agenda to come forward.  
**Commissioner Shaver** announced that the Merit Services Board will meet on January 18, 6:00 pm at Roane State.  
**Commissioner Meers** announced that grand opening of the animal shelter will be held on January 16, 4:00 pm.  
**Commissioner Jenkins** announced that the Zoning Regulations Study Committee will meet on February 02, 4:30 pm at Roane State.

(19)  
Adjournment

There being no further business, a **motion** being duly made and seconded, the January 09, 2006 meeting stood adjourned at 7:34 p.m.

  
CHAIRMAN

ATTEST:

  
COUNTY CLERK

  
COUNTY MAYOR



**Exhibit A**

**RESOLUTION**

**A RESOLUTION AMENDING THE ZONING MAP OF LOUDON COUNTY, TENNESSEE, PURSUANT TO CHAPTER SEVEN, §13-7-105 OF THE TENNESSEE CODE ANNOTATED, TO REZONE PROPERTY LOCATED AT THE INTERSECTION OF PINE GROVE PROVIDENCE ROAD AND ESTES ROAD, CONTAINING APPROX 85 ACRES, SITUATED IN THE 5TH LEGISLATIVE DISTRICT, REFERENCED BY TAX MAP 18, PART OF PARCEL 52.01, FROM A-1, AGRICULTURE FORESTRY DISTRICT, TO R-1, SUBURBAN-RESIDENTIAL DISTRICT**

**WHEREAS**, the Loudon County Commission, in accordance with Chapter Seven, §13-7-105 of the Tennessee Code Annotated, may from time to time, amend the number, shape, boundary, area or any regulation of or within any district or districts, or any other provision of any zoning resolution, and

**WHEREAS**, the Regional Planning Commission has forwarded a recommendation regarding the amendment to the Zoning Map of Loudon County, Tennessee,

**WHEREAS**, a notice of public hearing and a description of the resolution appeared in the Loudon County News Herald on November 3/4, 2005, consistent with the provisions of Tennessee Code Annotated, §13-7-105,

**NOW, THEREFORE, BE IT RESOLVED** by the Loudon County Commission that the Zoning Map of Loudon County, Tennessee be amended as follows:

That property located at Pine Grove Providence Road and Estes Road, containing approximately 85 acres, situated in the 5th Legislative District, referenced by Tax Map 18, part of Parcel 52.01, from A-1, Agriculture-Forestry District, to R-1, Suburban-Residential District; as shown on the attached map; said map being part of this Resolution.

**BE IT FINALLY RESOLVED**, that this Resolution shall take effect immediately, the public welfare requiring it.

\_\_\_\_\_  
ATTEST

\_\_\_\_\_  
LOUDON COUNTY CHAIRMAN  
DATE: \_\_\_\_\_

\_\_\_\_\_  
APPROVED: LOUDON COUNTY MAYOR

The votes on the question of approval of this Resolution by the Loudon County Commission is as follows:

APPROVED: \_\_\_\_0\_\_\_\_

DISAPPROVED: \_\_\_\_9\_\_\_\_

\_\_\_\_\_  
ATTEST: SECRETARY LOUDON COUNTY  
REGIONAL PLANNING COMMISSION  
Dated: November 22, 2005



Loudon County Commission  
January 9, 2005  
Item B

Request consideration of rezoning approximately 85 acres of property located at Pine Grove Providence Road and Estes Road, from A-1, Agriculture-Forestry District, to R-1, Suburban Residential District, referenced by Tax Map 18, part of Parcel 52.00.

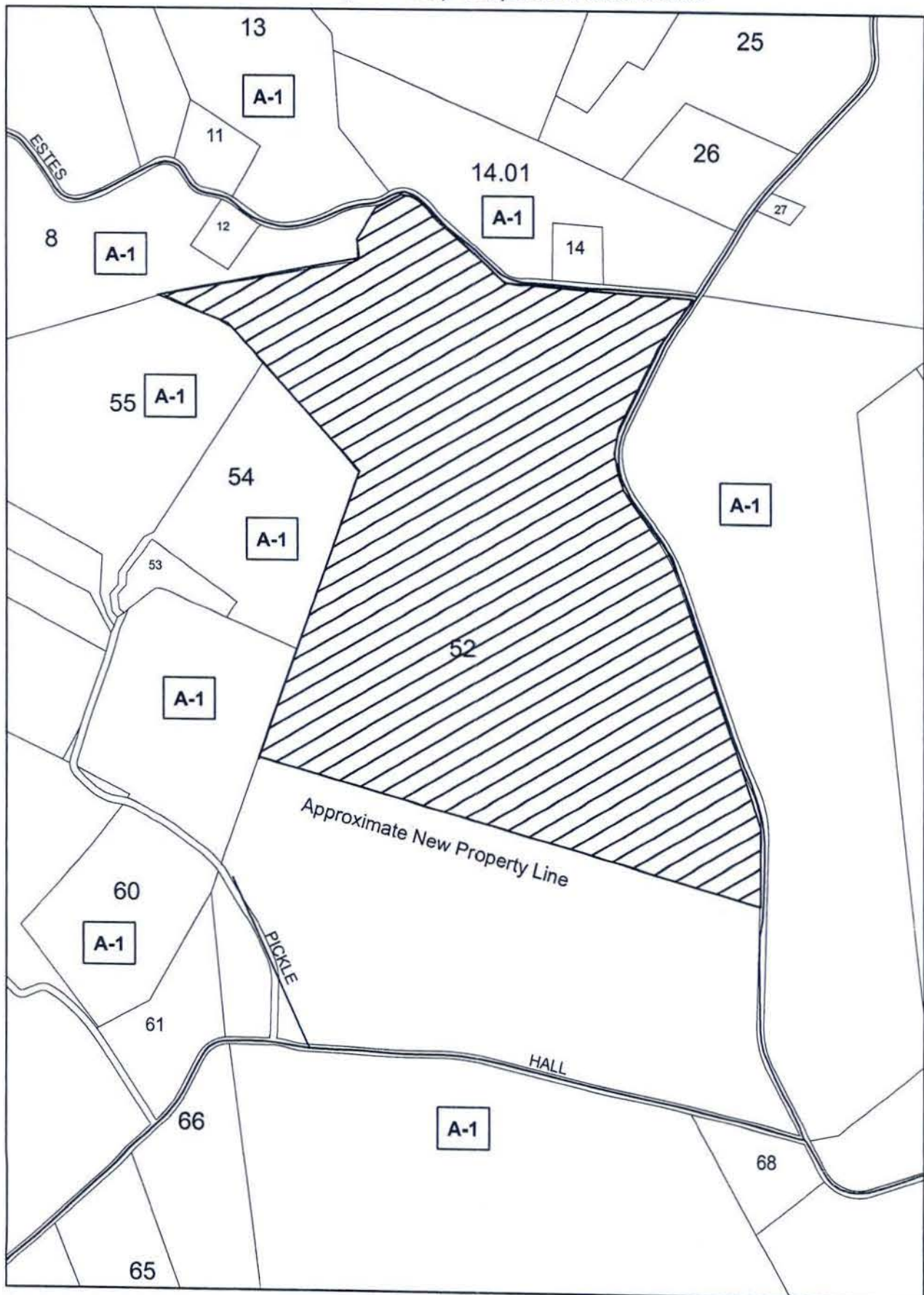



**Resolution 010906-B**

**RESOLUTION**

**A RESOLUTION AMENDING THE ZONING MAP OF LOUDON COUNTY, TENNESSEE, PURSUANT TO CHAPTER SEVEN, §13-7-105 OF THE TENNESSEE CODE ANNOTATED, TO REZONE PROPERTY LOCATED ON JACKSON BEND ROAD, APPROXIMATELY 5.5 ACRES, SITUATED IN THE THIRD LEGISLATIVE DISTRICT, REFERENCED BY TAX MAP 27, PARCEL 106.00, FROM R-1, SUBURBAN RESIDENTIAL DISTRICT, TO C-2, GENERAL COMMERCIAL DISTRICT**

**WHEREAS**, the Loudon County Commission, in accordance with Chapter Seven, §13-7-105 of the Tennessee Code Annotated, may from time to time, amend the number, shape, boundary, area or any regulation of or within any district or districts, or any other provision of any zoning resolution, and

**WHEREAS**, the Regional Planning Commission has forwarded a recommendation regarding the amendment to the Zoning Map of Loudon County, Tennessee,

**WHEREAS**, a notice of public hearing and a description of the resolution appeared in the Loudon County News Herald on December 4/5, 2005, consistent with the provisions of Tennessee Code Annotated, §13-7-105,

**NOW, THEREFORE, BE IT RESOLVED** by the Loudon County Commission that the Zoning Map of Loudon County, Tennessee be amended as follows:

That Property located on Jackson Bend Road, approximately 5.5 acres, situated in the Third Legislative District, referenced by Tax Map 27, Parcel 106.00, from R-1, Suburban Residential District, to C-2, General Commercial District; as shown on the attached map; said map being part of this Resolution.

**BE IT FINALLY RESOLVED**, that this Resolution shall take effect immediately, the public welfare requiring it.

ATTEST

APPROVED: LOUDON COUNTY MAYOR

LOUDON COUNTY CHAIRMAN

DATE: 11/09/06

The votes on the question of approval of this Resolution by the Planning Commission is as follows:

APPROVED: 7

APPROVED: 9

DISAPPROVED: 0

DISAPPROVED: 0

ATTEST: SECRETARY, LENOIR CITY  
REGIONAL PLANNING COMMISSION  
Dated: November 22, 2005

ATTEST: SECRETARY, LOUDON  
COUNTY REGIONAL PLANNING  
COMMISSION Dated: December 6, 2005



Loudon County Commission  
January 9, 2005  
Item A

Request consideration of rezoning approximately 5.55 acres of property located on Jackson Bend Road from R-1, Suburban Residential District, to C-2, General Commercial District, referenced by Tax Map 27, Parcel 106.00, 3rd Legislative District. Owner: Frances Scott

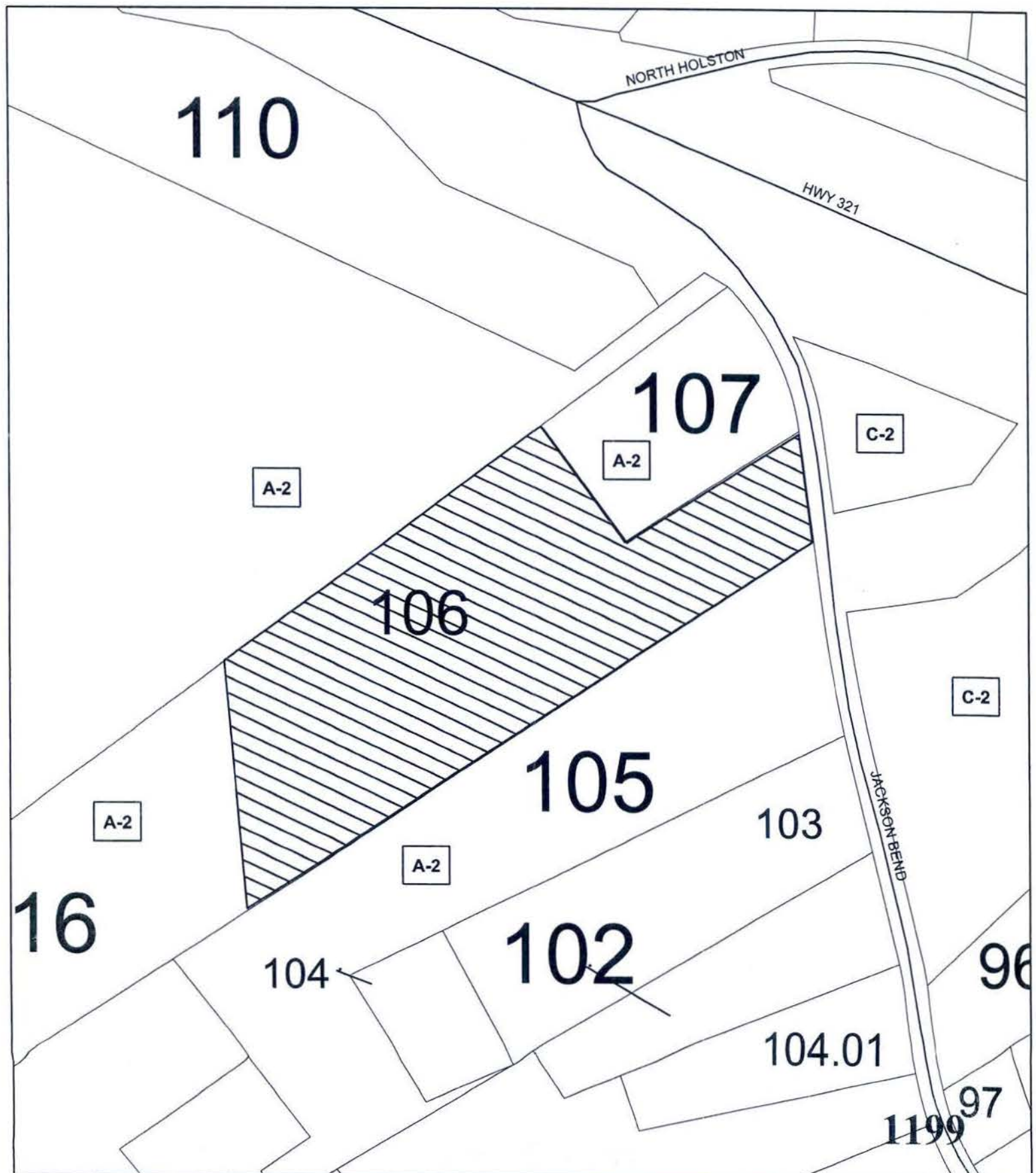



**Exhibit C**

LOUDON COUNTY ROAD LIST

JANUARY 9, 2005



ADOPTED RESOLUTION 010906  
LOUDON COUNTY ROAD LIST

DON PALMER,  
ROAD SUPERINTENDENT

CLASS 1 - 24'-100'  
CLASS 2 - 18'-40'  
CLASS 3 - 14'-30'  
CLASS 4 - 10'-20'



LOUDON COUNTY ROAD LIST

ROAD NAME

01/09/2006

A

LENGTH MILES	COUNTY OR STATE AID	CLASS AND WIDTH	ROAD BED WIDTH	RIGHT OF WAY WIDTH	CURBED SUBDIV DEAD END
-----------------	---------------------------	-----------------------	-------------------	--------------------------	------------------------------

ABBOTT CROSSING LN	0.9 CO.	3-26'			
ADKINS ROAD	0.2 CO.				
ALLEN ROAD	0.2 CO.	3-16'	18'		
ALLEN SHORE DRIVE	0.5 CO.				DE
ALLISON TOWN ROAD	0.6 CO.				
ALPINE DRIVE	0.1 CO.				
ANGLEWOOD DRIVE	0.2 CO.	3-23'	.....	.....	CURB-DE
ANTIOCH CHURCH ROAD E	2.7 SA				
ANTIOCH CHURCH ROAD W	2.4 CO.				
APPLEBY LANE	0.2 CO.				
ASHFORD LN	0.1 CO.	4-20'			
AVERY CIRCLE	0.7 CO.	3-26'	.....	.....	CURB
AVERY STREET	0.2 CO.	3-26'	.....	.....	CURB
AXLEY CHAPEL ROAD	2.2 CO.				

B

BAILEYS ROAD	0.2 CO.				
BARCLAYS COURT	0.1 CO.				
BARGER ROAD	0.1 CO.	3-15'	16'		CURB-DE
BARKMOOR DRIVE	0.3 CO.				DE
BARR ROAD	0.3 CO.				DE
BARRIER DRIVE	0.2 CO.				
BAT CREEK ROAD	1.1 CO.				
BAT CREEK ROAD E	1.3 CO.				
BAXTER BRIGHT ROAD	0.4 CO.				

PAGE 1 OF 40



LOUDON COUNTY ROAD LIST  
1/9/2006

ROAD NAME	LENGTH MILES	COUNTY OR STATE AID	CLASS AND WIDTH	ROAD BED WIDTH	RIGHT OF WAY WIDTH	CURBED SUBDIV DEAD END
B						
BEALS CHAPEL ROAD	2.8	CO.	3-18'			DE
BEALS CHAPEL ROAD	2.8	SA	3-21'	22'		
BEALS LANDING LANE	0.2	CO.	3-24'	24'	50 FT	.....
BEELER LOOP ROAD	0.4	CO.				CURBED
BELL ROAD N	0.8	CO.				
BELL ROAD S	0.8	CO.				
BELL VIEW ROAD	0.7	CO.				
BENJAMIN DRIVE	0.2	CO.				
BIG HILL ROAD	1.9	CO.				
BIG SANDY ROAD	6.1	CO.				
BILL SMITH ROAD	0.4	CO.				
BIRD ROAD	1.2	SA				
BISHOP ROAD	1.1	CO.				
BLACK ROAD	1	CO.				
BLACKBERRY RIDGE DRIVE	0.7	CO.	3-26'	.....	.....	CURB-DE
BLAIR ROAD		CO.				
BLUE HERRON DRIVE	0.1	CO.	3-24'	.....	.....	CURB-DE
BLUE SPRINGS ROAD	3.8	SA				
BLUE TICK LANE	0.4	CO.				DE

LOUDON COUNTY ROAD LIST  
1/9/2006

ROAD NAME	LENGTH	COUNTY	CLASS	ROAD BED	RIGHT OF	CURBED
B	MILES	OR	AND	WIDTH	WAY	SUBDIV
		STATE AID	WIDTH		WIDTH	DEAD END
BONA VISTA LANE	0.1	CO.				
BRADSHAW HOLLOW ROAD	0.8	CO.				
BRANCH ROAD	1.1	CO.				
BRANDON DRIVE	0.1	CO.	3-16'	16'		
BRANDYWINE DRIVE	1.1	CO.				
BRANNON ROAD	0.1	CO.				
BREAZEALE ROAD	1.9	CO.				
BRENTWOOD PLACE ROAD	0.1	CO.	3-26'			
BREWSTER ROAD	0.1	CO.				
BRIGHT ROAD	2.2	CO.				
BROOK ROAD	1.6	CO.				
BROOKVIEW ROAD	0.8	CO.				
BROWDER HOLLOW ROAD	1.6	CO.				
BROWDER SCHOOL ROAD	0.2	CO.				
BURL ANDERSON ROAD	0.2	CO.				
BURNETTE CIRCLE	0.4	CO.				
BUSTER BLVD	0.1	CO.	4-12'	16'		
BUTTERMILK ROAD	5.1	SA				DE
BUTTERMILK ROAD W	0.5	CO.				



LOUDON COUNTY ROAD LIST  
1/9/2006

ROAD NAME	LENGHT MILES	COUNTY OR STATE AID	CLASS AND WIDTH	ROAD BED WIDTH	RIGHT OF WAY WIDTH	CURBED SUBDIV DEAD END
C						
C & C ROAD	0.2 CO.					DE
CABE ROAD	0.5 CO.					
CALDWELL ROAD	1.3 CO.					
CALLOWAY CIRCLE	0.8 CO.		3-26'	.....	.....	CURB
CALLOWAY DRIVE	0.5 CO.		3-26'	.....	.....	CURBED
CALLOWAY ROAD	2.6 CO.					
CAMERON LANE	0.1 CO.		3-22'	.....	.....	CURB-DE
CARDINAL VIEW COURT	0.1 CO.					CURB-DE
CARDWELL CHAPEL ROAD	1.5 CO.					
CARPENTER LOOP	1.1 CO.					
CARTER DRIVE(ANNEXED L.C.)	0.2 CO.					
CARTER ROAD	0.4 CO.					
CARTER'S CHAPEL ROAD	1.3 SA					
CASEY LANE	0.1 CO.		3-22'	.....	.....	CURB-DE
CATTLEMAN'S DRIVE	0.2 CO.		3-25'	.....	.....	CURB-DE
CECIL WEBB ROAD	0.5 CO.					
CEDAR CIRCLE	0.6 CO.		3-25'	.....	.....	CURBED
CEDAR PARK DRIVE	0.2 CO.		4-16'	18'		DE
CEMETERY ROAD	0.4 CO.					
CHELSEA CIRCLE	0.1 CO.		.....	.....	.....	CURB-DE

PAGE 4 OF 40

LOUDON COUNTY ROAD LIST  
1/9/2006

ROAD NAME	LENGTH MILES	COUNTY OR STATE IAD	CLASS AND WIDTH	ROAD BED WIDTH	RIGHT OF WAY WIDTH	CURBED SUBDIV DEAD END
C						
CHILI LANE	0.1	CO.				
CHRISMAN ROAD	0.2	CO.				
CIRCLE DRIVE	0.4	CO.				
CLARKE ROAD	0.4	CO.				
CLAY HOLLOW ROAD	1.1	CO.				
CLEAR BRANCH ROAD N	0.5	CO.				
CLEAR BRANCH ROAD S	0.3	CO.				
CLEAR COVE COURT	0.1	CO.	3-24'	.....	.....	
CLINCHVIEW DRIVE	0.1	CO.				CURB-DE
CLOYD'S CREEK ROAD	0.2	CO.				
CLUB DRIVE	0.4	CO.				
COLUMBUS DRIVE	1.2	CO.				CURBED
CONKINNON DRIVE	1.3	CO.	3-24'	.....	.....	CURBED
CONMASTER ROAD	0.3	CO.				CURBED
COOK DRIVE	0.3	CO.				
COPE ROAD	0.2	CO.				
CORDOVA LANE	0.1	CO.				
CORINTH CHURCH ROAD	1.5	CO.				CURBED
CORINTH ROAD	1.4	CO.				
CORNETT ROAD	0.4	CO.				

PAGE 5 OF 40



LOUDON COUNTY ROAD LIST  
1/9/2006

ROAD NAME	LENGTH MILES	COUNTY OR STATE AID	CLASS AND WIDTH	ROAD BED WIDTH	RIGHT OF WAY WIDTH	CURBED SUBDIV DEAD END
<b>C</b>						
COSTNER ROAD	0.2	CO.				
COULTER SHOALS CIRCLE	0.7	CO.	3-19'			
COUNTY RD 299	0.1	CO.		.....	.....	.....
COVENANT CIRCLE	0.4	CO.	3-24'			
COVE VIEW LANE	0.1	CO.	3-23'			CURBED
COX ROAD	0.2	CO.				CURB-DE
COYTEE ROAD	1.3	CO.				
CRANFIELD LANE	0.1	CO.	3-16'	18'		DE
CREEKWOOD COURT	0.1	CO.	3-24'	.....	.....	CURB-DE
CRESCENT DRIVE	0.2	CO.				
CRESS LANE	0.3	CO.	3-17'	19'		DE
CRESTVIEW CIRCLE	0.6	CO.	3-26'	.....	.....	CURB
CRESTVIEW DRIVE	0.1	CO.	3-18'			
CROCK ROAD	0.9	CO.				.....
CRUZE ROAD	0.9	CO.				DE
CUDDIE LANE	0.1	CO.				
CUSICK CIRCLE	0.6	CO.	3-19'	21'		
CUSICK LANE	0.1	CO.	3-19'	21'		DE
<b>D</b>						
DAILEY AVE	1.1	CO.				
DAIRY LANE	0.3	CO.	3-26'	.....	.....	CURB
DAVIS DAIRY ROAD	0.3	CO.				
DAVIS DRIVE	0.3	CO.	3-15'	16'		DE
DAVIS FERRY ROAD	2.8	SA				

PAGE 6 OF 40

LOUDON COUNTY ROAD LIST  
1/9/2006

ROAD NAME	LENGTH MILES	COUNTY OR STATE AID	CLASS AND WIDTH	ROAD BED WIDTH	RIGHT OF WAY WIDTH	CURBED SUBDIV DEAD END
D						
DAVIS RIDGE ROAD		0.4 CO.				
DAVIS LANE		0.9 CO.				
DAWSON ROAD		0.8 CO.				DE
DEADEND ROAD		0.5 CO.				
DEATON ROAD		0.3 CO.	3-13'			
DEERFIELD COURT		0.1 CO.				DE
DEERFIELD LN		0.5 CO.				CURB-DE
DERBY CHASE DRIVE	4070'	CO.	3-22'	22'	50'	
DEWITT DRIVE		0.4 CO.	3-15'	16'		
DIXIE LEE CIRCLE		0.7 CO.			.....	DE
DIXIE LEE LANE		0.1 CO.				
DIXON ROAD		0.7 CO.	3-22'	22'		DE
DOGWOOD LANE		0.1 CO.	4-16'	20'		.....
DOGWOOD LANE E		0.1 CO.	3-24'	.....		DE
DONNA DRIVE		0.4 CO.			.....	CURB-DE
DONALDSON LIGHT LANE		0.2 CO.				
DOTSON HILL ROAD		0.3 CO.				DE
DOTSON ROAD		0.3 CO.				
DOWNING COURT		0.1 CO.				
DRIFTWOOD COURT		0.1 CO.	3-24'	.....		CURB-DE
DRY BRANCH ROAD		0.3 CO.			.....	CURB-DE
DRY RIDGE ROAD		1.7 CO.				
DRY VALLEY ROAD		2.4 SA				
DUGGAN ROAD		0.1 CO.				
DUNCAN ROAD		0.6 CO.	4-13'	13'		DE
DUNRIDGE LANE		0.1 CO.	3-26'	.....		.....
DUNSMORE ROAD		0.3 CO.				CURB-DE
DUTTON ROAD		1.1 CO..				

PAGE 17 OF 40



LOUDON COUNTY ROAD LIST  
01/09/2006

ROAD NAME	LENGTH MILES	COUNTY OF STATE AID	CLASS AND WIDTH	ROAD BEI WIDTH	RIGHT OF WAY WIDTH	CURBED SUBDIV DEAD END
E						
EAST COAST TELLICO PKWY	5.7	SA				
EASTER DRIVE	0.2	CO.				
EASTER RIDGE ROAD	0.3	CO.	3-17'	20'		
EASTMAN DRIVE	2.5	CO.				.....
EBLEN ROAD	0.2	CO.				
ECHO HOLLOW ROAD	0.4	CO.				
EDGE LANE	0.2	CO.				
EDITH LANE	0.5	CO.				
EDWARDS SCHOOL ROAD	0.5	CO.				
EL CAMINO LANE	0.4	CO.				
ELLIS ROAD	0.3	CO.				DE
ENGEL ROAD	0.4	CO.				
ERIE ROAD	2.6	CO.				
ESTES ROAD	1.4	CO.				.....
EVERGREEN CIRCLE	0.2	CO.				
F						
FAIRVIEW DRIVE	0.1	CO.	3-16'	18'		DE
FAIRVIEW ROAD	1.7	CO.				
FAIRWAY DRIVE	0.2	CO.				
FISHER LANE	1.8	CO.				CURBED
FISHERMAN COVE LANE	0.2	CO.	2-16'			

PAGE 8 OF 40

LOUDON COUNTY ROAD LIST  
01/09/2006

ROAD NAME	LENGTH MILES	COUNTY OR STATE AID	CLASS AND WIDTH	ROAD BED WIDTH	RIGHT OF WAY WIDTH	CURBED SUBDIV DEAD END
F						
FALCON FIRE COURT		CO.				
FALCON HEAD COURT		CO.				
FLATWOODS ROAD	1.6	CO.				
FORD ROAD	1.7	SA	3-20'	20'		
FORE DRIVE	0.1	CO.				.....
FOREST HEIGHTS CIRCLE	1	CO.				CURBED
FOREST HILLS DRIVE	0.1	CO.	3-20'	.....	.....	.....
FORK CREEK ROAD	3	CO.				
FORK ROAD	0.1	CO.				
FORTNER ROAD	0.1	CO.				
FOSHEE ROAD	1.5	CO.				
FOSTER DRIVE	0.4	CO.	3-26'	.....	.....	CURB
FOSTER ROAD	1.2	CO.				
FOUNTAIN HEAD COURT	0.1	CO.				CURB-DE
FOUTE TOWN ROAD	0.2	CO.	4-12'	13'		DE
FOX HUNTERS ROAD	0.4	CO.	4-13'	13'		DE
FRANKLIN ESTATES LN	0.4	CO.	3-25'			
FRIENDSHIP ROAD	0.5	CO.				
FRIENDSVILLE ROAD	2.5	CO.				
G						
GALLAHER ROAD	0.3	CO.				
GALYON DRIVE	0.1	CO.				
GALYON ROAD	0.6	CO.				
GAP ROAD	1.1	CO.				



LOUDON COUNTY ROAD LIST  
01/09/2006

ROAD NAME	LENGTH MILES	COUNTY OR STATE AID	CLASS AND WIDTH	ROAD BED WIDTH	RIGHT OF WAY WIDTH	CURBED SUBDIV DEAD END
<b>G</b>						
GASTON ROAD	0.2	CO.				
GENTRY DRIVE	0.2	CO.				
GENTRY ROAD	0.8	CO.				
GET GOOD HOLLOW ROAD	1.8	CO.				
GIFFIN CIRCLE	0.4	CO.				
GILBERT LANE	0.5	CO.				
GILES ROAD		CO.				DE
GLENDALE COMMUNITY ROAD	1.5	CO.				
GLEN MAR DRIVE	0.4	CO.	3-24'	.....	.....	CURB-DE
GRANDVIEW DRIVE(LC)	0.3	CO.	3-26'	.....	.....	CURB
GRANDVIEW DRIVE(LO)	0.4	CO.				
GRAPE TREE COURT		CO.				
GREEN DRIVE	0.5	CO.				CURBED
GRIFFITS KEEP COURT	0.2	CO.				
GRIMES ROAD	1.9	CO.				CURBED
GRUBB LANE	0.1	CO.				
GRUBB ROAD	0.8	CO.				
GRYDER LANE	0.6	CO.				
<b>H</b>						
HACKNEY CHAPEL ROAD	0.7	CO.				
HALL ROAD	1	CO.				
HALL STREET	0.7	CO.	4-16'			
HAMMONTREE LANE	0.3	CO.				
HAPPY HOLLOW ROAD	2.7	SA				
HARBOR POINT COURT	0.1	CO.	3-24'	.....	.....	CURB-DE
HARBOUR PLACE	0.1	CO.	3-23'	.....	.....	CURB-DE

PAGE 10 OF 40

LOUDON COUNTY ROAD LIST  
01/09/2006

ROAD NAME	LENGTH MILES	COUNTY OR STATE AID	CLASS AND WIDTH	ROAD BED WIDTH	RIGHT OF WAY WIDTH	CURBED SUBDIV DEAD END
H						
HARBOUR VIEW DRIVE	0.7	CO.	3-23'	.....	.....	CURB-DE
HARDIN DRIVE	0.4	CO.	4-19'	23'	.....	.....
HARMON LANE	0.2	CO.	.....	.....	.....	.....
HARRIS ROAD	1.5	CO.	.....	.....	.....	.....
HARRISON LANE	1	CO.	.....	.....	.....	.....
HARRISON ROAD	2.4	CO.	.....	.....	.....	.....
HATLEY DRIVE	0.3	CO.	.....	.....	.....	.....
HEATHER LANE	0.1	CO.	.....	.....	.....	.....
HEATON ROAD	0.3	CO.	.....	.....	.....	.....
HEWINS ROAD	0.3	CO.	4-13'	14'	.....	DE
HICKEY DRIVE	2.6	CO.	.....	.....	.....	.....
HICKORY CREEK ROAD	2.6	SA	.....	.....	.....	.....
HICKORY VALLEY ROAD	0.4	CO.	.....	.....	.....	.....
HIDDEN VALLEY LANE	0.1	CO.	4-16'	20'	.....	DE
HIDDEN VALLEY ROAD	0.1	CO.	4-16'	20'	.....	.....
HIGHLAND AVENUE	0.6	CO.	.....	.....	.....	.....
HILLSBOROUGH LN	0.2	CO.	3-22'	.....	.....	.....
HILLTOP DR	0.8	CO.	3-24'	.....	.....	.....
HINES VALLEY ROAD	5.9	SA	.....	.....	.....	.....
HIRST CIRCLE	0.7	CO.	3-24'	.....	.....	CURBED
HOFFMAN DRIVE	0.2	CO.	.....	.....	.....	.....
HOFFMAN LANE	0.1	CO.	.....	.....	.....	.....
HOLBROOK AVENUE	0.2	CO.	.....	.....	.....	.....
HOLLAND TRAIL	0.7	CO.	4-19'	23'	.....	.....
HOLT DRIVE(ANNEXED LOUDON )	0.6	CO.	.....	.....	.....	.....
HOLT ROAD	0.6	CO.	.....	.....	.....	.....
HOPE CREEK ROAD	0.9	CO.	.....	.....	.....	.....
HOTCHKISS VALLEY LANE	0.2	CO.	.....	.....	.....	DE
HOTCHKISS VALLEY ROAD E	4.6	SA	.....	.....	.....	.....

PAGE 11 OF 40



LOUDON COUNTY ROAD LIST  
01/09/2006

ROAD NAME	LENGTH MILES	COUNTY OR STATE AID	CLASS AND WIDTH	ROAD BED WIDTH	RIGHT OF WAY WIDTH	CURBED SUBDIV DEAD END
H						
HOTCHKISS VALLEY ROAD W	1.7 CO.					
HOUK ROAD	0.2 CO.					
HUBBARD ROAD	1.8 CO.					
HUFFS FERRY ROAD N	1.8 CO.					
HUNTSVILLE HOLLOW ROAD	1.1 CO.					
HUTTON ROAD	0.6 CO.					
I						
INDPENDENCE LANE	0.1 CO.		4-12'	14'		
INTERSTATE LANE	0.6 CO.					
IRENE LN	0.3 CO.		3-24'			
J						
JACKSON BEND ROAD	1.5 CO.					
JACKSON CEMETERY ROAD	0.4 CO.					
JACKSON FERRY ROAD	1.6 CO.					
JACOBS ROAD	0.5 CO.					
JAMES DRIVE	0.3 CO.		3-26'			
JESSIE LANE	0.2 CO.		3-27'			CURB-DE CURB

PAGE 12 OF 40

LOUDON COUNTY ROAD LIST  
01/09/2006

ROAD NAME	LENGTH MILES	COUNTY OR STATE AID	CLASS AND WIDTH	ROAD BED WIDTH	RIGHT OF WAY WIDTH	CURBED SUBDIV DEAD END
<b>J</b>						
JIM CONNER ROAD	0.2	CO.	4-12'	16'		DE
JIM DYKE ROAD	1.5	CO.				
JOHNSON CHURCH ROAD	0.3	CO.				
JULIP LANE	1040'	CO.	2-18'	18'	50'	
<b>K</b>						
KAGLEY DRIVE		CO.				
KEATON ROAD	0.3	CO.				DE
KEENER LANE	0.3	CO.	4-12'	12'		DE
KENNY BROOK LANE	0.2	CO.				
KEVIN LANE	0.3	CO.	3-24'	24'	50 FT	CURBED
KIMBRELL ROAD	0.7	CO.				
KING ROAD	0.8	CO.				
KISER LANE	0.3	CO.				
KISER ROAD (LO)	1.1	CO.				
KISER STATION ROAD (G)	0.8	CO.				
<b>L</b>						
LAKE COVE ROAD	0.3	CO.	3-24'	.....	.....	CURBED
LAKE CREST DRIVE	1	CO.	3-24'	.....	.....	CURBED
LAKE DRIVE	0.7	CO.				

PAGE 13 OF 40



LOUDON COUNTY ROAD LIST

01/ 9/2006

ROAD NAME

L

LENGTH MILES	COUNTY OR STATE AID	CLASS AND WIDTH	ROAD BED WIDTH	RIGHT OF WAY WIDTH	CURBED SUBDIV DEAD END
LAKE FOREST DRIVE	0.2 CO.	3-21'	21'		DE
LAKE HARBOUR DRIVE	0.4 CO.	3-24'	.....	.....	CURB-DE
LAKE POINT DRIVE	0.1 CO.	3-18'			CURB-DE
LAKELAND DRIVE	2.7 SA	3-20'	21'		
LAKELAND FARMS ROAD	0.4 CO.	4-12'	14'		DE
LAKESIDE DRIVE	1.4 CO.	3-18'	18'		.....
LAKEVIEW ROAD	1.7 CO.	22-Mar	23'		
LAKEWOOD DRIVE	0.6 CO.				
LANE ROAD	0.2 CO.	3-16'	17'		DE
LARUE ROAD	0.1 CO.				
LAURA LANE	0.1 CO.				
LEE HI LANE	0.1 CO.				
LEE SHIRLEY ROAD	0.2 CO.				
LEEPER'S FERRY ROAD	0.5 CO.				
LEEPER PARKWAY	0.2 CO.	3-26'	.....	.....	CURB
LENNOX COURT	0.1 CO.				CURB-DE
LENORE DRIVE	0.1 CO.	3-26'	.....	.....	CURBED
LEONA DRIVE	0.3 CO.				
LETTERMAN ROAD	0.1 CO.				
LINDER LANE	0.1 CO.	3-24'	.....	.....	CURB-DE
LINGENFELTER LANE	0.1 CO.	3-20'	.....	.....	CURB-DE
LITTLE MOUNTAIN LANE	0.5 CO.				
LITTLE SHUBERT ROAD	0.1 CO.				
LITTLE VALLEY ROAD	1.8 CO.				
LONG COVE COURT	0.3 CO.	3-24'	.....	.....	CURB-DE
LONG ROAD	0.2 CO.				
LOU GODDARD LANE	0.3 CO.				
LOUDON DRIVE	CO.				
LOUDON RIDGE ROAD	2.6 SA				
LUCY LANE	CO.				
LYNN ROAD	1.8 CO.				
LYNNWOOD DRIVE	0.7 CO.				

PAGE 14 OF 40

LOUDON COUNTY ROAD LIST  
01/09/2006

ROAD NAME	LENGTH MILES	COUNTY OR STATE AID	CLASS AND WIDTH	ROAD BED WIDTH	RIGHT OF WAY WIDTH	CURBED SUBDIV DEAD END
M						
MALONE ROAD (LC)	0.9	CO.				
MALONE ROAD (LO)	1.2	SA				
MANIS ROAD	0.6	CO.				
MAPLE HILL ROAD	1.4	SA				
MAPLE HILLS HEIGHTS		CO.				
MAPLE HILLS LANE	0.4	CO.	3-24'	24'	50 FT	CURBED
MAPLETREE LANE	0.1	CO.	3-24'	.....	.....	CURB-DE
MARBLE BLUFF ROAD	1.3	SA				
MARTEL ROAD	4.2	SA	3-21'	21'		
MARKWOOD ROAD	1	CO.				
MASHBURN DRIVE	0.4	CO.	4-13'	13'		DE
MATLOCK BEND ROAD	4.7	CO.				
MATLOCK BEND ROAD E	1.9	CO.				
MATLOCK ROAD	0.6	CO.				
MATLOCK SHORES ROAD		CO.				
MATLOCK TRAIL	0.3	CO.				
MAYO ROAD	0.8	CO.				
MAYO ROAD SOUTH	0.2	CO.				
MCDANIEL LANE	0.2	CO.	4-16'	20'	.....	DE
MCGHEE ROAD	0.6	CO.				
MCKELVEY ROAD	0.7	CO.				
MCTEER ROAD(ANNEXED L.C.)	0.3	CO.				
MEADOW DRIVE	0.3	CO.	3-26'	.....	.....	CURB
MEADOW ROAD N	2.6	SA				
MEADOW ROAD W	2.7	SA				
MEALER ROAD	0.6	CO.				
MIDWAY ROAD	0.8	CO.	3-17'	19'		.....

PAGE 15 OF 40



LOUDON COUNTY ROAD LIST  
01/09/2006

ROAD NAME M	MILES	OR STATE AID	AND WIDTH	WIDTH	OF WAY WIDTH	SUBDIV DEAD END
MILLERS COVE LANE	0.3	CO.				
MILLER ROAD	0.3	CO.	3-24'			CURBED
MILLER ROAD	0.4	CO.	4-12'	.....	.....	CURB
MIMOSA STREET	0.1	CO.	4-16'	20'		.....
MISTY RIDGE DRIVE	0.3	CO.	3-27'	.....		DE
MISTY RIDGE DRIVE(ADDITION)	0.3	CO.	3-24'	24'	50 FT	CURBED
MISTY VIEW DRIVE	0.2	CO.				CURBED
MONTCREST DRIVE	0.1	CO.				CURBED
MONTEREY DRIVE	0.3	CO.				
MONTICELLO DRIVE	0.1	CO.				
MONTOOTH ROAD	0.5	CO.				
MONUMENT STREET	0.1	CO.				
MONTVIEW ROAD	0.7	CO.				
MORGANTON CEMETERY ROAD	0.5	CO.				
MORGANTON ROAD	4.2	SA				
MORTON LANE	0.2	CO.	3-14'	14'		
MORTON ROAD	1.3	CO.	3-16'	16'		DE
MOSS ROAD	0.8	CO.				.....
MOUNTAIN CREST LN	0.2	CO.	3-25'			
MOUNTAIN VIEW ROAD	0.5	CO.				
MT. ZION CHURCH ROAD	0.5	CO.				
MUDDY CREEK ROAD	1.4	SA	3-23'	26'		
MURRY'S CHAPEL ROAD	0.9	CO.				.....
MYERS ROAD (LC)	0.5	CO.				
MYRTLE ROAD	0.4	CO.				

PAGE 16 OF 40

LOUDON COUNTY ROAD LIST  
01/09/2006

ROAD NAME	LENGTH MILES	COUNTY OR STATE AID	CLASS AND WIDTH	ROAD BED WIDTH	RIGHT OF WAY WIDTH	CURBED SUBDIV DEAD END
N						
NATIONAL CAMPGROUND ROAD	1.6	SA				
NEELEY ROAD	0.1	CO.	4-10'	12'		DE
NESS LANE	0.3	CO.				
NEW HOPE ROAD	2.3	CO.				
NEW MACEDONIA ROAD	0.2	CO.				.....
NEWBERRY DRIVE	0.5	CO.				
NEWTON ROAD	0.2	CO.				
NICHOLS ROAD WITH EXT.200 FT	0.4	CO.	4-13'	14'		.....
NILES FERRY ROAD	2.1	CO.				DE
NORTH HOLSTON DRIVE	0.4	CO.				
NORTH TRIGONIA ROAD	2.5	CO.				
NORTHSHORE DRIVE	2.1	CO.	3-21'	23'		.....
NORTHVIEW DRIVE	0.3	CO.				
N. WILKERSON ROAD	512'	CO.	3-24'	24'	50 FT	CURBED
NOTCH-IN-HILL ROAD	2.9	CO.				
O						
OAK CHASE BLVD	0.6	CO.				CURBED
OAK GROVE ROAD	0.7	CO.				
OAKLEY GLEN LANE	0.2	CO.	3-24'	24'	50 FT	CURBED
OAKWOOD ESTATES DRIVE (UNI'	0.8	CO.	3-24'	.....	.....	CURB-DE
OLD BAILEY ROAD	0.2	CO.	4-11'			DE



LOUDON COUNTY ROAD LIST  
01/09/2006

ROAD NAME	LENGTH MILES	COUNTY OR STATE AID	CLASS AND WIDTH	ROAD BED WIDTH	RIGHT OF WAY WIDTH	CURBED SUBDIV DEAD END
O						
OLD FARM ROAD	0.1	CO.				
OLD GREENBACK ROAD	0.7	CO.				
OLD HOLLOW ROAD	0.8	CO.				
OLD HWY 95	2.4	CO.				
OLD KINGSTON ROAD	2.4	CO.				
OLD LEE HIGHWAY	0.4	CO.				
OLD MIDWAY ROAD	1.1	CO.	3-17'	17'		
OLD NILES FERRY PIKE	0.1	CO.				.....
OLD SINKING CREEK ROAD	0.6	CO.				
OLD SPEARS ROAD	0.3	CO.	4-13'	14'		DE
OLD STAGE ROAD	0.9	CO.	4-18'	20'		.....
OLD SUGAR LIMB ROAD	1.8	CO.				
OODY ROAD	0.4	CO.				
ORCHARD DRIVE	0.1	CO.	3-24'	.....	.....	CURB
OREN WHITE ROAD	0.3	CO.				
OSPREY COVE COURT	0.2	CO.	3-24'	.....	.....	CURB-DE
OTTER LANE	0.1	CO.	3-24'	.....	.....	CURB-DE
OUTER DRIVE	0.5	CO.				
OVERLOOK DRIVE	0.1	CO.				
OVERLOOK ROAD	0.2	CO.				CURBED
OWNBY ROAD	0.1	CO.				
OXBOW ROAD	0.3	CO.				
P						
PALMER DRIVE	0.6	CO.	3-14'	15'		DE
PAR DRIVE	0.1	CO.				CURBED
PARDUE LANE	0.4	CO.	4-10'	12'		DE
PARKWAY DRIVE	0.3	CO.				DE

PAGE 18 OF 40

LOUDON COUNTY ROAD LIST  
01/09/2006

ROAD NAME	LENGTH MILES	COUNTY OR STATE AID	CLASS AND WIDTH	ROAD BED WIDTH	RIGHT OF WAY WIDTH	CURBED SUBDIV DEAD END
P						
PARRIS DRIVE	1.7	CO.	3-19'	20'		.....
PATE ROAD	0.2	CO.				
PAW PAW PLAINS ROAD	0.8	CO.				
PAW PAW PLAINS ROAD W	0.9	CO.				
PEACHTREE STREET	0.1	CO.				
PEMBROOK COURT	0.1	CO.				
PERKLE ROAD	0.6	CO.				CURB-DE
PETERSON ROAD	1.8	CO.				
PHELPS ROAD	0.9	CO.	3-15'	16'		
PHILLIPS ROAD	0.5	CO.				.....
PICKLE ROAD	0.4	CO.				
PINECREST CIRCLE	0.7	CO.	3-19'	21'		
PINE GROVE/PROVIDENCE ROAD	0.6	SA				.....
PINE LANE	0.2	CO.				
PINE STREET (LO)	0.1	CO.				DE
PINE TOP STREET (G)	0.6	CO.				
POINT HARBOUR DRIVE	0.2	CO.	3-23'	.....	.....	CURB-DE
POND CREEK ROAD	3.9	SA				
POND ROAD	3.8	CO.				
POPLAR RIDGE ROAD	0.9	CO.				
POPLAR SPRINGS ROAD	0.9	CO.				

PAGE 19 OF 40

LOUDON COUNTY ROAD LIST  
01/09/2006

ROAD NAME	LENGTH MILES	COUNTY OR STATE AID	CLASS AND WIDTH	ROAD BED WIDTH	RIGHT OF WAY WIDTH	CURBED SUBDIV DEAD END
P						
PORT MADISON DRIVE	0.4	CO.				
PRICE ROAD	0.7	CO.				
PROSPECT CHURCH ROAD	1.9	SA				DE
PUMP STATION ROAD	0.2	CO.				
Q						
QUEENER ROAD	0.2	SA				
QUILLEN OVERLOOK DRIVE	0.1	CO.				
R						
RABY TOWN ROAD	0.4	CO.				
RANCH ROAD	0.5	CO.				
RANCHERO DRIVE	0.2	CO.	3-21'	.....	.....	CURB-DE
RAUSIN ROAD	3.4	CO.				
RAWHIDE TRAIL	0.3	CO.	3-26'	.....	.....	CURB-DE
RED GROUSE DRIVE	0.4	CO.	3-24'	.....	.....	CURB-DE
REED SPRINGS CHURCH ROAD	0.7	CO.				CURB-DE
REED SPRINGS ROAD	0.6	CO.				
REST CAMP ROAD	1.5	CO.				
PAGE <u>20</u> OF <u>40</u>						



LOUDON COUNTY ROAD LIST

01/09/2006

ROAD NAME

	LENGTH MILES	COUNTY OR STATE AID	CLASS AND WIDTH	ROAD BED WIDTH	RIGHT OF WAY WIDTH	CURBED SUBDIV DEAD END
R						
REX LANE	0.1	CO.				
RIDEN ROAD	0.1	CO.				
RIDGEBARK LANE	0.2	CO.	3-24'	.....	.....	DE
RIDGEVIEW DRIVE	0.1	CO.				CURB-DE
RILEY DRIVE	0.7	CO.				CURB-DE
RICHEY ROAD	1.1	CO.				
RIVER CHASE ROAD	0.3	CO.	3-26'	.....	.....	CURB-DE
RIVER POINT DRIVE	0.2	CO.	3-24'	.....	.....	CURB-DE
RIVERS EDGE DRIVE	0.3	CO.				CURBED
RIVER VIEW DRIVE	1	CO.				CURBED
RIVERVIEW GOLF DRIVE	0.4	CO.				CURBED
RIVERVIEW ROAD	1	CO.				DE
ROAX ROAD	0.3	CO.				
ROBERSON SPRINGS ROAD	2.7	SA				
ROBERTS CIRCLE	0.4	CO.	3-18'	18'		.....
ROBERTS ROAD	0.4	CO.				
ROBERSON LANE		CO.				
ROBINSON CIRCLE (LC)	0.7	CO.				
ROBINSON DRIVE (LC)	0.1	CO.				
ROBINSON ROAD (LO)	0.4	CO.				
ROCK QUARRY ROAD	0.7	CO.				
ROCKY TOP ROAD	0.6	CO.				
RODNEY ROAD	0.1	CO.				DE
ROLLING ACRES DRIVE	0.1	CO.				
ROSS ROAD	1.9	CO.				
ROUNDUP LANE	0.1	CO.	3-25'	.....	.....	CURB-DE
ROY LONAS ROAD	0.4	CO.				
RURITAN ROAD	0.2	CO.				DE
RUSSELL LANE	0.3	CO.	4-19'	20'		.....
RUSSELL ROAD	0.1	CO.				
RYAN ROAD	0.7	CO.				

PAGE 21 OF 40

LOUDON COUNTY ROAD LIST  
01/09/2006

ROAD NAME	LENGTH MILES	COUNTY OR STATE AID	CLASS AND WIDTH	ROAD BED WIDTH	RIGHT OF WAY WIDTH	CURBED SUBDIV DEAD END
S						
SAMPSON BLVD	0.1	CO.	3-30'	.....	.....	CURBED
SANDY SHORE DRIVE	0.6	CO.				
SCENIC DRIVE	0.3	CO.				
SCENIC VIEW DRIVE	0.3	CO.				
SHAW FERRY LANE	0.6	CO.	3-25'	27'		DE
SHAW FERRY ROAD	2.5	SA	3-18'	18'		.....
SHAW FERRY ROAD N	1.1	CO.				
SHEETS HOLLOW ROAD		CO.				
SHELL ROAD	0.2	CO.				
SHELTON GROVE ROAD	0.7	CO.				
SHIPLEY LANE	0.3	CO.	4-13'	13'		.....
SHULTZ LANE	0.4	CO.				
SILO DRIVE	0.5	CO.	3-24'	.....	.....	CURB-DE
SIMMONS ROAD (LO)	0.3	CO.				
SIMPSON ROAD (LC)	0.5	CO.				
SIMPSON ROAD EAST	0.4	CO.	4-19'	20'		.....
SINKING CREEK ROAD	2.4	CO.				
SKYVIEW DRIVE	0.3	CO.				
SLAB TOWN ROAD	0.3	SA				CURB-DE
SMALLEN ROAD	1.1	CO.				
SMITH VALLEY ROAD	0.1	CO.	4-13'	15'		DE

LOUDON COUNTY ROAD LIST  
01/09/2006

ROAD NAME	LENGTH MILES	COUNTY OR STATE AID	CLASS AND WIDTH	ROAD BED WIDTH	RIGHT OF WAY WIDTH	CURBED SUBDIV DEAD END
S						
SNODDERLY ROAD	0.5	CO.				
SNOW ROAD	0.3	CO.	3-16'	18'		
SPRING ROAD	0.5	CO.				.....
SPRING VIEW DRIVE	0.3	CO.	3-26'	.....	.....	
STAFFORD ROAD	0.7	CO.				CURB-DE
STALLCUP ROAD	0.3	CO.				
STEEKEE CREEK ROAD	3.4	SA				
STEEKEE ROAD	4.3	SA				
STEEKEE SCHOOL ROAD	2.2	SA				
STEVENS LANE	0.4	CO.				
STEVENS ROAD	0.2	CO.				
STINNETT ROAD	0.3	CO.				
STOCKTON VALLEY ROAD	6.2	SA				
STRANGE ROAD	0.5	CO.	3-16'	18'		
ST. THOMAS WAY	0.1	CO.	3-22'			.....
SUGARWOOD ROAD	0.3	CO.				
SUNNYSIDE ROAD	2.6	CO.				
SUNSET DRIVE	0.1	CO.				



LOUDON COUNTY ROAD LIST  
01/09/2006

ROAD NAME	LENGTH MILES	COUNTY OR STATE AID	CLASS AND WIDTH	ROAD BED WIDTH	RIGHT OF WAY WIDTH	CURBED SUBDIV DEAD END
T						
TANGLEWOOD DRIVE	0.9	CO.	3-23'	.....	.....	CURB-DE
TARWATER ROAD	1.3	CO.				
TAYLOR DRIVE	0.1	CO.	4-16'	18'		DE
TEETERS ROAD	0.3	CO.				
TEN MILE ROAD	0.2	CO.				
THOMPSON BRIDGE ROAD	0.1	CO.				
THOMPSON ROAD	0.2	CO.				
THORNTON DRIVE	0.5	CO.				
TURMAN DRIVE	0.5	CO.	4-25'	27'		DE
THURMER CIRCLE	0.2	CO.	3-26'	.....	.....	DE
TILLEY ROAD	0.6	CO.				CURB-DE
TIMBERLINE DRIVE	0.3	CO.				
TIMBER RIDGE DRIVE	0.3	CO.				CURBED
TINNEL LANE	0.2	CO.				
TINNEL ROAD	0.4	CO.				
TIVOLI DRIVE	0.2	CO.				
TOWN CREEK CIRCLE	0.2	CO.				
TOWN CREEK ROAD E	1.4	SA				
TOWN CREEK ROAD W	1.4	SA				
TRADES DRIVE	0.1	CO.				
TRAIL VIEW DRIVE	0.3	CO.				
TRIGONIA ROAD	0.8	CO.				
TURNER LANE	0.2	CO.				
TURN LANE ROAD	0.3	CO.				CURB-DE
TURTLE COVE COURT	0.2	CO.	3-24'	.....	.....	CURB-DE
TWIN COVE CIRCLE	0.5	CO.	3-26'	.....	.....	CURB-DE

PAGE 24 OF 40

LOUDON COUNTY ROAD LIST  
01/09/2006

ROAD NAME	LENGTH MILES	COUNTY OR STATE AID	CLASS AND WIDTH	ROAD BED WIDTH	RIGHT OF WAY WIDTH	CURBED SUBDIV DEAD END
T						
TWIN COVE DRIVE	0.4	CO.	3-26'	.....	.....	CURB-DE
U						
UNION FORK CREEK CHURCH RC UNITIA ROAD	1.3 2.9	CO. SA	_____	_____	_____	_____
V						
VALLEY DALE DRIVE	0.2	CO.	_____	_____	_____	_____
VALLEY VIEW DRIVE	0.1	CO.	_____	_____	_____	_____
VARNER HOLLOW ROAD	0.4	CO.	_____	_____	_____	CURBED
VAUGHN ROAD	0.4	CO.	_____	_____	_____	_____
VAUGHN'S CHAPEL ROAD	0.3	CO.	_____	_____	_____	_____
VINEYARD ROAD	0.6	CO.	_____	_____	_____	_____
VIRTUE ROAD	0.5	SA	3-18'	20'	_____	_____
VONORE ROAD	4.3	SA	_____	_____	_____	.....

LOUDON COUNTY ROAD LIST  
01/09/2006

ROAD NAME	LENGTH MILES	COUNTY OR STATE AID	CLASS AND WIDTH	ROAD BED WIDTH	RIGHT OF WAY WIDTH	CURBED SUBDIV DEAD END
W						
WADE LANE	0.3	CO.				
WADE ROAD EAST	0.5	CO.				DE
WADE ROAD WEST	1.3	CO.				
WALLER FERRY ROAD	1.2	CO.				
WARD ROAD (LC)	0.7	CO.				DE
WARD ROAD (LO)	0.6	CO.				
WASHINGTON PIKE	4.3	CO.				
WATKINS ROAD	2.2	SA				
WATSON ROAD	1.4	CO.				
WATT CEMETERY ROAD	2.7	CO.				
WEBB CIRCLE	0.1	CO.				
WEBB DRIVE	0.5	CO.				
WEDGEWOOD DRIVE	0.4	CO.				
WESCHESTER ROAD	0.2	CO.				CURBED
WESLEY ROAD	0.3	CO.	4-19'	23'		.....
WEST FORK ROAD	0.4	CO.				
WEST LANE	0.2	CO.				
WESTSHORE DRIVE	0.2	CO.				
WHEAT ROAD	1.4	SA				
WHEELER DRIVE	0.1	CO.				
WHITE OAK ROAD	0.3	CO.				
WHITE ROAD	0.8	CO.				
WHITE WING ROAD	0.2	SA				
WHITE WING ROAD N	2.4	SA				
WHITE WING ROAD W	0.2	SA				
WHITNEY DRIVE	0.4	CO.				CURBED

PAGE 26 OF 40



LOUDON COUNTY ROAD LIST  
01/09/2006

ROAD NAME	LENGHT MILES	COUNTY OR STATE AID	CLASS AND WIDTH	ROAD BED WIDTH	RIGHT OF WAY WIDTH	CURBED SUBDIV DEAD END
W						
WILKERSON LANE	0.3	CO.	3-18'			
WILKERSON ROAD	0.6	CO.	3-14'			.....
WILLIAMSBURG DRIVE	0.1	CO.				DE
WILLIAMS FERRY ROAD	2	SA				CURBED
WILLIAMSON DRIVE	0.2	CO.				
WILSON ROAD (LC)	0.9	CO.	4-13'	16'		
WINDRIDGE ROAD	0.8	CO.				.....
WINDSWEPT DRIVE	0.3	CO.				CURBED
WILSON ROAD (LO)	0.3	CO.				CURBED
WINCHESTER DRIVE	0.2	CO.	4-19'	23'		
WOODLAND DRIVE	0.4	CO.				.....
WOODLAWN CHURCH ROAD	0.6	CO.				
WOODLAWN ROAD	0.4	CO.				
WOODS STREET	0.1	CO.				
Y						
YARBERRY DRIVE	0.8	CO.				
YATES LANE	0.1	CO.				DE
YEDEAR ROAD	0.6	CO.				
Z						
ZION RIDGE ROAD	1.1	CO.				

ROADS REMOVED FROM THE 1999  
COUNTY ROAD LIST DUE TO BEING  
PRIVATE ROADS OR ROADS ANNEXED  
BY THE CITIES OF LOUDON, LENOIR  
CITY, PHILADELPHIA, GREENBACK OR  
ROADS IN ANOTHER COUNTY  
01/09/2006

PRIVATE ROADS

ALEXANDER ROAD  
BEAVER BROOK DRIVE  
EAST COVE  
ELIZABETH WAY (2003)  
NOTHCOVE ESTATES DRIVE  
SOUTHSHORE DRIVE  
TIMBERLAKE DRIVE  
TURKEY PENN LANE (2003)  
VERLA WAY (2003)

CITY OF LOUDON

BLAIR BEND DRIVE  
BOB WHITE DRIVE  
CREEKWOOD CIRCLE  
HILLVALE LANE  
HILLVIEW LANE  
RIVER BEND ROAD  
ROBERSON LANE

LOUDON COUNTY ROAD LIST  
01/09/2006

ANNEXED ROADS

CITY OF LENOIR CITY

CHURCH ROAD  
CRISP ROAD  
INTERCHANGE PARK LANE  
JOHNSON CIRCLE  
JOHNSON DRIVE  
LEE DRIVE  
LLOYD LANE  
MOATS ROAD  
NORTHSIDE DRIVE  
PEARL DRIVE  
PINE RIDGE DRIVE  
REDBUD COURT  
SHADY LANE  
SHARP DRIVE  
SHEA DRIVE  
SIMPSON ROAD WEST  
TOM LEE ROAD  
VIRGINIA LANE

CITY OF PHILADELPHIA

ELM STREET

PAGE 29 OF 40



LOUDON COUNTY ROAD LIST  
01/09/2006

ANNEXED ROADS

CITY OF GREENBACK

HUTTON ROAD  
KINSER LANE  
KYKER ROAD  
MYERS ROAD  
PINE GROVE CIRCLE  
PINE STREET  
RAMSEY ROAD  
RUDD ROAD  
STEELE ROAD  
STONE DRIVE  
WOODS DRIVE

OTHER COUNTY - BLOUNT

FROG POND ROAD  
FRONTAGE ROAD  
GREGO DRIVE

PAGE 30 OF 40

ROADS REMOVED FROM THE 1999  
ROAD LIST FOR VARIOUS REASONS  
1/9/2006

ROAD NAME

COCK ROAD	NOT	FOUND
DAVID RIDGE ROAD	MIS-	SPELLING OF DAVIS RIDGE RD
FORTNER DRIVE	NOT	FOUND
HUNSVILLE HOLLOW ROAD	MIS-	SPELLING OF HUNTSVILLE HOL- LOW ROAD
PERKEY ROAD	NOT	FOUND

REMOVED FROM 2004 SUBDIVISION LIST			
SUMMIT HILLS	SAME	AS	SUMMIT- VUE

LOUDON COUNTY ROAD LIST  
1/9/2006

ADDENDUM #5

ROADS REMOVED FROM ROAD LISTS  
OF PREVIOUS YEARS FOR VARIO REASONS

ROAD NAME				
ALMA PLACE	CITY OF	LOUDON	ANNEXED	
BLAIR BEND ROAD	CITY OF	LOUDON	ANNEXED	
BUTTERMILL ROAD	MIS-	SPELLING	OF BUTTE MILK ROAD	
CHESTNUT RIDGE DRIVE	CITY OF	LENOIR	CITY ANNEXED	
CROOKED OAK DRIVE	CITY OF	LENOIR	CITY ANNEXED	
DAVID DRIVE	MIS-	SPELLING	OF DAVIS DRIVE	
DAVID DRIVE	CITY OF	LENOIR	CITY ANNEXED	
DUNRIDGE ROAD	IT IS	DUNRIDGE LANE		
EUGENE DISNEY ROAD	NEVER	BEEN	ACCEPTED	
EVERETT WILLIAMS ROAD	NEVER	BEEN	ACCEPTED	
FIPPS LANE	CITY OF	GREEN-	BACK ANNEXED	
FINLEY DRIVE	CITY OF	LENOIR	CITY ANNEXED	
GETT ROAD	CITY OF	GREEN-	BACK ANNEXED	
JENA ROAD	CITY OF	GREEN-	BACK ANNEXED	
JONES DRIVE	CITY OF	GREEN-	BACK ANNEXED	
JONES ROAD	NOW	WOOD-	LAWN CHURCH ROAD	
NEW SUGARLIMB ROAD	NOW	STATE	ROAD #233	
NORTHSHORE DRIVE (G)	IN	FOOTHILLS	POINTE	
NORWOOD STREET	CITY OF	LENOIR	CITY ANNEXED	
OAKLAND ROAD	NOW	STATE	ROAD #324	
OVERLOOK LANE	CITY OF	LOUDON	ANNEXED	
PARKWOOD CIRCLE	IN	FOOTHILLS	POINTE	
SHAMROCK LANE	NAME	CHANGED TO	COULTER SHOALS CIRCLE	
SIMPSON ROAD	INCLUDE IN	SIMPSON	ROAD (LC)	
TELLICO PARKWAY	NOW	STATE	ROAD #444	
TURMAN DRIVE	NAME	CHANGED TO	THURMAN CIRCLE	
WARES BEND ROAD	TVA	ROAD		



SUBDIVISIONS OF LOUDON COUNTY  
01/09/2006

ABBOTT CROSSING  
ANCHORAGE  
ANGLEWOOD  
AVALON  
BEALS LANDING  
BRANDYWINE  
BRENTWOOD ESTATES  
BURDETTE  
CARTER  
CEDAR HILLS  
CLINCH VIEW ESTATES  
COCKRELL  
CONKINNON POINTE  
CORDOVA  
COULTER SHOALS  
COVENANT CIRCLE  
CRANFILL  
CUSICK CIRCLE #1  
CUSICK CIRCLE #2  
DERBY CHASE  
DIXIE LEE VILLAGE  
DEERFIELD CROSSING  
DUFF TURNER

PAGE 33 OF 40

SUBDIVISIONS OF LOUDON COUNTY  
01/09/2006

EAST HILLS  
EATON FOREST  
EATON VILLAGE  
EATONWOOD  
FOOTHILLS POINTE  
FOREST HEIGHTS #1  
FOREST HEIGHTS #2  
FORT LOUDON ESTATES #1  
FORT LOUDON ESTATES #2  
FRANKLIN ESTATES  
GAULT  
GRIFFITH KEEP  
GIFFIN  
GREENACRES  
HARDIN ESTATES  
HARRISON HILLS  
HARRISON PARK  
HIDDEN VALLEY  
HIDDEN OAKS  
HIGHLAND HILLS  
HILLSBOROUGH LANE  
HOPE CREEK  
HUBBARD  
HUFFMAN BROTHERS  
HWY 70E COMM. PARK

PAGE 34 OF 40

SUBDIVISIONS OF LOUDON COUNTY

01/09/2006

LAKE POINTE  
LAKEVIEW (GREENBACK)  
LAKEVIEW (LOUDON)  
LANE  
LEEPERS CROSSING  
LINDNER VILLA  
LITTLE MOUNTAIN ESTATES  
LITTLE MT. VISTA  
LYNWOOD  
MALHON PLACE  
MAPLE HILL HGTS.  
MARTEL ESTATES  
MARTEL ESTATES EAST  
MATLOCK  
MCDANIEL  
MIDWAY  
MILLER'S LANDING  
MISTY RIDGE  
MOUNTVIEW ESTATES  
NORTH FORTY  
NORTHVIEW ESTATES  
OAKLEY GLEN  
OAKWOOD ESTATES  
OAKWOOD ESTATES #2  
OLD HICKORY

PAGE 35 OF 40



SUBDIVISIONS OF LOUDON COUNTY  
01/09/2006

PINE GROVE  
PLEASANT HILL  
PLEASANT VIEW  
POINTE HARBOR  
PORT MADISON  
RANCHERO  
RIVER CHASE  
RIVER BEND  
RIVERVIEW  
RIVERVIEW GOLF COURSE  
REMINGTON PLACE  
ROBERTSON SPRINGS  
SHARP ESTATES  
SHAVER  
SHAW FERRY  
SILO ACRES  
SNODDERLY  
STOCKTON VALLEY ESTATES  
STRANGE  
SUMMITUVE  
TANASI HILLS  
TANGLEWOOD  
TAYLOR  
THE PINES  
THE PLANTATION  
  
THURMAN CIRCLE  
TIMBER RIDGE  
TUCK AWAY COVE  
TWIN COVES  
VINEYARD COVE  
WARRIOR'S CHASE PH.1  
WILLIAMSBURG

PAGE 36 OF 40

LOUDON COUNTY ROAD LIST

1/9/2006

ADDENDUM #6

ADDITIONS/CHANGES 01-30-04

ROAD NAME	LENGTH MILES	COUNTY OR STATE AID	CLASS AND WIDTH	ROAD BED WIDTH	RIGHT OF WAY WIDTH	CURBED SUBDIV DEAD END
ABBOTT CROSSING SUBDIVISION ABBOT CROSSING LN	0.9	CO.	3-26'	_____	_____	_____
CONKINNON POINTE SUBDIVISION ASHFORD LN	0.1	CO.	4-20'	_____	_____	_____
ADOPTED 04-01-02 DEERFIELD CROSSING SUBDIVISION DEERFIELD LN	0.5	CO.	3-22'	_____	_____	_____
FRANKLIN ESTATES SUBDIVISION FRANKLIN ESTATES LN	0.4	CO.	3-25'	_____	_____	_____
MOUNTAIN CREST LN	0.2	CO.	3-25'	_____	_____	_____
ADOPTED 04-01-02 HILLSBOROUGH LANE SUBDIVISION HILLSBOROUGH LANE	0.2	CO.	3-22'	_____	_____	_____
ADOPTED 04-01-02 SUMMITVUE SUBDIVISION HILLTOP DR	0.8	CO.	3-24'	_____	_____	_____
ADOPTED 12-03-01 FISHERMAN COVE	0.2	CO.	2-16'	_____	_____	_____

PAGE 37 OF 40

LOUDON COUNTY ROAD LIST  
1/9/2006

ADDENDUM #6 CONTINUED

ADDITIONS/CHANGES 01-30-04

ROAD NAME	LENGTH MILES	COUNTY OR STATE AID	CLASS AND WIDTH	ROAD BED WIDTH	RIGHT OF WAY WIDTH	CURBED SUBDIV DEAD END
ADOPTED 08-06-01 IRENE LANE	0.3	CO.	3-24'	_____	_____	_____
ADOPTED 12-02-02 ST. THOMAS WAY	0.1	CO.	3-22'	_____	_____	_____

PAGE 38 OF 40



LOUDON COUNTY ROAD LIST  
1/9/2006

ADDENDUM #7

ADDITIONS/CHANGES 12-31-2004

HWY 70E COMM. PARK SUBDIVISION KEVIN LANE W/CUL-DE-SAC	0.3 CO.	3-24'	_____	50 FT	CURBED
OAKLEY GLEN SUBDIVISION OAKLEY GLEN LANE W/CUL-DE-SAC	0.2 CO.	3-24'	_____	50 FT	CURBED
MISTY RIDGE SUBDIVISION MISTY RIDGE DRIVE (ADDITION)	0.3 CO.	3-24'	_____	50 FT	CURBED
MAPLE HILL HGTS. SUBDIVISION MAPLE HILLS LANE W/CUL-DE-SAC	0.4 CO.	3-24'	_____	50 FT	CURBED
WARRIOR'S CHASE PH. I N.WILKERSON LANE W/TURN-AROUND	512' CO.	3-24'	_____	50 FT	CURBED
BEALS LANDING BEALS LANDING LANE W/CUL-DE-SAC	0.2 CO.	3-24'	_____	50 FT	CURBED
NICHOLS ROAD EXT.	.200' CO.		_____		
DERBY CHASE SUBDIVISION DERBY CHASE DRIVE JULIP LANE	4070' CO. 1040' CO.	3-22' 2-18'	22' 18'	50 FT 50 FT	_____ _____

PAGE 39 OF 40

LOUDON COUNTY ROAD LIST  
1/9/2006

ADDENDUM #8

ADDITIONS/CHANGES 12-31-05

ADDITION OF ROADS

COUNTY RD 299  
FALCON FIRE COURT  
FALCON HEAD COURT  
KAGLEY DR  
MAPLE HILLS HEIGHTS  
ROBERSON LANE

CHANGES (SPELLING)

LENOIR DR TO LENORE DR  
THURMAN DR TO TURMAN DR

PAGE 40 OF 40

**RESOLUTION 010906-D**

**A RESOLUTION CERTIFYING THE LOUDON COUNTY ECONOMIC DEVELOPMENT AGENCY AS THE LOCAL JOINT ECONOMIC AND COMMUNITY DEVELOPMENT BOARD AS REQUIRED BY PUBLIC ACT 1101**

**Whereas**, Public Act 1101 requires Loudon County and the cities within Loudon County to enter into an intergovernmental agreement to establish a joint board to be responsible for certain economic and community development activities; and

**Whereas**, Public Act 1101 provides that if there was an established agency in the county that was essentially performing the functions as outlined in the Act, the county could designate such agency as the appropriate agency to be responsible for economic and community development activities required by Public Act 1101; and

**Whereas**, the County petitioned the State of Tennessee, Local Government Planning Advisory Committee on February 1, 2000 requesting that the Loudon County Economic Development Agency be designated as the Joint Economic and Community Development Board; and

**Whereas**, on October 25, 2000 The State of Tennessee Local Government Planning Advisory Committee found the Loudon County Economic Development Agency to be similarly organized to serve as the Joint Economic and Community Development Board as required by Public Act 1101; and

**Whereas**, the Attorney General opined on July 11, 2005 (Opinion No. 05-109), that in applying for state grants, a local government must certify its compliance with the statute establishing joint economic and community development boards; and

**Now, Therefore, Be it Resolved** that the Loudon County Commission hereby certifies and designates the Loudon County Economic Development Agency Board of Directors as the Joint Economic and Community Development Board in compliance with Public Act 1101.

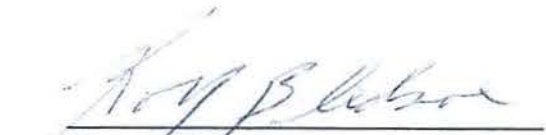
  
County Chairman

Attest:

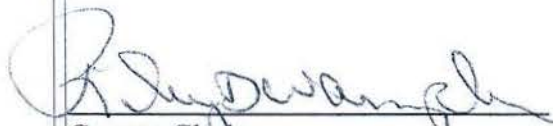
  
County Clerk

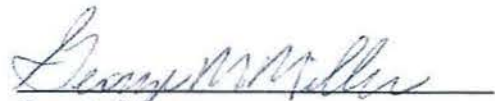
  
County Mayor



**Resolution 010906-E**

**Resolution In Support Of Traffic Light At Fort Loudoun Medical Center Drive and Highway 321 To Safeguard Public Health**

*Whereas*, there is presently no traffic light at the entrance to the new Fort Loudoun Medical Center in Lenoir City, Tennessee; and

*Whereas*, sick and elderly patients have a difficult time negotiating the intersection at the entrance to the new hospital; and

*Whereas*, during the past year there have been a number of serious automobile accidents involving patients and visitors entering and leaving the hospital campus; and

*Whereas*, traffic continues to increase as new businesses (Hampton Inn, Aubrey's, Cracker Barrel, Chili's, and two (2) additional clinics slated for construction) locate adjacent to the Fort Loudoun Medical Center ; and

*Whereas*, the Hospital Administration's continuing effort to bring this dangerous situation to the attention of the Tennessee Department of Transportation has thus far not resulted in an agreement to place a traffic light at the hospital's entrance; and

*Whereas*, this situation represents a direct and continuing threat to the hospital and to the citizens and visitors who utilize the businesses and facilities in that area.

*Now Therefore, Be It Resolved*, that the Loudon County Commission, meeting in regular session, assembled this 9<sup>h</sup> day of January, 2006, hereby formally petitions the Tennessee Department of Transportation to immediately approve the placement of a traffic light at the entrance to the Fort Loudoun Medical Center.

*Be It Further Resolved*, that a copy of this resolution be forwarded to each member of our state legislative delegation and to the Commissioner of the Tennessee Department of Transportation.

Attest:

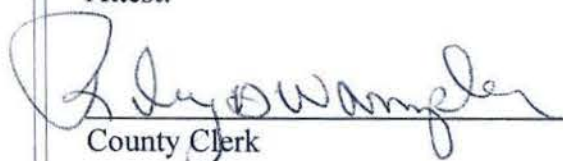
  
County Clerk

  
County Chairman

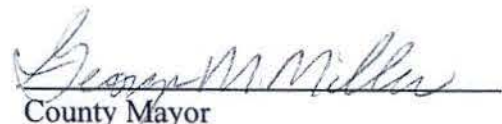
  
County Mayor

Loudon County  
General Fund 101  
Ending June 30, 2006

1244

Exhibit F

	A	B	C	D	E	F	G	H
1			<b>General Fund 101</b>					
2	<b>Account</b>		12/10/2005 15:06	<b>2006</b>	<b>2006</b>	<b>Approved</b>	<b>Proposed</b>	<b>Proposed</b>
3	<b>Number</b>			<b>Org Bgt</b>	<b>Amds</b>	<b>Amded Bgt</b>	<b>Amds</b>	<b>Amded Budget</b>
4								
221	48600		<i>Citizen Groups and Other</i>					
222	48610		Donations (Senior Citizens)	19,000		19,000		19,000
223	48990		Other	0	0	0	4,250	4,250
224								
225			<b>Total Citizens Groups and Other</b>	19,000	0	19,000	4,250	23,250
226								
227								
228			<b>Total Other Governments and Citizens</b>	88,290	0	88,290	4,250	92,540
229								
230	<b>Total Revenues</b>		Reimb from Hamilton Co for meth O/T. Disbursed from 54110-187	12,604,550	605,739	13,210,289	4,250	13,214,539
231								
232	49000		<i>Other Sources</i>					
233	49800		Transfers In (From 128 - Meth Match)	0	15,000	15,000		15,000
234								
235			<b>Total Transfers In</b>	0	15,000	15,000	0	15,000
236								
237	49950		<i>Special Revenue Items</i>					
238	49951		EDA Salary/Benefits Reimbursement	155,471	0	155,471	0	155,471
239	49952		Cont from LE Schools for Juvenile		10,000	10,000		10,000
240								
241			<b>Total Special Revenue</b>	155,471	10,000	165,471	0	165,471
242								
243								
244			<b>Total Revenues and Transfers In</b>	12,760,021	630,739	13,390,760	4,250	13,395,010
245								
246								
247								
248								



**Loudon County  
General Fund 101  
Ending June 30, 2006**

1245

	A	B	C	D	E	F	G	H
1			<b>General Fund 101</b>					
2	<b>Account</b>		12/10/2005 15:06	<b>2006</b>	<b>2006</b>	<b>Approved</b>	<b>Proposed</b>	<b>Proposed</b>
3	<b>Number</b>			<b>Org Bgt</b>	<b>Amds</b>	<b>Amded Bgt</b>	<b>Amds</b>	<b>Amded Budget</b>
4								
666	54000		Public Safety					
667								
668	54110		Sheriff's Department					
669	101		County Official/Administrative Officer	66,787		66,787		66,787
670	103		Assistants (Chief Deputy)	53,040		53,040		53,040
671	106		Deputies	864,000	(38,395)	825,605		825,605
672	108		Investigator(s)	164,000	(40,266)	123,734		123,734
673	109		Captain(s)	89,800		89,800		89,800
674	115		Sergeant(s)	123,000	40,908	163,908		163,908
675	120		Computer Programmer(s)	0		0		0
676	140		Salary Supplement (State reimb 46210)	18,000		18,000		18,000
677	161		Secretary(s)	56,780		56,780		56,780
678	162		Clerical Personnel	52,750	(1,584)	51,166		51,166
679	169		Part-time Personnel (Deputies)	45,000		45,000		45,000
680	170		School Resource Officer	82,000	67,894	149,894		149,894
681	187		Overtime Pay	30,000		30,000	4,250	34,250
682	189		Other Salaries and Wages	0		0		0
683	201		Social Security	102,000	1,868	103,868	170	104,038
684	204		State Retirement	127,335	(2,543)	124,792	210	125,002
685	212		Employer Medicare	23,855	437	24,292	40	24,332
686	196		In-Service Training	0		0		0
687	307		Communication	18,000		18,000		18,000
688	317		Data Processing Services	1,020		1,020		1,020
689	320		Dues and Memberships	1,950		1,950		1,950
690	338		Maintenance and Repair Services - Veh	55,000		55,000		55,000
691	355		Travel	6,500		6,500		6,500
692	399		Other Contracted Services	8,000		8,000		8,000
693	413		Psychologicals and Physicals (Emp.)	25,000		25,000		25,000
694	425		Gasoline	95,000		95,000		95,000

Meth O/T reimb  
by Hamilton Co  
Rev #48990



Loudon County  
General Fund 101  
Ending June 30, 2006

1246

	A	B	C	D	E	F	G	H
1			<b>General Fund 101</b>					
2	<b>Account</b>		12/10/2005 15:06	<b>2006</b>	<b>2006</b>	<b>Approved</b>	<b>Proposed</b>	<b>Proposed</b>
3	<b>Number</b>			<b>Org Bgt</b>	<b>Amds</b>	<b>Amded Bgt</b>	<b>Amds</b>	<b>Amded Budget</b>
4								
695	435		Office Supplies	16,500		16,500		16,500
696	450		Tires	17,500		17,500		17,500
697	451		Uniforms	12,000		12,000		12,000
698	499		Other Supplies and Materials	3,000		3,000		3,000
699	506		Liability Insurance	0		0		0
700	508		Premiums on Corporate Surety Bonds	125		125		125
701	511		Vehicle Equipment and Insurance	21,000		21,000		21,000
702	513		Worker's Comp Insurance	20,000		20,000		20,000
703	524		In Service/Staff Development	4,500		4,500		4,500
704	708		Communication Equipment	7,500		7,500		7,500
705	718		Motor Vehicles	150,000		150,000		150,000
706	719		Office Equipment	2,500		2,500		2,500
707								
708			Total Sheriff's Department	2,363,442	28,319	2,391,761	4,670	2,396,431
709								

Loudon County  
General Fund 101  
Ending June 30, 2006

1247

	A	B	C	D	E	F	G	H
1			<b>General Fund 101</b>					
2	<b>Account</b>		12/10/2005 15:52	<b>2006</b>	<b>2006</b>	<b>Approved</b>	<b>Proposed</b>	<b>Proposed</b>
3	<b>Number</b>			<b>Org Bgt</b>	<b>Amds</b>	<b>Amded Bgt</b>	<b>Amds</b>	<b>Amded Budget</b>
4								
967								
968	56500		Libraries				<div>Payment of FY 04-05 contribution in designation (See pg 52 35160) Effect on fund balance = 0.</div>	
969	162		Wages	134,921	(25,361)	109,560		109,560
970	169		Part-time Personnel	0	27,091	27,091		27,091
971	168		Temp Personnel (Substitute Librarians)	0	4,814	4,814		4,814
972	201		Social Security	8,365	406	8,771		8,771
973	204		TCRS	10,443	(1,963)	8,480		8,480
974	212		Employee Medicare & Ins.	1,956	95	2,051		2,051
975	316		Contribution	5,000	(5,000)	0	7,393	7,393
976								
977			Total Libraries	160,685	82	160,767	7,393	168,160

Loudon County  
General Fund 101  
Ending June 30, 2006

	A	B	C	D	E	F	G	H
1			<b>General Fund 101</b>					
2	<b>Account</b>		12/10/2005 16:20	<b>2006</b>	<b>2006</b>	<b>Approved</b>	<b>Proposed</b>	<b>Proposed</b>
3	<b>Number</b>			<b>Org Bgt</b>	<b>Amds</b>	<b>Amded Bgt</b>	<b>Amds</b>	<b>Amded Budget</b>
4								
1065								
1066	58600	Employee Benefits	<b>\$26,287 - Bldg Codes; \$35,856 - DGA Reimb</b>				<b>Increase in Sr Health perscriptions</b>	
1067	201	Social Security		0		0		0
1068	204	State Retirement		0		0		0
1069	205	Employee and Dependent Insurance		1,547,500	62,143	1,609,643	2,500	1,612,143
1070	210	Unemployment Compensation		32,000		32,000		32,000
1071	212	Employer Medicare		0		0		0
1072	513	Workman's Compensation		220,000		220,000		220,000
1073	530	Fines, Assessments, & Penalties		3000		3000		3,000
1074								
1075		Total Employee Benefits		1,802,500	62,143	1,864,643	2,500	1,867,143

1248



Loudon County  
General Fund 101  
Ending June 30, 2006

	A	B	C	D	E	F	G	H
1			<b>General Fund 101</b>					
2	<b>Account</b>		12/12/2005 13:39	2006	2006	Approved	Proposed	Proposed
3	<b>Number</b>			Org Bgt	Amds	Amded Bgt	Amds	Amded Budget
4								
1098								
1099	Beginning Fund Balance (Unaudited)			1,217,292		1,217,292		1,217,292
1100			Per FY 05 Year End Closing Report					
1101								
1102	35100		Designation from FY 05 for Juvenile Program		10,000	10,000		0
1103	35160		Designation from FY 05 for Library Board			0	7,393	
1104								
1105	Total Revenue			12,604,550	605,739	13,210,289	4,250	13,214,539
1106	Transfers In			155,471	25,000	180,471	0	180,471
1107								
1108	Total Revenue and Transfers In			12,760,021	630,739	13,390,760	4,250	13,395,010
1109								
1110	Total FY 2006 YE Entries for Designations				10,000			
1111								
1112	Total Available Funds			13,977,313	640,739	14,618,052	11,643	14,629,695
1113								
1114	Expenditure Budget			12,075,462	829,089	12,904,551	14,563	12,919,114
1115	Transfers Out			0	0	0	0	0
1116								
1117	Total Expenditures and Transfer Out			12,075,462	829,089	12,904,551	14,563	12,919,114
1118								
1119	Ending Fund Balance			1,901,851	(188,350)	1,713,501	(2,920)	1,710,581
1120								
1121								
1122								
1123								
1124								
1125								

Loudon County  
General Fund 101  
Ending June 30, 2006

	A	B	C	D	E	F	G	H
1			<b>General Fund 101</b>					
2	<b>Account</b>		1/5/2006 9:20	<b>2006</b>	<b>2006</b>	<b>Approved</b>	<b>Proposed</b>	<b>Proposed</b>
3	<b>Number</b>			<b>Org Bgt</b>	<b>Amds</b>	<b>Amded Bgt</b>	<b>Amds</b>	<b>Amded Budget</b>
4								
354	51710		Cable TV Authority/Advisory					
355	101		Administrative/Legal Fees	20,000		20,000	(6,777)	13,223
356	191		Board Members	3,200		3,200	(2,000)	1,200
357	201		Social Security	0		0		0
358	204		State Retirement	0		0		0
359	212		Employer Medicare	0		0		0
360	196		In-service Training	0		0		0
361	307		Communication	1,400		1,400	0	1,400
362	320		Dues and Memberships	1,450		1,450	0	1,450
363	331		Legal Services	1,500		1,500	0	1,500
364	332		Legal Notices	1,300		1,300	0	1,300
365	355		Travel	500		500	0	500
366	399		Contractual Services	8,000		8,000	(3,630)	4,370
367	435		Office Supplies	700		700	(200)	500
368	499		Other Supplies and Materials	1,500		1,500	(1,000)	500
369	524		In Service/Staff Development	7,500		7,500	(5,235)	2,265
370	719		Equipment	4,000		4,000	(2,500)	1,500
371								
372			Total Cable TV Authority/Advisory	51,050	0	51,050	(21,342)	29,708
373								



Loudon County  
General Fund 101  
Ending June 30, 2006

1251

	A	B	C	D	E	F	G	H
1			<b>General Fund 101</b>					
2	<b>Account</b>		1/5/2006 9:07	<b>2006</b>	<b>2006</b>	<b>Approved</b>	<b>Proposed</b>	<b>Proposed</b>
3	<b>Number</b>			<b>Org Bgt</b>	<b>Amds</b>	<b>Amded Bgt</b>	<b>Amds</b>	<b>Amded Budget</b>
4								
1098								
1099	<b>Beginning Fund Balance (Unaudited)</b>			1,217,292		1,217,292		1,217,292
1100			Per FY 05 Year End Closing Report					
1101								
1102	35110		Designation from LE for Juvenile Program		10,000	10,000		0
1103	35160		Designation from FY 05 for Library Board			0	7,393	
1104								
1105	<b>Total Revenue</b>			12,604,550	605,739	13,210,289	4,250	13,214,539
1106	<b>Transfers In</b>			155,471	25,000	180,471	0	180,471
1107								
1108	<b>Total Revenue and Transfers In</b>			12,760,021	630,739	13,390,760	4,250	13,395,010
1109								
1110	<b>Total FY 2006 YE Entries for Designations</b>				10,000			
1111								
1112	<b>Total Available Funds</b>			13,977,313	640,739	14,618,052	11,643	14,629,695
1113								
1114	<b>Expenditure Budget</b>			12,075,462	829,089	12,904,551	(6,779)	12,897,772
1115	<b>Transfers Out</b>			0	0	0	0	0
1116								
1117	<b>Total Expenditures and Transfer Out</b>			12,075,462	829,089	12,904,551	(6,779)	12,897,772
1118								
1119	<b>Ending Fund Balance</b>			1,901,851	(188,350)	1,713,501	18,422	1,731,923
1120								
1121								
1122								
1123								
1124								
1125								



LOUDON COUNTY  
General Capital Projects Fund 171  
Ending June 30, 2006

1252

Exhibit G

	A	B	C	D	E	F	G	H	I	J	K	L	M	N
1														
2					12/11/05		2006	2006	2006					
3					12/11/05 5:10 PM		Original	Budget	Approved	Proposed	Proposed			
4							Budget	Amendments	Amded Budget	Amendments	Amded Budget			
5		REVENUE					2.50							
6		40000	Local Taxes				106,700							
7			40110		Current Property Taxes		266,750		266,750		266,750			
8			40120		Trustee's Pr Yr		8,000		8,000		8,000			
9			40125		Trustee's Collections-Bankruptcy		3,500		3,500		3,500			
10			40130		Clerk and Master's Pr Yr									
11														
12					Total Local Revenue		278,250	0	278,250	0	278,250			
13														
14														
15		43000	Charges for Services											
16			43190		Other General Ser Charges		0	0	0					
17														
18					Total Charges for Services		0	0	0					
19						GIS								
20		44000	Other Local Revenue											
21			44570		Contributions & Gifts		20,000		20,000		20,000			
22			44990		Other Local Revenue									
23														
24					Total Other Local Revenue		20,000	0	20,000		20,000			
25														
26		46000	State of Tennessee											
27			46290		Other Public Safety Grants (Irene Lane)		90,000		90,000		90,000			
28														
29					Total State of Tennessee		90,000	0	90,000		90,000			
30														

LOUDON COUNTY  
General Capital Projects Fund 171  
Ending June 30, 2006

1253

	A	B	C	D	E	F	G	H	I	J	K	L	M	N
1														
2					12/11/05		2006	2006	2006					
3					12/11/05 5:10 PM		Original	Budget	Approved	Proposed	Proposed			
4							Budget	Amendments	Amded Budget	Amendments	Amded Budget			
31		47000	Federal Revenue											
32			47114		USDA - Other (TASS Grant)		0		0	153,500	153,500			
33			47180		CDBG Grant (Hwy 70 Sewer)		91,000	0	91,000		91,000			
34														
35					<b>Total Direct Federal</b>		91,000	0	91,000	153,500	244,500			
36														
37		48000	Other											
38			48990		Other (TV Irene Lane)		15,000		15,000		15,000			
39														
40					<b>Total Other</b>		15,000		15,000		15,000			
41														
42		49000	Other Sources											
43			49500		Other Loans Issued		1,000,000	0	1,000,000		1,000,000			
44														
45														
46														
47					<b>TOTAL REVENUE</b>		<b>1,494,250</b>	<b>0</b>	<b>1,494,250</b>	<b>153,500</b>	<b>1,647,750</b>			
48														



LOUDON COUNTY  
General Capital Projects Fund 171  
Ending June 30, 2006

1254

	A	B	C	D	E	F	G	H	I	J	K	L	M	N
1														
2					12/11/05		2006	2006	2006					
3					12/11/05 5:10 PM		Original	Budget	Approved	Proposed	Proposed			
4							Budget	Amendments	Amended Budget	Amendments	Amended Budget			
49					<b>EXPENDITURES</b>									
50		91120			Administration of Justice Projects				Juvenile Cnr					
51			706		Building Construction		58,000	14,300	72,300		72,300			
52			321		Engineering		0	9,700	9,700		9,700			
53														
54					Justice Center - Contractor's contingency									
55					Total Adm of Justice		58,000	24,000	72,300	0	82,000			
56														
57		91130			Public Safety Projects									
58			399		Other Contracted Services		113,300		113,300		113,300			
59			791		Other Construction		0	48,000	48,000	154,000	202,000			
60														
61														
62					Total Public Safety		113,300	48,000	161,300	154,000	315,300			
63														
64		91140			Public Health and Welfare Projects									
65			706		Building Construction				100,000		100,000			
66			706		Building Construction				200,000		200,000			
67			399		Other Contracted Services				71,400		71,400			
68			499		Other Supplies & Materials				49,900		49,900			
69														
70					Total Public Health & Welfare		421,300	0	421,300	0	421,300			
71														
72		91190			Other General Government Projects									
73			791		Other Construction		0	3,000	3,000		3,000			
74														
75					Total Other Gen Gov't Projects		0	3,000	3,000	0	3,000			
76														
77														
78														
79		91150			Social Cultural and Recreation Projects									
80			321		Engineering Services				15,000		15,000			
81			706		Building Construction		769,650	253,400	1,023,050		1,023,050			
82			724		Site Development		110,000		110,000		110,000			
83														
84					Total Social, Cultural & Recreation		879,650	268,400	1,148,050	0	1,148,050			
85														



LOUDON COUNTY  
General Capital Projects Fund 171  
Ending June 30, 2006

1255

	A	B	C	D	E	F	G	H	I	J	K	L	M	N
1														
2					12/11/05		2006	2006	2006					
3					12/11/05 5:10 PM		Original	Budget	Approved	Proposed	Proposed			
4							Budget	Amendments	Amended Budget	Amendments	Amended Budget			
86		91170	Public Utility Projects											
87			321		Engineering Services		Hines Valley		0	1,000	1,000			
88			331		Legal Services		TASS Water Project		0	4,300	4,300			
89			724		Site Development		Loudon Conv Cntr		0	4,400	4,400			
90			790		Other Equipment		Loudon Conv Cntr		0	2,720	2,720			
91			791		Other Construction		Loudon Conv Cntr & Wright Bros		0	77,000	77,000			
92														
93					Total Public Utility Projects		0	0	0	89,420	89,420			
94														
95														
96														
97		58000	Miscellaneous											
98			510		Trustee's Commission		6,000		6,000		6,000			
99														
100					Total Miscellaneous		6,000	0	6,000	0	6,000			
101														
102														
103														
104					TOTAL EXPENDITURES		1,478,250	343,400	1,821,650	243,420	2,065,070			
105														
106														
107														
108														
109														
110					BEGINNING FUND BALANCE (Unaudited)		1,449,384		1,449,384		1,449,384			
111														
112					TOTAL REVENUE		1,494,250	0	1,494,250	153,500	1,647,750			
113														
114					TOTAL AVAILABLE FUNDS		2,943,634	0	2,943,634	153,500	3,097,134			
115														
116														
117					TOTAL EXPENDITURE/TRFS		1,478,250	343,400	1,821,650	243,420	2,065,070			
118														
119														
120														
121														
122					ENDING FUND BALANCE		1,465,384	(343,400)	1,121,984	(89,920)	1,032,064			

Per FY 05 Year End  
Closing Report



Loudon County  
General Debt Service 151  
Ending June 30, 2006

Exhibit H

	A	B	C	D	E	F	G	H	I	J	K	L	M
1													
2					12/12/05	2006	Approved	2006	Proposed	Proposed			
3					12/12/05 10:52 AM	Budget	Amds	Amd	Amds	Amded			
4					Fund 151 General Debt Service			Budget		Budget			
5			REVENUE										
6		40000	Local Taxes										
7			40110		Current Property Taxes	1,013,650		1,013,650		1,013,650			
8			40120		Trustee's Pr Yr	30,000		30,000		30,000			
9			40125		Banruptcy	0		0		0			
10			40130		Clerk and Master's Pr Yr	15,000		15,000		15,000			
11			40140		Interest and Penalty	6,000		6,000		6,000			
12			40150		Pickup Taxes	0		0		0			
13			40320		Bank Excise Tax	0		0		0			
14													
15					Total Local Revenue	1,064,650	0	1,064,650	0	1,064,650			
16													
17		44000	Other Local Revenue										
18			44110		Interest Earned	58,606		58,606		58,606			
19			44170		Miscellaneous	0		0		0			
20			44514		Revenue from Joint Ventures	141,500		141,500	16,100	157,600			
21			44990		Other Local Revenue	0		0		0			
22													
23					Total Other Local Revenue	200,106	0	200,106	16,100	216,206			
24													
25			TOTAL REVENUE			1,264,756	0	1,264,756	16,100	1,280,856			
26													
27		49000	Other Sources										
28			49800		Transfers In	101,130		101,130		101,130			
29													
30			TOTAL TRANSFERS			101,130	0	101,130	0	101,130			
31													
32			TOTAL REVENUE AND TRANSFERS IN			1,365,886	0	1,365,886	16,100	1,381,986			



Loudon County  
General Debt Service 151  
Ending June 30, 2006

1257

	A	B	C	D	E	F	G	H	I	J	K	L	M
1													
2					12/12/05	2006	Approved	2006	Proposed	Proposed			
3					12/12/05 10:52 AM	Budget	Amds	Amd	Amds	Amded			
4					Fund 151 General Debt Service			Budget		Budget			
33													
34					EXPENDITURES								
35													
36					82110 Principal - General Government								
37			601 300K		Principal on Bonds (Ind Park 97-03)	10,000		10,000		10,000			
38			601 5.36M		Principal on Bonds (Pub Imp 12-1-99)	115,000		115,000		115,000			
39			601 2.015M		Principal on Bonds (Gen Obl 2002)	110,000		110,000		110,000			
40			601 5.225M		Principal on Bonds (Gen Obl 2004)	50,000		50,000		50,000			
41													
42					Total Principal on Bonds	285,000	0	285,000	0	285,000			
43													
44			612 5M		Principal on Loans (TCSA 2002)	282,000		282,000		282,000			
45			612 1M		Principal on Loans (II F4)	95,000		95,000		95,000			
46			612 2.7M		Principal on Loans (VI C-4)	240,000		240,000		240,000			
47			612 3M		Principal on Loans (II E3)	150,000		150,000		150,000			
48													
49					Total Principal on Loans	767,000	0	767,000	0	767,000			
50													
51					Total General Gov't Principal	1,052,000	0	1,052,000	0	1,052,000			
52													
53					82210 Interest - General Government								
54			603 300K		Interest on Bonds (Ind Park 97-03)	7,900		7,900		7,900			
55			603 5.36M		Interest on Bonds (Pub Imp 12-1-99)	29,250		29,250		29,250			
56			603 2.015M		Interest on Bonds (Gen Obl 2002)	17,650		17,650		17,650			
57			603 5.225M		Interest on Bonds (Gen Obl 2004)	181,230		181,230		181,230			
58													
59					Total Interest on Bonds	236,030	0	236,030	0	236,030			
60													
61			613 5M		Interest on Loans (TCSA 2002)	223,650		223,650		223,650			
62			613 1M		Interest on Loans (II F4)	20,500		20,500		20,500			
63			613 2.7M		Interest on Loans (VI C-4)	66,250		66,250		66,250			
64			613 3M		Interest on Loans (II E3)	150,000		150,000		150,000			
65													
66					Total Interest on Loans	460,400	0	460,400	0	460,400			
67													
68					Total General Gov't Interest	696,430	0	696,430	0	696,430			
69													
70					82310 Other - General Government								



Loudon County  
General Debt Service 151  
Ending June 30, 2006

1258

	A	B	C	D	E	F	G	H	I	J	K	L	M
1													
2					12/12/05	2006	Approved	2006	Proposed	Proposed			
3					12/12/05 10:52 AM	Budget	Amds	Amd	Amds	Amded			
4					Fund 151 General Debt Service			Budget		Budget			
71			510		Trustee's Commission	30,000		30,000		30,000			
72			699		Other Debt Service (Fees)	7,500		7,500		7,500			
73			699 TASS		Other Debt Service (W&T 1998 TASS)	43,400		43,400		43,400			
74			699 TASS		Other Debt Service (91-04 TASS)	49,500		49,500		49,500			
75			699 TASS		Other Debt Service (IV E6 TASS)	48,600		48,600		48,600			
76			699 TASS		Other Debt Service (91-07 TASS)				16,100	16,100			
77													
78					Total Other General Government	179,000	0	179,000	16,100	195,100			
79													
80													
81													
82													
83													
84													
85			TOTAL EXPENDITURES			1,927,430	0	1,927,430	16,100	1,943,530			
86													
87					TOTAL REVENUE and TRFS IN	1,365,886	0	1,365,886	16,100	1,381,986			
88					TOTAL EXPENDITURES/TRFS OUT	1,927,430	0	1,927,430	16,100	1,943,530			
89					EFFECT ON FUND BALANCE	(561,544)	0	(561,544)	0	(561,544)			
90													
91					BEGINNING FUND BALANCE	2,350,085	0	2,350,085	0	2,350,085			
92													
93			39000		ENDING FUND BALANCE	1,788,541	0	1,788,541	0	1,788,541			
94													
95													
96													

## Exhibit I



Account Number	Description	Original Budget Budget Total	Previous Amendments	Current Amendment	Amended Budget Total
71100-195	Certified Substitute Teachers	\$ -	\$ 5,000.00	\$ 45,000.00	\$ 50,000.00
71100-198	Non-Certified Substitute Teachers	\$ 178,100.00	\$ (5,000.00)	\$ (45,000.00)	\$ 128,100.00
71200-163	Educational Assistants	\$ 54,988.00	\$ -	\$ 7,800.00	\$ 62,788.00
71200-201	Social Security	\$ 68,985.00	\$ -	\$ 481.00	\$ 69,466.00
71200-204	State Retirement	\$ 61,914.00	\$ -	\$ 601.00	\$ 62,515.00
71200-206	Life Insurance	\$ 5,544.00	\$ -	\$ 126.00	\$ 5,670.00
71200-207	Medical Insurance	\$ 169,357.00	\$ -	\$ 3,690.00	\$ 173,047.00
71200-208	Dental Insurance	\$ 8,159.00	\$ -	\$ 189.00	\$ 8,348.00
71200-212	Employer Medicare	\$ 16,174.00	\$ -	\$ 113.00	\$ 16,287.00
71200-399	Other Contracted Services	\$ 227,000.00	\$ (27,869.00)	\$ 10,500.00	\$ 209,631.00
72210-355	Travel	\$ 1,000.00	\$ -	\$ 15,500.00	\$ 16,500.00
				\$ 39,000.00	
39000 Undesignated Fund Balance				\$ (39,000.00)	

A. Edwards H. ~~Miller~~

Approved by the board of education on November 10, 20