

# LOUDON COUNTY COMMISSION WORKSHOP

Monday, June 21, 2010  
Loudon County Office Building  
6:00 pm

1. **This is the time for audience members to speak on items on or not on the Agenda.**
  
2. **Kramer & Rayson Attorneys - Bob Bowman**
  - a. Lawsuit
  
3. **Loudon County Planning and Codes - Russ Newman**
  - a. A Resolution Amending the Zoning Map of Loudon County, Tennessee, Pursuant to Chapter Seven, § 13-7-105 of the Tennessee Code Annotated, to Rezone Approximately 8.8 Acres from R-1 (Suburban-Residential) to A-2 (Rural- Residential). Referenced by Tax Map 5, Part of Parcel 105.00, Located on Waller Ferry Road at the Northeast Intersection of Hwy 321 North, 5th Legislative District.
  - b. Consideration of a Loudon County Water Quality Buffer Resolution
  
4. **Loudon County Mayor - Doyle Arp**
  - a. Resolution to Affirm Compliance with Federal Title VI Regulations
  - b. Resolution to Adopt the Strategic Economic Development Plan
  - c. Five Year Asset Based Strategic Economic Development Plan 2010-2014
  - d. Loudon County Hospital Advisory Board Appointments
  
5. **Loudon County Commissioner - Harold Duff**
  - a. Tennessee Legislative Update
  
6. **Loudon County Budget Director - Tracy Blair**
  - a. Budget Committee Recommendations
  
7. **Any Other Items**

RESOLUTION

**A RESOLUTION AMENDING THE ZONING MAP OF LOUDON COUNTY, TENNESSEE, PURSUANT TO CHAPTER SEVEN, §13-7-105 OF THE TENNESSEE CODE ANNOTATED, to Rezone Approximately 8.8 acres from R-1 (Suburban-Residential) to A-2 (Rural-Residential). Referenced by: Tax Map 5, part of Parcel 105.00, located on Waller Ferry Road at the northeast intersection of Hwy 321 North, 5<sup>th</sup> Legislative District.**

**WHEREAS**, the Loudon County Commission, in accordance with Chapter Seven, §13-7-105 of the Tennessee Code Annotated, may from time to time, amend the number, shape, boundary, area or any regulation of or within any district or districts, or any other provision of any zoning resolution, and

**WHEREAS**, the Regional Planning Commission has forwarded a recommendation regarding the amendment to the Zoning Map of Loudon County, Tennessee,

**WHEREAS**, a notice of public hearing and a description of the resolution appeared in the Loudon County News Herald on June 17/18, 2010 consistent with the provisions of Tennessee Code Annotated, §13-7-105,

**NOW, THEREFORE, BE IT RESOLVED** by the Loudon County Commission that the Zoning Map of Loudon County, Tennessee be amended as follows:

Located on Waller Ferry Road at the northwest intersection of Waller Ferry Road and Highway 321 north, situated in the 5<sup>th</sup> Legislative District, referenced by Tax Map 5, Part of Parcel 105.00 be rezoned from R-1, Suburban Residential District to A-2, Rural Residential, as shown on the attached map; said map being part of this Resolution.

**BE IT FINALLY RESOLVED**, that this Resolution shall take effect immediately, the public welfare requiring it.

\_\_\_\_\_  
ATTEST

\_\_\_\_\_  
LOUDON COUNTY CHAIRMAN  
DATE: \_\_\_\_\_

\_\_\_\_\_  
APPROVED: LOUDON COUNTY MAYOR

The votes on the question of approval of this Resolution by the Planning Commission are as follows:

APPROVED: 8

DISAPPROVED: 0

*Patricia G. McLean*  
ATTEST: SECRETARY LOUDON COUNTY  
REGIONAL PLANNING COMMISSION  
Dated: May 18, 2010

FILE # [10-04-31-RZ-CO]

Rezone approximately 8.8 acres from R-1 (Suburban-Residential) to A-2 (Rural-Residential). Referenced by: Tax Map 5, part of Parcel 105.00, located on Waller Ferry Road at the northeast intersection of Hwy 321 North, 5<sup>th</sup> Legislative District

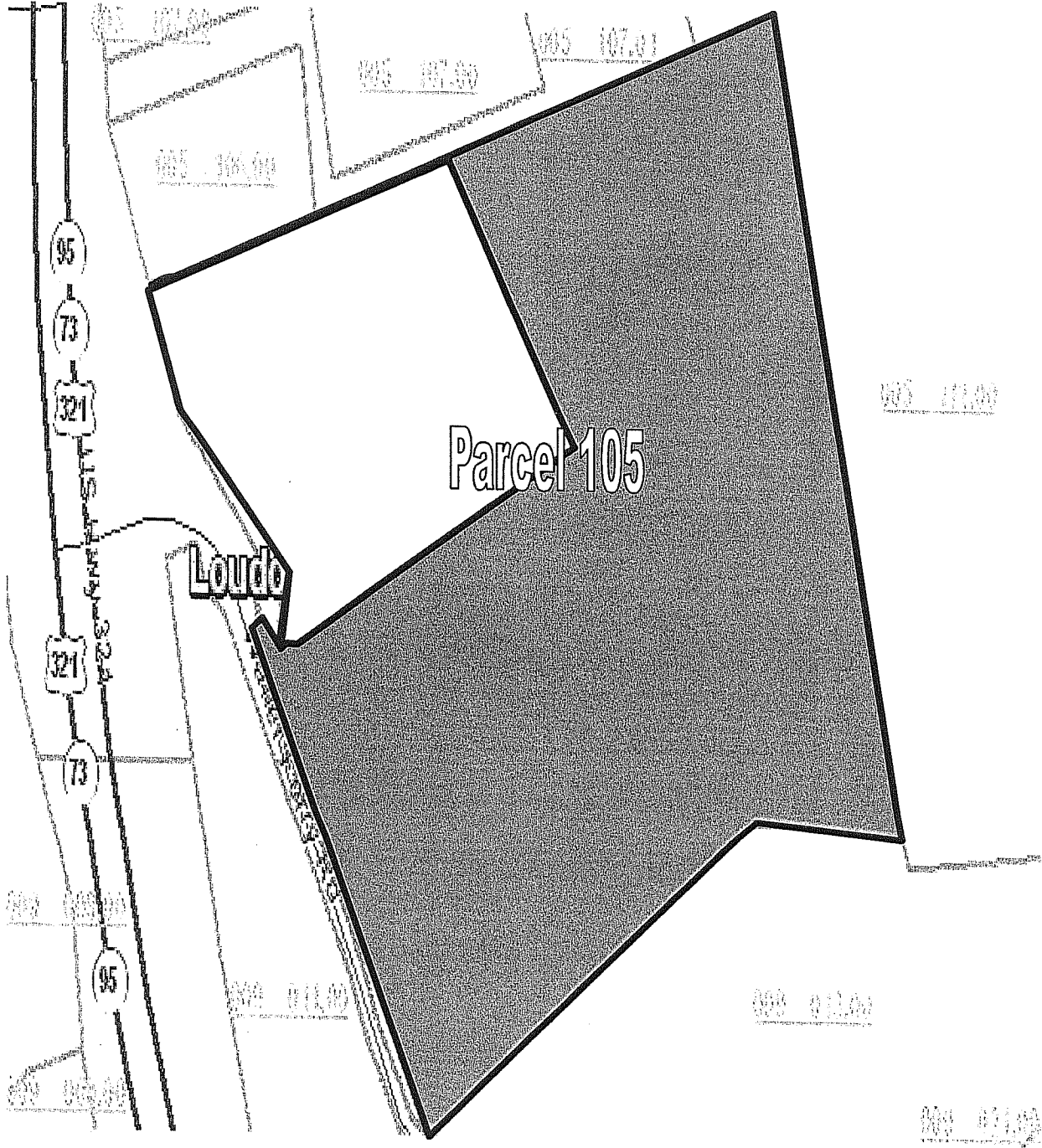

**RESOLUTION TO AFFIRM COMPLIANCE WITH  
FEDERAL TITLE VI REGULATIONS**

**WHEREAS**, both Title VI of the Civil Rights Act of 1964 and the Civil Rights Restoration Act of 1987 provide that no person in the United States shall, on the ground of race, color or national origin be excluded from participation in, be denied the benefits of or be subjected to discrimination under any program or activity receiving federal financial assistance; and

**WHEREAS**, the Tennessee Attorney General opined in Opinion No. 92.47 that state and local governments are required to comply with Title VI of the Civil Rights Act in administering federally funded programs; and

**WHEREAS**, the Community Development Division of the Tennessee Department of Economic and Community Development administers the Three-Star Program and awards financial incentives for communities designated as Three-Star communities; and

**WHEREAS**, by virtue of the Tennessee Department of Economic and Community Development receiving federal financial assistance all communities designated as Three-Star communities must confirm that the community is in compliance with the regulations of Title VI of the Civil Rights Act of 1964 and the Civil Rights Restoration Act of 1987;

**NOW, THEREFORE, BE IT RESOLVED**, by the county legislative body of \_\_\_\_\_ County, Tennessee, meeting in regular session at \_\_\_\_\_, Tennessee, that:

**SECTION 1.** The legislative body of \_\_\_\_\_ County declares that the county is in compliance with the federal Title VI regulations.

**SECTION 2.** The Department of Economic and Community Development may from time to time monitor the county's compliance with federal Title VI regulations.

**SECTION 3.** This Resolution shall take effect upon adoption, the public welfare requiring it.

Adopted this \_\_\_\_\_ day of \_\_\_\_\_, 20\_\_\_\_.

APPROVED:

\_\_\_\_\_  
County Mayor

ATTEST:

**RESOLUTION TO ADOPT THE STRATEGIC  
ECONOMIC DEVELOPMENT PLAN**

**WHEREAS**, the Three-Star Program was developed to meet the needs and challenges of the evolving economic environment in urban and rural communities and to partner with communities to create opportunities for sustained economic growth; and

**WHEREAS**, communities seeking certification as a Three-Star community must meet certain criteria, including the adoption of a five-year strategic economic development plan; and

**WHEREAS**, in achieving the mission of the Three-Star Program, the Department of Economic and Community Development commits to assist communities in developing and implementing a strategic economic plan;

**NOW, THEREFORE, BE IT RESOLVED**, by the county legislative body of \_\_\_\_\_ County, Tennessee, meeting in regular session at \_\_\_\_\_, Tennessee, that:

**SECTION 1.** The legislative body of \_\_\_\_\_ County declares that the county has adopted a five-year strategic economic development plan to be updated annually.

**SECTION 2.** The strategic economic development plan includes the county's economic goals in promoting economic growth, a plan to accomplish those goals and a projected timeline in achieving those goals.

**SECTION 3.** The strategic economic development plan addresses the county's goals pertaining to existing industry, manufacturing recruitment, workforce development, retail/service, tourism, agriculture, infrastructure assessment and educational assessment.

Adopted this \_\_\_\_\_ day of \_\_\_\_\_, 20\_\_\_\_\_.

APPROVED:

\_\_\_\_\_  
County Mayor

ATTEST:



**Loudon County, Tennessee**

*Five Year Asset Based  
Strategic Economic Development Plan  
2010 - 2014*

# Loudon County, Tennessee

## *2010 Three-Star Program*

Loudon County, Tennessee is participating in the Tennessee Three-Star Communities Program, administered by the Tennessee Department of Economic and Community Development (ECD). This program is designed to assist our community to achieve excellence in community and economic development.

As a required element of the program, the five-year strategic economic development plan is to be updated annually. This plan must include goals, a projected timeline for achieving the goals, and an agency responsible for coordinating the goals. The strategic plan must address agriculture, education, existing industries, infrastructure, manufacturing recruitment, retail/services, tourism, and workforce development. Other areas may be addressed at the discretion of the community.

The Joint Economic and Community Development Board (JECDB) is assisting in the preparation of the application for Three Star certification. A committee consisting of representation from the Loudon County Chamber of Commerce, Economic Development Agency, Loudon County Planning Office, Loudon County Education Foundation, Loudon County Visitors Bureau, Loudon County Workforce Development and the Loudon County Agriculture Extension Service was formed to prepare the necessary strategic plan.

The Committee, with input from several community agencies and with their own knowledge and insight, prepared the goals and actions in this document.

This plan is not a feasibility study, an economic analysis or forecast, a marketing plan, or a comprehensive community development plan. It is, however, a genuine attempt to determine key issues facing Loudon County and to outline an agenda for achieving a prosperous future. The purpose has been to stimulate ideas, build consensus, and generate support for action by a variety of public and private entities. Detailed implementation steps for the recommendations in this plan will have to be developed by the appropriate responsible entities. Also, this plan should be updated annually to monitor progress and identify new goals and actions. This plan should help local leaders to periodically ask: Are we making progress?

**Loudon County  
Five Year Strategic Plan**

<b>Loudon County Five Year Strategic Plan</b>	<b>Planning and Infrastructure Development</b>					
	<b>2010</b>	<b>2011</b>	<b>2012</b>	<b>2013</b>	<b>2014</b>	<b>Responsibility</b>
<b>GOALS:</b>						
Hwy. 321 Fort Loudoun Bridge and Tellico River Bridge Replacement	X	X	X	X	X	Loudon County/Lenoir City
Implementation of Corridor Study of Hwy. 321	X	X	X	X	X	Loudon County/Lenoir City
Development of Low Impact Development Regulations	X	X	X	X	X	Loudon County
Hwy. 321 continuous center turn lane from McGhee Blvd. to Town Creek Road	X	X	X	X	X	Lenoir City
Hwy. 11 4-laning/realignment from Lenoir City to Hwy. 70	X	X	X	X	X	Loudon County
Simmons Rd./Port Madison/Hwy 11 intersection realignment/widening	X	X	X	X	X	Loudon County
Shaw Ferry intersection improvements	X	X	X	X	X	Loudon County
Hwy. 70/Hwy. 11 intersection improvements	X	X	X	X	X	Loudon County/Lenoir City
Hwy. 72 widening/realignment from Pond Creek Bridge to Stockton Valley Road	X	X	X	X	X	Loudon County



<b>Hwy. 72 at Maremont Road Signalization</b>	<b>X</b>	<b>X</b>	<b>X</b>	<b>X</b>	<b>X</b>	<b>Loudon County/Loudon City</b>
<b>Sugar Limb Rd./Hwy. 11 Intersection Improvements (Signalization/Roundabout)</b>	<b>X</b>	<b>X</b>	<b>X</b>	<b>X</b>	<b>X</b>	<b>Loudon County</b>
<b>Improve Broadway/321 with construction of Signature Intersection</b>	<b>X</b>	<b>X</b>	<b>X</b>	<b>X</b>	<b>X</b>	<b>Lenoir City</b>

**Strategic Priority - Planning and Infrastructure Development:**

**Replace existing bridge over Fort Loudoun Dam**

**1. Who are the stakeholders for this strategic priority? How will they benefit?**

("Stakeholders" refers to all groups that might be affected by your community's actions and success)

Stakeholders	Benefit to Stakeholders
1. Residents	Homeland Security, traffic control
2. Entire Region	Traffic flow
3. Tourism	Traffic flow, better access to mountains
4. Industry	Transportation, traffic flow
5.	

**2. Action Planning with SMART goals.** (SMART goals are Specific; Measurable; Achievable; Realistic; Time-bound)

#	WHAT (Goal)	HOW (Action: Strategy & Process)	WHO (Owner)	WHEN (Milestones)	MEASURES (How will you now?)	RESOURCES (What will you need?)	✓ (Do you have?)
1	Increased Traffic Flow	Surveys, infrastructure, funding	Pat Phillips, LCEDA  Kathy Knight, LCEDA	Dec. 2010	Better traffic flow, increased tourism, increased industry.	40 – 60 million dollars	Surveys, plans ready
2	Increased Tourism	Surveys, infrastructure, funding	Doyle Arp, Loudon County Mayor				
3	Increased Industry	Surveys, infrastructure, funding	Matt Brookshire, Lenoir City Mayor				

### 3. Cycles of Improvement

WHAT (Goal)	WHEN (Milestones)	MEASURES	RESULTS	WHAT WENT RIGHT? +	WHAT WENT WRONG? -	WHAT WILL WE CHANGE?	NEXT STEPS
Ft. Loudon Bridge Replacement	2010-2014	State funding needed	Design and R.O.W. required		State funding not approved yet	Encourage state to fund construction	Waiting for State Bridge Bond funding
Ft. Loudon Bridge Replacement	2010-2014	Plans ready					Bids to be accepted Dec. 11, 2010
Ft. Loudon Bridge Replacement	2010-2014	Funding		Support of our local government. delegation	Money not available through TDOT		General Assembly hoping to pass bridge bonds

Loudon County Five Year Strategic Plan	Community Development					
	2010	2011	2012	2013	2014	Responsibility
<b>GOALS:</b>						
Establish a database listing volunteer opportunities throughout the community	X	X	X	X	X	Health Education Alliance of Loudon County
Complete downtown Loudon greenway and fountain triangle redevelopment projects	X					Loudon City
Extend Lenoir City greenway from Lenoir City Middle School through Town Creek development to Hwy. 321	X	X				Lenoir City
Provide public water service to Hotchkiss Valley residents	X					LCUB/Loudon County
Consider Main Street programs for Lenoir City and Loudon to facilitate downtown revitalization	X	X				Loudon/Lenoir City
Construct planned new school buildings in Loudon County	X	X	X	X	X	Loudon County
Construct new municipal/utility facilities in Lenoir City	X	X	X	X		Lenoir City
Recruitment of a new postal facility in Lenoir City	X	X				Lenoir City/EDA
Continue growth in planned residential retirement communities	X	X				Loudon/Lenoir City
Support and assist growth at TRDA of Loudon County developments	X	X	X			Loudon
Review medical growth needs of the community	X	X				Ft. Loudoun Medical Center

--	--	--	--	--	--	--

**Strategic Priority – Community Development:**

**Establish a database listing volunteer opportunities throughout the community**

**1. Who are the stakeholders for this strategic priority? How will they benefit?**

("Stakeholders" refers to all groups that might be affected by your community's actions and success)

<b>Stakeholders</b>	<b>Benefit to Stakeholders</b>
1. Agencies	Free help, in-kind donations
2. Schools	Free help, in-kind donations
3. Non-Profit Organizations	Free help, in-kind donations
4. Volunteers	Free help, in-kind donations
5.	

**2. Action Planning with SMART goals.** (SMART goals are Specific; Measurable; Achievable; Realistic; Time-bound)

#	WHAT (Goal)	HOW (Action: Strategy & Process)	WHO (Owner)	WHEN (Milestones)	MEASURES (How will you now?)	RESOURCES (What will you need?)	✓ (Do you have?)
1	Establishing a database listing volunteer opportunities throughout the community.	Contact agencies, schools, and non-profit organizations for volunteer opportunities.	Debbie Henry, Health Education Alliance of Loudon County	September 2009	Receive volunteer opportunities from groups and organizations.	Information from organizations	
		Establish database listing Volunteer opportunities.				Ways to share information	
		Review the Leadership Loudon County Alumni volunteer brochure.				LEAD brochure	
		Find funding sources for printing, distribution, etc.				Funding	

### 3. Cycles of Improvement

WHAT (Goal)	WHEN (Milestones)	MEASURES	RESULTS	WHAT WENT RIGHT? +	WHAT WENT WRONG? -	WHAT WILL WE CHANGE?	NEXT STEPS
Establish volunteer opportunity database in community	Jan. 2011	Gathering and compiling all information		Venue in place to go to for starting the database	Difficult to get info from all parties		Compilation of information for database



Loudon County Five Year Strategic Plan	Leadership Development					
	2010	2011	2012	2013	2014	Responsibility
<b>GOALS:</b>  <b>Encourage all members of City Councils to attend Three-Star training sessions</b>  <b>Chamber sponsored required in-service for all City and County Elected Officials</b>  <b>Community Connections Visit</b>  <b>Provide Adult and Youth Leadership training</b>	X					City Mayors  Chamber/County Mayor City Mayors  Chamber/EDA/County Mayor  LCEF

--	--	--	--	--	--	--

**Strategic Priority - Leadership Development:**

**Encourage all members of City Councils to attend Three-Star training session.**

**1. Who are the stakeholders for this strategic priority? How will they benefit?**

("Stakeholders" refers to all groups that might be affected by your community's actions and success)

Stakeholders	Benefit to Stakeholders
1. City Government	Grant reductions
2. Residents	Better informed officials
3.	
4.	
5.	

**2. Action Planning with SMART goals. (SMART goals are Specific; Measurable; Achievable; Realistic; Time-bound)**

#	WHAT (Goal)	HOW (Action: Strategy & Process)	WHO (Owner)	WHEN (Milestones)	MEASURES (How will you now?)	RESOURCES (What will you need?)	✓ (Do you have?)
1	Better informed councils	MTAS Training USDA Training TVA Training State of Tennessee training	City Mayors	June 30, 2009	Our Regional Economic Development Specialist	Commitment from elected officials  Meeting space	
2	Represent Loudon County better	MTAS Training USDA Training TVA Training State of Tennessee training	City Mayors	June 30, 2009	Our Regional Economic Development Specialist	Commitment from elected officials  Meeting space	

### 3. Cycles of Improvement

WHAT (Goal)	WHEN (Milestones)	MEASURES	RESULTS	WHAT WENT RIGHT? +	WHAT WENT WRONG? -	WHAT WILL WE CHANGE?	NEXT STEPS
Encourage all members of City Councils to attend Three Star training sessions	2011	City and County Mayors encouraging council members	Some members attended training	All of Philadelphia city council attended training	Election year		Continue to encourage those remaining in office and those who will be newly elected to attend

Loudon County Five Year Strategic Plan	Economic Development					
	2010	2011	2012	2013	2014	Responsibility
<b>GOALS:</b>						
Redevelopment of Lenoir City Car Works	X					LCEDA/Loudon County
Host annual industry appreciation/recognition luncheon event	X	X	X	X	X	LCEDA
Identify and present PEAK (Performance, Excellence, Achievement, Knowledge/Innovation) Awards to existing industries that excel in corporate social responsibility, innovation and performance	X	X	X	X	X	LCEDA
Schedule 2-3 corporate outreach visits of area industries	X	X	X	X	X	LCEDA
Complete E-Synchronist existing industry surveys tool to identify industry trends, shifts in industry, and any concerns or needs of location industries	X	X	X	X	X	LCEDA
Work with local companies to identify opportunities for State Incumbent Worker Program grants	X	X	X	X	X	LCEDA
Develop an existing industry expansion incentive program	X	X	X	X	X	LCEDA
Work with Innovation Valley, Inc., in creating a regional existing industry program	X	X	X	X	X	LCEDA
Initiate a Labor Market Study that focuses on labor market trends, wages, and underemployment	X	X				LCEDA

<b>Work with other east Tennessee counties to develop and implement a plan to improve air quality attainment status</b>	X	X	X	X	X	Loudon County
<b>Partner with East Tennessee Economic Development Agency in recruitment efforts directed towards location consultants and targeted industry sectors</b>	X	X	X	X	X	LCEDA
<b>Prepare updated marketing materials on available industrial sites</b>	X	X	X	X	X	LCEDA
<b>Evaluate the need for a comprehensive business recruitment incentive program to maintain the areas competitiveness</b>	X	X	X	X	X	LCEDA
<b>Concentrate recruiting on clean manufacturing industry that will have a minimum impact on the environment</b>	X	X	X	X	X	LCEDA
<b>Schedule monthly visits with local business representatives</b>	X	X	X	X	X	Chamber
<b>Maintain a comprehensive existing business directory</b>	X	X	X	X	X	Chamber
<b>Establish a County Conference Center</b>	X	X	X			Loudon County
<b>Work to keep unemployment rates low</b>	X	X		X	X	Loudon Co/EDA/Career Ctr.
<b>Gather data on local businesses to identify products and services offered. Use data to identify product needs and new businesses to target.</b>	X	X	X	X	X	LCEDA/Chamber
<b>Provide local businesses with training, counseling and resource information</b>	X	X	X	X	X	Chamber
<b>Offer an annual customer service training program to assist businesses to improve customer relations</b>	X	X	X	X	X	Loudon Co Visitors Bureau
<b>Annually develop and maintain a marketing presentation that shows Loudon County's ranking in income, housing values, growth, and retail losses</b>	X	X	X	X	X	LCEDA

Industry Survey with Innovation Valley	X					LCEDA
Attainment for Ozone	X					LCEDA

**Strategic Priority - Economic Development:**

**Redevelopment of Lenoir City Car Works.**

**1. Who are the stakeholders for this strategic priority? How will they benefit?**

("Stakeholders" refers to all groups that might be affected by your community's actions and success)

Stakeholders	Benefit to Stakeholders
1. Residents	Job creation, environmental improvement
2. Incoming industry	Suitable site
3. Existing industry	Expansion
4. Local Government	Income tax base
5.	

2. **Action Planning with SMART goals.** (SMART goals are Specific; Measurable; Achievable; Realistic; Time-bound)

#	WHAT (Goal)	HOW (Action: Strategy & Process)	WHO (Owner)	WHEN (Milestones)	MEASURES (How will you now?)	RESOURCES (What will you need?)	✓ (Do you have?)
1	Create additional jobs	Redevelopment plan	Pat Phillips, Loudon County EDA	December, 2009	TDEC will tell us	One million dollars	
2	Improve environment	Environmental studies	Kathy Knight, Loudon County EDA			Local assistance	
3	Suitable site for new industry	Local grant between county and cities	Doyle Arp, Loudon County Mayor			Cooperation from Norfolk Southern Railway	
4	Room for existing industry to expand		Matt Brookshire, Lenoir City Mayor				
5	Better income tax base						



### 3. Cycles of Improvement

WHAT (Goal)	WHEN (Milestones)	MEASURES	RESULTS	WHAT WENT RIGHT? +	WHAT WENT WRONG? -	WHAT WILL WE CHANGE?	NEXT STEPS
Redevelopment of Lenoir City Car Works	Late 2010	Norfolk & TDEC looking at options		Meeting with TDEC quarterly	1 <sup>st</sup> plan for property fell through		Remains an industrial priority for county Continue to work with TDEC on options
Redevelopment of Lenoir City Car Works			Previous actions led Norfolk Southern to reconsider development strategies for property	Actions caused delays by Norfolk Southern to change original strategies			

Loudon County Five Year Strategic Plan	Education/Workforce Development					
	2010	2011	2012	2013	2014	Responsibility
<b>GOALS:</b>						
Create a combined Education Coalition to benefit Workforce Development	X	X	X	X	X	LCEF/HEAL/RSCC/LCEDA/ UT Extension/Career Center/ Literacy Council
Establish an Education Committee through the Loudon County Education Foundation to assess current local education status and future needs	X	X	X	X	X	LCEF
Maintain an Educational Institution Inventory for all levels	X	X	X	X	X	Education Committee
Work with both school systems to identify and support future needs	X	X	X	X	X	Education Committee
Actively support the long-range goals of both school systems	X	X	X	X	X	LCEF/Education Committee
Actively support each school's School Improvement Plan	X	X	X	X	X	LCEF/Education Committee
Encourage the community and local government to assist in meeting identified needs including funding	X	X	X	X	X	LCEF/Education Committee
Support schools in meeting the needs of all populations	X	X	X	X	X	LCEF/Education Committee
Work with both school systems on student retention and graduation rates	X	X	X	X	X	LCEF/Education Committee
Support Adult Literacy Programs	X	X	X	X	X	LCEF/Education Committee

<b>Support efforts to develop a well-educated &amp; prepared workforce</b>	<b>X</b>	<b>X</b>	<b>X</b>	<b>X</b>	<b>X</b>	<b>LCEF /Education Committee</b>
<b>Encourage Roane State to offer increased higher education opportunities in Loudon County</b>	<b>X</b>	<b>X</b>	<b>X</b>	<b>X</b>	<b>X</b>	<b>LCEF/Education Committee</b>
<b>Recognize student achievement/teacher excellence at annual event</b>	<b>X</b>	<b>X</b>	<b>X</b>	<b>X</b>	<b>X</b>	<b>LCEF</b>
<b>Promote lifelong learning in Loudon County from pre-school programs through adult education</b>	<b>X</b>	<b>X</b>	<b>X</b>	<b>X</b>	<b>X</b>	<b>LCEF/Education Committee</b>
<b>Conduct an analysis of current and future needs of local employers</b>	<b>X</b>	<b>X</b>	<b>X</b>	<b>X</b>	<b>X</b>	<b>Career Center/Chamber</b>
<b>Continue with Workforce Development through the Career Center System, Economic Development, Workforce Development Board, and Educational Systems</b>	<b>X</b>	<b>X</b>	<b>X</b>	<b>X</b>	<b>X</b>	<b>Career Center</b>
<b>Utilize current job training facilities for manufacturing and beyond</b>	<b>X</b>	<b>X</b>	<b>X</b>	<b>X</b>	<b>X</b>	<b>Career Center</b>
<b>Increase concentration and awareness of technical and vocational career skills</b>	<b>X</b>	<b>X</b>	<b>X</b>	<b>X</b>	<b>X</b>	<b>Career Center/Chamber</b>
<b>Market and deliver career oriented services to new and existing companies to address hiring needs, especially the Career Readiness Certificates (CRC) that are being recognized across the United States</b>	<b>X</b>	<b>X</b>	<b>X</b>	<b>X</b>	<b>X</b>	<b>Career Center</b>
<b>Encourage programs that provide multi-language training</b>	<b>X</b>	<b>X</b>	<b>X</b>	<b>X</b>	<b>X</b>	<b>Career Center</b>
<b>Initiate a public awareness campaign focused on education and workforce development</b>	<b>X</b>	<b>X</b>	<b>X</b>	<b>X</b>	<b>X</b>	<b>LCEDA</b>
<b>Develop internship program with local manufacturing firms for high school and college students</b>	<b>X</b>	<b>X</b>	<b>X</b>	<b>X</b>	<b>X</b>	<b>LCEDA</b>
<b>Partner with TRDA on the creation of a Marine Institute to assist with workforce training in the boating industry</b>	<b>X</b>	<b>X</b>	<b>X</b>	<b>X</b>	<b>X</b>	<b>LCEDA</b>

--	--	--	--	--	--	--

**Strategic Priority – Education/Workforce Development:**

**Create a combined Education Coalition to benefit Workforce Development**

**1. Who are the stakeholders for this strategic priority? How will they benefit?**

("Stakeholders" refers to all groups that might be affected by your community's actions and success)

Stakeholders	Benefit to Stakeholders
1. Youth	Further education, better prepared
2. Industry	Educated workforce
3.	
4.	
5.	

2. Action Planning with SMART goals. (SMART goals are Specific; Measurable; Achievable; Realistic; Time-bound).

#	WHAT (Goal)	HOW (Action: Strategy & Process)	WHO (Owner)	WHEN (Milestones)	MEASURES (How will you now?)	RESOURCES (What will you need?)	✓ (Do you have?)
1	Create Coalition	Bring people together	Michelle Dicken, LCEF  Debbie Henry, HEAL	June 1, 2009	Establish group	Volunteer hours Meeting location	
2	Coordinate effort to educate students		Susan Williams, RSCC Susan Williamson, Loudon County Literacy Council				
3	Job Opportunities		Sheila Borders, UT Extension, Loudon County	June 1, 2009	Follow up evaluations with clientele served	Meeting locations	Yes

			Kathy Knight, LCEDA Kelley Thomas, LCCC				

### 3. Cycles of Improvement

WHAT (Goal)	WHEN (Milestones)	MEASURES	RESULTS	WHAT WENT RIGHT? +	WHAT WENT WRONG? -	WHAT WILL WE CHANGE?	NEXT STEPS
Career Readiness Certificates (CRC)	Jan. –Dec, 2009	Number of client referrals for CRC testing	215 client referrals for 2009	Several Loudon County companies hired clients who took the CRC	Not enough companies on board yet	Try to encourage CRC usage with clients and companies	Continue to work with administrative agencies to encourage and advertise CRC usage
Working with job training facilities & Increasing awareness of vocational and technical skills	Jan-Dec, 2009 Jan-April, 2010	Number of clients in training at vocational or colleges	64 in 2009 131 in 2010	Funding levels supported larger training numbers and commitments	Large amounts of lay offs overwhelmed some training facilities	Looking at more Dual Credit and youth in addition to adults	Continue to work with schools for other work-ready certifications
Memorandum of Understanding with LCEF	April/May 2010	Public awareness campaign	Developing programs that target students at risk of dropping out	Motivational speaker from disadvantaged background and now successful because of education		Get local industries involved by making students aware of what education is needed for job	Plan to take at-risk students on tours of local industries to show what education and skills are needed to work there

Educators in the Workplace Event		Bringing educators from throughout our region into our businesses	Educating our educators on what skills and educational requirements are necessary to work at our local companies	Positive feedback from event at Astec Underground in July 2009			June 2010 event to be held at Kimberly Clark
Education: Foundation for Success Program	May 2010	To increase the percentage of students in Loudon County who complete high school and go on to earn a higher degree	REACH Conference for 120 students in 5 <sup>th</sup> grade and 90 high school Sophomores held	Positive feedback from students, parents and educators		Add a trip to local industry	Continue to promote the worth of education to at-risk students in Loudon County

**Loudon County Commission**

## Loudon County Three-Star Committees & Chairpersons

### Planning and Infrastructure Development

County Mayor Doyle Arp

Lenoir City Mayor Matt Brookshire

Loudon Mayor Bernie Swiney

### Community Development

Kathy Knight, LCEDA

County Mayor Doyle Arp

### Leadership Development

Michelle Dicken, LCEF

County Mayor Doyle Arp

### Economic Development

Kathy Knight, LCEDA

Pat Phillips, LCEDA

Russ Newman, Loudon County Planning Office

### Education and Workforce Development

Wayne Honeycutt, Loudon County Schools

Wayne Miller, Lenoir City Schools

Michelle Dicken, LCEF

Kelley Thomas, Loudon County Career Center

Kathy Knight, LCEDA

### Tourism

Mary Bryant, Loudon County Visitors Center



**LOUDON COUNTY COMMISSION**

**RESOLUTION 060710**

**RESOLUTION APPROVING OR ACKNOWLEDGING BOARD OR  
COMMITTEE APPOINTMENT BY COUNTY MAYOR**

*WHEREAS*, by statute, and/or intergovernmental agreement and/or County Procedural Regulations, the County Mayor has authority to make certain committee and board appointments; and

*WHEREAS*, appointments are necessary and/or desirable at this time; and

*WHEREAS*, the County Mayor appoints the following as members of

**Loudon County Hospital Advisory Board**

<u>Appointee</u>			<u>Term Expiration</u>
Dr. Jim Cleveland	1 <sup>st</sup> Panel	1 yr. Term	January 2011
Betty Carroll	1 <sup>st</sup> Panel	1 yr. Term	January 2011
Bob Wright	1 <sup>st</sup> Panel	1 yr. Term	January 2011
Harvey Sproul	1 <sup>st</sup> Panel	1 yr. Term	January 2011
Bo Carey	2 <sup>nd</sup> Panel	2 yr. Term	January 2012
Nancy Beaty	2 <sup>nd</sup> Panel	2 yr. Term	January 2012
Jim Condra	2 <sup>nd</sup> Panel	2 yr. Term	January 2012
Kathy Knight	2 <sup>nd</sup> Panel	2 yr. Term	January 2012
Bud Guider	3 <sup>rd</sup> Panel	3 yr. Term	January 2013
George Miller	3 <sup>rd</sup> Panel	3 yr. Term	January 2013
Sam Buscetta	3 <sup>rd</sup> Panel	3 yr. Term	January 2013
Jeffrey Feike, Ex-Officio	3 <sup>rd</sup> Panel	3 yr. Term	January 2013

*NOW, THEREFORE, BE IT RESOLVED* that the Loudon County Commission, meeting in regular session assembled this 7th day of June, 2010, hereby approves or acknowledges (as appropriate), the said appointments.

\_\_\_\_\_  
COUNTY CHAIRMAN

ATTEST:

\_\_\_\_\_  
COUNTY CLERK

\_\_\_\_\_  
COUNTY MAYOR