

**LOUDON COUNTY COMMISSION  
REGULAR MEETING  
September 08, 2020**

Item #	Item	Resolution/Exhibit #
1	Public Hearing – 299 Davis Ferry Road	-----
2	Opening of Meeting	-----
3	Roll Call	
4	Election of September 2020-August 2021 Commission Chairman – Henry Cullen	-----
5	Election of September 2020 – August 2021 Vice Chair – Commissioner Brewster	-----
6	Chairman Cullen expressing thanks to commission	-----
7	Adoption for September 8, 2020 Agenda	-----
8	Approval of August 3, 2020 Commission Meeting Minutes	-----
9	General Public Comments	-----
10	Boards and Committees – Agriculture Extension Committee	Resolution 090820-A
	Boards and Committees – Animal Control Authority Advisory Board	Resolution 090820-B
	Boards and Committees – Industrial Bond/Development Board	Resolution 090820-C
	Bonds and Committees – Ethics Committee	Resolution 090820-D
	Bonds and Committees – TRDA Board	Resolution 090820-E
11	September 11 (9-11 Community Events) Information	-----
12	Re-Zone Resolution – 299 Davis Ferry Road	Resolution 090820-F
13	Raises Elected Officials FY 20-21	-----
14	County Employees Raises (2.5 % Retro to July 1, 2020)	-----
15	\$ 2500 Run LoCo	-----
16	BOE Year 2 – Five Year Capital Plan	-----
17	Budget Amendments – Funds 141	Exhibit 090820-G
	Budget Amendments – Funds 142	Exhibit 090820-H
18	\$ 3500 Increase GIS Budget	-----
19	Monthly Reports – Summary Financial Statement August 2020	Exhibit 090820-I
	Monthly Reports – Letter Comptrollers Office (Receipt and Approval of the 2020-2021 Budget)	Exhibit 090820-J
20	Notaries and Bonds	Exhibit 090820-K
21	Jail Move-In Date	-----
22	Jail Open House/ Virtual Tour	-----
23	Request for Courthouse Update for Workshop	-----
24	Adjournment	-----

**LOUDON COUNTY COMMISSOIN**  
**LOUDON COUNTY, TENNESSEE**  
**Tuesday, September 8, 2020**  
**Courthouse Annex Building**  
**6:00 P.M.**

**REGULAR COMMISSION MEETING**

**(1) Public Hearing**

A RESOLUTION AMENDING THE ZONING MAP OF LOUDON COUNTY, TENNESSEE, PURSUANT TO CHAPTER SEVEN, §13-7-105 OF THE TENNESSEE CODE ANNOTATED, TO REZONE APPROXIMATELY 1.69 ACRES FROM C-2, GENERAL COMMERCIAL DISTRICT TO C-1, RURAL CENTER DISTRICT, LOUDON COUNTY TAX MAP 050, PARCEL 193.02 LOCATED AT 299 DAVIS FERRY RD., LOUDON COUNTY, TN, SITUATED IN THE 1<sup>ST</sup> LEGISLATIVE DISTRICT

**(2) Opening of Meeting**

BE IT REMEMBERED that the Board of Commission of Loudon County convened in regular session in Loudon, Tennessee on the 8<sup>th</sup> day of September 2020.

**Commission Chairman, Henry Cullen** called the meeting to order at 6:02p.m.

**Commission Chairman, Henry Cullen** opened the County Commission Meeting by leading the Pledge of Allegiance to the Flag of the United States of America, and gave the invocation.

**(3) Roll Cal**

Upon Roll Call, the following commissioners were present: **Kelly Brewster, David Meers, Julia Hurley, Matthew Tinker, Bill Satterfield, Gary Whitfield, Henry Cullen, Harold Duff, Van Shaver and Adam Waller** (10)

Thereupon **Chariman Cullen** announced the presence of a quorum.

Also present was the **Honorable Mayor - Buddy Bradshaw, Director of Accounts and Budgets - Tracy Blair and Chief Deputy Clerk - Tammie Wampler.**

**(4) Chairman Election**

**Commission Chairman Henry Cullen** turned the meeting over to **Mayor Bradshaw**. Mayor Bradshaw opened the floor for nominations for the election of the Loudon County Commission Chairperson for September 2020 – August 2021 term.

**Commissioner Meers** made a motion to nominate commissioner Henry Cullen. The nomination was seconded by **Commissioner Waller**. There were no other nominations presented. **Commissioner Shaver** made a motion to cease nominations and it was seconded by **Commissioner Brewster**. **Mayor Bradshaw** then called for a voice vote to elect **Henry Cullen** as Commission Chairman.

Upon Voice Vote the motion **PASSED** unanimously.

**(5) Chair-Pro  
Tempore Election  
(Vice-Chair)**

**Mayor Buddy Bradshaw** announced that by unanimous vote **Commissioner Cullen** was voted to be the Commission Chairman and turned the meeting back over to **Chairman Cullen**.

**Chairman Cullen** opened the floor up for nominations for Chair-Pro Tempore for the September 2020 – August 2021 term. **Commissioner Shaver** made a motion to nominate **Commissioner Kelly Brewster** to continue as Chair-Pro Tempore and the motion was seconded by **Commissioner Waller**. **Commission Chairman Cullen**

(5)  
**CONTINUED**  
Chair-Pro  
Tempore  
Election  
(Vice-Chair)

called for any other nominations and there were not any further presented.  
**Commissioner Shaver** made a motion to cease nominations and was seconded by **Commissioner Meers**. **Commission Chairman Cullen** called for a Voice Vote to elect **Kelly Brewster** as the Chair-Pro Tempore.

Upon Voice Vote the motion **PASSED** unanimously.

(6) Chairman  
Cullen  
Expressing  
Thanks

**Commission Chairman Cullen** expressed his appreciation for the vote of confidence. He said that the past two years have been some wild years that commission has gone thru. Last year it was the jail, jailers and the budget. Chairman Cullen said this year we met up with Covid-19 which we never expected. He commented that he hopes God will bless us and get these disasters out of the way. **Commission Chairman Cullen** once again thanked the Commission.

(7) Agenda  
Adoption

**Chairman Cullen** requested that the September 8, 2020 agenda be adopted. **Commissioner Shaver** made a motion to adopt the agenda as amended and the motion was seconded by **Commissioner Whitfield**.

Items that are being amended to the agenda are as follows:

**Mayor Bradshaw** – Remove Proclamation for **Dr. Guider**. This will be followed up with at a workshop or Zoom meeting in the future.

**Mayor Bradshaw** – Add to Boards and Committees – TRDA Board of Directors / **Mayor Bradshaw** and **Jimmy Matlock** will continue for another term

**Tracy Blair** – Asking Commission for consideration to increase the GIS budget in the amount of \$ 3500 for **Property Assessor Mike Campbell's** office due to needing cross training and having both employee on staff during this time. **Case Collins** has given his notice of four weeks.

(8) Minutes  
Approved

**Chairman Cullen** requested that the August 3, 2020 minutes be accepted. **Commissioner Shaver** made a motion to accept the minutes and **Commissioner Brewster** seconded the motion.

Upon Voice Vote, the motion **PASSED** unanimously.

(9) General  
Public  
Comments

**Commission Chairman Cullen** asked for any General Public comments. There was not anyone who came forward to address the commission.

(10) Boards &  
Committees

**Mayor Buddy Bradshaw** presented Commission with the following Boards and Committees:

- 1) Agriculture Extension Committee – **Van Shaver** replacing **Gary Whitfield**  
**RESOLUTION 090820-A**
- 2) Animal Control Authority Advisory Board **RESOLUTION 090820-B**
- 3) Industrial Bond / Development Board **RESOLUTION 090820-C**
- 4) Ethics Committee – **Steve Cook** is the appointment to the open spot.  
**RESOLUTION 090820-D**
- 5) TRDA Board **RESOLUTION 090820-E**

**Commissioner Shaver** made a motion to approve the recommendations by **Mayor Bradshaw** and **Commissioner Waller** seconded the motion.

(11)  
September  
11 / 9-11  
Community  
Events

Upon Voice Vote, the motion **PASSED** unanimously.

**Mayor Bradshaw** reminded commission that there were several events coming up for Friday, September 11<sup>th</sup> as memorials for 9-11. One was being held at the Sheriff's Office and the other at the Loudon Fire Department.

(12) Re-Zone  
Resolution –  
299 Davis  
Ferry Road

**Commission Chairman Cullen** called back to the floor Loudon County **Planning and Codes Director Jim Jenkins** regarding the zoning request for 299 Davis Ferry Road.

**Commissioner Satterfield** made a motion to forgo the reading of the zoning request that was read at the public hearing at the beginning of the meeting.

A RESOLUTION AMENDING THE ZONING MAP OF LOUDON COUNTY, TENNESSEE, PURSUANT TO CHAPTER SEVEN, §13-7-105 OF THE TENNESSEE CODE ANNOTATED, TO REZONE APPROXIMATELY 1.69 ACRES FROM C-2, GENERAL COMMERCIAL DISTRICT TO C-1, RURAL CENTER DISTRICT, LOUDON COUNTY TAX MAP 050, PARCEL 193.02 LOCATED AT 299 DAVIS FERRY RD., LOUDON COUNTY, TN, SITUATED IN THE 1<sup>st</sup> LEGISLATIVE DISTRICT

**RESOLUTION 090820-F**

**Commissioner Brewster** made a motion to approve the zoning resolution and **Commissioner Meers** seconded the motion.

Upon Voice Vote, the motion **PASSED** unanimously.

(13) Raises  
Elected  
Officials FY  
20-21

**Director of Accounts and Budgets – Tracy Blair** presented to commission the recommendation to cease raises of elected officials as appropriated in the FY 20-21 budget.

**Commissioner Shaver** made a motion to cease raises that were recommended by the Budget Committee. **Commissioner Brewster** gave a second for discussion purposes.

**Commissioner Shaver** withdrew his motion and **Commissioner Brewster** also withdrew her seconded motion so that a different motion could be presented to commission.

**Commissioner Shaver** made it a point for the record that if nothing is done then the raises stay as is and no action is necessary.

**Commissioner Meers** made a motion to increase the wages for the Sheriff, Highway Superintendent and the Mayor in the amount of \$ 10,723.00 for this year. **Commissioner Tinker** seconded the motion.

**Commission Chairman Cullen** called for a Roll Call Vote.

The following commissioners voted AYE:

**Meers, Hurley, Tinker, Satterfield, Whitfield, Cullen, Duff, Brewster (8)**

The following commissioners voted NAY:

**Shaver, Waller (2)**

The motion **PASSED**. (8/2)



(14) County  
Employees  
Raises (2.5 %  
Retro to  
July 1: 2020)

**Commissioner Shaver** made a motion to give all county employees a two and half percent raise retroactive to July 1, 2020. **Commissioner Brewster** seconded the motion.

**Commissioner Satterfield** made a motion to add teachers to this motion with a 1 and a half percent raise. This motion was seconded by **Commissioner Tinker**. After much discussion, **Commission Satterfield** withdrew his amendment to the motion.

**Commission Chairman Cullen** called for a Roll Call Vote.

The following commissioners voted AYE:

**Hurley, Tinker, Satterfield, Whitfield, Duff, Shaver, Waller, Brewster, Meers (9)**

The following commissioners voted NAY:

**Cullen (1)**

The motion **PASSED**. (9/1)

(15) \$ 2500  
Run LoCo

**Director of Accounts and Budgets – Tracy Blair** presented to commission the recommendation to reduce the appropriation for the \$ 2500 contribution to Loudon County Education Foundation for Run LoCo.

**Commissioner Waller** made a motion to reduce the appropriation for the \$ 2500 contribution to Loudon County Education Foundation for Run LoCo. **Commissioner Shaver** seconded the motion.

**Commission Chairman Cullen** called for a Roll Call Vote.

The following commissioners voted AYE:

**Satterfield, Whitfield, Cullen, Shaver, Waller, Brewster, Meers (7)**

The following commissioners voted NAY:

**Tinker, Duff, Hurley (3)**

The motion **PASSED**. (7/3)

(16) BOE  
Year 2 - Five  
Year Capital  
Plan

**Director of Accounts and Budgets – Tracy Blair** presented to commission the recommendation to appropriate Year 2 of the BOE Five Year Capital Plan (\$ 549, 100), plus the unencumbered balance of FY 19-20 appropriations (\$ 147, 406), for a total of \$ 696, 506.00 in the Educational Capital Projects fund 177 Subfund AFT.

**Commissioner Whitfield** made a motion to accept the recommendation and **Commissioner Brewster** seconded the motion.

**Commission Chairman Cullen** called for a Roll Call Vote.

The following commissioners voted AYE:

**Satterfield, Whitfield, Cullen, Duff, Brewster, Meers, Hurley, Tinker (8)**

The following commissioners voted NAY:

**Shaver (1)**

NOTE: Before giving his vote, **Commissioner Tinker** gave his conflict of Interest Statement

**Commissioner Waller** had to leave the meeting early and was not here for this vote. The motion **PASSED**. (8/1)

(17) Budget  
Amendments  
– Funds 141  
& 142

**Director of Accounts and Budgets – Tracy Blair** presented to commission the recommendation to approve amendments in the following funds:

- 1) General Purpose School Fund 141 **EXHIBIT 090820-G**
- 2) School Federal Projects Fund 142 **EXHIBIT 090820-H**

**Commissioner Shaver** made a motion to approve both Fund 141 and Fund 142. **Commissioner Brewster** seconded the motion.

**Commission Chairman Cullen** called for a Roll Call Vote.

The following commissioners voted AYE:

**Whitfield, Cullen, Duff, Shaver, Brewster, Meers, Hurley, Tinker, Satterfield** (9)

The following commissioners voted NAY: (0)

NOTE: Before giving his vote, **Commissioner Tinker** gave his conflict of Interest Statement

**Commissioner Waller** had to leave the meeting early and was not here for this vote.

The motion **PASSED** unanimously.

(18) \$ 3500  
Increase GIS  
Budget

**Director of Accounts and Budgets – Tracy Blair** presented to commission the added agenda item for consideration of a \$3500 increase in the GIS budget to replace a long time employee who is resigning and the replacement will happen prior to that employees last day of employment for training purposes. This did not go before the budget committee so it did not have a recommendation.

**Commissioner Brewster** made a motion to approve this request and **Commissioner Tinker** seconded the motion.

**Commission Chairman Cullen** called for a Roll Call Vote.

The following commissioners voted AYE:

**Cullen, Duff, Shaver, Brewster, Meers, Hurley, Tinker, Satterfield, Whitfield** (9)

The following commissioners voted NAY: (0)

**Commissioner Waller** had to leave the meeting early and was not here for this vote.

The motion **PASSED** unanimously.

(19) Monthly  
Reports

**Director of Accounts and Budgets – Tracy Blair** request that the record reflect that prior to the meeting the following reports were distributed.

- 1) Summary Financial Statement August 2020 **EXHIBIT 090820-I**
- 2) Letter from Comptroller's Office (Receipt and Approval of the FY 2020 - 2021 Budget **EXHIBIT 090820-J**

(20) Notaries  
& Bonds

**Commissioner Meers** made a motion that was seconded by **Commissioner Brewster** to approve the following Notaries and Bonds:

**Brenda J. Burnette, Barbara S. Crane, Ashley Deane DeMerchant, Grazyna Gammons, Lenora Hennen, h. Bart Howell, Megan Hull, Jill Langer, Francin Magana Almanza, Becky Smith**

**EXHIBIT 090820-K**

Upon Voice Vote, the motion **PASSED** unanimously.

(21) Jail  
Move-In  
Update

**Commissioner Shaver** asked **Loudon County Sheriff - Tim Guider** when they would be moving into the jail. Loudon County Sheriff said he felt that from discussion with **Captain Keener** that it would be a couple of weeks and that there are very minimal items still to be completed.

(22) Jail  
Open House  
/ Virtual Tour

**Loudon County Sheriff – Tim Guider** also mentioned that he and **Mayor Bradshaw** had hoped to have an open house for the jail. However due to COVID-19 that felt it is best to have a virtual tour. **Chip Lynn** with Redskin Radio has agreed to do the video.

(23) Request  
for  
Courthouse  
Update for  
Workshop

**Commissioner Brewster** requested that we have an update by **Procurement Director – Susan Huskey** at the next workshop regarding the courthouse.

(24)  
Adjournment

There being no further business, a motion being duly made by **Commissioner Shaver** and seconded by **Commissioner Whitfield** the September 8, 2020 County Commission Meeting was adjourned at 7:46pm.



Loudon County Commission Chairman

Attest:

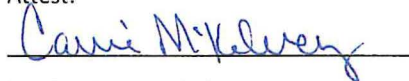

Loudon County Clerk

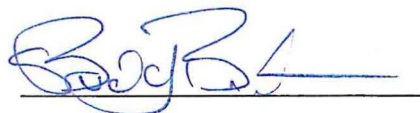

Loudon County Mayor

# LOUDON COUNTY COMMISSION

## RESOLUTION 090820-A

### RESOLUTION APPROVING OR ACKNOWLEDGING BOARD OR COMMITTEE APPOINTMENT BY COUNTY MAYOR

**WHEREAS**, by statute, and/or intergovernmental agreement and/or County Procedural Regulations, the County Mayor has the authority to make certain committee and board appointments; and

**WHEREAS**, appointments are necessary and/or desirable at this time with a 2 year rotation term; and

**WHEREAS**, the County Mayor appoints the following members of the

### **AGRICULTURE EXTENSION COMMITTEE**

<u>Appointee</u>		<u>Term Expiration</u>
Bill Satterfield	Commissioner	September 2022
Robert Anderson		September 2022
Sue Bright		September 2022

**NOW, THEREFORE, BE IT RESOLVED** that the Loudon County commission, meeting in regular session assembled this 8th day of September 2020 hereby approves or acknowledges (as appropriate) the said appointments.

  
COUNTY CHAIRMAN

#### **ATTEST:**

  
COUNTY CLERK

  
COUNTY MAYOR

The remaining members and their continuing expiration terms for said board or committee are as follows:

<u>Appointee</u>		<u>Term Expiration</u>
Jack Bowden		September 2021
Ruth Henderson McQueen		September 2021
Van Shaver	Commissioner	September 2021



**LOUDON COUNTY COMMISSION**  
**Resolution 090820-B**

**RESOLUTION APPROVING OR ACKNOWLEDGING BOARD OR**  
**COMMITTEE APPOINTMENT BY COUNTY MAYOR**

*WHEREAS*, by statute, and/or intergovernmental agreement and/or County Procedural Regulations, the County Mayor has the authority to make certain committee and board appointments; and

*WHEREAS*, appointments are necessary and/or desirable at this time with a 1 year rotation term; and

*WHEREAS*, the County Mayor appoints the following members of the

**ANIMAL CONTROL AUTHORITY ADVISORY BOARD**

<u>Appointee</u>		<u>Term Expiration</u>
Henry Cullen	County Commissioner	September 2021
Dot Boruff	At-Large	September 2021
Dr. Barry Gordon	Veterinarian Society	September 2021
Ed Loy	Humane Society	September 2021
James Web	At-Large	September 2021

*NOW, THEREFORE, BE IT RESOLVED* that the Loudon County Commission, meeting in regular session assembled this 8<sup>th</sup> day of September, 2020 hereby approves or acknowledges (as appropriate) the said appointments.

**ATTEST:**

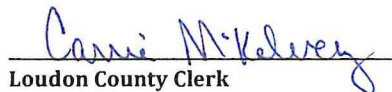
  
Loudon County Clerk

  
Loudon County Commission Chairman

  
Loudon County Mayor

**LOUDON COUNTY COMMISSION**  
**RESOLUTION 090820-C**

**RESOLUTION APPROVING OR ACKNOWLEDGING BOARD OR**  
**COMMITTEE APPOINTMENT BY COUNTY MAYOR**

**WHEREAS**, by statute, and/or intergovernmental agreement and/or County Procedural Regulations, the County Mayor has the authority to make certain committee and board appointments; and

**WHEREAS**, appointments are necessary and/or desirable at this time with a 6 year rotation term; and

**WHEREAS**, the County Mayor appoints the following members of the

**INDUSTRIAL BOND / DEVELOPMENT**  
**BOARD OF LOUDON COUNTY**

<u>Appointee</u>		<u>Term Expiration</u>
Mel Hines	Panel B	September 2026
Ted Wampler, Jr.	Panel B	September 2026
Tom Myers	Panel B	September 2026

**NOW, THEREFORE, BE IT RESOLVED** that the Loudon County Commission, meeting in regular session assembled this 8th day of September 2020 hereby approves or acknowledges (as appropriate) the said appointments.

  
\_\_\_\_\_  
COUNTY CHAIRMAN

**ATTEST:**

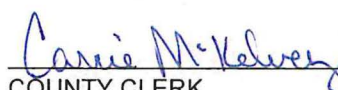
  
\_\_\_\_\_  
COUNTY CLERK

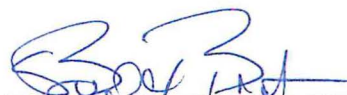
  
\_\_\_\_\_  
COUNTY MAYOR

The remaining members and their continuing expiration terms for said board or committee are as follows:

<u>Appointee</u>		<u>Term Expiration</u>
James Thomason	Panel C	September 2021
Jim Curtis	Panel C	September 2021
Nancy Beaty	Panel C	September 2021
Bruce Martin	Panel A	September 2022
Mike Webb	Panel A	September 2022

**LOUDON COUNTY COMMISSION**  
**Resolution 090820-D**

**RESOLUTION APPROVING OR ACKNOWLEDGING BOARD OR  
COMMITTEE APPOINTMENT BY COUNTY MAYOR**

**WHEREAS**, by statute, and/or intergovernmental agreement and/or County Procedural Regulations, the County Mayor has the authority to make certain committee and board appointments; and

**WHEREAS**, appointments are necessary and/or desirable at this time with a 1 year rotation term; and

**WHEREAS**, the County Mayor appoints the following members of the

**ETHICS COMMITTEE**

<u>Appointee</u>		<u>Term Expiration</u>
Steve Cook	At-Large	September 2021
Eddie Simpson	Constitutional Officer	September 2021
Matthew Tinker	County Commissioner	September 2021
Bill Satterfield	County Commissioner	September 2021
Kelly Brewster	County Commissioner	September 2021

**NOW, THEREFORE, BE IT RESOLVED** that the Loudon County Commission, meeting in regular session assembled this 8th day of September, 2020 hereby approves or acknowledges (as appropriate) the said appointments.

**ATTEST:**

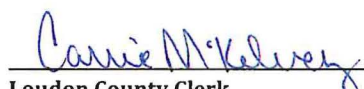
  
Loudon County Clerk

  
Loudon County Commission Chairman

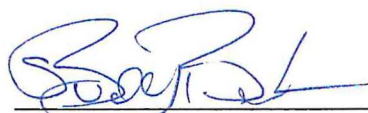
  
Loudon County Mayor

**LOUDON COUNTY COMMISSION**

**Resolution 090820-E**

**RESOLUTION APPROVING OR ACKNOWLEDGING BOARD OR  
COMMITTEE APPOINTMENT BY COUNTY MAYOR**

**WHEREAS**, by statute and/or intergovernmental agreement and/or County Procedural Regulations, the County Mayor has the authority to make certain committee and board appointments; and

**WHEREAS**, appointments are necessary and/or desirable at this time with a 6 year rotation term; and

**WHEREAS**, the County Mayor appoints the following members of the:

**TRDA BOARD OF DIRECTORS**

<u>Appointee</u>	<u>Term Expiration</u>
Buddy Bradshaw	August 2026
Jimmy Matlock	August 2026

**NOW, THEREFORE, BE IT RESOLVED** that the Loudon County Commission, meeting in regular session, assembled this 8<sup>th</sup> day of September, 2020 hereby approves or acknowledges (as appropriate) the said appointments.

  
Loudon County Commission Chairman

ATTEST:

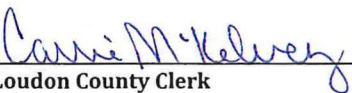
  
Loudon County Clerk

  
Loudon County Mayor

The remaining members and their continuing expiration terms for said board or committee are as follows:

<u>Appointee</u>	<u>Term Expiration</u>
Henry Cullen	April 2026



*Loudon County Commission*  
**RESOLUTION 090820-F**

**A RESOLUTION AMENDING THE ZONING MAP OF LOUDON COUNTY, TENNESSEE, PURSUANT TO CHAPTER SEVEN, §13-7-105 OF THE TENNESSEE CODE ANNOTATED, TO REZONE APPROXIMATELY 1.69 ACRES FROM C-2, GENERAL COMMERCIAL DISTRICT TO C-1, RURAL CENTER DISTRICT, LOUDON COUNTY TAX MAP 050, PARCEL 193.02 LOCATED AT 299 DAVIS FERRY RD., LOUDON COUNTY, TN, SITUATED IN THE 1<sup>ST</sup> LEGISLATIVE DISTRICT**

**WHEREAS**, the Loudon County Commission, in accordance with Chapter Seven, §13-7-105 of the Tennessee Code Annotated, may from time to time, amend the number, shape, boundary, area or any regulation of or within any district or districts, or any other provision of any zoning resolution, and

**WHEREAS**, the Regional Planning Commission has forwarded a recommendation regarding the amendment to the Zoning Map of Loudon County, Tennessee,

**WHEREAS**, a notice of public hearing and a description of the resolution appeared in the Loudon County newspaper, the News Herald on August 5, 2020 consistent with the provisions of Tennessee Code Annotated, §13-7-105, and

**NOW, THEREFORE, BE IT RESOLVED** by the Loudon County Commission that the Zoning Map of Loudon County, Tennessee be amended as follows:

Located at 299 Davis Ferry Rd., situated in the 1<sup>st</sup> Legislative District, referenced by Tax Map 050, Parcel 193.02 be rezoned from C-2, General Commercial District, to C-1, Rural Center District as shown on the attached illustration; said illustration being part of this Resolution.

**BE IT FINALLY RESOLVED**, that this Resolution shall take effect immediately, the public welfare requiring it.

  
ATTEST

  
LOUDON COUNTY CHAIRMAN

DATE: 9.8.20

  
APPROVED: LOUDON COUNTY MAYOR

The votes on the question of approval of this Resolution by the Planning Commission are as follows:

APPROVED: 7

DISAPPROVED: 0

  
ATTEST: SECRETARY LOUDON COUNTY  
REGIONAL PLANNING COMMISSION  
Dated:

RESOLUTION NO. \_\_\_\_\_

ILLUSTRATION ATTACHMENT

REZONE APPROXIMATELY 1.69 ACRES FROM C-2, GENERAL COMMERCIAL DISTRICT TO  
C-1, RURAL CENTER DISTRICT REFERENCED BY LOUDON COUNTY TAX MAP 050,  
PARCEL 193.02, LOCATED AT 299 DAVIS FERRY RD.,  
LOUDON COUNTY, TN, SITUATED IN THE 1<sup>ST</sup> LEGISLATIVE DISTRICT

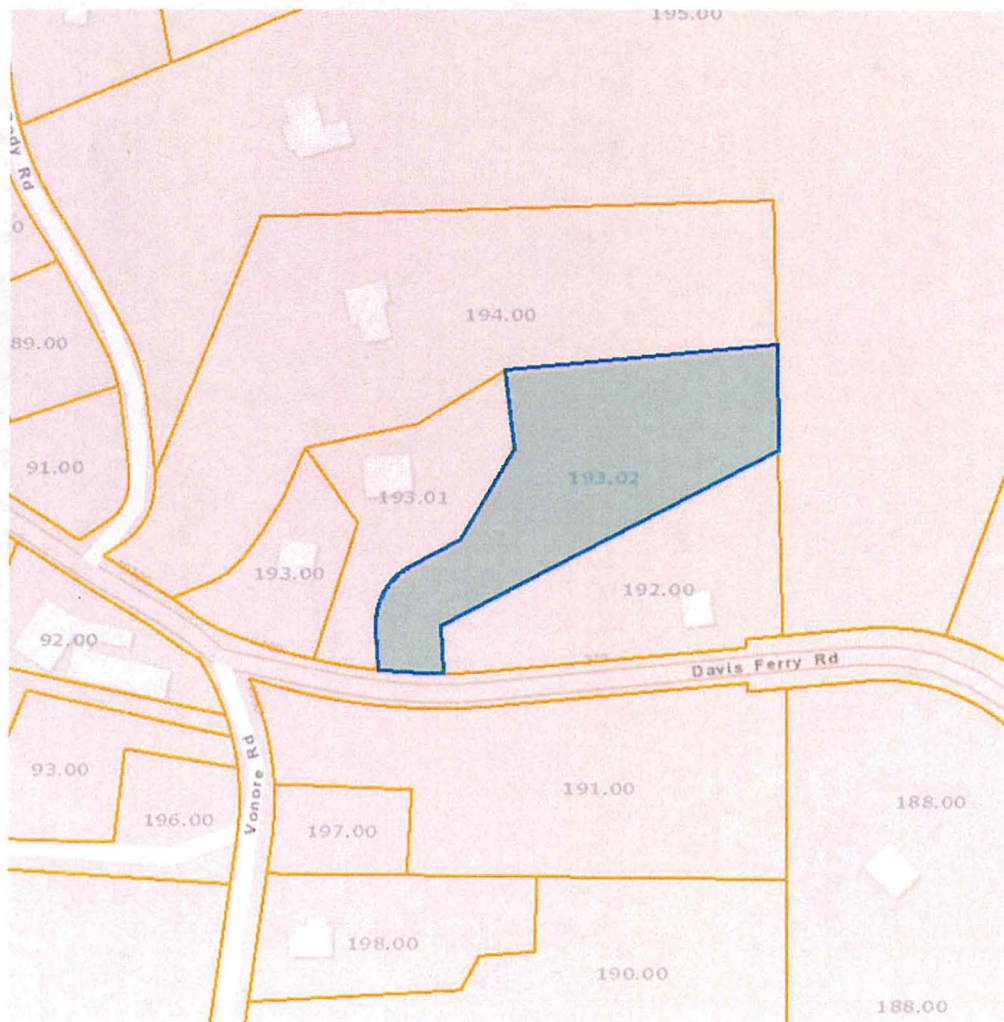

Loudon County Board of Education  
General Purpose School Fund 141  
Fiscal Year Ending June 30, 2021

BUDGET AMENDMENTS						
General Fund 141						
8/4/2020 11:05						
Account Number		2020-2021	2020-2021	Approved	Proposed	Proposed
72620	<u>Maintenance of Plant</u>					
335	Maintenance and Repair Services-Building	250,000	0	250,000	0	250,000
335-PES	Maintenance and Repair Services-Building	0	0	0	0	0
	<b>Total Maintenance of Plant</b>	<b>250,000</b>	<b>0</b>	<b>250,000</b>	<b>0</b>	<b>250,000</b>
72710	<u>Transportation</u>					
105	Supervisor/Director	55,785	0	55,785	0	55,785
201	Social Security	3,459	0	3,459	0	3,459
204	State Retirement	3,744	0	3,744	0	3,744
206	Life Insurance	187	0	187	0	187
207	Medical Insurance	13,106	0	13,106	0	13,106
208	Dental Insurance	375	0	375	0	375
212	Employer Medicare	809	0	809	0	809
313	Contracts with Parents	9,070	0	9,070	0	9,070
315	Contracts with Vehicle Owners	1,830,000	0	1,830,000	0	1,830,000
327	Freight Expenses	100	0	100	0	100
336	Maintenance and Repair Services - Equipment	6,243	0	6,243	0	6,243
340	Medical and Dental Services	3,000	0	3,000	0	3,000
348	Postal Charges	100	0	100	0	100
355	Travel	1,750	0	1,750	0	1,750
399	Other Contracted Services	3,200	0	3,200	0	3,200
435	Office Supplies	2,000	0	2,000	0	2,000
524	In-Service/Staff Development	5,000	0	5,000	0	5,000
599	Other Charges	5,985	0	5,985	0	5,985
790	Other Equipment	4,000	0	4,000	0	4,000
	<b>Total Transportation</b>	<b>1,947,913</b>	<b>0</b>	<b>1,947,913</b>	<b>0</b>	<b>1,947,913</b>
72901	<b>Education COVID-19</b>					
72901	<u>Support Services</u>					
116	Teachers	0	0	0	270,000	270,000
201	Social Security	0	0	0	16,740	16,740
204	State Retirement	0	0	0	27,729	27,729
212	Employer Medicare	0	0	0	3,915	3,915
499	Other Supplies & Materials	0	52,238	52,238	0	52,238
790	Other Equipment	0	209,000	209,000	0	209,000
	<b>Total COVID-19</b>	<b>0</b>	<b>261,238</b>	<b>261,238</b>	<b>318,384</b>	<b>579,622</b>
	<b>Total Support Services</b>	<b>13,002,554</b>	<b>268,834</b>	<b>13,271,388</b>	<b>318,384</b>	<b>13,589,772</b>
<b>Total Education</b>		<b>40,187,100</b>	<b>43,834</b>	<b>40,230,934</b>	<b>318,384</b>	<b>40,549,318</b>

LCBOE:  
Virtual School Stipends  
from fund balance.



Loudon County Board of Education  
School Federal Projects Fund 142  
Fiscal Year Ending June 30, 2021

1	A	B	C	D	E	F	G	H	I
2	Account Number		Federal Fund 142	2020-2021	2020-2021	Approved	Proposed	Proposed	
3			8/4/2020 12:16	Org Bgt	Amds	Amded Bgt	Amds	Amded Budget	
4									
762	Sub Fund		939 - Elementary and Secondary School Emergency Relief Revenue						
763									
764	47000		Federal Government						
765									
766	47100		Federal Through State						
767		47301	ESSER Grant	756,437.24	0.00	756,437.24	0.00	756,437.24	
768									
769			Total Federal Through State	756,437.24	0.00	756,437.24	0.00	756,437.24	
770									
771			Total Federal Government	0.00	0.00	0.00	0.00	0.00	
772									
773			Total Revenue	756,437.24	0.00	756,437.24	0.00	756,437.24	
774									
775			Total Other Sources	0.00	0.00	0.00	0.00	0.00	
776									
777			Total Preschool Revenue	756,437.24	0.00	756,437.24	0.00	756,437.24	
778									
779									
780	Sub Fund		939 - Elementary and Secondary School Emergency Relief Expenditures						
781									
782	70000		Education						
783									
784	71000		Instruction						
785									
786	71100		Regular Instruction Program						
787	189		Other Salaries & Wages	42,401.63	0.00	42,401.63	101,598.37	144,000.00	
788	201		Social Security	2,628.90	0.00	2,628.90	6,299.10	8,928.00	
789	204		State Retirement	4,354.65	0.00	4,354.65	10,434.15	14,788.80	
790	212		Employer Medicare	614.82	0.00	614.82	1,473.18	2,088.00	
791	307		Communications	10,000.00	0.00	10,000.00	(10,000.00)	0.00	
792	399		Other Contracted Services	60,000.00	0.00	60,000.00	(60,000.00)	0.00	
793	471		Software	0.00	0.00	0.00	39,800.00	39,800.00	
794	722		Instructional Equipment	478,000.24	0.00	478,000.24	(138,200.24)	339,800.00	
795				598,000.24	0.00	598,000.24	(48,595.44)	549,404.80	
796									
797	72210		Support Services - Regular Instruction						
798	307		Communications	0.00	0.00	0.00	21,000.00	21,000.00	
799	399		Other Contracted Services	0.00	0.00	0.00	154,400.00	154,400.00	
800				0.00	0.00	0.00	175,400.00	175,400.00	
801									
802	72220		Support Services - Special Education						
803	307		Communications	0.00	0.00	0.00	10,000.00	10,000.00	
804				0.00	0.00	0.00	10,000.00	10,000.00	
805	72250		Technology						
806	336		Maintenance & Repair Services	35,000.00	0.00	35,000.00	(35,000.00)	0.00	
807	471		Software	32,800.00	0.00	32,800.00	(32,800.00)	0.00	
808	790		Other Equipment	80,637.00	0.00	80,637.00	(68,137.00)	12,500.00	
809				148,437.00	0.00	148,437.00	(135,937.00)	12,500.00	
810									
811	73100		Food Service						
812	710		Food Service Equipment	10,000.00	0.00	10,000.00	(867.56)	9,132.44	
813				10,000.00	0.00	10,000.00	(867.56)	9,132.44	
814									
815			Total Expenditures	756,437.24	0.00	756,437.24	0.00	756,437.24	
816									
817			Beginning Fund Balance	0.00	0.00	0.00	0.00	0.00	
818									
819			Revenues	756,437.24	0.00	756,437.24	0.00	756,437.24	
820									
821			Expenditures	756,437.24	0.00	756,437.24	0.00	756,437.24	
822									
823			Ending Fund Balance	0.00	0.00	0.00	0.00	0.00	

LCBOE:  
ESSER amendments.



Template Name: LGC Defined  
Created by: LGC

Loudon County Finance  
Summary Financial Statement  
August 2020

101 General		Year-To-Date			Month-To-Date		
Account	Description	Budget Estimate	Actual	% of Budget	Estimate Avg/Mth	Actual	% of Avg
<b>Revenues</b>							
40110	Current Property Tax	11,756,269.00	(2,314.95)	0.02 %	979,689.08	0.00	0.00 %
40120	Trustee's Collections - Prior Year	75,000.00	0.00	0.00 %	6,250.00	0.00	0.00 %
40125	Trustee Collection-Bankruptcy	8,668.00	(76.74)	0.89 %	722.33	0.00	0.00 %
40130	Cir Clk/Clk & Master Collections-Pr Yr	125,000.00	(18,009.72)	14.41 %	10,416.67	(18,009.72)	172.89 %
40140	Interest And Penalty	25,000.00	(1,248.64)	4.99 %	2,083.33	0.00	0.00 %
40163	Payments In Lieu Of Taxes - Other	490,395.00	0.00	0.00 %	40,866.25	0.00	0.00 %
40210	Local Option Sales Tax	265,100.00	(40,053.29)	15.11 %	22,091.67	(40,053.29)	181.30 %
40220	Hotel/Motel Tax	440,000.00	(40,591.77)	9.23 %	36,666.67	(40,591.77)	110.70 %
40250	Litigation Tax - General	100,000.00	(8,292.90)	8.29 %	8,333.33	(8,292.90)	99.51 %
40260	Litigation Tax - Special Purpose	290,000.00	(21,894.17)	7.55 %	24,166.67	(21,894.17)	90.60 %
40270	Business Tax	536,400.00	(24,216.46)	4.51 %	44,700.00	(24,216.46)	54.18 %
40275	Mixed Drink Tax	29,000.00	(2,171.75)	7.49 %	2,416.67	(2,171.75)	89.87 %
40320	Bank Excise Tax	81,922.00	0.00	0.00 %	6,826.83	0.00	0.00 %
40330	Wholesale Beer Tax	95,000.00	(13,209.65)	13.90 %	7,916.67	(13,209.65)	166.86 %
41120	Animal Registration	63,500.00	(9,875.00)	15.55 %	5,291.67	(6,104.00)	115.35 %
41140	Cable TV Franchise	332,000.00	0.00	0.00 %	27,666.67	0.00	0.00 %
41510	Beer Permits	3,500.00	0.00	0.00 %	291.67	0.00	0.00 %
41520	Building Permits	380,000.00	(83,857.00)	22.07 %	31,666.67	(35,286.00)	111.43 %
41590	Other Permits	30,000.00	(2,922.50)	9.74 %	2,500.00	(1,340.00)	53.60 %
42151	Interpreter Fee	250.00	0.00	0.00 %	20.83	0.00	0.00 %
42180	DUI Treatment Fines	2,600.00	(142.50)	5.48 %	216.67	(142.50)	65.77 %
42190	Data Entry Fee - Circuit Court	1,200.00	(44.00)	3.67 %	100.00	(44.00)	44.00 %
42191	Courtroom Security Fee	5,000.00	(184.17)	3.68 %	416.67	(184.17)	44.20 %
42210	Fines	10,000.00	(2,288.55)	22.89 %	833.33	(2,288.55)	274.63 %
42220	Officers Costs	20,000.00	(156.27)	0.78 %	1,666.67	(156.27)	9.38 %
42240	Drug Control Fines	2,200.00	(81.23)	3.69 %	183.33	(81.23)	44.31 %
42250	Jail Fees	1,560.00	(16.15)	1.04 %	130.00	(16.15)	12.42 %
42290	Data Entry Fee - Criminal Court	1,000.00	(32.00)	3.20 %	83.33	(32.00)	38.40 %
42292	Victims Assistance Assessments	3,450.00	(42.00)	1.22 %	287.50	(42.00)	14.61 %
42310	Fines	45,000.00	(1,733.85)	3.85 %	3,750.00	(1,733.85)	46.24 %
42320	Officers Costs	113,000.00	(5,691.64)	5.04 %	9,416.67	(5,691.64)	60.44 %
42330	Games And Fish Fines	500.00	(18.90)	3.78 %	41.67	(18.90)	45.36 %
42340	Drug Control Fines	7,500.00	(141.79)	1.89 %	625.00	(141.79)	22.69 %
42350	Jail Fees	5,200.00	(391.40)	7.53 %	433.33	(391.40)	90.32 %
42380	DUI Treatment Fines	15,000.00	(1,031.70)	6.88 %	1,250.00	(1,031.70)	82.54 %
42390	Data Entry Fee - General Sessions	18,000.00	(1,521.50)	8.45 %	1,500.00	(1,521.50)	101.43 %
42391	Courtroom Security Fee	100,000.00	(8,121.41)	8.12 %	8,333.33	(8,121.41)	97.46 %
42392	Victims Assistance Assessments	18,000.00	(1,457.02)	8.09 %	1,500.00	(1,457.02)	97.13 %

Template Name: LGC Defined  
Created by: LGC

Loudon County Finance  
Summary Financial Statement  
August 2020

User:  
Date/Time:

Tracy Blair  
9/8/2020 5:28 PM  
Page 2 of 24

101 General		Year-To-Date			Month-To-Date		
Account	Description	Budget Estimate	Actual	% of Budget	Estimate Avg/Mth	Actual	% of Avg
42410	Fines	1,700.00	0.00	0.00 %	141.67	0.00	0.00 %
42490	Data Entry Fee - Juvenile Court	673.00	(56.00)	8.32 %	56.08	(56.00)	99.85 %
42520	Officers Costs	33,000.00	(751.45)	2.28 %	2,750.00	(751.45)	27.33 %
42530	Data Entry Fee - Chancery Court	13,900.00	(328.00)	2.36 %	1,158.33	(328.00)	28.32 %
42591	Courtroom Security Fee	2,580.00	(127.75)	4.95 %	215.00	(127.75)	59.42 %
42610	Fines	5,000.00	(375.00)	7.50 %	416.67	(375.00)	90.00 %
43190	Other General Service Charges	35,000.00	0.00	0.00 %	2,916.67	0.00	0.00 %
43370	Telephone Commissions	50,000.00	0.00	0.00 %	4,166.67	0.00	0.00 %
43392	Data Processing Fee -Register	21,000.00	(2,644.00)	12.59 %	1,750.00	(2,644.00)	151.09 %
43394	Data Processing Fee - Sheriff	6,000.00	(307.80)	5.13 %	500.00	(307.80)	61.56 %
43395	Sex Offender Registraion Fee	3,000.00	0.00	0.00 %	250.00	0.00	0.00 %
43396	Data Processing Fee - County Clerk	1,000.00	(105.00)	10.50 %	83.33	(105.00)	126.00 %
43399	Vehicle Insurance Coverage and	1,600.00	(250.00)	15.63 %	133.33	(250.00)	187.50 %
44110	Investment Income	100,000.00	(15,921.24)	15.92 %	8,333.33	(41,450.06)	497.40 %
44120	Lease/Rentals	2,600.00	(100.00)	3.85 %	216.67	(100.00)	46.15 %
44130	Sale Of Materials And Supplies	2,200.00	(225.00)	10.23 %	183.33	(75.00)	40.91 %
44131	Commissary Sales	23,000.00	(1,582.20)	6.88 %	1,916.67	(1,582.20)	82.55 %
44140	Sale Of Maps	500.00	0.00	0.00 %	41.67	0.00	0.00 %
44160	Retirees' Insurance Payments	63,258.00	(13,332.52)	21.08 %	5,271.50	(5,663.84)	107.44 %
44161	Cobra Insurance Payments	2,873.00	(942.77)	32.81 %	239.42	(204.73)	85.51 %
44170	Miscellaneous Refunds	10,588.00	0.00	0.00 %	882.33	0.00	0.00 %
44180	Expenditure Credits	3,642.00	0.00	0.00 %	303.50	0.00	0.00 %
44530	Sale Of Equipment	4,505.00	0.00	0.00 %	375.42	0.00	0.00 %
44540	Sale Of Property	0.00	(25,000.00)	0.00 %	0.00	0.00	0.00 %
44560	Damages Recovered From Individuals	1,635.00	(20.00)	1.22 %	136.25	(20.00)	14.68 %
44570	Contributions & Gifts	31,135.00	(3,326.00)	10.68 %	2,594.58	(1,444.00)	55.65 %
45510	County Clerk	483,000.00	(57,120.11)	11.83 %	40,250.00	(57,120.11)	141.91 %
45520	Circuit Court Clerk	95,000.00	(4,180.27)	4.40 %	7,916.67	(4,180.27)	52.80 %
45540	General Sessions Court Clerk	428,250.00	(31,097.27)	7.26 %	35,687.50	(31,097.27)	87.14 %
45550	Clerk And Master	80,000.00	(9,319.69)	11.65 %	6,666.67	(9,319.69)	139.80 %
45580	Register	328,000.00	(45,835.83)	13.97 %	27,333.33	(45,835.83)	167.69 %
45590	Sheriff	25,000.00	(3,871.00)	15.48 %	2,083.33	(3,871.00)	185.81 %
45610	Trustee	858,000.00	(24,834.82)	2.89 %	71,500.00	0.00	0.00 %
46110	Juvenile Services Program	10,000.00	0.00	0.00 %	833.33	0.00	0.00 %
46140	Aging Programs	13,528.00	0.00	0.00 %	1,127.33	0.00	0.00 %
46210	Law Enforcement Training Programs	39,200.00	0.00	0.00 %	3,266.67	0.00	0.00 %
46310	Health Department Programs	444,200.00	(33,511.74)	7.54 %	37,016.67	(33,511.74)	90.53 %
46820	Income Tax	400,000.00	0.00	0.00 %	33,333.33	0.00	0.00 %
46830	Beer Tax	20,000.00	0.00	0.00 %	1,666.67	0.00	0.00 %

Template Name: LGC Defined  
Created by: LGC

Loudon County Finance  
Summary Financial Statement  
August 2020

User:  
Date/Time:

Tracy Blair  
9/8/2020 5:28 PM  
Page 3 of 24

101 General		Year-To-Date			Month-To-Date		
Account	Description	Budget Estimate	Actual	% of Budget	Estimate Avg/Mth	Actual	% of Avg
46835	Vehicle Certificate Of Title Fees	9,000.00	0.00	0.00 %	750.00	0.00	0.00 %
46840	Alcoholic Beverage Tax	64,975.00	(24,636.80)	37.92 %	5,414.58	(24,636.80)	455.01 %
46852	State Revenue Sharing -	40,000.00	(6,566.02)	16.42 %	3,333.33	(6,566.02)	196.98 %
46915	Contracted Prisoner Board	203,000.00	(22,269.00)	10.97 %	16,916.67	(22,269.00)	131.64 %
46960	Registrar's Salary Supplement	15,000.00	0.00	0.00 %	1,250.00	0.00	0.00 %
46970	State Shared Sales Tax - Cities	6,000.00	(637.61)	10.63 %	500.00	(637.61)	127.52 %
46990	Other State Revenues	6,296.00	(120.00)	1.91 %	524.67	(120.00)	22.87 %
47220	Civil Defense Reimbursement	55,500.00	0.00	0.00 %	4,625.00	0.00	0.00 %
47590	Other Federal Through State	40,333.00	0.00	0.00 %	3,361.08	0.00	0.00 %
48130	Contributions	7,500.00	0.00	0.00 %	625.00	0.00	0.00 %
48140	Contracted Services	50,000.00	0.00	0.00 %	4,166.67	0.00	0.00 %
48610	Donations	16,000.00	0.00	0.00 %	1,333.33	0.00	0.00 %
49700	Insurance Recovery	0.00	(788.75)	0.00 %	0.00	(788.75)	0.00 %
<b>Total Revenues</b>		<b>19,654,385.00</b>	<b>(622,014.26)</b>	<b>3.16 %</b>	<b>1,637,865.42</b>	<b>(529,704.71)</b>	<b>32.34 %</b>
<b>Expenditures</b>							
51100	County Commission	(213,257.00)	26,442.16	12.40 %	(17,771.42)	11,452.48	64.44 %
51210	Board Of Equalization	(2,600.00)	0.00	0.00 %	(216.67)	0.00	0.00 %
51220	Beer Board	(5,000.00)	0.00	0.00 %	(416.67)	0.00	0.00 %
51240	Other Boards And Committees	(7,150.00)	0.00	0.00 %	(595.83)	0.00	0.00 %
51300	County Mayor/Executive	(241,210.00)	37,675.88	15.62 %	(20,100.83)	21,335.17	106.14 %
51310	Personnel Office	(46,285.00)	12,853.41	27.77 %	(3,857.08)	2,152.64	55.81 %
51400	County Attorney	(155,000.00)	59,068.40	38.11 %	(12,916.67)	59,068.40	457.30 %
51500	Election Commission	(376,323.00)	127,479.25	33.87 %	(31,360.25)	86,890.61	277.07 %
51600	Register Of Deeds	(313,926.00)	62,418.20	19.88 %	(26,160.50)	22,075.01	84.38 %
51720	Planning	(165,316.00)	10,530.44	6.37 %	(13,776.33)	7,107.71	51.59 %
51750	Codes Compliance	(317,623.00)	47,145.28	14.84 %	(26,468.58)	28,423.47	107.39 %
51760	Geographical Information Systems	(68,620.00)	12,345.78	17.99 %	(5,718.33)	4,787.96	83.73 %
51800	County Buildings	(1,282,835.00)	390,926.29	30.47 %	(106,902.92)	110,510.59	103.37 %
51900	Other General Administration	(305,900.00)	304,103.25	99.41 %	(25,491.67)	172.25	0.68 %
51910	Preservation Of Records	(1,000.00)	0.00	0.00 %	(83.33)	0.00	0.00 %
52100	Accounting And Budgeting	(694,478.00)	115,675.70	16.66 %	(57,873.17)	52,315.41	90.40 %
52200	Purchasing	(261,487.00)	37,488.56	14.34 %	(21,790.58)	21,034.96	96.53 %
52300	Property Assessor's Office	(466,792.00)	128,180.24	27.46 %	(38,899.33)	31,941.47	82.11 %
52400	County Trustee's Office	(383,946.00)	90,119.07	23.47 %	(31,995.50)	26,012.23	81.30 %
52500	County Clerk's Office	(676,299.00)	100,007.51	14.79 %	(56,358.25)	47,541.57	84.36 %
52600	Data Processing	(182,207.00)	27,859.15	15.29 %	(15,183.92)	18,773.93	123.64 %
53100	Circuit Court	(469,043.00)	83,221.67	17.74 %	(39,086.92)	36,014.24	92.14 %
53300	General Sessions Court	(691,304.00)	123,107.75	17.81 %	(57,608.67)	47,645.07	82.70 %

Template Name: LGC Defined  
Created by: LGC

Loudon County Finance  
Summary Financial Statement  
August 2020

User:  
Date/Time:

Tracy Blair  
9/8/2020 5:28 PM  
Page 4 of 24

101 General		Year-To-Date			Month-To-Date		
Account	Description	Budget Estimate	Actual	% of Budget	Estimate Avg/Mth	Actual	% of Avg
53310	General Sessions Judge	(495,655.00)	76,592.05	15.45 %	(41,304.58)	39,551.08	95.75 %
53400	Chancery Court	(305,667.00)	41,805.36	13.68 %	(25,472.25)	23,016.25	90.36 %
53500	Juvenile Court	(323,230.00)	46,475.47	14.38 %	(26,935.83)	28,690.41	106.51 %
53700	Judicial Commissioners	(66,552.00)	7,692.61	11.56 %	(5,546.00)	5,001.76	90.19 %
53900	Other Administration Of Justice	(18,760.00)	947.62	5.05 %	(1,563.33)	(0.38)	-0.02 %
53920	Courtroom Security	(1,500.00)	0.00	0.00 %	(125.00)	0.00	0.00 %
53930	Victim Assistance Programs	(22,000.00)	0.00	0.00 %	(1,833.33)	0.00	0.00 %
54110	Sheriff's Department	(5,170,509.00)	904,375.22	17.49 %	(430,875.75)	505,753.23	117.38 %
54120	Special Patrols	(11,000.00)	700.00	6.36 %	(916.67)	700.00	76.36 %
54130	Traffic Control	(34,500.00)	2,969.32	8.61 %	(2,875.00)	2,608.56	90.73 %
54160	Administration Of The Sexual Offender	(1,500.00)	0.00	0.00 %	(125.00)	0.00	0.00 %
54210	Jail	(4,304,338.00)	693,524.14	16.11 %	(358,694.83)	231,116.86	64.43 %
54320	Rural Fire Protection	(250,000.00)	0.00	0.00 %	(20,833.33)	0.00	0.00 %
54410	Civil Defense	(205,482.00)	33,683.61	16.39 %	(17,123.50)	17,047.00	99.55 %
54490	Other Emergency Management	(16,000.00)	0.00	0.00 %	(1,333.33)	0.00	0.00 %
54610	County Coroner/Medical Examiner	(109,000.00)	70,000.00	64.22 %	(9,083.33)	0.00	0.00 %
54900	Other Public Safety	(541,500.00)	0.00	0.00 %	(45,125.00)	0.00	0.00 %
55110	Local Health Center	(40,078.00)	12,808.97	31.96 %	(3,339.83)	3,025.90	90.60 %
55120	Rabies And Animal Control	(467,261.00)	121,632.35	26.03 %	(38,938.42)	30,769.17	79.02 %
55190	Other Local Health Services	(444,200.00)	42,839.70	9.64 %	(37,016.67)	24,916.53	67.31 %
56300	Senior Citizens Assistance	(267,305.00)	37,644.37	14.08 %	(22,275.42)	20,783.05	93.30 %
57100	Agricultural Extension Service	(179,661.00)	1,921.59	1.07 %	(14,971.75)	1,921.59	12.83 %
57500	Soil Conservation	(21,681.00)	1,568.95	7.24 %	(1,806.75)	1,193.20	66.04 %
57700	Flood Control	(2,000.00)	0.00	0.00 %	(166.67)	0.00	0.00 %
57800	Storm Water Management	(4,000.00)	0.00	0.00 %	(333.33)	0.00	0.00 %
58110	Tourism	(100,000.00)	0.00	0.00 %	(8,333.33)	0.00	0.00 %
58120	Industrial Development	(153,885.00)	3,884.48	2.52 %	(12,823.75)	0.00	0.00 %
58130	Housing And Urban Development	(6,750.00)	0.00	0.00 %	(562.50)	0.00	0.00 %
58300	Veteran's Services	(73,150.00)	9,544.35	13.05 %	(6,095.83)	5,257.13	86.24 %
58500	Contributions To Other Agencies	(75,100.00)	0.00	0.00 %	(6,258.33)	0.00	0.00 %
58600	Employee Benefits	(2,500.00)	156,600.00	6,264.00 %	(208.33)	130.00	62.40 %
58801	COVID-19 Grant #1	0.00	13,677.37	0.00 %	0.00	5,955.57	0.00 %
58900	Miscellaneous	(345,000.00)	9,146.15	2.65 %	(28,750.00)	0.00	0.00 %
82110	General Government	(50,000.00)	0.00	0.00 %	(4,166.67)	0.00	0.00 %
	<b>Total Expenditures</b>	<b>(21,437,365.00)</b>	<b>4,086,681.67</b>	<b>19.06 %</b>	<b>(1,786,447.08)</b>	<b>1,582,692.08</b>	<b>88.59 %</b>
<b>Total</b>	<b>101 General</b>	<b>(1,782,980.00)</b>	<b>3,464,667.41</b>	<b>194.32 %</b>	<b>(148,581.67)</b>	<b>1,052,987.37</b>	<b>708.69 %</b>



Template Name: LGC Defined  
Created by: LGC

Loudon County Finance  
Summary Financial Statement  
August 2020

User:  
Date/Time:

Tracy Blair  
9/8/2020 5:28 PM  
Page 5 of 24

112 Courthouse & Jail Maintenance		Year-To-Date			Month-To-Date		
Account	Description	Budget Estimate	Actual	% of Budget	Estimate Avg/Mth	Actual	% of Avg
<b>Revenues</b>							
40266	Litigation Tax-Jail, Wrkhse,	100,000.00	(8,446.59)	8.45 %	8,333.33	(8,446.59)	101.36 %
	<b>Total Revenues</b>	<b>100,000.00</b>	<b>(8,446.59)</b>	<b>8.45 %</b>	<b>8,333.33</b>	<b>(8,446.59)</b>	<b>101.36 %</b>
<b>Expenditures</b>							
58900	Miscellaneous	(2,000.00)	78.93	3.95 %	(166.67)	0.00	0.00 %
99100	Transfers Out	(125,000.00)	0.00	0.00 %	(10,416.67)	0.00	0.00 %
	<b>Total Expenditures</b>	<b>(127,000.00)</b>	<b>78.93</b>	<b>0.06 %</b>	<b>(10,583.33)</b>	<b>0.00</b>	<b>0.00 %</b>
<b>Total 112</b>	<b>Courthouse &amp; Jail Maintenance</b>	<b>(27,000.00)</b>	<b>(8,367.66)</b>	<b>-30.99 %</b>	<b>(2,250.00)</b>	<b>(8,446.59)</b>	<b>-375.40</b>

Template Name: LGC Defined  
Created by: LGC

Loudon County Finance  
Summary Financial Statement  
August 2020

User:  
Date/Time:

Tracy Blair  
9/8/2020 5:28 PM  
Page 6 of 24

114 Law Library		Year-To-Date			Month-To-Date		
Account	Description	Budget Estimate	Actual	% of Budget	Estimate Avg/Mth	Actual	% of Avg
<b>Revenues</b>							
40260	Litigation Tax - Special Purpose	4,500.00	(336.63)	7.48 %	375.00	(336.63)	89.77 %
	<b>Total Revenues</b>	<b>4,500.00</b>	<b>(336.63)</b>	<b>7.48 %</b>	<b>375.00</b>	<b>(336.63)</b>	<b>89.77 %</b>
<b>Expenditures</b>							
56500	Libraries	(4,600.00)	215.98	4.70 %	(383.33)	84.99	22.17 %
58900	Miscellaneous	(150.00)	3.17	2.11 %	(12.50)	0.00	0.00 %
	<b>Total Expenditures</b>	<b>(4,750.00)</b>	<b>219.15</b>	<b>4.61 %</b>	<b>(395.83)</b>	<b>84.99</b>	<b>21.47 %</b>
<b>Total</b>	<b>114 Law Library</b>	<b>(250.00)</b>	<b>(117.48)</b>	<b>-46.99 %</b>	<b>(20.83)</b>	<b>(251.64)</b>	<b>-1,207.87</b>

Template Name: LGC Defined  
Created by: LGC

Loudon County Finance  
Summary Financial Statement  
August 2020

User:  
Date/Time:

Tracy Blair  
9/8/2020 5:28 PM  
Page 7 of 24

115 Public Library		Year-To-Date			Month-To-Date		
Account	Description	Budget Estimate	Actual	% of Budget	Estimate Avg/Mth	Actual	% of Avg
<b>Revenues</b>							
40110	Current Property Tax	0.00	(68.07)	0.00 %	0.00	0.00	0.00 %
40125	Trustee's Collections - Bankruptcy	0.00	(2.24)	0.00 %	0.00	0.00	0.00 %
40130	Cir Clk/Clk & Master Collections-Pr Yr	0.00	(527.81)	0.00 %	0.00	(527.81)	0.00 %
40140	Interest And Penalty	0.00	(36.65)	0.00 %	0.00	0.00	0.00 %
43350	Copy Fees	0.00	(656.35)	0.00 %	0.00	(374.75)	0.00 %
43360	Library Fees	0.00	(396.80)	0.00 %	0.00	(210.60)	0.00 %
44160	Retirees' Insurance Payments	0.00	(5,206.42)	0.00 %	0.00	(972.71)	0.00 %
44570	Contributions & Gifts	0.00	(45.00)	0.00 %	0.00	(31.30)	0.00 %
48130	Contributions	0.00	(21,887.50)	0.00 %	0.00	(1,900.00)	0.00 %
<b>Total Revenues</b>		<b>0.00</b>	<b>(28,826.84)</b>	<b>100.00 %</b>	<b>0.00</b>	<b>(4,017.17)</b>	<b>0.00 %</b>
<b>Expenditures</b>							
56500	Libraries	0.00	69,699.30	0.00 %	0.00	27,729.95	0.00 %
<b>Total Expenditures</b>		<b>0.00</b>	<b>69,699.30</b>	<b>100.00 %</b>	<b>0.00</b>	<b>27,729.95</b>	<b>0.00 %</b>
<b>Total</b>	<b>115 Public Library</b>	<b>0.00</b>	<b>40,872.46</b>	<b>100.00 %</b>	<b>0.00</b>	<b>23,712.78</b>	<b>0.00 %</b>

Template Name: LGC Defined  
Created by: LGC

Loudon County Finance  
Summary Financial Statement  
August 2020

User:  
Date/Time:

Tracy Blair  
9/8/2020 5:28 PM  
Page 8 of 24

116 Solid Waste/Sanitation		Year-To-Date			Month-To-Date		
Account	Description	Budget Estimate	Actual	% of Budget	Estimate Avg/Mth	Actual	% of Avg
<b>Revenues</b>							
40210	Local Option Sales Tax	0.00	(99,152.65)	0.00 %	0.00	(99,152.65)	0.00 %
44145	Sale Of Recycled Materials	0.00	(17,047.06)	0.00 %	0.00	(14,260.06)	0.00 %
44160	Retirees' Insurance Payments	0.00	(93.92)	0.00 %	0.00	(69.92)	0.00 %
<b>Total Revenues</b>		<b>0.00</b>	<b>(116,293.63)</b>	<b>100.00 %</b>	<b>0.00</b>	<b>(113,482.63)</b>	<b>0.00 %</b>
<b>Expenditures</b>							
55720	Sanitation Education/Information	0.00	5,499.62	0.00 %	0.00	5,499.62	0.00 %
55732	Convenience Centers	0.00	280,509.53	0.00 %	0.00	43,178.32	0.00 %
55739	Other Waste Collection	0.00	4,807.00	0.00 %	0.00	4,807.00	0.00 %
<b>Total Expenditures</b>		<b>0.00</b>	<b>290,816.15</b>	<b>100.00 %</b>	<b>0.00</b>	<b>53,484.94</b>	<b>0.00 %</b>
<b>Total</b>	<b>116 Solid Waste/Sanitation</b>	<b>0.00</b>	<b>174,522.52</b>	<b>100.00 %</b>	<b>0.00</b>	<b>(59,997.69)</b>	<b>0.00 %</b>



Template Name: LGC Defined  
Created by: LGC

Loudon County Finance  
Summary Financial Statement  
August 2020

User:  
Date/Time:

Tracy Blair  
9/8/2020 5:28 PM  
Page 9 of 24

119 Industrial/Economic Development		Year-To-Date			Month-To-Date		
Account	Description	Budget Estimate	Actual	% of Budget	Estimate Avg/Mth	Actual	% of Avg
<b>Revenues</b>							
44120	Lease/Rentals	0.00	(3,533.33)	0.00 %	0.00	(2,208.33)	0.00 %
	<b>Total Revenues</b>	<b>0.00</b>	<b>(3,533.33)</b>	<b>100.00 %</b>	<b>0.00</b>	<b>(2,208.33)</b>	<b>0.00 %</b>
<b>Expenditures</b>							
58120	Industrial Development	0.00	13.25	0.00 %	0.00	0.00	0.00 %
	<b>Total Expenditures</b>	<b>0.00</b>	<b>13.25</b>	<b>100.00 %</b>	<b>0.00</b>	<b>0.00</b>	<b>0.00 %</b>
<b>Total</b>	<b>119 Industrial/Economic Development</b>	<b>0.00</b>	<b>(3,520.08)</b>	<b>100.00 %</b>	<b>0.00</b>	<b>(2,208.33)</b>	<b>0.00 %</b>

Template Name: LGC Defined  
Created by: LGC

Loudon County Finance  
Summary Financial Statement  
August 2020

User:  
Date/Time:

Tracy Blair  
9/8/2020 5:28 PM  
Page 10 of 24

122 Drug Control		Year-To-Date			Month-To-Date		
Account	Description	Budget Estimate	Actual	% of Budget	Estimate Avg/Mth	Actual	% of Avg
<b>Revenues</b>							
42240	Drug Control Fines	0.00	(176.22)	0.00 %	0.00	(176.22)	0.00 %
42340	Drug Control Fines	0.00	(141.78)	0.00 %	0.00	(141.78)	0.00 %
44570	Contributions & Gifts	0.00	(500.00)	0.00 %	0.00	(500.00)	0.00 %
<b>Total Revenues</b>		<b>0.00</b>	<b>(818.00)</b>	<b>100.00 %</b>	<b>0.00</b>	<b>(818.00)</b>	<b>0.00 %</b>
<b>Expenditures</b>							
54150	Drug Enforcement	0.00	17,393.68	0.00 %	0.00	3,431.15	0.00 %
<b>Total Expenditures</b>		<b>0.00</b>	<b>17,393.68</b>	<b>100.00 %</b>	<b>0.00</b>	<b>3,431.15</b>	<b>0.00 %</b>
<b>Total</b>	<b>122 Drug Control</b>	<b>0.00</b>	<b>16,575.68</b>	<b>100.00 %</b>	<b>0.00</b>	<b>2,613.15</b>	<b>0.00 %</b>

Template Name: LGC Defined  
Created by: LGC

Loudon County Finance  
Summary Financial Statement  
August 2020

User:  
Date/Time:

Tracy Blair  
9/8/2020 5:28 PM  
Page 11 of 24

131 Highway/Public Works

		Year-To-Date			Month-To-Date		
Account	Description	Budget Estimate	Actual	% of Budget	Estimate Avg/Mth	Actual	% of Avg
<b>Revenues</b>							
40110	Current Property Tax	0.00	(120.79)	0.00 %	0.00	0.00	0.00 %
40125	Bankruptcy	0.00	(4.11)	0.00 %	0.00	0.00	0.00 %
40130	Cir Clk/Clk & Master Collections-Pr Yr	0.00	(938.02)	0.00 %	0.00	(938.02)	0.00 %
40140	Interest And Penalty	0.00	(65.03)	0.00 %	0.00	0.00	0.00 %
44130	Sale Of Materials And Supplies	0.00	(2,076.80)	0.00 %	0.00	(1,271.60)	0.00 %
44160	Retirees' Insurance Payments	0.00	(3,142.66)	0.00 %	0.00	(1,200.15)	0.00 %
46920	Gasoline And Motor Fuel Tax	0.00	(197,574.02)	0.00 %	0.00	(197,574.02)	0.00 %
46930	Petroleum Special Tax	0.00	(2,919.61)	0.00 %	0.00	(2,919.61)	0.00 %
47590	Other Federal Through State	0.00	0.00	0.00 %	0.00	0.00	0.00 %
49600	Proceeds From Sale Of Capital Assets	0.00	(92,000.00)	0.00 %	0.00	0.00	0.00 %
<b>Total Revenues</b>		<b>0.00</b>	<b>(298,841.04)</b>	<b>100.00 %</b>	<b>0.00</b>	<b>(203,903.40)</b>	<b>0.00 %</b>
<b>Expenditures</b>							
61000	Administration	0.00	117,780.09	0.00 %	0.00	66,519.60	0.00 %
62000	Highway And Bridge Maintenance	0.00	633,540.94	0.00 %	0.00	7,000.00	0.00 %
63100	Operation And Maintenance Of	0.00	221,961.46	0.00 %	0.00	7,050.00	0.00 %
65000	Other Charges	0.00	137,434.64	0.00 %	0.00	7,245.92	0.00 %
66000	Employee Benefits	0.00	114,198.27	0.00 %	0.00	33,597.26	0.00 %
68000	Capital Outlay	0.00	106,731.90	0.00 %	0.00	319.90	0.00 %
<b>Total Expenditures</b>		<b>0.00</b>	<b>1,331,647.30</b>	<b>100.00 %</b>	<b>0.00</b>	<b>121,732.68</b>	<b>0.00 %</b>
<b>Total</b>	<b>131 Highway/Public Works</b>	<b>0.00</b>	<b>1,032,806.26</b>	<b>100.00 %</b>	<b>0.00</b>	<b>(82,170.72)</b>	<b>0.00 %</b>

Template Name: LGC Defined  
Created by: LGC

Loudon County Finance  
Summary Financial Statement  
August 2020

User:  
Date/Time:

Tracy Blair  
9/8/2020 5:28 PM  
Page 12 of 24

141 General Purpose School		Year-To-Date			Month-To-Date		
Account	Description	Budget Estimate	Actual	% of Budget	Estimate Avg/Mth	Actual	% of Avg
<b>Revenues</b>							
40110	Current Property Tax	0.00	4,822.21	0.00 %	0.00	0.00	0.00 %
40125	Bankruptcy	0.00	(71.35)	0.00 %	0.00	0.00	0.00 %
40130	Cir Clk/Clk & Master Collections-Pr Yr	0.00	(16,343.98)	0.00 %	0.00	(16,343.98)	0.00 %
40140	Interest And Penalty	0.00	(1,121.25)	0.00 %	0.00	0.00	0.00 %
40210	Local Option Sales Tax	0.00	(436,020.43)	0.00 %	0.00	(436,020.43)	0.00 %
40275	Mixed Drink Tax	0.00	(2,751.39)	0.00 %	0.00	(2,569.00)	0.00 %
41110	Marriage Licenses	0.00	(57.00)	0.00 %	0.00	(57.00)	0.00 %
44110	Investment Income	0.00	(10,029.18)	0.00 %	0.00	0.00	0.00 %
44160	Retirees' Insurance Payments	0.00	(15,635.93)	0.00 %	0.00	(8,399.23)	0.00 %
44170	Miscellaneous Refunds	0.00	(1,994.40)	0.00 %	0.00	(1,994.40)	0.00 %
46511	Basic Education Program	0.00	(2,169,200.00)	0.00 %	0.00	(2,169,200.00)	0.00 %
46590	Other State Education Funds	0.00	(5,847.09)	0.00 %	0.00	(5,847.09)	0.00 %
46851	State Revenue Sharing -T.V.A.	0.00	(1,654.89)	0.00 %	0.00	0.00	0.00 %
46980	Other State Grants	0.00	(10,000.00)	0.00 %	0.00	(10,000.00)	0.00 %
47306	COVID-19 Grant A	0.00	(8,127.02)	0.00 %	0.00	(8,127.02)	0.00 %
48610	Donations	0.00	(12,500.00)	0.00 %	0.00	(10,000.00)	0.00 %
<b>Total Revenues</b>		<b>0.00</b>	<b>(2,686,531.70)</b>	<b>100.00 %</b>	<b>0.00</b>	<b>(2,668,558.15)</b>	<b>0.00 %</b>
<b>Expenditures</b>							
71100	Regular Instruction Program	0.00	2,243,724.08	0.00 %	0.00	1,832,402.81	0.00 %
71200	Special Education Program	0.00	327,165.27	0.00 %	0.00	309,663.76	0.00 %
71300	Vocational Education Program	0.00	195,160.50	0.00 %	0.00	183,854.07	0.00 %
72110	Attendance	0.00	8,316.16	0.00 %	0.00	4,158.08	0.00 %
72120	Health Services	0.00	56,681.07	0.00 %	0.00	49,384.66	0.00 %
72130	Other Student Support	0.00	129,577.84	0.00 %	0.00	110,483.62	0.00 %
72210	Regular Instruction Program	0.00	180,605.59	0.00 %	0.00	130,760.77	0.00 %
72220	Special Education Program	0.00	200,656.95	0.00 %	0.00	186,018.08	0.00 %
72230	Vocational Education Program	0.00	25,764.86	0.00 %	0.00	12,846.75	0.00 %
72250	Technology	0.00	365,713.39	0.00 %	0.00	162,421.73	0.00 %
72310	Board Of Education	0.00	241,177.28	0.00 %	0.00	38,772.74	0.00 %
72320	Office Of The Superintendent	0.00	151,822.51	0.00 %	0.00	102,965.57	0.00 %
72410	Office Of The Principal	0.00	269,722.44	0.00 %	0.00	179,742.53	0.00 %
72510	Fiscal Services	0.00	13,939.34	0.00 %	0.00	6,968.01	0.00 %
72610	Operation Of Plant	0.00	1,639,432.60	0.00 %	0.00	89,021.11	0.00 %
72620	Maintenance Of Plant	0.00	100,740.80	0.00 %	0.00	8,400.80	0.00 %
72710	Transportation	0.00	191,482.38	0.00 %	0.00	184,209.80	0.00 %
72901	COVID-19 Expenditures	0.00	199,544.12	0.00 %	0.00	137,651.25	0.00 %
73300	Community Services	0.00	67,484.44	0.00 %	0.00	54,993.45	0.00 %



Template Name: LGC Defined  
Created by: LGC

Loudon County Finance  
Summary Financial Statement  
August 2020

User:  
Date/Time:

Tracy Blair  
9/8/2020 5:28 PM  
Page 13 of 24

141 General Purpose School		Year-To-Date			Month-To-Date		
Account	Description	Budget Estimate	Actual	% of Budget	Estimate Avg/Mth	Actual	% of Avg
73400	Early Childhood Education	0.00	144,152.49	0.00 %	0.00	144,003.25	0.00 %
	<b>Total Expenditures</b>	<b>0.00</b>	<b>6,752,864.11</b>	<b>100.00 %</b>	<b>0.00</b>	<b>3,928,722.84</b>	<b>0.00 %</b>
<b>Total</b>	<b>141 General Purpose School</b>	<b>0.00</b>	<b>4,066,332.41</b>	<b>100.00 %</b>	<b>0.00</b>	<b>1,260,164.69</b>	<b>0.00 %</b>

Template Name: LGC Defined  
Created by: LGC

Loudon County Finance  
Summary Financial Statement  
August 2020

User:  
Date/Time:

Tracy Blair  
9/8/2020 5:28 PM  
Page 14 of 24

142 School Federal Projects		Year-To-Date			Month-To-Date		
Account	Description	Budget Estimate	Actual	% of Budget	Estimate Avg/Mth	Actual	% of Avg
<b>Revenues</b>							
47141	Title 1 Grants To Local Educ Agencies	0.00	(66,096.21)	0.00 %	0.00	(66,096.21)	0.00 %
47143	Special Education - Grants To States	0.00	(70,436.69)	0.00 %	0.00	(70,436.69)	0.00 %
47146	English Language Acquisition Grants	0.00	(24.87)	0.00 %	0.00	(24.87)	0.00 %
47147	Safe And Drug-Free Schools-St Grants	0.00	(3,153.36)	0.00 %	0.00	(3,153.36)	0.00 %
47189	Eisenhower Prof Development State	0.00	(13,706.78)	0.00 %	0.00	(13,706.78)	0.00 %
47301	COVID-19 Grant #1	0.00	(113,253.36)	0.00 %	0.00	(113,253.36)	0.00 %
<b>Total Revenues</b>		<b>0.00</b>	<b>(266,671.27)</b>	<b>100.00 %</b>	<b>0.00</b>	<b>(266,671.27)</b>	<b>0.00 %</b>
<b>Expenditures</b>							
71100	Regular Instruction Program	0.00	426,998.83	0.00 %	0.00	61,342.91	0.00 %
71200	Special Education Program	0.00	59,231.37	0.00 %	0.00	57,206.37	0.00 %
71300	Vocational Education Program	0.00	3,275.00	0.00 %	0.00	3,275.00	0.00 %
72130	Other Student Support	0.00	982.34	0.00 %	0.00	300.00	0.00 %
72210	Regular Instruction Program	0.00	188,822.05	0.00 %	0.00	37,628.41	0.00 %
72220	Special Education Program	0.00	139,592.42	0.00 %	0.00	120,679.60	0.00 %
72250	Technology	0.00	10,381.43	0.00 %	0.00	3,256.43	0.00 %
73100	Food Service	0.00	6,228.36	0.00 %	0.00	0.00	0.00 %
<b>Total Expenditures</b>		<b>0.00</b>	<b>835,511.80</b>	<b>100.00 %</b>	<b>0.00</b>	<b>283,688.72</b>	<b>0.00 %</b>
<b>Total</b>	<b>142 School Federal Projects</b>	<b>0.00</b>	<b>568,840.53</b>	<b>100.00 %</b>	<b>0.00</b>	<b>17,017.45</b>	<b>0.00 %</b>

Template Name: LGC Defined  
Created by: LGC

Loudon County Finance  
Summary Financial Statement  
August 2020

User:  
Date/Time:

Tracy Blair  
9/8/2020 5:28 PM  
Page 15 of 24

143 Central Cafeteria		Year-To-Date			Month-To-Date		
Account	Description	Budget Estimate	Actual	% of Budget	Estimate Avg/Mth	Actual	% of Avg
<b>Revenues</b>							
43521	Lunch Payments - Children	0.00	(1,676.70)	0.00 %	0.00	(1,676.70)	0.00 %
44110	Investment Income	0.00	(456.56)	0.00 %	0.00	(0.09)	0.00 %
47990	Other Direct Federal Revenue	0.00	(62,269.00)	0.00 %	0.00	0.00	0.00 %
	<b>Total Revenues</b>	<b>0.00</b>	<b>(64,402.26)</b>	<b>100.00 %</b>	<b>0.00</b>	<b>(1,676.79)</b>	<b>0.00 %</b>
<b>Expenditures</b>							
73100	Food Service	0.00	1,133,550.92	0.00 %	0.00	1,076,007.77	0.00 %
	<b>Total Expenditures</b>	<b>0.00</b>	<b>1,133,550.92</b>	<b>100.00 %</b>	<b>0.00</b>	<b>1,076,007.77</b>	<b>0.00 %</b>
<b>Total</b>	<b>143 Central Cafeteria</b>	<b>0.00</b>	<b>1,069,148.66</b>	<b>100.00 %</b>	<b>0.00</b>	<b>1,074,330.98</b>	<b>0.00 %</b>

Template Name: LGC Defined  
Created by: LGC

Loudon County Finance  
Summary Financial Statement  
August 2020

User:  
Date/Time:

Tracy Blair  
9/8/2020 5:28 PM  
Page 16 of 24

151 General Debt Service		Year-To-Date			Month-To-Date		
Account	Description	Budget Estimate	Actual	% of Budget	Estimate Avg/Mth	Actual	% of Avg
<b>Revenues</b>							
40110	Current Property Tax	0.00	(363.58)	0.00 %	0.00	0.00	0.00 %
40125	Bankruptcy	0.00	(11.83)	0.00 %	0.00	0.00	0.00 %
40130	Cir Clk/Clk & Master Collections-Pr Yr	0.00	(2,826.47)	0.00 %	0.00	(2,826.47)	0.00 %
40140	Interest And Penalty	0.00	(195.97)	0.00 %	0.00	0.00	0.00 %
44110	Investment Income	0.00	(2,735.23)	0.00 %	0.00	0.00	0.00 %
	<b>Total Revenues</b>	<b>0.00</b>	<b>(6,133.08)</b>	<b>100.00 %</b>	<b>0.00</b>	<b>(2,826.47)</b>	<b>0.00 %</b>
<b>Expenditures</b>							
82210	General Government	0.00	4,150.80	0.00 %	0.00	349.20	0.00 %
82310	General Government	0.00	33,997.80	0.00 %	0.00	16,956.00	0.00 %
	<b>Total Expenditures</b>	<b>0.00</b>	<b>38,148.60</b>	<b>100.00 %</b>	<b>0.00</b>	<b>17,305.20</b>	<b>0.00 %</b>
<b>Total</b>	<b>151 General Debt Service</b>	<b>0.00</b>	<b>32,015.52</b>	<b>100.00 %</b>	<b>0.00</b>	<b>14,478.73</b>	<b>0.00 %</b>



Template Name: LGC Defined  
Created by: LGC

Loudon County Finance  
Summary Financial Statement  
August 2020

User:  
Date/Time:

Tracy Blair  
9/8/2020 5:28 PM  
Page 17 of 24

156 Education Debt Service		Year-To-Date			Month-To-Date		
Account	Description	Budget Estimate	Actual	% of Budget	Estimate Avg/Mth	Actual	% of Avg
<b>Revenues</b>							
40110	Current Property Tax	0.00	(2,367.00)	0.00 %	0.00	0.00	0.00 %
40125	Bankruptcy	0.00	(30.22)	0.00 %	0.00	0.00	0.00 %
40130	Cir Clk/Clk & Master Collections-Pr Yr	0.00	(6,635.62)	0.00 %	0.00	(6,635.62)	0.00 %
40140	Interest And Penalty	0.00	(407.93)	0.00 %	0.00	0.00	0.00 %
40285	Adequate Facilities/Development Tax	0.00	(67,073.50)	0.00 %	0.00	0.00	0.00 %
44110	Investment Income	0.00	(12,308.54)	0.00 %	0.00	0.00	0.00 %
<b>Total Revenues</b>		<b>0.00</b>	<b>(88,822.81)</b>	<b>100.00 %</b>	<b>0.00</b>	<b>(6,635.62)</b>	<b>0.00 %</b>
<b>Expenditures</b>							
82230	Education	0.00	44,431.13	0.00 %	0.00	44,431.13	0.00 %
82330	Education	0.00	119.20	0.00 %	0.00	0.00	0.00 %
<b>Total Expenditures</b>		<b>0.00</b>	<b>44,550.33</b>	<b>100.00 %</b>	<b>0.00</b>	<b>44,431.13</b>	<b>0.00 %</b>
<b>Total</b>	<b>156 Education Debt Service</b>	<b>0.00</b>	<b>(44,272.48)</b>	<b>100.00 %</b>	<b>0.00</b>	<b>37,795.51</b>	<b>0.00 %</b>

Template Name: LGC Defined  
Created by: LGC

Loudon County Finance  
Summary Financial Statement  
August 2020

User:  
Date/Time:

Tracy Blair  
9/8/2020 5:28 PM  
Page 18 of 24

171 General Capital Projects		Year-To-Date			Month-To-Date		
Account	Description	Budget Estimate	Actual	% of Budget	Estimate Avg/Mth	Actual	% of Avg
<b>Revenues</b>							
40110	Current Property Tax	0.00	(36.09)	0.00 %	0.00	0.00	0.00 %
40125	Bankruptcy	0.00	(1.24)	0.00 %	0.00	0.00	0.00 %
40130	Cir Clk/Clk & Master Collections-Pr Yr	0.00	(280.53)	0.00 %	0.00	(280.53)	0.00 %
40140	Interest And Penalty	0.00	(19.51)	0.00 %	0.00	0.00	0.00 %
40210	Local Option Sales Tax	0.00	(26,990.26)	0.00 %	0.00	(26,990.26)	0.00 %
44110	Investment Income	0.00	(1,340.39)	0.00 %	0.00	0.00	0.00 %
44570	Contributions & Gifts	0.00	(327.50)	0.00 %	0.00	(277.50)	0.00 %
46990	Other State Revenues	0.00	(1,142,935.00)	0.00 %	0.00	(1,142,935.00)	0.00 %
	<b>Total Revenues</b>	<b>0.00</b>	<b>(1,171,930.52)</b>	<b>100.00 %</b>	<b>0.00</b>	<b>(1,170,483.29)</b>	<b>0.00 %</b>
<b>Expenditures</b>							
58900	Miscellaneous	0.00	5.55	0.00 %	0.00	0.00	0.00 %
91110	General Administration Projects	0.00	11,411.00	0.00 %	0.00	10,061.00	0.00 %
91120	Administration Of Justice Projects	0.00	1,029,691.95	0.00 %	0.00	265,704.48	0.00 %
91130	Public Safety Projects	0.00	205,676.93	0.00 %	0.00	6,629.47	0.00 %
91150	Social, Cultural And Recreation	0.00	3,100.00	0.00 %	0.00	0.00	0.00 %
	<b>Total Expenditures</b>	<b>0.00</b>	<b>1,249,885.43</b>	<b>100.00 %</b>	<b>0.00</b>	<b>282,394.95</b>	<b>0.00 %</b>
<b>Total</b>	<b>171 General Capital Projects</b>	<b>0.00</b>	<b>77,954.91</b>	<b>100.00 %</b>	<b>0.00</b>	<b>(888,088.34)</b>	<b>0.00 %</b>

Template Name: LGC Defined  
Created by: LGC

Loudon County Finance  
Summary Financial Statement  
August 2020

User:  
Date/Time:

Tracy Blair  
9/8/2020 5:28 PM  
Page 19 of 24

176 Highway Capital Projects		Year-To-Date			Month-To-Date		
Account	Description	Budget Estimate	Actual	% of Budget	Estimate Avg/Mth	Actual	% of Avg
<b>Revenues</b>							
40110	Current Property Tax	0.00	(61.60)	0.00 %	0.00	0.00	0.00 %
40125	Trustee's Collections - Bankruptcy	0.00	(2.11)	0.00 %	0.00	0.00	0.00 %
40130	Cir Clk/Clk & Master Collections-Pr Yr	0.00	(482.61)	0.00 %	0.00	(482.61)	0.00 %
40140	Interest And Penalty	0.00	(33.55)	0.00 %	0.00	0.00	0.00 %
<b>Total Revenues</b>		<b>0.00</b>	<b>(579.87)</b>	<b>100.00 %</b>	<b>0.00</b>	<b>(482.61)</b>	<b>0.00 %</b>
<b>Expenditures</b>							
91200	Highway & Street Capital Projects	0.00	14.53	0.00 %	0.00	0.00	0.00 %
<b>Total Expenditures</b>		<b>0.00</b>	<b>14.53</b>	<b>100.00 %</b>	<b>0.00</b>	<b>0.00</b>	<b>0.00 %</b>
<b>Total</b>	<b>176 Highway Capital Projects</b>	<b>0.00</b>	<b>(565.34)</b>	<b>100.00 %</b>	<b>0.00</b>	<b>(482.61)</b>	<b>0.00 %</b>

Template Name: LGC Defined  
Created by: LGC

Loudon County Finance  
Summary Financial Statement  
August 2020

User:  
Date/Time:

Tracy Blair  
9/8/2020 5:28 PM  
Page 20 of 24

177 Education Capital Projects		Year-To-Date			Month-To-Date		
Account	Description	Budget Estimate	Actual	% of Budget	Estimate Avg/Mth	Actual	% of Avg
<b>Expenditures</b>							
91300	Education Capital Projects	0.00	5,000.00	0.00 %	0.00	5,000.00	0.00 %
	<b>Total Expenditures</b>	<b>0.00</b>	<b>5,000.00</b>	<b>100.00 %</b>	<b>0.00</b>	<b>5,000.00</b>	<b>0.00 %</b>
<b>Total</b>	<b>177 Education Capital Projects</b>	<b>0.00</b>	<b>5,000.00</b>	<b>100.00 %</b>	<b>0.00</b>	<b>5,000.00</b>	<b>0.00 %</b>



**Loudon County Commission**  
**EXHIBIT 090820-J**



JUSTIN P. WILSON  
*Comptroller*

JASON L. MUMPOWER  
*Deputy Comptroller*

August 12, 2020

Honorable Rollen Bradshaw, Mayor  
and Honorable Board of Commissioners  
Loudon County  
P.O. Box 109  
Loudon, TN 37774

Dear Mayor Bradshaw and Members of the Board:

This letter acknowledges receipt of a copy of the 2021 fiscal year budget.

We have reviewed the County's budget and have determined that projected revenues and other available funds are sufficient to meet anticipated expenditures. Our review of the budget is based solely on the information we have received. With regard to programs included in the budget such as education, roads, and corrections, we have not made any attempt to determine that the local government has complied with specific program statutes or guidelines, or with any financing requirements prescribed by any state or federal agency. Please note local officials are required to ensure the budget remains balanced throughout the fiscal year and that all maintenance of effort requirements are met – our office has not reviewed or approved any maintenance of effort programs in this budget. Budget amendments must be sent to our office for formal acknowledgement after they are approved by the local governing body (submit to: JPR@lccol.org).

### **Approval**

This letter constitutes approval, by our office, for the County's 2021 fiscal year budget as adopted by the governing body. However, we would like to bring the following issue to your attention that, if not addressed, could possibly lead to financial problems in the future.

### **Structurally Balanced Budget**

For the second consecutive year, the County has adopted a budget for its General Fund and General Purpose School Fund with disbursements that exceed receipts. The County has projected to use a large portion of its cash reserves to pay for the increase in expenditures. It is our understanding that almost all of the additional expenditures are related to recurring expenditures, such as salaries. Using reserves to pay for recurring expenditures is contrary to sound budget practices. A budget is structurally balanced when recurring revenues are sufficient to pay for recurring expenditures. Local officials should adopt future budgets that are structurally balanced. Please refer to our website to learn about seven keys to a fiscally well-managed government: <https://lccol.org/7keys>.

LOUDON COUNTY CLERK  
CARRIE MCKELVEY COUNTY CLERK  
101 MULBERRY ST STE 200  
LOUDON TN 37774  
Telephone 865-458-3314  
Fax 865-458-9891

Notaries to be elected September 08,2020

---

BRENDA J BURNETTE  
BARBARA S CRANE  
ASHLEY DEANE DEMERCHANT  
GRAZYNA GAMMONS  
LENORA HENNEN  
H BART HOWELL

---

MEGHAN L. HULL  
JILL LANGER  
FRANCIN MAGANA ALMANZA  
BECKY L SMITH