

LOUDON COUNTY COMMISSION
LOUDON COUNTY, TENNESSEE
Monday April 01, 2019
6:00 P.M.
Courthouse Annex

AGENDA
Regular Meeting

PUBLIC HEARING

1. A Resolution closing Notch-In-Hill Road as a public road pursuant to Tennessee Code Annotated §54-10-216
2. A Resolution adopted by the Loudon County Commission closing a certain portion of Buster Blvd. located at or near Martel Road
3. A Resolution amending the Zoning Map of Loudon County, Tennessee, pursuant to Chapter Seven, §13-7-105 of the Tennessee Code Annotated, to rezone approximately 3.18 acres from C-2 (General Commercial District) to R-1 (Suburban Residential District) Tax Map 016, Parcel 332.00, 1350 Old Midway Road, Lenoir City, TN, situated in the 2nd Legislative District
4. A Resolution amending the Zoning Map of Loudon County, Tennessee, pursuant to Chapter Seven, §13-7-105 of the Tennessee Code Annotated, to rezone approximately 28.0 acres from R-1 (Suburban Residential District) to A-2 (Rural Residential District) Tax Map 007, Parcel 114.00, 101 Wilkerson Lane, Lenoir City, TN, situated in the 5th Legislative District

1. Opening of Meeting, Pledge of Allegiance to the Flag of the United States, Invocation
2. Roll Call
3. Adoption of the April 01, 2019 Commission Agenda

4. Reading and Acceptance of the March 04, 2019 County Commission Meeting Minutes
5. General Public Comments
6. Reports of County Officials, Departments, and Committees
 - A. **Loudon County Mayor- Buddy Bradshaw**
 1. Surplus Property Authority Term Update
 2. A Resolution encouraging the State of Tennessee to remedy online sales tax collections with an equitable distribution of revenues collected based upon a pro-rated percentage of the population of the unincorporated versus incorporated population of the county.
 3. A Resolution urging the General Assembly to adopt an equitable distribution of local sales tax revenue from out-of-state sellers
 - B. **Purchasing Director – Susan Huskey**
 1. Multi-Year Mailing Machine Agreements
 - C. **Planning & Codes – Laura Smith**
 1. A Resolution closing Notch-In-Hill Road as a public road pursuant to Tennessee Code Annotated §54-10-216
 2. A Resolution adopted by the Loudon County Commission closing a certain portion of Buster Blvd. located at or near Martel Road
 3. A Resolution amending the Zoning Map of Loudon County, Tennessee, pursuant to Chapter Seven, §13-7-105 of the Tennessee Code Annotated, to rezone approximately 3.18 acres from C-2 (General Commercial District) to R-1 (Suburban Residential District) Tax Map 016, Parcel 332.00, 1350 Old Midway Road, Lenoir City, TN, situated in the 2nd Legislative District

4. A Resolution amending the Zoning Map of Loudon County, Tennessee, pursuant to Chapter Seven, §13-7-105 of the Tennessee Code Annotated, to rezone approximately 28.0 acres from R-1 (Suburban Residential District) to A-2 (Rural Residential District) Tax Map 007, Parcel 114.00, 101 Wilkerson Lane, Lenoir City, TN, situated in the 5th Legislative District

D. Commissioner Van Shaver

1. Allenbrook Street Paving
2. Consideration of sending a letter to the City of Lenoir City in reference to flooding in Huntsville Hollow
3. Consideration of sending a letter to the City of Lenoir City in reference to promised paving of streets in Harrison Hills

E. Director of Accounts & Budgets – Tracy Blair

1. Consideration of a recommendation to approve amendment to the DGA Grant for Health Department employees; \$58,600 increase; no matching funds.
2. Consideration of a recommendation to approve application / acceptance of \$20,000 Access to Health through Healthy Active built Environments Grant from the Tennessee Department of Health; no matching funds
3. Consideration of a recommendation to accept the unanimous decision of the Roane State Maintenance and Advisory Committee (Center Executive Board), and approve a Resolution to Amend the Inter-local Agreement to Development of Loudon County Career Center
4. Consideration of recommendation to approve amendments in the following funds:
 - A. County General Fund 101
 - B. Highway Department Fund 131
 - C. General Purpose School Fund 141
 - D. School Federal Projects Fund 142
5. Distribution of Monthly reports

F. **Commissioner David Meers**

1. Notaries
2. Approval of Statutory Bond for Director of Accounts & Budgets, Tracy Blair

7. Adjournment

LOUDON COUNTY COMMISSION
LOUDON COUNTY, TENNESSEE
Monday March 04, 2019
Courthouse Annex Building
6 P.M.

REGULAR COMMISSION MEETING

(1)
Opening of
Meeting

BE IT REMEMBERED that the Board of Commissioners of Loudon County convened in regular session in Loudon, TN on the 4th day of March, 2019.

Commission Chairman Henry Cullen called the meeting to order at 6:01 P.M.

Commissioner Gary Whitfield opened the County Commission Meeting, led the Pledge of the Allegiance to the Flag of the United States of America, and gave the Invocation.

(2)
Roll Call

Upon Roll Call, the following Commissioners were present: **Kelly Brewster, David Meers, Bill Satterfield, Gary Whitfield, Henry Cullen, Harold Duff, Van Shaver, and Adam Waller (8)**

The following Commissioners were absent: **Julia Hurley and Matthew Tinker (2)**

Thereupon **Chairman Cullen** announced the presence of a quorum.

Also present was **Director of Accounts and Budgets, Tracy Blair**. The **Honorable Mayor Buddy Bradshaw** was absent.

(3)
Adoption
of Agenda

Chairman Cullen requested that the March 04, 2019 Agenda be adopted. **Commissioner Meers** ask that it be noted that he distributed copies of the Loudon County Emergency Communications District 2018 Annual Report to all Commissioners prior to the start of the meeting (**EXHIBIT 030419-M**). **Commissioner Shaver** made a motion to adopt the March 04, 2019 Commission Agenda. The motion was seconded by **Commissioner Brewster**.

Upon Voice Vote, the motion **PASSED** unanimously.

(4)
02-04-19
Minutes &
02-19-19 SCM
Minutes
Approved

Chairman Cullen requested that the February 04, 2019 Commission Meeting Minutes and the February 19, 2019 Special Called Commission Meeting Minutes be accepted and approved. **Commissioner Shaver** made a motion to accept and approve the January 07, 2019 minutes as they were written. The motion was seconded by **Commissioner Waller**.

Upon Voice Vote, the motion **PASSED** unanimously.

(5)
General
Public
Comments

Chairman Cullen opened the floor for comments by the General Public. **Pat Hunter** spoke. No other members of the general public came forward to speak.

Commissioner Meers asked that it be noted in the minutes that on November 15, 2018, **Commissioner Meers** made a request to the **Board of Education**, that they go back and give the Commission a three year summation of their budget. Commission could use that summation as a baseline to look at the **Board of Education's** requests; increases, decreases and what the requests may be for now and in the future. To date, that summation has not been provided to the Commission. Therefore, **Commissioner Meers** requested that the **County Mayor** draft a letter to **Mr. Jason Vance** to find out the status of **Commissioner Meers'** request.

(6)
Board &
Committee
Term Updates
Approved

In the absence of **Mayor Buddy Bradshaw**, **Chairman Cullen** presented Commission with **Mayor Bradshaw's** recommendations to Board and Committee Term Updates for the Solid Waste Commission, the Surplus Property Authority, and the Adult Oriented Business Board. **Commissioner Shaver** made a motion to approve all three Resolutions and **Commissioner Brewster** seconded the motion.

Upon Voice Vote, the motion **PASSED** unanimously.

RESOLUTION 030419-A, RESOLUTION 030419-B, & RESOLUTION 030419-C

(7)
STC Audit
Agreement

In the absence of **Mayor Bradshaw**, **Director of Accounts and Budgets, Tracy Blair** presented Commission with an Audit Agreement between Loudon County and **Randy Sanders DBA Situs Tax Consultants (STC)**. **Mrs. Blair** stated that the purpose of the audit is to identify any monies recorded incorrectly, recapture those funds and bring them back to Loudon County. **Commissioner Shaver** made a motion to approve the Audit Agreement and **Commissioner Whitfield** seconded the motion.

Chairman Cullen called for a Roll Call Vote.

Upon Roll Call Vote, the following Commissioners voted **AYE**: **Meers, Satterfield, Whitfield, Cullen, Duff, Shaver, Waller, and Brewster (8)**

The following Commissioners voted **NAY**: **(0)**

The following Commissioners were **ABSENT**: **Hurley & Tinker (2)**

The motion **PASSED (8/0/2)**

EXHIBIT 020419-D

(8)
TAEP GRANTS

In the absence of **Mayor Bradshaw**, **Chairman Cullen** presented Commission with **Mayor Bradshaw's** recommendation to approve applying for TAEP Grants. **Commissioner Shaver** made a motion to approve application of TAEP Grants and **Commissioner Waller** seconded the motion.

Upon Voice Vote, the motion **PASSED** unanimously.

EXHIBIT 030419-E

(9)
EDA Review
Committee
Established

Commissioner Kelly Brewster made a motion for Commission to approve the establishment of an EDA Review Committee, containing three to four commissioners to be appointed by **Mayor Bradshaw**; the purpose of the committee being to review the 2008 Inter-Local Governmental Agreement (Exhibit 020408-F) and work to update it. **Commissioner Shaver** seconded the motion.

Chairman Cullen called for a Roll Call Vote.

Upon Roll Call Vote, the following Commissioners voted **AYE: Satterfield, Whitfield, Cullen, Shaver, Waller, Brewster, and Meers (7)**

The following Commissioners voted **NAY: Duff (1)**

The following Commissioners were **ABSENT: Hurley & Tinker (2)**

The motion **PASSED (7/1/2)**

(10)
\$17,211.76
Monetary
Bequest to
Animal Shelter

Director of Accounts and Budgets, Tracy Blair requested consideration of a recommendation to approve a resolution accepting a \$17,211.76 monetary bequest for the benefit of the Loudon County Animal Shelter and authorizing the **Loudon County Mayor** to execute the necessary documents for its' receipt. **Commissioner Shaver** made a motion to approve the resolution and **Commissioner Waller** seconded the motion.

Chairman Cullen called for a Roll Call Vote.

Upon Roll Call Vote, the following Commissioners voted **AYE: Whitfield, Cullen, Duff, Shaver, Waller, Brewster, Meers and Satterfield (8)**

The following Commissioners voted **NAY: (0)**

The following Commissioners were **ABSENT: Hurley & Tinker (2)**

The motion **PASSED (8/0/2)**

RESOLUTION 030419-F

(11)
Pettway Grant
for Libraries

Director of Accounts and Budgets, Tracy Blair requested consideration of a recommendation to approve the application/acceptance of the Pettway Grant for Loudon County Libraries, with no matching funds required, as follows:

Loudon - \$5,500
Lenoir City - \$3,000
Greenback - \$3,000
Philadelphia - \$2,200

Commissioner Satterfield made a motion to approve the application/acceptance of the Pettway Grant. The motion was seconded by **Commissioner Brewster**.

Chairman Cullen called for a Roll Call Vote.

Upon Roll Call Vote, the following Commissioners voted **AYE: Cullen, Duff, Shaver, Waller, Brewster, Meers, Satterfield, and Whitfield (8)**

The following Commissioners voted **NAY: (0)**

The following Commissioners were **ABSENT**: Hurley & Tinker (2)

The motion **PASSED (8/0/2)**

(12)
Budget
Amendments
Fund 101 & 131

Director of Accounts and Budgets, Tracy Blair requested consideration of a recommendation to approve amendments in the County General Fund 101 and in the Highway Department Fund 131. **Commissioner Satterfield** made a motion to approve the amendments and a second was made by **Commissioner Shaver**.

Chairman Cullen called for a Roll Call Vote.

Upon Roll Call Vote, the following Commissioners voted **AYE**: **Duff, Shaver, Waller, Brewster, Meers, Satterfield, Whitfield, and Cullen (8)**

The following Commissioners voted **NAY**: (0)

The following Commissioners were **ABSENT**: Hurley & Tinker (2)

The motion **PASSED (8/0/2)**

EXHIBIT 030419-G & EXHIBIT 030419-H

(13)
Distribution
of Monthly
Reports

Director of Accounts and Budgets, Tracy Blair requested that the record reflect the distribution of the following reports:

- A. Budget Committee Meeting Minutes for January 22, 2019
EXHIBIT 030419-I
- B. Summary Financial Statement February 2019
EXHIBIT 030419-J
- C. Monthly Cash Flow Analysis: General Purpose School Fund 141
EXHIBIT 030419-K

(14)
Bonds &
Notaries

Commissioner Meers made a motion that was seconded by **Commissioner Waller** to approve the following bonds & notaries:

Francie L. Bacon, Ashlyn Callhan, Melissa L. Fugate, Kimberlee Fuller, Jarvis Dolar Johnson, Amy Jones, Nancy Kelley, Mary K. Longworth, Jamie Markowicz, Barbara Middlebrooks, Ricardo Olvera, Linda Lucille Parton, Roger Sierra, Kristopher H. Tindell, and Mac Tobler

Upon Voice Vote, the motion **PASSED** unanimously.

EXHIBIT 030419-L

(15)
Adjournment

There being no further business, a motion being duly made by **Commissioner Waller** and seconded by **Chairman Shaver**, the March 04, 2019 Loudon County Commission Meeting stood adjourned at 6:30 P.M.

Attest:

Loudon County Commission Chairman

Loudon County Clerk

Loudon County Mayor

LOUDON COUNTY COMMISSION
RESOLUTION 040119-A

RESOLUTION APPROVING OR ACKNOWLEDGING BOARD OR
COMMITTEE APPOINTMENT BY COUNTY MAYOR

WHEREAS, by statute, and/or Intergovernmental Agreement and/or County Procedural Regulations, the County Mayor has the authority to make certain committee and board appointments; and

WHEREAS, appointments are necessary and/or desirable at this time with a 1 year rotation term; and

WHEREAS, the County Mayor appoints the following members of the:

SURPLUS PROPERTY AUTHORITY

<u>Appointee</u>		<u>Term Expiration</u>
Van Shaver	Commissioner	April 2020
Kelly Brewster	Commissioner	April 2020
Adam Waller	Commissioner	April 2020
Matthew Tinker	Commissioner	April 2020
Buddy Bradshaw	County Mayor	April 2020
Susan Huskey	Purchasing Director	April 2020

NOW, THEREFORE, BE IT RESOLVED that the Loudon County Commission, meeting in regular session assembled this 1st day of April, 2019 hereby approves and/or acknowledges (as appropriate) the said appointments.

Attest:

Loudon County Commission Chairman

Loudon County Clerk

Loudon County Mayor

LOUDON COUNTY COMMISSION
RESOLUTION 040119-B

***A RESOLUTION ENCOURAGING THE STATE OF TENNESSEE TO REMEDY
ONLINE SALES TAX COLLECTIONS WITH AN EQUITABLE DISTRIBUTION OF REVENUES
COLLECTED BASED UPON A PRO-RATED PERCENTAGE OF THE POPULATION OF THE
UNINCORPORATED VERSUS INCORPORATED POPULATION OF THE COUNTY***

WHEREAS, online sales continue to grow and with these increases, sales tax collections have greatly expanded; however, under present legislation, these taxes are attributed to the location of a store, not to the point of sale of the purchaser; and

WHEREAS, revenues are being withheld from the county and our public school systems because the collection rules were written when online sales did not exist; and

WHEREAS, these outdated collection procedures have resulted in an unfair and inequitable result and should be remedied to better address point of sale collections by considering the percentage of the population of the unincorporated areas as it relates to the total county population.

THEREFORE, BE IT RESOLVED by the Loudon County Board of County Commissioners, meeting in regular session on this 1st day of April, 2019 that this body does hereby strongly encourage the state of Tennessee to remedy online sales tax collections and create a more equitable distribution of states tax revenues collected; and

BE IT FURTHER RESOLVED that in order to more fairly distribute collections that sales tax revenues would be distributed based upon a pro-rated share of incorporated versus unincorporated collections in the county.

Loudon County Commission Chairman

ATTEST:

Loudon County Clerk

Loudon County Mayor

LOUDON COUNTY COMMISSION
RESOLUTION 040119-C

***TO URGE THE GENERAL ASSEMBLY TO ADOPT AN EQUITABLE DISTRIBUTION
OF LOCAL SALES TAX REVENUE FROM OUT-OF-STATE SELLERS***

WHEREAS, county governments in Tennessee are the primary providers of numerous essential government services including, but not limited to , public K – 12 education, jails and law enforcement, road building and maintenance, election administration, property assessment, solid waste disposal, and record keeping and administration for the various state courts; and

WHEREAS, county governments are limited by law regarding the forms of taxation and revenue generation which they are authorized to use, making the local sales tax an important source of revenue for counties; and

WHEREAS, the House Finance, Ways, and Means Committee asked the TACIR to study revenue sources of cities and counties in Tennessee and the services each provide; and

WHEREAS, representatives of counties and cities on the TACIR working group agree that the current distribution of the uniform local sales tax rate for out-of-state sellers is inequitable and should be eliminated; and

WHEREAS, the TACIR working group recommends that local sales tax revenue from out-of-state sellers be distributed based on the destination of the purchaser.

NOW, THEREFORE BE IT RESOLVED by the Loudon County Legislative Body meeting in Regular Session at Loudon, Tennessee on this 1st day of April, 2019, that the members of the General Assembly representing the people of Loudon County are strongly urged to work for the passage of Legislation to provide for an equitable distribution of local sales tax revenue from out-of-state sellers by distributing the tax based on the destination of the purchase; and

BE IT FURTHER RESOLVED, that the county clerk shall mail certified copies of this resolution to members of the Tennessee General Assembly representing the people of Loudon County.

Adopted this 1st day of April, 2019.

Loudon County Commission Chairman

Attest:

Loudon County Clerk

Approved:

Loudon County Mayor

LOUDON COUNTY COMMISSION

EXHIBIT 040119-D



Government Product Lease Agreement with Meter Rental Agreement

Section (A) Office Information

Office Number	Office Name	Phone #	Date
962	Advanced Mailing Systems, Inc	(800) 903-4858	03/06/2019

Section (B) Billing Information

Company Name	Loudon County Clerk & Master		
DBA			
Billing Address	601 Grove St		
City State Zip+4	Loudon	TN	37774
Contact Name	Matt Klein	Phone	(865) 468-4663
Contact Title	Purchasing	Fax	
Email Address	kleinmatt@loudoncounty-tn.gov		
		PO #	

Section (C) Installation Information (if different from billing information)

Company Name	Loudon County Clerk & Master		
Installation Address	601 Grove St		
City State Zip+4	Loudon	TN	37774
Contact Name	Lisa Niles	Phone	(865) 468-2630
Contact Title	Clerk and Master	Fax	
Email Address	kleinmatt@loudoncounty-tn.gov		
Main Post Office	PO 5-Digit Zip Code		

Section (D) Products

Qty	Model / Part Number	Description (Include Serial Number, if applicable)
1	IN600AFSH	IN Series 600 Base w/ Auto Feeder, Sealer & Catch Tray
1	INWP30	IN Series 30 lb Weighing Platform
1	WP3070STON	Scale Stand for ISWP30/70 & INWP30/70

Section (E) Lease Payment Information & Schedule

Tax Status: <input type="checkbox"/> Taxable <input checked="" type="checkbox"/> Tax Exempt <i>Certificate attached</i> Billing Frequency: <input type="checkbox"/> Monthly <input checked="" type="checkbox"/> Quarterly <input type="checkbox"/> Annually Billing Method: <input type="checkbox"/> Standard <input type="checkbox"/> Amars	Number of Months First 60	Monthly Payment (Plus applicable taxes) \$174.15
	Current Lease Number: <input type="checkbox"/> ACH (Customer to submit authorization form)	

Section (F) Postage Meter & Postage Funding Information

Meter Model IN600AFAI Machine Model IN600AFSH Postage Funding Method: <input checked="" type="checkbox"/> Bill Me <input type="checkbox"/> Prepay by Check <input type="checkbox"/> ACH Debit (Submit customer authorization form) <input type="checkbox"/> OMAS <input type="checkbox"/> CPU (Include authorization form) Agency Code <input type="text"/> Sub Agency Code <input type="text"/>	Postage Funding Account: <input type="checkbox"/> POC <input type="checkbox"/> TMS <input checked="" type="checkbox"/> New <input type="checkbox"/> Existing Existing Account Number: <input type="text"/>
Service Products (Check all that apply) <input checked="" type="checkbox"/> Online Postal Rates iMeter™ App (SP10) <input type="checkbox"/> Online Postal Expense Manager iMeter™ App (SP20/NeoStats) <input type="checkbox"/> Online E-Services iMeter™ App (SP30) <input checked="" type="checkbox"/> NeoShip PLUS - Requires NeoFunds/TotalFunds (EP70PLUS) <input checked="" type="checkbox"/> NeoShip Install & User Guide (EP70GUIDES) <input type="checkbox"/> RunMyMail <input type="checkbox"/> 3G/4G Call Service <input checked="" type="checkbox"/> Maintenance <input checked="" type="checkbox"/> Installation/Training <input type="checkbox"/> Software Support	

Section (G) Approval

Existing customers who currently fund the Postage account by ACH Debit will not be converted to NeoFunds/TotalFunds unless initiated here _____

This document consists of a Government Product Lease ("Lease") with MailFinance Inc.; and a Postage Meter Rental Agreement ("Rental Agreement"), and an Online Services and Software Agreement with Neopost USA Inc.; and a NeoFunds/TotalFunds Account Agreement with Mailroom Finance, Inc. Your signature constitutes an offer to enter into the Lease and, if applicable, the other agreements, and acknowledges that you have received, read, and agree to all applicable terms and conditions (Version Government-Equipment-Lease-Terms-USPS-Dealer-v4-18), which are also available at <https://www.neopost.com/terms/government-equipment-lease-terms-usps-dealer-v4-16.pdf>, and that you are authorized to sign the agreements on behalf of the customer identified above. The applicable agreements will become binding on the companies identified above only after an authorized individual accepts your offer by signing below, or when the equipment is shipped to you.

***** SEE PURCHASE ORDER *****

Authorized Signature _____	Print Name and Title _____	Date Accepted _____
Accepted by Neopost USA and its Affiliates _____		Date Accepted _____

Customer

Organization	Loudon County Clerk & Master		
Address	801 Grove St		
City State Zip	Loudon	TN	37774
Phone	(865) 458-4663	Fax	

Example Purchase Order - Lease

NASPO/ValuePoint Contract #: ADSP0 16-169901
and / or
State Participating Addendum (PA) #: 57416 (TN)

Vendor

Company Name	MailFinance, Inc.	FEDERAL ID#	94-2984524
Attention	Government Sales	DUNS#	150836872
Address	478 Wheelers Farms Rd		
City State Zip	Milford	CT	06461
Phone	(888) 448-9045	Fax	(203) 301-2600

Ship To

Organization	Loudon County Clerk & Master		
Attention	Lisa Niles		
Address	601 Grove St		
City State Zip	Loudon	TN	37774
Phone	(865) 458-2630	Email	kleinschmidt@loudoncounty-t

P.O. Number	P.O. Date	Requisitioner	Shipped Via	F.O.B. Point	Terms
			Ground	Destination	Quarterly Invoicing
QTY	Unit	Description	Unit Price	Total	
60	Months	Lease Payment	\$174.15	\$10,449.00	

Lease payment specified above for products listed below includes, as applicable, reduced price equipment maintenance to reflect first year free, meter rental, meter resets, postal rate changes, software license/support/subscription fees, delivery, installation, and operator training.

Products

QTY	Product ID	Description
1	IN600AFSH	IN Series 600 Base w/ Autofeeder, Sealer & Catch Tray
1	INWP30	IN Series 30 lb Weighing Platform
1	WP3070STDN	Scale Stand for ISWP30/70 & INWP30/70

1) Order is governed under the terms and conditions of the NASPO/ValuePoint Master Price Agreement Contract Number ADSP016-169901. Enter this order in accordance with the prices, terms, delivery method, and specifications listed above.

2) Payments will be sent to:
MailFinance Inc.
Dept 3682
PO Box 123682
Dallas TX 75312-3682

3) Send all correspondence to:
MailFinance Inc.
478 Wheelers Farms Rd
Milford CT 06461

Authorized by _____ Date _____
Print Name _____ Title _____

This is NOT an actual purchase order. This document is intended to serve as an example for requisitioners to reference when preparing purchase orders to lease Neopost solutions available on the current NASPO/ValuePoint contract.

LOUDON COUNTY COMMISSION
EXHIBIT 040119-E

MailFinance
A Neopost USA Company

Government Product Lease Agreement
with Meter Rental Agreement

Section (A) Office Information

Office Number	Office Name	Phone #	Date
962	Advanced Mailing Systems, Inc	(800) 893-4858	03/06/2019

Section (B) Billing Information

Company Name	Loudon County Department of Health		
DEA			
Billing Address	100 River Rd, Ste 110		
City/State/Zip+4	Loudon	TN	37774
Contact Name	Susan Huskey	Phone:	(845) 458-4686
Contact Title	Senior Buyer	Fax:	
Email Address	susan.huskey@loudoncounty-tn.gov		
PO #			

Section (C) Installation Information (If different from billing information)

Company Name	Loudon County Department of Health		
Installation Address	600 Ryder Avenue		
City/State/Zip+4	Loudon	TN	37774
Contact Name	Debbie Lorenz	Phone:	(865) 458-2652
Contact Title	Manager	Fax:	
Email Address	debbie.lorenz@tn.gov		
Main Post Office	PO 5-Digit Zip Code		

Section (D) Products

Qty	Model / Part Number	Description (Include Serial Number, if applicable)
1	IN600AFSH	IN Series 800 Base w/ Auto feeder, Sealer & Catch Tray
1	INWPS	IN Series 5 lb Weighing Platform

Section (E) Lease Payment Information & Schedule

Tax Status: <input type="checkbox"/> Taxable <input checked="" type="checkbox"/> Tax Exempt <i>Certificate attached</i> Billing Frequency: <input type="checkbox"/> Monthly <input checked="" type="checkbox"/> Quarterly <input type="checkbox"/> Annually Billing Method: <input type="checkbox"/> Standard <input checked="" type="checkbox"/> ACH	Number of Months First: 90 Monthly Payment (Plus applicable taxes): \$161.66
	Current Lease Number: N14081086 <input type="checkbox"/> ACH (Customer to submit authorization form)

Section (F) Postage Meter & Postage Funding Information

Meter Model	IN600AFAT	Machine Model	IN600AFSH
Postage Funding Method: <input checked="" type="checkbox"/> Bill Me <input type="checkbox"/> Prepay by Check <input type="checkbox"/> ACH Debit (Submit customer authorization form) <input type="checkbox"/> ONAS <input type="checkbox"/> EPU (Include authorization form)		Postage Funding Account: <input checked="" type="checkbox"/> POC <input type="checkbox"/> TMS <input type="checkbox"/> New <input checked="" type="checkbox"/> Existing Existing Account Number: 6006384	
Agency Code		Sub Agency Code	

Service Products (Check all that apply)

<input checked="" type="checkbox"/> Online Postal Rates Meter™ App (SP10) <input type="checkbox"/> Online Postal Expense Manager Meter™ App (SP20/NeoStats) <input type="checkbox"/> Online E-Service Meter™ App (SP30) <input checked="" type="checkbox"/> NeoShip PLUS - Requires NeoFunds/TotalFunds (EP70PLUS) <input checked="" type="checkbox"/> NeoShip Initiat & User Guide (EP70GUIDES) <input type="checkbox"/> RankMyMail <input type="checkbox"/> 3G/4G Call Service <input checked="" type="checkbox"/> Maintenance <input checked="" type="checkbox"/> Installation/Training <input type="checkbox"/> Software Support
--

Section (G) Approval

Existing customers who currently fund the Postage account by ACH Debit will not be converted to NeoFunds/TotalFunds unless Initialed here _____

This document consists of a Government Product Lease ("Lease") with MailFinance Inc.; and a Postage Meter Rental Agreement ("Rental Agreement"), and an Online Services and Software Agreement with Neopost USA Inc.; and a NeoFunds/TotalFunds Account Agreement with MailFinance, Inc. Your signature constitutes an offer to enter into the Lease and, if applicable, the other agreements, and acknowledges that you have received, read, and agree to all applicable terms and conditions (version Government Equipment Lease Terms USPS-Dealer-v4-16), which are also available at <http://www.neopost.com/terms/government-equipment-lease-terms-usps-dealer-v4-16.pdf>; and that you are authorized to sign the agreements on behalf of the customer identified above. The applicable agreements will become binding on the companies identified above only after an authorized individual accepts your offer by signing below, or when the equipment is shipped to you.

SEE PURCHASE ORDER		
Authorized Signature	Print Name and Title	Date Accepted
Accepted by Neopost USA and its Affiliates		Date Accepted

Customer

Organization	Loudon County Department of Health		
Address	100 River Rd, Ste 110		
City State Zip	Loudon	TN	37774
Phone	(865) 458-4885	Fax	

Example Purchase Order - Lease

NASPO/ValuePoint Contract #: ADSP016-169901
and / or
State Participating Addendum (PA) #: 57416 (TN)

Vendor

Company Name	MailFinance, Inc.	FEDERAL ID# 94-2884524
Attention	Government Sales	DUNS# 150436872
Address	478 Wheelers Farms Rd	
City State Zip	Wilford	CT 06461
Phone	(866) 446-0045	Fax (203) 301-2600

Ship To

Organization	Loudon County Department of Health		
Attention	Debbie Lorenz		
Address	800 Rayder Avenue		
City State Zip	Loudon	TN	37774
Phone	(865) 458-2682	Email	dabralorenz@lcm.gov

P.O. Number	P.O. Date	Requisitioner	Shipped Via	F.O.B. Point	Terms
			Ground	Destination	Quarterly Invoicing
QTY	Unit	Description	Unit Price	Total	
60	Months	Lease Payment	\$161.68	\$9,699.60	

Lease payment specified above for products listed below includes, as applicable, reduced price equipment maintenance to reflect first year free, meter rental, meter resets, postal rate changes, software license/support/subscription fees, delivery, installation, and operator training.

Products

QTY	Product ID	Description
1	IN800AFSH	IN Series 600 Base w/ Autofeeder, Sealer & Catch Tray
1	INWVP5	IN Series 5 lb Weighing Platform

1) Order is governed under the terms and conditions of the NASPO/ValuePoint Master Price Agreement Contract Number ADSP016-169901. Enter this order in accordance with the prices, terms, delivery method, and specifications listed above.

2) Payments will be sent to:
MailFinance Inc.
Dept 3682
PO Box 123882
Dallas TX 75313-3682

3) Send all correspondence to:
MailFinance Inc.
478 Wheelers Farms Rd
Wilford CT 06461

Authorized by	Date
Print Name	Title

This is NOT an actual purchase order. This document is intended to serve as an example for requisitioners to reference when preparing purchase orders to lease Neopost solutions available on the current NASPO/ValuePoint contract.

LOUDON COUNTY COMMISSION
RESOLUTION 040119-F

**RESOLUTION CLOSING NOTCH-IN-HILL ROAD AS A PUBLIC ROAD PURSUANT TO
TENNESSEE CODE ANNOTATED § 54-10-216**

WHEREAS, Loudon County Board of Commissioners on December 3, 2018, adopted the provisions of Tenn. Code Ann. § 54-10-216 as a procedure for closing public roads in Loudon County as found in the public record as Resolution No. 120318-0; and

WHEREAS, a citizen of Loudon County filed an Application for Closure with the Loudon County Highway Superintendent requesting the County Highway Department and appropriate Planning Commissions to make recommendations to the Loudon County Board of Commissioners regarding whether or not Notch-in-Hill Road should be closed as a public road (see Exhibit 1); and

WHEREAS, the City of Loudon Regional Planning Commission recommended closure of Notch-in-Hill Road on February 6, 2019 (see Exhibit 2), and the Loudon County Regional Planning Commission recommended closure of Notch-in-Hill Road on February 19, 2019 (see Exhibit 3); and

WHEREAS, the Loudon County Highway Department, through its Chief Administrative Officer, recommends that Notch-in-Hill Road (as identified in Exhibit 4) be closed as a public road.

NOW THEREFORE, be it resolved, by a majority vote of Loudon County Board of Commissioners, in regular session assembled this ____ day of _____, 2019, that Notch-in-Hill Road (as identified in Exhibit 4) is hereby closed as a public road in Loudon County, Tennessee.

ATTEST:

APPROVED:

Carrie McKelvey, County Clerk

Rollen (Buddy) Bradshaw, Mayor

Henry Cullen, Chairman of the Loudon County
Board of Commissioners

ITEM 3.i.

APPLICATION FOR CLOSURE

Pursuant to Tenn. Code Ann. §54-10-216, I hereby submit this application to the Loudon County Highway Superintendent and request that the County Highway Department initiate the procedure for the Loudon County Regional Planning Commission to make recommendation to the Loudon County Board of Commissioners regarding whether or not Notch-in-Hill Road should be closed as a public road.

Respectfully submitted this 12 day of December, 2018.

Ron Morton
RON MORTON

Date: 12/12/18

691 Wagoner Road
Madison TN 37224
(Address)

approved 2/5/19

Eddie Simpson

EXHIBIT 1



Loudon County Planning Department

MINUTES MEETING REPORT

LOUDON REGIONAL PLANNING COMMISSION
FEBRUARY 6, 2019

101 Mulberry Street, Suite 101
Loudon, Tennessee 37774
Office: 865-458-2055
Fax: 865-458-3598
www.loudoncounty-tn.gov

Members Present	Members Absent	Others Present
LeeAnn Chihasz		Mayor Jeff Harris
Gene Gammons		Grazyna Gammons
Ham Carey, Chairman		Laura Smith, Planning
Debbie Hines		Travis Gray, Codes Enforcement
Salvador Mejia		Ron Hutson, Planning
Jim Greenway		Nate Moore, Atty.
Dennis Brennan		Eddie Simpson
Carlie McEachern		Billy Pickel
Tim Dixon		Jim Watson
		Israel Jimenez
		Tim Brewster
		Angelia Almaza

CALL TO ORDER AND APPROVAL OF MINUTES

Chairman, Ham Carey called the meeting to order at 12:30 p.m., the Pledge of Allegiance was recited and roll called. The December 5, 2018 minutes were unanimously approved on a motion by Carlie McEachern seconded by Debbie Hines.

REQUEST TO CLOSE RIGHT-OF-WAY, NOTCH-IN-HILL ROAD, TAX MAP 041, AND TAX MAP 033

Nate Moore with County Attorney, Bob Bowman's office, was present and stated that a request to close the road known as Notch-In-Hill was made to the County Road Superintendent by one of the property owners. Mr. Moore stated that although some of the property owners would be landlocked, they would have an easement to access their property per state statute. Audience member, Jim Watson stated that he farmed property out there and questioned how they would access the property. Loudon County Road Superintendent, Eddie Simpson stated that they had checked with all property owners previously, but only regarding closing of the road. Mr. Watson also stated that people had been dumping out there and he wanted the County to take care of the road. He noted that when the gas company went through, they had brought dozers out and the road became passable. Mr. Moore said that gates could be placed by the land owners but they would have to give access to property owners.

Mr. Simpson recommended closing the road. He stated that the County does not maintain the road and although it is a public road, it is not a County road. Mr. Simpson stated that existing access easements would remain and he recommended closing it. Mr. Watson and applicant, Mr. Morton, had a disagreement regarding activities occurring on the properties. Ms. Watson stated that they lease property from Ms. Hackney for cattle and if there are gates up and she can't

Serving Loudon County
Loudon • Greenback • Philadelphia

EXHIBIT 2

access the property, then there is a problem. Mr. Watson stated that he was present to speak for Ms. Karen Hackney and that she had not been contacted. Mr. Moore stated the owners would have easements and that Mr. Watson could use it with approval from the property owner. Mr. McEachern noted that it is the oldest road in the County. Mr. Moore read from an email from Mr. Bowman, which stated the property owners except for Mr. Bright had all been contacted and all agreed to the closure.

Mr. Moore further explained that the Planning Commission makes a recommendation that then goes to the Loudon County Planning Commission for recommendation then goes to Loudon County Commission for final approval and if approved, the road would be closed and would no longer be public.

ACTION

Tim Dixon moved to close the road from Vonore Road to Popular Springs Road as recommended by Mr. Simpson. The motion was seconded by Ms. Hines and approved with Ms. Chihasz, Mr. Carey, Ms. Hines, Mr. Dixon, and Mr. Greenway voting yes, Mr. Gammons, Mr. Mejia, Mr. McEachern and Mr. Brennan abstaining.

ANNUAL MEETING-ELECTION OF OFFICERS

The January meeting is typically the annual meeting when officers are elected for another term. Chairman Carey stated that it was time for someone else to be chairman. Debbie Hines moved to elect Mr. McEachern as chairman which was seconded by Mr. Gammons and approved unanimously. Mr. McEachern then nominated Ms. Hines as Vice Chairman which was seconded by Mr. Gammons and approved unanimously. Mr. McEachern then nominated Mr. Greenway to be Secretary which was seconded by Ms. Hines and approved unanimously.

2019 ANNUAL MEETING CALENDAR

Mr. McEachern moved to approve the meeting calendar for 2019 as presented which was seconded by Ms. Hines and approved unanimously.

REVIEW AND DISCUSSION, RV AND TRAVEL TRAILER PARKS AND PLANNED UNIT DEVELOPMENTS

RV and Travel Trailer Park were discussed and an example was handed out for review. The consensus was to take the discussion back up again after the BZA meeting adjourned.

ANNOUNCEMENTS AND/OR COMMENTS FROM THE BOARD/COMMISSION

None

ADJOURN

The meeting adjourned at 1:30 p.m. and will reconvene after the Board of Zoning Appeals meeting.

The Planning Commission meeting was reconvened at 1:47 p.m. and there was a discussion regarding the RV and Travel Trailer Park standards that were recently approved by the County. The commission requested reviewing those regulations and comparing them with previous

handouts. Ms. Smith will email copies of the resolution to the Planning Commission and will include it on the next meeting agenda.

PUBLIC COMMENTS

As this was Ham Carey's last day as chairman, Mr. Brennan took the opportunity to recognize him and everyone thanked him for his many years of service, work and dedication.

Councilman, Tim Brewster discussed the road frontage requirement in the subdivision regulations and a proposal to reduce it from 75' to 50'. Ms. Smith will look at other areas for example such as Maryville, Lenoir City, Alcoa, as well as several existing subdivisions in Lenoir City and report back to the commission.

ADJORN

The meeting adjourned at 2:30 p.m.

Chairman

3-6-19
Date.



Loudon County Planning Department

101 Mulberry Street, Suite 101
Loudon, Tennessee 37774
Office: 865-458-2055
Fax: 865-458-3598
www.loudoncounty-tn.gov

WORKSHOP
LOUDON COUNTY
REGIONAL PLANNING COMMISSION
FEBRUARY 19, 2019
4:30 p.m.

The Loudon County Regional Planning Commission held a continuing education/training workshop at 4:30 p.m. on the topic of the powers and procedure of the Board of Zoning Appeals.

MINUTES
LOUDON COUNTY REGIONAL PLANNING COMMISSION
February 19, 2019
5:30 p.m.

Members Present	Members Absent	Others Present
John Napier, Chairman		Nate Moore, Attorney
Carlie McEachern		Ron Hutson
Leon Shields		Laura Smith, Planning
Pat Cook		Jim Jenkins, Codes Enforcement
Pam McNew, Secretary		Eddie Simpson, Road Superintendent
Ryan Bright		Jonathan Lyons
Mark White		Mike Turner
Ed Lee		Michael Ayres
Jim Brooks		Audience Members
Andy Hamilton		
Jimmy Williams		

CALL TO ORDER, PLEDGE OF ALLEGIANCE AND APPROVAL OF MINUTES

Chairman, John Napier called the meeting to order at 5:30 p.m., the pledge of allegiance was given and roll called. Chairman Napier noted that the agenda had been amended to include "Item i" and that Item C. showed a final plat approval request and it is for preliminary approval, and the minutes to be approved are from the January 15, 2019 meeting, not November and December. Pam McNew then moved to approve the minutes which was seconded by Carlie McEachern and approved unanimously.

REZONING REQUEST FROM C-2, GENERAL COMMERCIAL DISTRICT TO R-1, SUBURBAN RESIDENTIAL DISTRICT. PROPERTY OWNER, THOMAS FELICE, APPLICANT, DAVID HENDERSON. PROPERTY ADDRESS, 1350 OLD MIDWAY RD, LENOIR CITY, TAX MAP 016, PARCEL 332.00, APPROXIMATELY 3.18 ACRES.

Mr. Henderson was present to request property he proposes buying be rezoned from C-2, General Commercial District to R-1, Suburban Residential District, in order to build a home.

Serving Loudon County
Loudon • Greenback • Philadelphia

EXHIBIT 3

Property owner, Thomas Felice, had provided written approval to the applicant for the request. Ms. Smith stated that adjacent properties to the east and south of this property are zoned R-1, Suburban Residential and recommended approval.

ACTION

Ed Lee moved to recommend approval which was seconded by Mr. McEachern and approved unanimously.

REQUEST TO CLOSE RIGHT-OF-WAY, NOTCH-IN-HILL ROAD, TAX MAP 042, TAX MAP 041, AND TAX MAP 033

Loudon County Road Superintendent, Eddie Simpson was present with Nate Moore, from County Attorney, Bob Bowman's office. Mr. Simpson summarized some history of Notch-In-Hill Road. He stated that approximately nine years ago the City of Loudon annexed the territory with the road, but then about five years ago, they deannexed the territory. At that time, Mr. Simpson did not recommend accepting the road back into the County system. It was a dirt road and public. It was brought to the attention of the Loudon County Attorney, Bob Bowman, at the request from property owner, Ron Morton to close the road, and have barriers placed at both ends because of the tires, trash, refrigerators, and other items that are dumped out there. He said that gates and barriers could go up, but only property owners would get through. Mr. Simpson stated that he had sent out notices to all the property owners and he recommended closure of the road. At the City of Loudon Regional Planning Commission meeting, there had been one lease holder who opposed the closure of the road. Mr. Moore stated that one property owner would be landlocked but that property owners would have easements and that all the property owners were in favor of the closing. Mr. Moore discussed the process for road closings. Mr. Simpson also stated that only property owners would have access through gates. He stated that the road has not been maintained by the City in five years and there are rough areas. Ms. Smith stated that the City of Loudon Regional Planning Commission recommended the closing of the road as recommended by Mr. Simpson.

ACTION

Leon Shields moved to recommend approval and there was a question regarding ownership of the right-of-way, but no one was determined as being the property owner. The motion was then seconded by Jim Brooks and approved unanimously.

REQUEST TO CLOSE PORTION OF RIGHT-OF-WAY, BUSTER BLVD. APPROXIMATE 200 LINEAR FEET BY 20' WIDTH. AREA ADJACENT TO PARCELS 20.00, 21.00, 22.00 AND 35.00 ON TAX MAP 21A, GROUP B, PROPERTY OWNER LONNIE JONES, 6115 MARTEL RD. APPLICANT, PAULA MILLER, R-1, SUBURBAN RESIDENTIAL DISTRICT

Ms. Smith summarized that Mr. Jones had requested resubdivision of 5-lots he owned off Martel Road a few months ago. There is a portion of Buster Blvd. that runs through Mr. Jones property. At that time, approval for resubdividing three of the lots was approved with Mr. Jones to get more information regarding the alley. With the request to close the portion of Buster Blvd. adjacent to Mr. Jones property, the remaining lots could be resubdivided. Ms. Smith recommended the portion be closed stating that it is unimproved, closing it would not land lock anyone, and Mr. Simpson forwarded his recommendation to close it.

ACTION

Mr. McEachern moved to recommend closing the portion of the right of way which was seconded by Mr. Lee and approved unanimously.

SUBDIVISION PLAT, REQUEST FOR EXTENSION OF PRELIMINARY, STAMFORD BRIDGE SUBDIVISION, HWY. 11E, TAX MAP 011, PARCEL 137.00, APPLICANT JONATHAN LYONS FOR PROPERTY OWNER, MIKE TURNER AND DEVELOPER, STEVE BETHEL, R-1, SUBURBAN RESIDENTIAL DISTRICT WITH PUD, PLANNED UNIT DEVELOPMENT, APPROXIMATELY 7.6 ACRES

Surveyor, Jonathan Lyons was present with Stephan Turner of Turner Homes to request extension of the preliminary plat approval of the Stamford Bridge Subdivision. Mr. Turner stated that because of rains, progress has been delayed. He stated that he thought they would be closer to complete by July. Bad dirt had cost about of month of delays but the detention pond had been completed.

ACTION

Mark White moved to approve the extension of the preliminary plat which was seconded by Ryan Bright and approved unanimously.

REZONING REQUEST FROM R-1, SUBURBAN RESIDENTIAL DISTRICT TO A-2, RURAL RESIDENTIAL DISTRICT FOR PROPOSED HORSE RIDING FACILITY, PROPERTY OWNER, JULIANNE HAMILTON, APPLICANT, MICHAEL AYRES, PROPERTY ADDRESS, 101 WILKERSON LANE, TAX MAP 007, PARCEL 114.00, APPROXIMATELY 28 ACRES;

Mr. Ayres was present and stated that he has two daughters who have trained and ridden horses. They want to have a horse farm and riding stables. He stated that it would be similar to what is seen in Kentucky and he would be investing a lot of money. The horses are "warmblood" horses and hunter jumpers.

ACTION

Mr. Brooks moved to approve the recommendation to rezone the property which was seconded by Mr. McEachern and approved unanimously.

SUBDIVISION PLAT, COMBINING 4-LOTS INTO 1-LOT, APPLICANT, BETHANY ROONEY, BDG ARCHITECTS, FOR REGIONS BANK, PROPERTY OWNER, UNION PLANTERS BANK, 6105 MORGANTON RD., GREENBACK, TAX MAP 70L, GROUP D, PARCELS 009.00, 010.00, 011.00 AND 012.00, C-2, HIGHWAY COMMERCIAL DISTRICT, CITY OF GREENBACK, APPROXIMATELY 0.63 ACRES;

Michael Foster, Architect for Regions Bank was present to request subdivision plat approval to combine the lots for an ATM that the bank proposes building. The bank is on two of the four lots. He stated that a lot of banks are now doing stand-alone ATM's. The bank will also be on the BZA agenda.

ACTION

Mr. McEachern moved to approve the plat which was seconded by Mr. Brooks and approved unanimously.

COUNTY COMMISSION ACTION ON PLANNING COMMISSION RECOMMENDATIONS

None

CODES DEPARTMENT BUILDING ACTIVITY SUMMARY

The January 2019 Building Activity Summary was attached.

ADDITIONAL PUBLIC COMMENTS

None

UPDATE FROM PLANNING DEPARTMENT

There was a reminder of the upcoming symposium and conference in March.
East Tennessee Development Symposium, March 12-13, 2019, Crown Plaza. Knoxville, TN.
Tennessee American Planning Association (TAPA) Spring Conference, March 21-22, 2019,
Black Forest Lodge by Hilton, Pigeon Forge, TN.

ADJOURN

The meeting adjourned at 6:00 p.m.

Chairman

3-19-2019
Date

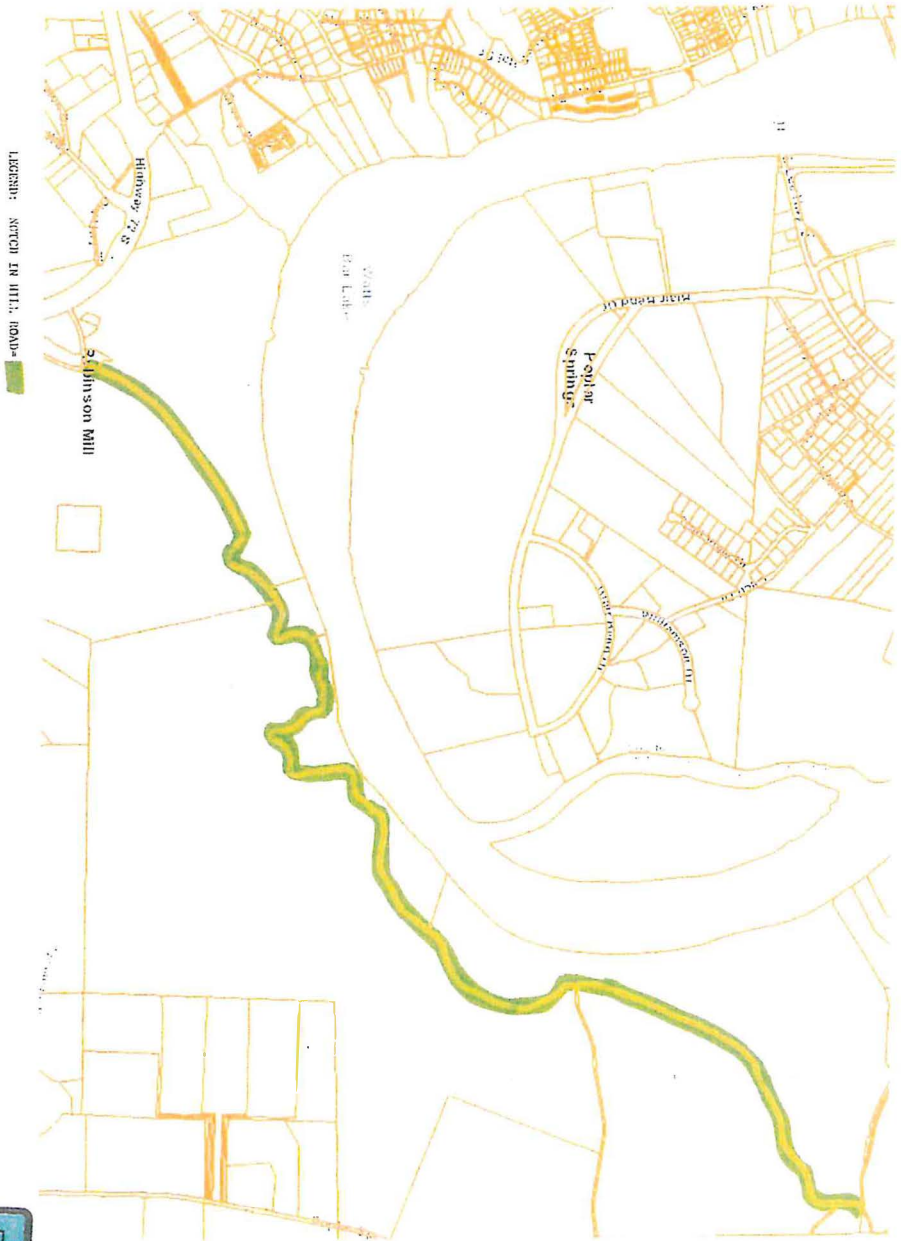

EXHIBIT 4

LOUDON COUNTY COMMISSION
RESOLUTION 040119- G

**RESOLUTION ADOPTED BY THE LOUDON COUNTY COMMISSION CLOSING A
CERTAIN PORTION OF BUSTER BLVD. LOCATED AT OR NEAR MARTEL ROAD**

WHEREAS, the chief legislative body of the county has the authority, under Tennessee Code Annotated, (TCA) §13-3-406 to accept the dedication of roads, close existing roads, adopt standards for the acceptance of new roads and reopen previously closed or abandoned roads; and

WHEREAS, the Loudon County Regional Planning Commission has received for review a request from owners (or their representatives) of property located adjacent to an abandoned road, requesting the closing of that roadway or segment known as Buster Blvd; and

WHEREAS, applicant feels the described abandoned roadway has no present nor future public use, and desires that any county encumbrance caused by the presence of the road bed be removed; and

WHEREAS, identified affected property owners were notified and a public notice and description of the request appeared in the Loudon County News Herald on February 27, 2019, consistent with the provisions of Loudon County's Procedure for Closing a Public Road; and

WHEREAS, the Loudon County Regional Planning Commission has reviewed this matter, including the recommendation of the County Highway Superintendent, and based on its investigation has determined that, in its opinion, the closing of said road will not adversely affect any property owners or the present or future function of the County's roadway system, and recommends the closure of said road, described as follows:

Buster Blvd. being more specifically shown on the attached illustration, incorporated herein.

NOW, THEREFORE, BE IT RESOLVED by the Loudon County Commission, in regular session assembled on this 1st day of April, 2019, that the afore described section of the abandoned roadway is hereby closed, with any interest the County has in the roadway being hereby relinquished as provided by law.

BE IT FURTHER RESOLVED that this Resolution shall take effect immediately, the public welfare requiring it.

This Resolution adopted this 1st day of April, 2019

Attest:

Loudon County Court Clerk

Loudon County Chairman

Approved:

Loudon County Mayor

The vote on the question of approval of this Resolution by the Planning Commission is as follows:

APPROVED: 11

DISAPPROVED: 0

Pamela S. G. McLea
ATTEST: SECRETARY, LOUDON COUNTY
REGIONAL PLANNING COMMISSION
DATE: February 19, 2019

LOUDON COUNTY COMMISSION
Resolution 040119- [G](#)
Attachment A

Loudon County - Parcel: 021A B 020.00

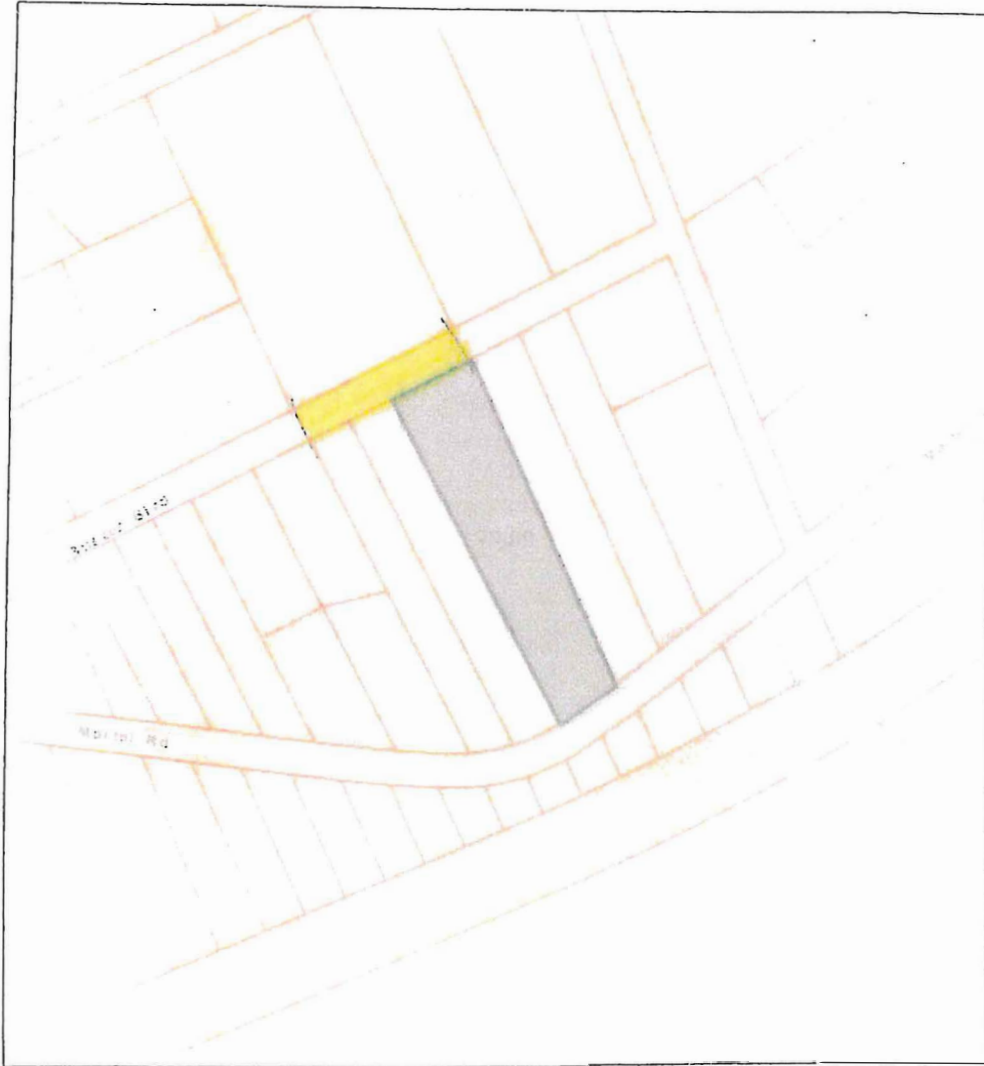

Date: February 4, 2019
County: Loudon
Owner: JONES LONNIE H
Address: MARTEL RD 61.15
Parcel Number: 021A B 020.00
Deeded Acreage: 0
Calculated Acreage: 0
Date of Imagery: 2015

TN Comptroller - OLG
State of Tennessee, Comptroller of the Treasury, Office of Local Government
(OLG)
Sources: Esri, HERE, Garmin, USGS, Intermap, INCREMENT P, NRCan,
Esri Japan, METI, Esri China (Hong Kong), Esri Korea, Esri (Thailand),
Esri India, Swire, Esri Taiwan

The property lines are compiled from information maintained by your local county Assessor's
office but are not conclusive evidence of property ownership in any court of law.

LOUDON COUNTY COMMISSION

Resolution 040119- **G**

Attachment B



Loudon County Highway Department

Eddie Simpson

Road Superintendent

292 Blair Bend Drive, Loudon, TN 37774

PHONE: 865.458.6940

FAX: 865.458.9379

EMAIL: simpson_e@loudoncounty-tn.gov

January 14, 2019

Director Smith,

It has been brought to the attention of the Superintendent of the Loudon County Highway Department that there is an unfinished portion of road platted on property that is assumed as private property.

The property in question is located at the end of Buster Boulevard, in Lenoir City. Buster Boulevard is on the County Road List as 0.1 of a mile. This road has an alleged unfinished portion that splits the property owned by, Mr. Jones. It is customary for the road bed and right of way in these instances be surrendered to the adjoining property owners fifty-fifty. In this situation Mr. Jones owns all of the property effected.

The County has incurred no expenses and has no future need for the unfinished portion of Buster Boulevard. Therefore the Loudon County Road Superintendent would like to surrender the above mentioned portion to the current property owner.

Sincerely,

Eddie Simpson, Road Superintendent

LOUDON COUNTY COMMISSION
RESOLUTION 040119- H

**A RESOLUTION AMENDING THE ZONING MAP OF LOUDON COUNTY,
TENNESSEE, PURSUANT TO CHAPTER SEVEN, §13-7-105 OF THE
TENNESSEE CODE ANNOTATED, TO REZONE APPROXIMATELY 3.18
ACRES FROM C-2 (GENERAL COMMERCIAL DISTRICT) TO R-1
(SUBURBAN RESIDENTIAL DISTRICT) 1350 OLD MIDWAY ROAD, TAX
MAP 016, PARCEL 332.00, LENOIR CITY, TN, SITUATED IN THE 2ND
LEGISLATIVE DISTRICT**

WHEREAS, the Loudon County Commission, in accordance with Chapter Seven, §13-7-105 of the Tennessee Code Annotated, may from time to time, amend the number, shape, boundary, area or any regulation of or within any district or districts, or any other provision of any zoning resolution, and

WHEREAS, the Regional Planning Commission has forwarded a recommendation regarding the amendment to the Zoning Map of Loudon County, Tennessee,

WHEREAS, a notice of public hearing and a description of the resolution appeared in the Loudon County News Herald on February 27, 2019 consistent with the provisions of Tennessee Code Annotated, §13-7-105, and

NOW, THEREFORE, BE IT RESOLVED by the Loudon County Commission that the Zoning Map of Loudon County, Tennessee be amended as follows:

Located at 1350 Old Midway Road, Lenoir City, TN situated in the 2nd Legislative District, referenced by Tax Map 016, Parcel 332.00, be rezoned from C-2 (General Commercial District) to R-1 (Suburban Residential District), being specifically shown on the attached illustration.

BE IT FINALLY RESOLVED, that this Resolution shall take effect immediately, the public welfare requiring it.

ATTEST:

LOUDON COUNTY CHAIRMAN

DATE:

April 1, 2019

APPROVED: LOUDON COUNTY MAYOR

The votes on the question of approval of this Resolution by the Planning Commission are as follows:

APPROVED: 11

DISAPPROVED: 0



ATTEST: SECRETARY LOUDON COUNTY

LOUDON COUNTY COMMISSION
Resolution 040319-H
Attachment A

REGIONAL PLANNING COMMISSION

Dated: 2019

Loudon County - Parcel: 016 332.00



County: Loudon
Owner: FELICE THOMAS
Address: OLD MIDWAY RD 1350
Parcel Number: 016 332.00
Deeded Acreage: 3.18
Calculated Acreage: 0
Date of Imagery: 2015

LOUDON COUNTY COMMISSION
RESOLUTION 040119-I

A RESOLUTION AMENDING THE ZONING MAP OF LOUDON COUNTY, TENNESSEE, PURSUANT TO CHAPTER SEVEN, §13-7-105 OF THE TENNESSEE CODE ANNOTATED, TO REZONE APPROXIMATELY 28.0 ACRES FROM R-1 (SUBURBAN RESIDENTIAL DISTRICT) TO A-2 (RURAL RESIDENTIAL DISTRICT) 101 WILKERSON LANE, LENOIR CITY, TN, SITUATED IN THE 5TH LEGISLATIVE DISTRICT

WHEREAS, the Loudon County Commission, in accordance with Chapter Seven, §13-7-105 of the Tennessee Code Annotated, may from time to time, amend the number, shape, boundary, area or any regulation of or within any district or districts, or any other provision of any zoning resolution, and

WHEREAS, the Loudon County Regional Planning Commission has forwarded a recommendation regarding the amendment to the Zoning Map of Loudon County, Tennessee,

WHEREAS, a notice of public hearing and a description of the resolution appeared in the Loudon County News Herald on February 27, 2019 consistent with the provisions of Tennessee Code Annotated, §13-7-105, and

NOW, THEREFORE, BE IT RESOLVED by the Loudon County Commission that the Zoning Map of Loudon County, Tennessee be amended as follows:

Located at 101 Wilkerson Lane, Lenoir City, TN situated in the 2^{5h} Legislative District, referenced by Tax Map 007, Parcel 114.00, be rezoned from R-1 (Suburban Residential District) to A-2 (Rural Residential District), as shown on illustration, incorporated herein.

BE IT FINALLY RESOLVED, that this Resolution shall take effect immediately, the public welfare requiring it.

ATTEST:

LOUDON COUNTY CHAIRMAN

DATE: April 1, 2019

APPROVED: LOUDON COUNTY MAYOR

The votes on the question of approval of this Resolution by the Loudon County Planning Commission are as follows:

APPROVED: 11

DISAPPROVED: 0



**ATTEST: SECRETARY LOUDON COUNTY
REGIONAL PLANNING COMMISSION**
Dated: 2019

LOUDON COUNTY COMMISSION
Resolution 040319-~~I~~
Attachment A

Loudon County - Parcel: 007 114.00



County: Loudon
Owner: HAMILTON JU LIANNE S
Address: WILKERSON LN 101
Parcel Number: 007 114.00
Deeded Acreage: 0
Calculated Acreage: 0
Date of Imagery: 2015

LOUDON COUNTY COMMISSION
EXHIBIT 040119-J



Loudon County Commission
Loudon, Tennessee

April 01, 2019

City of Lenoir City
Honorable Mayor Tony Aikens
Lenoir City Council
530 Hwy 321 N.
Lenoir City, TN 37771

Honorable Mayor and Lenoir City Council,

Residents of the Huntsville Hollow community have contacted their county representatives with a growing problem in their community due to continued development within the city limits of Lenoir City.

The Huntsville Hollow residents have always had problems with flooding during heavy rains, but over the years, the problems have continually grown worse, this due to all the new subdivisions developed in the city. These residents understand the normal flooding issues that come with their geographical location but it is undeniable that the upstream developments, within the city, have caused enormous storm water runoff increases in their community causing flooding in even more moderate rain events.

Each new subdivision developed up stream from their community adds additional storm water runoff through their neighborhood. Those subdivisions include, Chestnut Ridge, Allen Brook, Harrison Woods, Acadia Villas, Oak Hills and even a portion of Harrison Glen

The residents of Huntsville Hollow are asking that the city use Rain Tax/storm water fee revenues to take the necessary actions, within the city limits, in and around these subdivisions to mitigate the additional storm water runoff created by these developments.

Your quick attention and action to this matter would be greatly appreciated.

Sincerely,
Loudon County Commission

LOUDON COUNTY COMMISSION
EXHIBIT 040119-K



Loudon County Commission
Loudon, Tennessee

April 01, 2019

City of Lenoir City
Honorable Mayor Tony Aikens
Lenoir City Council
530 Hwy 321 N.
Lenoir City, TN 37771

Honorable Mayor and Lenoir City Council,

Several residents of the Harrison Hills subdivision have contacted their county representatives with concerns of damage to their streets during the construction of the new intersection at Harrison Road and Hwy. 95.

During the construction, a detour through the Harrison Hills subdivision was established for several weeks rerouting thousands of vehicles per day through the subdivision. In the process, a portion of Spring Road and Benjamin Drive were damaged.

According to residents of Harrison Hills, they were told by city officials that the damaged streets would be repaired and paved when the construction was completed. To date, these repairs and paving have not been done.

We would ask that Lenoir City follow through on the promises made and repair and pave the streets as was promised.

Thank you for your time and attention to this issue and your prompt action to take care of this matter.

Sincerely,
Loudon County Commission.

LOUDON COUNTY COMMISSION
RESOLUTION 040119-L

***RESOLUTION OF THE CITY COUNCIL OF LENOIR CITY, TENNESSEE SUPPORTING
AMENDMENT TO INTERLOCAL AGREEMENT WITH LOUDON COUNTY FOR THE
ROANE STATE/LIBRARY/BUSINESS DEVELOPMENT CENTER PROJECT***

WHEREAS, Loudon County is serving as fiscal agent for the Roane State/Career Center/Lenoir City Library joint building project; and

WHEREAS, in the process of auditing the books and reviewing the status of this project, the Building Committee has suggested that it is appropriate and within good accounting principles to set up a reserve fund for future improvements and capital projects that will become necessary or desirable in the future; and

WHEREAS, amendment would specifically authorize establishment of a regular current maintenance or operations designation, as well as to establish a reserve fund for future improvements and capital projects to the building.

NOW, THEREFORE, BE IT RESOLVED, the Interlocal Agreement between the County of Loudon and the City of Lenoir City, dated June 28, 1999, providing for the construction and operation of the College/Library/Business Development Center project, shall be amended by adding the following sentence to Paragraph Eight (8) of the Agreement:

The Center Executive Board (also known as the "Building Committee") shall direct the fiscal agent to establish a current building and operations designation, as well as a building maintenance and improvement designation, in an appropriate amount equal to the balance remaining as of June 30, 2019.

This amendment shall be effective on June 30, 2019 and after both parties to the Inter-local Agreement have adopted such.

LOUDON COUNTY, TENNESSEE

CITY OF LENOIR CITY, TENNESSEE

Loudon County Commission Chairman

Lenoir City Mayor

Loudon County Mayor

Attest: City Recorder

Attest: Loudon County Clerk

Loudon County
County General Fund 101
Fiscal Year Ending June 30, 2019

	A	B	C	D	E	F	G	H
1			General Fund 101					
2	Account Number		3/18/2019 11:49	2018-2019	2018-2019	Approved	Proposed	Proposed
3				Org Bgt	Amds	Amded Bgt	Amds	Amded Budget
4								
5	Revenue							
6								
7	40000		Local Taxes					
8								
9	40100		<u>County Property Taxes</u>					
10		40110	Current Property Tax	9,450,535		9,450,535		9,450,535
11		40120	Trustee's Collections Prior Year	130,000		130,000		130,000
12		40125	Trustee's Collections-Bankruptcy	4,200		4,200		4,200
13		40130	Clerk and Master's Collections Prior Year	130,000		130,000		130,000
14		40140	Interest and Penalty	33,000		33,000		33,000
15		40150	Pick-Up Taxes			0		0
16		40163 - DELCA	Payment in Lieu of Tax (DelConca)	0		0		0
17		40163 - DUPOT	Payment in Lieu of Tax (Dupont)	4,760		4,760	(4,760)	0
18		40163 - GOODS	Payment in Lieu of Tax (Goodson Coffee)	21,395		21,395		21,395
19		40163 - KIMBC	Payment in Lieu of Tax (Kimberly Clark)			0		0
20		40163 - MORG	Payment in Lieu of Tax (Morgan Olson)	75,215		75,215		75,215
21		40163 - OVRLK	Payment in Lieu of Tax (Overlook)	1,913		1,913		1,913
22		40163 - TATE	Payment in Lieu of Tax (Tate & Lyle)	293,207		293,207		293,207
23		40163 - VANHO	Payment in Lieu of Tax (VanHooseCo)	24,545		24,545		24,545
24								
25			Total County Property Taxes	10,168,770	0	10,168,770	(4,760)	10,164,010
26								
27	40200		<u>County Local Option Taxes</u>					
28		40210	Local Option Sales Tax	234,990		234,990		234,990
29		40220	Hotel/Motel Tax	440,000		440,000		440,000
30		40220 FY 2015	Hotel/Motel Tax			0		0
31		40250	Litigation Tax - General	100,000		100,000		100,000
32		40260	Litigation Tax - Special Purpose	226,795		226,795		226,795
33		40270	Business Tax	536,400		536,400		536,400
34		40275	Mixed Drink Tax	29,000		29,000		29,000
35								
36			Total County Local Option Taxes	1,567,185	0	1,567,185	0	1,567,185
37								
38								
39								
40								
41								
42	40300		<u>Statutory Local Taxes</u>					
43		40320	Bank Excise Tax	21,022		21,022		21,022
44		40330	Wholesale Beer Tax	95,000		95,000		95,000
45								
46			Total Statutory Local Taxes	116,022	0	116,022	0	116,022
47								
48	Total Local Taxes			11,851,977	0	11,851,977	(4,760)	11,847,217
49								

Loudon County
County General Fund 101
Fiscal Year Ending June 30, 2019

	A	B	C	D	E	F	G	H
1			General Fund 101					
2	Account Number		3/18/2019 11:49	2018-2019	2018-2019	Approved	Proposed	Proposed
3				Org Bgt	Amds	Amded Bgt	Amds	Amded Budget
4								
150								
151								
152	43000		Charges for Current Services					
153								
154	43100		<u>General Service Charges</u>					
155	43190-FY18		Other General Services Charges	0		0	690	690
156	43190		Other General Services Charges	0		0	32,000	32,000
157								
158			Total General Services Charges	0	0	0	32,690	32,690
159								
160	43000		<u>Fees</u>					
161	43350		Copy Fees	0		0		0
162	43366		Greenbelt Late Application Fee	0		0	100	100
163	43370		Telephone Commissions	50,000		50,000		50,000
164	43370-FY18		Telephone Commissions	0				
165	43380		Vending Machine Commissions			0		0
166	43392		Data Processing Fee - Register	21,000		21,000		21,000
167	43394		Data Processing Fee - Sheriff	10,000		10,000		10,000
168	43395		Sex Offender Registration Fee - Sheriff	3,000		3,000		3,000
169	43396		Data Processing Fee - County Clerk	3,000		3,000		3,000
170	43399		Vehicle Registration Reinstatement Fee	0		0		0
171								
172			Total Fees	87,000	0	87,000	100	87,100
173								
174	Total Charges for Current Services			87,000	0	87,000	32,790	119,790
175								
176								
177								
178								

Loudon County
County General Fund 101
Fiscal Year Ending June 30, 2019

	A	B	C	D	E	F	G	H
1			General Fund 101					
2	Account Number		3/18/2019 11:49	2018-2019	2018-2019	Approved	Proposed	Proposed
3				Org Bgt	Amds	Amded Bgt	Amds	Amded Budget
4								
179								
180	44000		Other Local Revenues					
181								
182	44100		Investments					
183	44110		Investment Income	20,000		20,000	10,000	30,000
184	44120		Lease/Rentals	2,600		2,600		2,600
185	44130		Sale of Materials and Supplies	2,200		2,200	150	2,350
186	44131		Commissary Sales	16,000		16,000	3,078	19,078
187	44140		Sale of Maps	500		500		500
188	44160		Retirees' Insurance Payments			0		0
189	44160-RET-LIF		Retirees' Insurance Payments-Life	4,453	(509)	3,944		3,944
190	44160-RET-MED		Retirees' Insurance Payments-Medical	37,397	4,656	42,053		42,053
191	44160-RET-DEN		Retirees' Insurance Payments-Dental	13,289	2,264	15,553		15,553
192	44161-COBRA-DEN		COBRA Insurance Payments-Dental			0		0
193	44161-COBRA-MED		COBRA Insurance Payments-Medical		1,949	1,949		1,949
194	44170		Miscellaneous Refunds	2,500		2,500	2,527	5,027
195	44170 AFT		Misc Refunds - AFT			0		0
196	44170 ELECT		Misc Refunds			0		0
197	44170 PROCL		Misc Refunds	0		0		0
198	44170 RESER		Misc Refunds - Sheriff's Reserves	0		0		0
199	44170 WKCMP		Misc Refunds - Workers Comp	1,083		1,083	9,382	10,465
200	44170 BELLS		Misc Refunds - (Bellsouth)	30,000		30,000	(30,000)	0
201	44180		Expenditure Credits	0		0	1,556	1,556
202	44530 ANIMA		Sale of Equipment	500				
203	44530 GOVDL		Sale of Equipment	0		0	5,400	5,400
204	44540		Sale of Property	0		0		0
205	44560		Damages Recovered from Individuals	0		0	20	20
206	44570		Contributions and Gifts (Animal Shelter)	0		0		0
207	44570-TEXT		Contributions and Gifts - Project Text-A-Tip	0		0		0
208	44570 - ASHLT		Contributions and Gifts	15,000		15,000	2,385	17,385
209	44570-AWARE		Contributions and Gifts - Community Awareness	0		0	100	100
210	44570-BQUEST		Contributions and Gifts - Animal Shelter Bequest	0		0	17,212	17,212
211	44570-CHAP		Contributions and Gifts - Sheriff's Chaplain Corp	0	100	100		100
212	44570-DIVE		Contributions and Gifts - DIVE Team	0	4,000	4,000		4,000
213	44570 - LADDs		Contributions and Gifts - Laddies Program				2,250	2,250
214	44570-LFSVR		Contributions and Gifts - Project Lifesaver	0		0	1,705	1,705
215	44570-RESER		Contributions and Gifts - Reserves	0		0	100	100
216	44570-PETSM		Contributions and Gifts - PetsMart			0	4,000	4,000
217	44570-SRCTR		Contributions and Gifts	0		0	2,000	2,000
218	44570-SRCTZ		Contributions and Gifts	0		0	1,302	1,302
219	44990		Other Local Revenue	0		0		0
220								
221			Total Investments	145,522	12,460	157,982	33,167	191,149
222								
223	Total Other Local Revenues			145,522	12,460	157,982	33,167	191,149
224								

Expensed @ 55120-
PETSM
[18Mar_01Apr2019]

Loudon County
County General Fund 101
Fiscal Year Ending June 30, 2019

	A	B	C	D	E	F	G	H
1			General Fund 101					
2	Account Number		3/18/2019 11:49	2018-2019	2018-2019	Approved	Proposed	Proposed
3				Org Bgt	Amds	Amded Bgt	Amds	Amded Budget
4								
248	46000		State of Tennessee					
249								
250	46100		<u>General Government Grants</u>					
251	46110		Juvenile Services Program	10,000		10,000		10,000
252	46140-SRCTR		Aging Programs - Sr. Center	13,528		13,528		13,528
253	46140-TCAD		Aging Programs - TN Comm on Aging & Disability	0		0		0
254	46160		State Reappraisal Grant			0		0
255	46190 PRIM		Other General Govt Grant	0		0		0
256								
257			Total General Government Grants	23,528	0	23,528	0	23,528
260								
261	46200		<u>Public Safety Grants</u>					
262	46210		Law Enforcement Grant	25,800		25,800		25,800
263	46290-GHSOG		Other Public Safety Grants-Governor's Hwy Safety O	0	5,000	5,000		5,000
264	46290-GHSOG-FY18		Other Public Safety Grants-Governor's Hwy Safety O	0	3,858	3,858		3,858
265								
266			Total Public Safety Grants	25,800	8,858	34,658	0	34,658
267								
268	46300		<u>Health and Welfare Grants</u>					
269	46310		Health Department Programs	366,700	(11,700)	355,000	58,600	413,600
270	46390-TOBAC		Tobacco Grant	0		0		0
271								
272			Total Health and Welfare Grants	366,700	(11,700)	355,000	58,600	413,600
273								
274								
275	46800-46900		<u>Other State Revenues</u>					
276	46820		Income Tax	400,000		400,000		400,000
277	46830		Beer Tax	20,000		20,000		20,000
278	46835 COCLK		Vehicle Certificate of Title Fees	9,000		9,000		9,000
279	46840		Alcoholic Beverage Tax	64,975		64,975		64,975
280	46840-FY18		Alcoholic Beverage Tax	0		0		0
281	46850		Mixed Drink Tax			0		0
282	46852		State Revenue Sharing- Telecommunications	40,000		40,000		40,000
283	46880		Board of Jurors	0		0	2,868	2,868
284	46915		Contracted Prisoner Boarding	180,000		180,000	(90,000)	90,000
285	46960		Registrar's Salary Supplement	15,000		15,000		15,000
286	46970		State Shared Sales Tax - Cities	6,000		6,000		6,000
287	46980 - ELECT		Other State Grants			0		0
288	46990		Other State Revenues			0		0
289	46990-HGUN		Other State Revenues	0		0		0
290	46990-FANTA		Other State Revenues	0		0		0
291								
292			Total Other State Revenues	734,975	0	734,975	(87,132)	647,843
293								
294	Total State of Tennessee			1,151,003	(2,842)	1,148,161	(28,532)	1,119,629
295								

Loudon County
County General Fund 101
Fiscal Year Ending June 30, 2019

	A	B	C	D	E	F	G	H
1			General Fund 101					
2			3/18/2019 11:49	2018-2019	2018-2019	Approved	Proposed	Proposed
3	Account Number			Org Bgt	Amds	Amded Bgt	Amds	Amded Budget
319								
320	48000		Other Governments and Citizens					
321								
322	<u>48100</u>		<u>Other Governments</u>					
323	48110		Prisoner Board	0		0		0
324	48130 LOANI		Contributions - Loudon for Animal Shelter	0		0		0
325	48130 LEANI		Contributions - Lenoir City for Animal Shelter	5,000		5,000		5,000
326	48140		Contracted Services/Agreements			0		0
327	48140 LOPLN		Contracted Services/Loudon City Planning	25,000		25,000		25,000
328	48140 LOPTX		Contracted Services/Agreements	0		0		0
329	48140 LEPTX		Contracted Services/Agreements	0		0		0
330	48140 PHCTY		Contracted Services/Agreements	0		0		0
331				0		0		0
332								
333			Total Other Governments	30,000	0	30,000	0	30,000
334								
335								
336	<u>48600</u>		<u>Citizen Groups and Other</u>					
337	48610-DIVE		Donations (Dive Team Resolution)	0				0
338	48610 - LUNCH		Donations (Sr. Center Lunch Program)	5,000				
339	48610 SRCTR		Donations - Sr Cntr	11,000		11,000		11,000
340	48990		Other (HIDTA)	0		0	2,500	2,500
341								
342			Total Citizens Groups and Other	16,000	0	16,000	2,500	18,500
343								
344								
345	Total Other Governments and Citizens			46,000	0	46,000	2,500	48,500
346								
347	Total Revenues			17,123,490	79,000	17,202,490	35,165	17,237,655
348								

Revenue from HIDTA
reimburses Sheriff Dept O/T
In
54110-187
[18Mar_01Apr2019]

Loudon County
County General Fund 101
Fiscal Year Ending June 30, 2019

	A	B	C	D	E	F	G	H
1			General Fund 101					
2	Account Number		3/18/2019 11:49	2018-2019	2018-2019	Approved	Proposed	Proposed
3				Org Bgt	Amds	Amded Bgt	Amds	Amded Budget
4								
349	49000		<i>Other Sources</i>					
350	49500		Other Loans Issued	0				
351	49700		Insurance Recovery	0	12,668	12,668	11,734	24,402
352	49800		Transfers In (From Gen Cap Projects Fund 171)	0		0		0
353								
354			Total Transfers In	0	12,668	12,668	11,734	24,402
355								
356								
357								
358	Total Revenues and Transfers In			17,123,490	91,668	17,215,158	46,899	17,262,057
359								
360								
361								
362								

Loudon County
County General Fund 101
Fiscal Year Ending June 30, 2019

	A	B	C	D	E	F	G	H
1			General Fund 101					
2	Account Number		3/18/2019 11:49	2018-2019	2018-2019	Approved	Proposed	Proposed
3				Org Bgt	Amds	Amded Bgt	Amds	Amded Budget
4								
465								
466	51310		Personnel Office					
467	105		Supervisor/Director of Librarians			0		0
468	140		Salary Supplement			0		0
469	162		Employee Benefits Administrator			0		0
470	169		Part-time Personnel	27,531		27,531		27,531
471	187		Overtime Wages			0		0
472	201		Social Security			0		0
473	204		State Retirement			0		0
474	206 RET		Life Insurance - Retiree	192		192		192
475	207		Medical Insurance			0		0
476	208 RET		Dental Insurance - Retiree	333		333		333
477	210		Unemployment Compensation			0		0
478	212		Employer Medicare	399		399		399
479	320		Dues & Memberships	150		150		150
480	330		Operating Lease Payments	1,200		1,200		1,200
481	337		Maintenance & Repair Equipment			0		0
482	340		Medical Services (Drug Screens/Health Check)	5,600		5,600		5,600
483	348		Postal Charges	200		200		200
484	349		Printing, Stationery, & Forms	500		500		500
485	355		Travel	1,000		1,000		1,000
486	399		Other Contracted Services - 5 Points ACA Compliance	6,000		6,000		6,000
487	414		Duplicating Supplies	0	27	27		27
488	435		Office Supplies	500		500		500
489	499		Other Supplies & Materials	800	(200)	600		600
490	513		Workers' Comp Insurance			0		0
491	524		In Services/Staff Development	500		500		500
492	711		Furniture & Fixtures			0		0
493	719		Office Equipment		200	200		200
494								
495			Total Personnel Office	44,905	27	44,932	0	44,932
496								
497								
498								
499	51400		Legal Fees					
500	331		Legal Services	155,000		155,000	(48,270)	106,730
501	331-NILES		Legal Services			0	18,270	18,270
502	399-KIMBC		Other Contracted Services	0		0	45,000	45,000
503	505		Judgments			0		0
504								
505			Total Legal Fees	155,000	0	155,000	15,000	170,000
506								

Loudon County
County General Fund 101
Fiscal Year Ending June 30, 2019

	A	B	C	D	E	F	G	H
1			General Fund 101					
2	Account Number		3/18/2019 11:49	2018-2019	2018-2019	Approved	Proposed	Proposed
3				Org Bgt	Amds	Amded Bgt	Amds	Amded Budget
4								
781								
782	52200		Purchasing					
783	105		Supervisor/Director	55,589		55,589		55,589
784	122		Purchasing Personnel	107,682		107,682		107,682
785	169		Part-time Personnel	11,318		11,318		11,318
786	187		Overtime	1,000		1,000		1,000
787	201		Social Security	10,887		10,887		10,887
788	204		State Retirement	15,951		15,951		15,951
789	206		Life Insurance	630		630		630
790	206-RET-LIF		Life Insurance	192		192		192
791	207		Medical Insurance	16,853	2,911	19,764		19,764
792	207-RET-MED		Medical Insurance	6,847	(6,847)	0		0
793	207-SRHTH		Medical Insurance	0	2,141	2,141		2,141
794	208		Dental Insurance	820	114	934		934
795	208-RET-DEN		Dental Insurance	333		333		333
796	212		Employer Medicare	2,546		2,546		2,546
797	307		Communication	3,200		3,200		3,200
798	307-WIRE		Communication	0		0		0
799	320		Dues and Memberships	960		960		960
800	330		Operating Least Payments (Copier)	3,000	(200)	2,800		2,800
801	338		Maintenance and Repair Services-Vehicl	1,000		1,000		1,000
802	348		Postal Charges	300		300		300
803	349		Printing, Stationery & Forms	1,000		1,000	(1,000)	0
804	355		Travel	2,200	800	3,000	600	3,600
805	399		Other Contracted Services	3,000	(600)	2,400	(1,000)	1,400
806	399 GOVDL		Other Contracted Services-GovDeals	500		500		500
807	399 SPLUS		Other Contracted Services - Surplus	500		500		500
808	414		Duplicating Supplies	0	189	189		189
809	425		Gasoline	590		590		590
810	435		Office Supplies	2,950	(267)	2,683		2,683
811	451		Uniforms	0	67	67		67
812	499		Other Supplies & Materials	0	200	200		200
813	508		Premiums on Corp Surety Bonds	350		350		350
814	513		Workers' Comp Insurance	3,649		3,649		3,649
815	524		In Service/Staff Development	3,000		3,000		3,000
816	711		Furniture & Fixtures	0		0		0
817	719		Office Equipment	3,000		3,000	1,400	4,400
818								
819			Total Purchasing	259,847	(1,492)	258,355	0	258,355
820								

Loudon County
County General Fund 101
Fiscal Year Ending June 30, 2019

	A	B	C	D	E	F	G	H
1			General Fund 101					
2			3/18/2019 11:49	2018-2019	2018-2019	Approved	Proposed	Proposed
3	Account Number			Org Bgt	Amds	Amded Bgt	Amds	Amded Budget
4								
821								
822	52300		Property Assessor's Office					
823	101		County Official/Administrative Officer	78,782		78,782		78,782
824	161		Staff Wages	173,015		173,015		173,015
825	168		Temporary Personnel	3,000		3,000		3,000
826	185		Educational Incentive	750		750		750
827	187		Overtime Pay	0		0		0
828	201		Social Security	15,844		15,844		15,844
829	204		State Retirement	24,522		24,522		24,522
830	206		Life Insurance	989	(8)	981		981
831	206-RET-LIF		Life Insurance - Retirees	192		192		192
832	207		Medical Insurance	44,927	(6,853)	38,074		38,074
833	207-SRHTH		Medical Insurance - Sr Health	4,408	(127)	4,281		4,281
834	208		Dental Insurance	2,952	(442)	2,510		2,510
835	208-RET-DEN		Dental Insurance - Retiree	978		978		978
836	212		Employer Medicare	3,705		3,705		3,705
837	307		Communication	1,700		1,700		1,700
838	307-WIRE		Communication	500		500		500
839	317		Data Processing Services	8,550		8,550		8,550
840	320		Dues and Memberships	4,000		4,000		4,000
841	330		Operating Lease Payments (Copier)	2,300		2,300		2,300
842	331		Legal Services	20,000		20,000	(15,000)	5,000
843	332		Legal Notices, Recording and Court Cos	100		100		100
844	334		Maintenance Agreements	13,500		13,500		13,500
845	338		Maint & Repair of Vehicles	1,000		1,000		1,000
846	348		Postage	3,000		3,000		3,000
847	349		Printing, Stationery & Forms	750		750		750
848	351		Rentals	100		100		100
849	355		Travel	5,000		5,000		5,000
850	399		Other Contracted Services	40,000		40,000		40,000
851	414		Duplicating Supplies	0	81	81		81
852	425		Gasoline	2,000		2,000		2,000
853	435		Office Supplies	2,500		2,500		2,500
854	450		Tires	400		400		400
855	451		Uniforms	500		500		500
856	508		Premium on Corporate Surety Bonds	200		200		200
857	513		Workers' Comp Insurance	5,474		5,474		5,474
858	524		In Service/Staff Development	2,000		2,000		2,000
859	711		Furniture and Fixtures	500		500		500
860	719		Office Equipment	1,000		1,000		1,000
861								
862			Total Property Assessor's Office	469,138	(7,349)	461,789	(15,000)	446,789

Legal fees associated
with K Clark expensed
at 51400
[18Mar_01Apr2019]

Loudon County
County General Fund 101
Fiscal Year Ending June 30, 2019

	A	B	C	D	E	F	G	H
1			General Fund 101					
2	Account Number		3/18/2019 11:49	2018-2019	2018-2019	Approved	Proposed	Proposed
3				Org Bgt	Amds	Amded Bgt	Amds	Amded Budget
4								
1096								
1097	53500		Juvenile Court					
1098	105		Supervisor/Director	70,335		70,335		70,335
1099	111		Probation Officer(s)	78,624		78,624		78,624
1100	161		Secretary(ies)	38,022		38,022		38,022
1101	169		Part-time Personnel	18,617		18,617		18,617
1102	187		Overtime Wages	10,000		10,000		10,000
1103	201		Social Security	13,367		13,367		13,367
1104	204		State Retirement	19,127		19,127		19,127
1105	206		Life Insurance	718		718		718
1106	206-RET-LIF		Life Insurance	116		116		116
1107	207		Medical Insurance	22,466	669	23,135		23,135
1108	208		Dental Insurance	1,622		1,622		1,622
1109	208 RET DEN		Dental Insurance - Retirees	0		0		0
1110	212		Employer Medicare	3,126		3,126		3,126
1111	212-BKPAY		Employer Medicare - Back Pay	0		0		0
1112	307		Communication	8,500		8,500		8,500
1113	307-WIRE		Communication	0		0		0
1114	309		Contracts with Gov't Agencies	10,000	11,500	21,500	1,300	22,800
1115	320		Dues and Memberships	100		100		100
1116	330		Operating Lease Payments (Copier)	1,500		1,500		1,500
1117	336		Maintenance and Repair Services-Equipment	0		0		0
1118	338		Vehicle Maintenance	3,000		3,000		3,000
1119	340		Medical & Dental Services	0		0		0
1120	348		Postal Charges	200		200		200
1121	349		Printing, Stationery & Forms	200		200		200
1122	355		Travel	4,500	(2,000)	2,500		2,500
1123	399		Other Contracted Services	3,325		3,325		3,325
1124	414		Duplicating Supplies	0	135	135		135
1125	425		Gasoline	2,000		2,000		2,000
1126	435		Office Supplies	1,500		1,500		1,500
1127	450		Tires	500		500		500
1128	499		Other Supplies and Materials	1,500		1,500		1,500
1129	513		Workers' Comp Insurance	3,649		3,649		3,649
1130	524		In Service/Staff Development	3,000	(1,500)	1,500		1,500
1131	719		Office Equipment	500		500		500
1132	790		Other Equipment	0		0		0
1133						0		0
1134			Total Juvenile Court	320,114	8,804	328,918	1,300	330,218
1135								

Loudon County
County General Fund 101
Fiscal Year Ending June 30, 2019

	A	B	C	D	E	F	G	H
1			General Fund 101					
2	Account Number		3/18/2019 11:49	2018-2019	2018-2019	Approved	Proposed	Proposed
3				Org Bgt	Amds	Amded Bgt	Amds	Amded Budget
4								
1184	54000		Public Safety					
1185								
1186	54110		Sheriff's Department					
1187	101		County Official/ Administrative Officer (Sheriff)	91,576		91,576		91,576
1188	103		Assistants (Chief Deputies)	124,577		124,577		124,577
1189	106		Deputies (XTRA = \$40,054)	1,199,906		1,199,906		1,199,906
1190	108		Investigator(s)	151,979		151,979		151,979
1191	109		Captain(s)	55,436		55,436		55,436
1192	110		Lieutenant(s)	154,914		154,914		154,914
1193	115		Sergeant(s)	101,318		101,318		101,318
1194	120		Computer Programmer	46,102		46,102		46,102
1195	140		Salary Supplement (Inservice reimb by State)	29,400		29,400		29,400
1196	161		Secretary(ies)	34,488		34,488		34,488
1197	162		Clerical Personnel	102,024		102,024		102,024
1198	166		Custodial Personnel	28,663		28,663		28,663
1199	169		Part-time Personnel (Deputies)	50,000		50,000		50,000
1200	170		School Resource Officer (XTRA = \$7,000)	401,207		401,207		401,207
1201	187		Overtime Pay	150,000		150,000	2,500	152,500
1202	187-GHSOG		Overtime (GHSO Grant)	0	4,130	4,130		4,130
1203	187-GHSOG-FY18		Overtime Pay (GHSO Grant)	5,000	(1,801)	3,199		3,199
1204	201		Social Security	168,739		168,739		168,739
1205	201-GHSOG		Social Sec (GHSO Grant)	0	257	257		257
1206	201-GHSOG-FY18		Social Security (GHSO Grant)	310	(118)	192		192
1207	204		State Retirement	343,252		343,252		343,252
1208	204		State Retirement - Improved Benefit 55/25	0		0		0
1209	204-GHSOG		Retirement (GHSO Grant)	0	546	546		546
1210	204-GHSOG-FY18		State Retirement (GHSO Grant)	661	(238)	423		423
1211	206		Life Insurance	8,914	126	9,040		9,040
1212	206-RET-LIF		Life Insurance-Retirees	1,591	(282)	1,309		1,309
1213	207		Medical Insurance	641,173	8,340	649,513		649,513
1214	207-SRHTH		Medical Insurance - Sr. Health	8,816	(254)	8,562		8,562
1215	208		Dental Insurance	34,056	(698)	33,358		33,358
1216	208-RET-DEN		Dental Insurance-Retirees	1,644		1,644		1,644
1217	210		Unemployment Compensation	0		0		0
1218	212		Employer Medicare	39,463		39,463		39,463
1219	212-GHSOG		Medicare (GHSO Grant)	0	67	67		67
1220	212-GHSOG-FY18		Employer Medicare (GHSO Grant)	73	(27)	46		46
1221	307		Communication	19,000		19,000		19,000
1222	307-WIRE		Communication	0				
1223	320		Dues and Memberships	2,750		2,750		2,750
1224	330		Operating Lease Payments	3,000		3,000		3,000
1225	330-SHERF		Operating Lease Payments (From Restricted Funds)	2,100		2,100		2,100
1226	332-AWARE		Legal Notices (From Committed Funds)	0		0		0
1227	334		Maintenance Agreements	10,000		10,000		10,000
1228	334-RADIO		Maintenance Agreements - Radios	13,000		13,000		13,000
1229	336		Equipment Maint & Repair	5,000		5,000		5,000

Reimbursed in Revenue
#48990
[18Mar_01Apr2019]

Loudon County
County General Fund 101
Fiscal Year Ending June 30, 2019

	A	B	C	D	E	F	G	H
1			General Fund 101					
2			3/18/2019 11:49	2018-2019	2018-2019	Approved	Proposed	Proposed
3	Account Number			Org Bgt	Amds	Amded Bgt	Amds	Amded Budget
4								
1230	338		Maintenance and Repair Services - Vehicles	160,000	2,668	162,668	9,531	172,199
1231	338- FY18		Maintenance and Repair Services - Vehicles	0		0		0
1232	340		Medical and Dental Services	5,000		5,000		5,000
1233	348		Postal Charges	6,000		6,000	Insurance Recovery @ 49700 [18Mar_01Apr2019]	6,000
1234	349		Printing, Stationery, and Forms	3,500		3,500		3,500
1235	349-LFSVR		Printing, Stationery, and Forms	1,000		1,000		1,000
1236	353		Tow-in Services	6,000		6,000		6,000
1237	355		Travel	10,000		10,000		10,000
1238	355- LFSVR		Travel	0		0	2,800	2,800
1239	399		Other Contracted Services	23,000		23,000		23,000
1240	412		Diesel Fuel	500		500		500
1241	413		Drugs and Medical Supplies	0		0		0
1242	414		Duplicating Supplies	0	1,749	1,749		1,749
1243	422		Food Supplies	2,000		2,000		2,000
1244	425		Gasoline	200,000		200,000		200,000
1245	435		Office Supplies	10,000		10,000		10,000
1246	450		Tires	25,000		25,000		25,000
1247	451		Uniforms	35,000		35,000		35,000
1248	451-CHAP		Uniforms	0	100	100		100
1249	499		Other Supplies and Materials	10,000		10,000		10,000
1250	499-AWARE		Other Supplies and Materials (From Committed Funds)	1,000		1,000		1,000
1251	499-LFSVR		Other Supplies and Materials (From Committed Funds)	3,000		3,000		3,000
1252	508		Premiums on Corporate Surety Bonds	250		250		250
1253	513		Worker's Comp Insurance	47,728		47,728		47,728
1254	524		In Service/Staff Development	25,000		25,000		25,000
1255	524 LFSVR		In Service/Staff Dev-Project Lifesaver	0		0		0
1256	708		Communication Equipment	10,000		10,000		10,000
1257	716		Law Enforcement Equipment	13,000		13,000		13,000
1258	716-AWARE		Law Enforcement Equipment (From Committed Funds)	1,000		1,000	100	1,100
1259	716 GHSOG		Law Enforcement Equip (GHSOG)	0		0		0
1260	716 GHSOG F15		Law Enforcement Equip (GHSOG)	0		0		0
1261	718		Vehicles	0	10,000	10,000		10,000
1262	719		Office Equipment	2,000		2,000		2,000
1263	719-SHERF		Office Equipment (From Restricted Funds)	10,000		10,000		10,000
1264								
1265			Total Sheriff's Department	4,640,110	24,565	4,664,675	14,931	4,679,606
1266								
1267								
1268								
1269								
1270								
1271								

Loudon County
County General Fund 101
Fiscal Year Ending June 30, 2019

	A	B	C	D	E	F	G	H
1			General Fund 101					
2	Account Number		3/18/2019 11:49	2018-2019	2018-2019	Approved	Proposed	Proposed
3				Org Bgt	Amds	Amded Bgt	Amds	Amded Budget
4								
1461								
1462	55000		Public Health and Welfare					
1463								
1464	55110		Local Health Department					0
1465	206 RET		Life Insurance Retirees	96		96		96
1466	207 RET		Medical Insurance - Retirees	858		858		858
1467	208 RET		Dental Insurance - Retirees	319	14	333		333
1468	307		Communication	5,000		5,000		5,000
1469	307-WIRE		Communication	0		0		0
1470	316		Contributions	4,635		4,635		4,635
1471	320		Dues & Memberships	300		300		300
1472	330		Operating Lease Payments (Copier)	4,500		4,500		4,500
1473	333		Licenses	210		210		210
1474	337		Maintenance & Repair - Office Equip	600		600	(600)	0
1475	348		Postal Charges	1,800		1,800		1,800
1476	349		Printing, Stationery & Forms	250		250		250
1477	349-FLU		Printing, Stationery & Forms	0		0		0
1478	355		Travel	1,532		1,532		1,532
1479	399		Other Contracted Services	10,895		10,895		10,895
1480	399-FLU		Other Contracted Services	0		0		0
1481	413		Medical Supplies	1,500		1,500	(1,241)	259
1482	413 FLU		Drugs & Medical Supplies	0		0		0
1483	414		Duplicating Supplies	0	323	323		323
1484	422		Food Supplies	0	400	400		400
1485	435		Office Supplies	5,287	(400)	4,887	(500)	4,387
1486	499		Other Supplies & Materials	908		908		908
1487	508		Premiums on Corporate Surety Bonds	64		64		64
1488	524		In-Service/Staff Development	1,000		1,000		1,000
1489	711		Furniture and Fixtures	426		426	(426)	0
1490	719		Office Equipment	510		510	(510)	0
1491	790		Other Equipment	1,228		1,228	3,277	4,505
1492						0		0
1493			Total Local Health Department	41,918	337	42,255	0	42,255

Loudon County
County General Fund 101
Fiscal Year Ending June 30, 2019

	A	B	C	D	E	F	G	H
1			General Fund 101					
2	Account Number		3/18/2019 11:49	2018-2019	2018-2019	Approved	Proposed	Proposed
3				Org Bgt	Amds	Amded Bgt	Amds	Amded Budget
4								
1494								
1495	55120		Animal Control					
1496	103		Assistant Director	0		0		0
1497	105		Supervisor/Director	49,879		49,879		49,879
1498	169		Part-time Personnel	29,994		29,994		29,994
1499	187		Overtime Pay	8,000		8,000		8,000
1500	189		Staff Wages	134,930		134,930		134,930
1501	201		Social Security	12,233		12,233		12,233
1502	204		State Retirement	16,246		16,246		16,246
1503	206		Life Insurance	827	121	948		948
1504	207		Medical Insurance	31,950	4,783	36,733		36,733
1505	208		Dental Insurance	1,583	175	1,758		1,758
1506	212		Employer Medicare	2,861		2,861		2,861
1507	307		Communication	4,000	166	4,166		4,166
1508	307-WIRE		Communication	0		0		0
1509	330		Operating Lease Payments	800		800		800
1510	333		Licenses	220		220		220
1511	338		Maintenance and Repair - Vehicles	1,500		1,500		1,500
1512	338 BQUST		Maintenance and Repair - Vehicles	0	3,000	3,000		3,000
1513	340		Medical & Dental Services (Vaccinations for employees)	1,000		1,000		1,000
1514	348		Postal Charges	200		200		200
1515	349		Printing, Stationery & Forms	1,327		1,327		1,327
1516	349 PETSM		Printing, Stationery & Forms	1,000		1,000		1,000
1517	355		Travel	2,000		2,000		2,000
1518	355-PETSM		Travel - PetsMart	1,000		1,000	3,000	4,000
1519	357		Veterinary Services	30,000	(246)	29,754	400	30,154
1520	357-FY18		Veterinary Services	0		0		0
1521	359		Disposal Fees	100		100		100
1522	399		Other Contracted Services	1,000		1,000	(400)	600

Loudon County
County General Fund 101
Fiscal Year Ending June 30, 2019

	A	B	C	D	E	F	G	H
1			General Fund 101					
2	Account Number		3/18/2019 11:49	2018-2019	2018-2019	Approved	Proposed	Proposed
3				Org Bgt	Amds	Amded Bgt	Amds	Amded Budget
4								
1523	401		Animal Food & Supplies	28,000		28,000		28,000
1524	401 ASHLT		Animal Food & Supplies	15,000		15,000	2,385	17,385
1525	401 BQUST		Animal Food & Supplies	15,600	(3,000)	12,600		12,600
1526	401 BQUST		Animal Food & Supplies	0	10,000	10,000		10,000
1527	401 BQUST		Animal Food & Supplies	0		0	17,211	17,211
1528	401-LADDS		Animal Food & Supplies	3,000		3,000		3,000
1529	401-PETSM		Animal Food & Supplies	5,000		5,000	(3,000)	2,000
1530	401-TEST		Animal Food & Supplies	6,500		6,500		6,500
1531	410		Custodial Supplies	5,000		5,000		5,000
1532	414		Duplicating Supplies	0	269	269		269
1533	425		Gasoline	8,000		8,000		8,000
1534	435		Office Supplies	1,500		1,500		1,500
1535	450		Tires	2,000		2,000		2,000
1536	451		Uniforms	1,500		1,500		1,500
1537	452		Utilities	9,000		9,000		9,000
1538	499		Other Supplies & Materials	1,500		1,500		1,500
1539	509		Refunds	0	80	80		80
1540	513		Workers' Comp Insurance	4,561		4,561		4,561
1541	524		In Service/Staff Development	1,000		1,000		1,000
1542	718		Vehicles	0		0		0
1543	719		Office Equipment	754		754		754
1544	790 ANIMA		Other Equipment	500		500		500
1545								
1546			Total Animal Control	441,065	15,348	456,413	19,596	476,009

Loudon County
County General Fund 101
Fiscal Year Ending June 30, 2019

	A	B	C	D	E	F	G	H
1			General Fund 101					
2	Account Number		3/18/2019 11:49	2018-2019	2018-2019	Approved	Proposed	Proposed
3				Org Bgt	Amds	Amded Bgt	Amds	Amded Budget
4								
1547								
1548	55150		Material and Child Health Services					
1549	105-TOBAC-PRE		Supervisor/Director	0		0		0
1550	201-TOBAC PRE		Social Security	0		0		0
1551	719-TOBAC-PRE		Office Equipment	0		0		0
1552								
1553				0	0	0	0	0
1554								
1555	55190		Other Local Health Services (DGA Grant)					
1556	189		Wages/Salaries	196,215		196,215	43,485	239,700
1557	187		Overtime	0		0	1,000	1,000
1558	201		Social Security	12,165		12,165	2,758	14,923
1559	204		Retirement	19,052		19,052	4,320	23,372
1560	206		Life Insurance	1,600		1,600		1,600
1561	206-RET-LIF		Life Insurance	0	96	96		96
1562	207		Medical Insurance	90,723	(13,937)	76,786	6,392	83,178
1563	207- SRHTH		Medical Insurance	0	2,141	2,141		2,141
1564	208		Dental Insurance	7,700		7,700		7,700
1565	212		Medicare	2,845		2,845	645	3,490
1566	307		Communication	500		500		500
1567	355		Travel	10,200		10,200		10,200
1568	399-TOBAC		Other Contracted Services	15,000		15,000		15,000
1569	499-TOBAC		Other Supplies and Materials	0				
1570	506		Liability Insurance	3,000		3,000		3,000
1571	513		Workman's Comp Insurance	7,700		7,700		7,700
1572	711		Furniture and Fixtures	0		0		0
1573								
1574			Total Other Local Health Services	366,700	(11,700)	355,000	58,600	413,600
1575								
1576								
1577								
1578								
1579	Total Public Health and Welfare			849,683	3,985	853,668	78,196	931,864
1580								

Loudon County
County General Fund 101
Fiscal Year Ending June 30, 2019

	A	B	C	D	E	F	G	H
1			General Fund 101					
2	Account Number		3/18/2019 11:49	2018-2019	2018-2019	Approved	Proposed	Proposed
3				Org Bgt	Amds	Amded Bgt	Amds	Amded Budget
4								
1588								
1589	56300		Senior Citizens Assistance					
1590	105		Supervisor/Director	41,984		41,984		41,984
1591	161		Office on Aging Director	32,927	3,030	35,957		35,957
1592	189		Other Salaries and Wages	57,575	1,610	59,185		59,185
1593	201		Social Security	8,214	288	8,502		8,502
1594	204		Retirement	12,864	451	13,315		13,315
1595	206		Life Insurance	674	6	680		680
1596	206-RET-LIF		Life Insurance - Retirees	500		500		500
1597	207		Medical Insurance	36,971	1,340	38,311		38,311
1598	207-RET-MED		Medical Insurance - Retirees	28	2,912	2,940		2,940
1599	207-SRHTH		Medical Insurance - Sr. Health	6,612	(190)	6,422		6,422
1600	208		Dental Insurance	2,186	220	2,406		2,406
1601	208-RET-DEN		Dental Insurance-Retirees	306	27	333		333
1602	212		Employer Medicare	1,921	67	1,988		1,988
1603	307		Communication	5,000		5,000		5,000
1604	330		Operating Lease Payments (Copier)	2,200		2,200		2,200
1605	333		Licenses	1,600		1,600		1,600
1606	336		Maintenance and Repair Services-Equipment	1,637		1,637		1,637
1607	338		Vehicle Maintenance	3,000		3,000		3,000
1608	348		Postal Charges	400		400		400
1609	349		Printing, Stationery, and Forms	0		0		0
1610	355		Travel	1,000		1,000		1,000
1611	399		Other Contracted Services	3,000		3,000		3,000
1612	410		Custodial Supplies	600		600		600
1613	414		Duplicating Supplies	0	135	135		135
1614	422 LUNCH		Food Supplies	8,000		8,000		8,000
1615	425		Gasoline	3,000		3,000		3,000
1616	435		Office Supplies	2,000	(200)	1,800		1,800
1617	437		Periodicals	0	200	200		200
1618	450		Tires & Tubes	1,000		1,000		1,000
1619	452		Utilities	15,000		15,000		15,000
1620	499		Other Supplies and Materials	600		600		600
1621	513		Workers' Comp Insurance	3,649		3,649		3,649
1622	599		Other Charges	1,000		1,000		1,000
1623	599-SRCTZ		Other Charges	0		0	2,000	2,000
1624	719		Office Equipment	0		0		0
1625	790-TCAD		Other Equipment	0		0		0
1626						0		0
1627			Total Senior Citizens Assistance	255,448	9,896	265,344	2,000	267,344
1628								
1629	56700		Parks and Fair Boards	0				
1630	316		Contributions	0				
1631				0				
1632			Total Social, Cultural, and Recreational Services	258,448	9,896	268,344	2,000	270,344
1633								

Loudon County
County General Fund 101
Fiscal Year Ending June 30, 2019

	A	B	C	D	E	F	G	H
1			General Fund 101					
2	Account Number		3/18/2019 11:49	2018-2019	2018-2019	Approved	Proposed	Proposed
3				Org Bgt	Amds	Amded Bgt	Amds	Amded Budget
4								
1678								
1679	58000		Other General Government					
1680	58110		Tourism					
1681	316		Contributions (Visitor's Bureau)	127,600		127,600		127,600
1682	316		Contributions (Visitor's Bureau)	0		0		0
1683								
1684			Total Tourism	127,600	0	127,600	0	127,600
1685								
1686	58120		Economic and Industrial Agencies					
1687	320		Dues and Memberships	3,885		3,885		3,885
1688	320		Dues & Memberships (E TN Economic Dev Agency)			0		0
1689	320		Dues & Memberships (E TN Dev District)	0		0		0
1690	316		Contributions	162,545		162,545		162,545
1691	316		Contributions (Loudon Co Ec Dev Ag)	0		0		0
1692	316		Contributions (Innovation Valley)	0		0		0
1693								
1694			Total Economic and Industrial Agencies	166,430	0	166,430	0	166,430
1695								
1696	58130		General Welfare Assistance					
1697	316		Contributions	3,000		3,000		3,000
1698	341		Pauper Burials	3,750		3,750		3,750
1699								
1700			Total General Welfare Assistance	6,750	0	6,750	0	6,750
1701								
1702	58300		Veterans Services					
1703	169		Part-time Personnel	12,824				
1704	189		Other Salaries & Wages	30,202		30,202		30,202
1705	201		Social Security	2,668		2,668		2,668
1706	212		Employer Medicare	624		624		624
1707	307		Communications	1,800		1,800	(500)	1,300
1708	307 WIRE		Communications	400		400		400
1709	316		Contributions - Veteran's Honor Guard	0		0		0
1710	320		Dues and Memberships	950		950		950
1711	330		Operating Lease Payments	250		250		250
1712	334		Maintenance Agreement - TDVA Claims Mgmt Progr	800		800	98	898
1713	338		Maintenace and Repair Services-Vehicl	500		500	(445)	55
1714	348		Postal Charges	300		300		300
1715	349		Printing, Stationery, and Forms	100		100		100
1716	355		Travel	3,000		3,000	347	3,347
1717	414		Duplicating Supplies	0	162	162		162
1718	425		Gasoline	500		500		500
1719	435		Office Supplies	600		600		600
1720	471		Software	0		0	500	500
1721	499		Other Supplies & Materials	0		0		0
1722	719		Office Equipment	0		0		0
1723								

Loudon County
County General Fund 101
Fiscal Year Ending June 30, 2019

	A	B	C	D	E	F	G	H
1			General Fund 101					
2	Account Number		3/18/2019 11:49	2018-2019	2018-2019	Approved	Proposed	Proposed
3				Org Bgt	Amds	Amded Bgt	Amds	Amded Budget
4								
1792								
1793	Total FB per June 30, 2018 Audit			7,472,649				
1794	Less Restricted, Committed & Assigned Items			808,074				
1795	Available Fund Balance July 1, 2018			6,664,575		6,664,575		6,664,575
1796								
1797								
1798								
1799								
1800								
1801	Total Revenue			17,123,490	79,000	17,202,490	35,165	17,237,655
1802	Transfers In			0	12,668	12,668	11,734	24,402
1803								
1804	Total Revenue and Transfers In			17,123,490	91,668	17,215,158	46,899	17,262,057
1805								
1806								
1807								
1808	Total Available Funds			23,788,065	91,668	23,879,733	46,899	23,926,632
1809								
1810	Expenditure Budget			18,912,029	77,077	18,989,106	96,427	19,085,533
1811	Transfers Out			0	0	0	0	0
1812								
1813	Total Expenditures and Transfer Out			18,912,029	77,077	18,989,106	96,427	19,085,533
1814								
1815	Ending Fund Balance			4,876,036	14,591	4,890,627	(49,528)	4,841,099
1816								
1817								
1818								

**Loudon County
Highway Fund 131
Fiscal Year Ending June 30, 2019**

	A	B	C	D	E	F	G	H
1			Highway Dept 131					
2	Account		3/18/2019 12:05	2018-2019	2018-2019	Approved	Proposed	Proposed
3	Number			Org Bgt	Amds	Amded Bgt	Amds	Amded Budget
4								
146								
147								
148	62000		Highway and Bridge Maintenance					
149	321		Engineering Services	500	(500)	0		0
150	323		Explosive and Drilling Services			0		0
151	351		Rentals	4,000		4,000		4,000
152	399		Other Contracted Services	30,000		30,000		30,000
153	403		Asphalt - Cold Mix	6,000		6,000		6,000
154	404		Asphalt - Hot Mix	481,560	480,000	961,560		961,560
155	408		Concrete	8,000	(1,000)	7,000		7,000
156	409		Crushed Stone	40,000		40,000		40,000
157	436		Other Road Materials	15,000		15,000		15,000
158	438		Pipe	15,000		15,000		15,000
159	443		Road Signs	4,000	2,500	6,500		6,500
160	444		Salt	20,000		20,000	(17,216)	2,784
161	445		Sand	1,000		1,000		1,000
162	468		Chemicals	2,000		2,000		2,000
163	499		Other Supplies & Materials	13,500	(3,000)	10,500		10,500
164								
165			Total Highway & Bridge Maintenance	640,560	478,000	1,118,560	(17,216)	1,101,344
166								
167								
168								
169								
170								

Loudon County
Highway Fund 131
Fiscal Year Ending June 30, 2019

	A	B	C	D	E	F	G	H
1			Highway Dept 131					
2	Account		3/18/2019 12:05	2018-2019	2018-2019	Approved	Proposed	Proposed
3	Number			Org Bgt	Amds	Amded Bgt	Amds	Amded Budget
4								
171	63100		Operation & Maintenance of Equipment					
172	336		Maintenance & Repair - Equipment	20,000	17,500	37,500	17,216	54,716
173	338		Maintenance & Repair Vehicles	20,000	(11,000)	9,000		9,000
174	353		Tow-In Services	2,000		2,000		2,000
175	359		Disposal Fees	9,000	(4,246)	4,754		4,754
176	399		Other Contracted Services			0		0
177	412		Diesel Fuel	40,000	20,000	60,000		60,000
178	416		Equipment Parts - Heavy	35,000	10,000	45,000		45,000
179	417		Equipment Parts - Light	120,000	(10,000)	110,000		110,000
180	418		Equip/Mach Parts			0		0
181	425		Gasoline	25,000		25,000		25,000
182	433		Lubricants	6,000		6,000		6,000
183	446		Small Tools			0		0
184	450		Tires and Tubes	25,000		25,000		25,000
185	499		Other Supplies & Materials	10,000	(2,000)	8,000		8,000
186	599		Other Charges	2,000		2,000		2,000
187								
188			Total Operation & Maint of Equip	314,000	20,254	334,254	17,216	351,470
189								
190								

Loudon County Board of Education
General Purpose School Fund 141
Fiscal Year Ending June 30, 2019

BUDGET AMENDMENTS						
General Fund 141						
Account Number	3/18/2019 13:42	2018-2019	2018-2019	Approved	Proposed	Proposed
		Original Budget	Amendments	Amended Budget	Amendments	Amended Budget
General Purpose School Revenue						
40000	Local Taxes					
40100	<u>County Property Taxes</u>					
40110	Current Property Tax	9,691,061	0	9,691,061	0	9,691,061
40120	Trustee's Collections Prior Year	205,000	0	205,000	0	205,000
	Total County Property Taxes	9,896,061	0	9,896,061	0	9,896,061
40125	Bankruptcy	3,000	0	3,000	0	3,000
		3,000	0	3,000	0	3,000
40100	<u>County Property Taxes</u>					
40130	Clerk and Master's Collections Prior Year	135,000	0	135,000	0	135,000
40140	Interest and Penalty	35,000	0	35,000	0	35,000
40163-TATE	Payments in-Lieu of Taxes - Tate & Lyle	324,645	0	324,645	0	324,645
	Total County Property Taxes	494,645	0	494,645	0	494,645
40200	<u>County Local Option Taxes</u>					
40210	Local Option Sales Tax	3,150,000	0	3,150,000	0	3,150,000
40275	Mixed Drink Tax	4,500	0	4,500	0	4,500
	Total County Local Option Taxes	3,154,500	0	3,154,500	0	3,154,500
40300	<u>Statutory Local Taxes</u>					
40320	Bank Excise Tax	5,000	0	5,000	0	5,000
40350	Interstate Telecommunications Tax	2,300	0	2,300	0	2,300
	Total Statutory Local Taxes	7,300	0	7,300	0	7,300
Total Local Taxes		13,555,506	0	13,555,506	0	13,555,506
41000	Licenses and Permits					
41100	<u>Licenses</u>					
41110	Marriage Licenses	1,199	0	1,199	0	1,199
41140	Cable TV Franchises	0	0	0	0	0
	Total Licenses	1,199	0	1,199	0	1,199
Total Licenses and Permits		1,199	0	1,199	0	1,199

Loudon County Board of Education
General Purpose School Fund 141
Fiscal Year Ending June 30, 2019

BUDGET AMENDMENTS						
General Fund 141						
3/18/2019 13:42						
Account Number		2018-2019	2018-2019	Approved	Proposed	Proposed
		Original Budget	Amendments	Amended Budget	Amendments	Amended Budget
43000	Charges for Current Services					
43500	Education Charges					
43542	Contract for Instructional Services with Other LEA's	0	0	0	0	0
43570	Receipts from Individual Schools	0	0	0	0	0
43581	Community Service Fees-Children	0	0	0	0	0
43583	TBI Criminal Background Fee	0	0	0	0	0
	Total Education Charges	0	0	0	0	0
Total Charges for Current Services		0	0	0	0	0
44000	Other Local Revenues					
44100	Recurring Items					
44110	Investment Income	14,000	0	14,000	0	14,000
44130	Sale of Material and Supplies	0	0	0	0	0
44145	Sale of Recycled Materials	0	0	0	0	0
44146	E-Rate Funding	0	0	0	0	0
44160-RET-DEN	Retirees' Insurance Payments	47,000	0	47,000	0	47,000
44160-RET-LIF	Retirees' Insurance Payments	6,900	0	6,900	0	6,900
44160-RET-VIS	Retirees' Insurance Payments	5,000	0	5,000	0	5,000
44161-COBRA-DEN	Cobra Insurance Payments	0	0	0	0	0
44170	Miscellaneous Refunds	2,000	0	2,000	0	2,000
44170-ATT	Miscellaneous Refunds	0	0	0	0	0
44170-TNRMT	Miscellaneous Refunds - TN Risk Management	0	0	0	142	142
	Total Recurring Items	74,900	0	74,900	142	75,042
44500	Nonrecurring Items					
44530	Sale of Equipment	0	8,130	8,130	0	8,130
44530-GOVDL	Sale of Equipment	0	7,439	7,439	0	7,439
44570-CSH	Contributions and Gifts	0	0	0	0	0
	Total Nonrecurring Items	0	15,569	15,569	0	15,569
Total Other Local Revenues		74,900	15,569	90,469	142	90,611

LCBOE:
Workers Comp
Audit refund.

Loudon County Board of Education
General Purpose School Fund 141
Fiscal Year Ending June 30, 2019

BUDGET AMENDMENTS						
General Fund 141						
Account Number	3/18/2019 13:42	2018-2019	2018-2019	Approved	Proposed	Proposed
		Original Budget	Amendments	Amended Budget	Amendments	Amended Budget
46000	State of Tennessee					
46500	State Education Funds					
46511	Basic Education Program	21,432,000	20,000	21,452,000	0	21,452,000
46515	Early Childhood Education	805,419	(35,353)	770,066	0	770,066
46520	School Food Service	0	0	0	0	0
46550	Driver Education	0	0	0	0	0
46590	Other State Education Funds	58,467	0	58,467	0	58,467
46590-FUEL	FUEL 60 Grant	0	1,500	1,500	0	1,500
46590-FRC	Family Resource Center	29,611	(29,611)	0	0	0
46590-LEAP	LEAPS Grant	232,000	77,625	309,625	0	309,625
46591	Coordinated School Health	160,000	0	160,000	0	160,000
46592	Internet Connectivity	0	0	0	0	0
46594	Family Resource Center	0	29,611	29,611	1,000	30,611
46610	Career Ladder Program	108,000	0	108,000	0	108,000
46640	Vocational Equipment	0	0	0	0	0
	Total State Education Funds	22,825,497	63,772	22,889,269	1,000	22,890,269
46800	Other State Revenues					
46840	Alcoholic Beverage Tax	0	0	0	0	0
46851	State Revenue Sharing-T.V.A.	1,100,000	0	1,100,000	0	1,100,000
	Total Other State Revenues	1,100,000	0	1,100,000	0	1,100,000
Total State of Tennessee		23,925,497	63,772	23,989,269	1,000	23,990,269
46980-FE	Other State Grants	0	10,000	10,000	0	10,000
46980-READ	Other State Grants	0	10,000	10,000	0	10,000
46980-READSUM	Other State Grants	0	0	0	60,000	60,000
46981	Safe Schools	0	152,180	152,180	0	152,180
46990	Other State Revenue	0	7,265	7,265	0	7,265
	Total	0	179,445	179,445	60,000	239,445

LCBOE:
Family Day Grant
awarded to FRC

LCBOE:
READ Summer
Grant - LES & PES

Loudon County Board of Education
General Purpose School Fund 141
Fiscal Year Ending June 30, 2019

BUDGET AMENDMENTS						
General Fund 141						
Account Number	3/18/2019 13:42	2018-2019	2018-2019	Approved	Proposed	Proposed
		Original Budget	Amendments	Amended Budget	Amendments	Amended Budget
47000	Federal Government					
47100	Federal Through State					
47143	Special Education - Grants to States	0	45,000	45,000	0	45,000
47147	Safe and Drug-Free Schools State Grant (Title IV)	0	190,732	190,732	0	190,732
47590-VR	Other Federal Through State VR Grant	0	166,040	166,040	0	166,040
	Total Federal Through State	0	401,772	401,772	0	401,772
47600	Direct Federal Revenue					
47640	ROTC Reimbursement	66,000	0	66,000	0	66,000
	Total Direct Federal Revenue	66,000	0	66,000	0	66,000
Total Federal Government		66,000	401,772	467,772	0	467,772
48600	Citizens Groups					
48610	Donations	0	250	250	0	250
48610-ALT	Donations - Alternative School	0	0	0	0	0
48610-BIT	Donations - Bridges in Transition	0	0	0	0	0
48610-CAMP	Donations - Camp Bravado	0	0	0	0	0
48610-CHR	Donations - Christmas	0	1,500	1,500	0	1,500
48610-CL	Donations - CL	0	1,000	1,000	1,314	2,314
48610-FAM	Donations - FAM	0	5,200	5,200	0	5,200
48610-FRC	Donations - FRC	0	0	0	0	0
48610-LCAP	Donations - LCA	0	0	0	0	0
48610-LCEF	Donations - LCEF	0	0	0	0	0
48610-MUSIC	Donations - MUSIC	0	0	0	0	0
48610-NMS	Donations - North Middle School	0	0	0	0	0
48610-ROBO	Donations - ROBO	0	8,438	8,438	0	8,438
48610-STAR	Donations - STAR	0	1,400	1,400	0	1,400
48610-SUP	Donations - SUP	0	1,848	1,848	0	1,848
48610-WSF	Donations - WSF	0	6,800	6,800	0	6,800
	Total Citizens Groups	0	26,436	26,436	1,314	27,750
48990	Other					
48990	Other	0	0	0	0	0
49700-INS	Insurance Recovery	0	900,607	900,607	0	900,607
49700-TNRMT	Insurance Recovery	0	100,766	100,766	1,134	101,900
49800	Transfer In	0	0	0	0	0
	LCBOE: Cost Center Change.					
Total Revenues		37,623,102	686,994	38,310,096	62,456	38,372,552
	Total Other Source	0	1,001,373	1,001,373	1,134	1,002,507
Total General Purpose School		37,623,102	1,688,367	39,311,469	63,590	39,375,059

LCBOE:
Donation received
for Winter Clothes
project.

LCBOE:
GBS scoreboard
insurance claim.

Loudon County Board of Education
General Purpose School Fund 141
Fiscal Year Ending June 30, 2019

BUDGET AMENDMENTS						
General Fund 141						
Account Number	3/18/2019 13:42	2018-2019	2018-2019	Approved	Proposed	Proposed
		Original Budget	Amendments	Amended Budget	Amendments	Amended Budget
General Purpose School Expenditures						
70000	Education					
71000	Instruction					
71100	<u>Regular Instruction Program</u>					
116	Teachers	14,575,682	(13,082)	14,562,600	(17,167)	14,545,433
116-READSUM	Teachers - READSUM	0	0	0	24,600	24,600
117	Career Ladder Program	61,500	0	61,500	0	61,500
128	Homebound Teachers	14,000	0	14,000	0	14,000
163	Educational Assistants	1,178,952	0	1,178,952	0	1,178,952
189	Other Salaries & Wages	0	4,236	4,236	0	4,236
195	Certified Substitute Teachers	45,600	0	45,600	0	45,600
198	Non-Certified Substitute Teachers	128,914	0	128,914	0	128,914
201	Social Security	992,506	380	992,886	0	992,886
201-READSUM	Social Security - READSUM	0	0	0	1,525	1,525
204	State Retirement	1,647,356	643	1,647,999	0	1,647,999
204-READSUM	State Retirement - READSUM	0	0	0	2,573	2,573
205-RET-VIS	Employee and Dependent Insurance	2,803	0	2,803	0	2,803
206	Life Insurance	56,942	0	56,942	0	56,942
206-RET-LIF	Life Insurance	14,700	0	14,700	0	14,700
207	Medical Insurance	2,577,133	0	2,577,133	0	2,577,133
207-RET-MED	Medical Insurance	52,828	0	52,828	0	52,828
208	Dental Insurance	127,942	0	127,942	0	127,942
208-RET-DEN	Dental Insurance	30,300	0	30,300	0	30,300
210	Unemployment Compensation	35,752	0	35,752	0	35,752
212	Employer Medicare	232,369	88	232,457	0	232,457
212-READSUM	Employer Medicare - READSUM	0	0	0	357	357

LCBOE:
READ Summer Grant
expenses.

**Loudon County Board of Education
General Purpose School Fund 141
Fiscal Year Ending June 30, 2019**

BUDGET AMENDMENTS							
General Fund 141							
Account Number	3/18/2019 13:42	2018-2019	2018-2019	Approved	Proposed	Proposed	
		Original Budget	Amendments	Amended Budget	Amendments	Amended Budget	
355	Travel	5,000	0	5,000	0	5,000	
399	Other Contracted Services	80,000	0	80,000	0	80,000	
429	Instructional Supplies	118,000	0	118,000	0	118,000	
429-EES	Instructional Supplies - Eaton Elementary School	48,197	0	48,197	0	48,197	
429-FLM	Instructional Supplies - Fort Loudoun Middle School	22,073	(2,287)	19,786	0	19,786	
429-GBS	Instructional Supplies - Greenback School	33,196	0	33,196	0	33,196	LCBOE: LES moving funds to PD.
429-HPS	Instructional Supplies - Highland Park Elementary School	25,832	0	25,832	0	25,832	
429-LES	Instructional Supplies - Loudon Elementary School	30,295	5,328	35,623	(1,000)	34,623	
429-LHS	Instructional Supplies - Loudon High School	46,040	0	46,040	0	46,040	
429-NMS	Instructional Supplies - North Middle School	42,256	0	42,256	0	42,256	LCBOE: PES moving funds to PD.
429-PES	Instructional Supplies - Philadelphia Elementary School	32,382	(5,600)	26,782	(250)	26,532	
429-READ	Instructional Supplies - READ	0	10,000	10,000	0	10,000	
429-READSUM	Instructional Supplies - READSUM	0	0	0	15,034	15,034	
429-SES	Instructional Supplies - Steekee Elementary School	14,735	(760)	13,975	0	13,975	
449	Textbooks	50,000	0	50,000	0	50,000	
524	In-Service Staff Development	2,000	0	2,000	0	2,000	
599	Other Charges	0	0	0	0	0	
599-READSUM	Other Charges - READSUM	0	0	0	3,996	3,996	
790	Other Equipment	250,000	0	250,000	0	250,000	
790-EES	Other Equipment - Eaton Elementary School	7,000	6,049	13,049	0	13,049	
790-FE	Other Equipment - Family Engagement	0	10,000	10,000	0	10,000	
790-FLM	Other Equipment - Fort Loudoun Middle School	7,500	0	7,500	0	7,500	
790-GBS	Other Equipment - Greenback School	13,000	0	13,000	0	13,000	
790-HPS	Other Equipment - Highland Park Elementary School	7,000	2,001	9,001	0	9,001	
790-LES	Other Equipment - Loudon Elementary School	5,000	5,328	10,328	0	10,328	
790-LHS	Other Equipment - Loudon High School	17,000	0	17,000	0	17,000	
790-NMS	Other Equipment - North Middle School	25,800	(1,775)	24,025	0	24,025	
790-PES	Other Equipment - Philadelphia Elementary School	15,000	(4,387)	10,613	0	10,613	
790-SES	Other Equipment - Steekee Elementary School	5,329	(1,000)	4,329	0	4,329	
	Total Regular Instruction Program	22,677,914	15,162	22,693,076	29,668	22,722,744	

Loudon County Board of Education
General Purpose School Fund 141
Fiscal Year Ending June 30, 2019

BUDGET AMENDMENTS						
General Fund 141						
Account Number	3/18/2019 13:42	2018-2019	2018-2019	Approved	Proposed	Proposed
		Original Budget	Amendments	Amended Budget	Amendments	Amended Budget
71150	<u>Alternative Instruction Program</u>					
499	Other Supplies & Materials	0	250	250	0	250
	Total Alternative Instruction Program	0	250	250	0	250
71200	<u>Special Education Program</u>					
116	Teachers	1,434,275	0	1,434,275	0	1,434,275
116-VR	Teachers	0	96,000	96,000	0	96,000
117	Career Ladder Program	2,500	0	2,500	0	2,500
128	Homebound Teachers	23,000	0	23,000	0	23,000
163	Educational Assistants	343,331	0	343,331	0	343,331
163-VR	Educational Assistants	0	47,000	47,000	0	47,000
171	Speech Pathologist	173,181	0	173,181	0	173,181
189	Other Salaries & Wages	40,000	0	40,000	0	40,000
195	Certified Substitute Teachers	5,000	0	5,000	0	5,000
198	Non-Certified Substitute Teachers	26,000	0	26,000	0	26,000
201	Social Security	129,535	0	129,535	0	129,535
201-VR	Social Security	0	8,866	8,866	0	8,866
204	State Retirement	212,809	0	212,809	0	212,809
204-VR	State Retirement	0	12,100	12,100	0	12,100
205-RET-VIS	Employee and Dependent Insurance	660	0	660	0	660
206	Life Insurance	8,418	0	8,418	0	8,418
206-RET-LIF	Life Insurance	1,511	0	1,511	0	1,511
207	Medical Insurance	357,291	0	357,291	0	357,291
207-RET-MED	Medical Insurance	3,750	0	3,750	0	3,750
208	Dental Insurance	17,000	0	17,000	0	17,000
208-RET-DEN	Dental Insurance	4,300	0	4,300	0	4,300
212	Employer Medicare	30,295	0	30,295	0	30,295
212-VR	Employer Medicare	0	2,074	2,074	0	2,074
399	Other Contracted Services	0	0	0	0	0
429	Instructional Supplies	81,752	(10,000)	71,752	(10,000)	61,752
499	Other Supplies & Materials	0	10,000	10,000	10,000	20,000
725	Special Education Equipment	103,500	0	103,500	0	103,500
	Total Special Instruction Program	2,998,108	166,040	3,164,148	0	3,164,148

LCBOE:
Moving funds to
Other Supplies &
Materials

Loudon County Board of Education
General Purpose School Fund 141
Fiscal Year Ending June 30, 2019

BUDGET AMENDMENTS						
General Fund 141						
3/18/2019 13:42						
Account Number		2018-2019	2018-2019	Approved	Proposed	Proposed
		Original Budget	Amendments	Amended Budget	Amendments	Amended Budget
71300	<i>Vocational Education Program</i>					
116	Teachers	726,519	0	726,519	0	726,519
117	Career Ladder Program	6,000	0	6,000	0	6,000
163	Educational Assistants	20,805	0	20,805	0	20,805
195	Certified Substitute Teachers	5,700	0	5,700	0	5,700
198	Non-Certified Substitute Teachers	10,000	0	10,000	0	10,000
201	Social Security	47,680	0	47,680	0	47,680
204	State Retirement	78,640	0	78,640	0	78,640
205-RET-VIS	Employee and Dependent Insurance	173	0	173	0	173
206	Life Insurance	2,550	0	2,550	0	2,550
206-RET-LIF	Life Insurance	400	0	400	0	400
207	Medical Insurance	141,265	0	141,265	0	141,265
208	Dental Insurance	5,400	0	5,400	0	5,400
208-RET-DEN	Dental Insurance	810	0	810	0	810
212	Employer Medicare	11,151	0	11,151	0	11,151
336	Maintenance and Repair Services-Equipment	2,300	1,000	3,300	0	3,300
355	Travel	8,000	0	8,000	0	8,000
399	Other Contracted Services	0	0	0	0	0
425	Gasoline	200	0	200	0	200
429	Instructional Supplies	74,386	6,839	81,225	0	81,225
790	Other Equipment	60,000	(1,000)	59,000	0	59,000
790-CTE	Other Equipment	0	0	0	0	0
	Total Vocational Education Program	1,201,979	6,839	1,208,818	0	1,208,818
Total Instruction		26,878,001	188,291	27,066,292	29,668	27,095,960

Loudon County Board of Education
General Purpose School Fund 141
Fiscal Year Ending June 30, 2019

BUDGET AMENDMENTS						
General Fund 141						
Account Number	3/18/2019 13:42	2018-2019	2018-2019	Approved	Proposed	Proposed
		Original Budget	Amendments	Amended Budget	Amendments	Amended Budget
72000	Support Services					
72120	Health Services					
105-CSH	Supervisor/Director	51,226	(7,745)	43,481	0	43,481
131	Medical Personnel	287,652	0	287,652	0	287,652
189-CSH	Other Salaries & Wages	64,693	(25,701)	38,992	12,000	50,992
201	Social Security	17,835	0	17,835	0	17,835
201-CSH	Social Security	7,236	(2,123)	5,113	744	5,857
204	State Retirement	27,931	0	27,931	0	27,931
204-CSH	State Retirement	6,929	673	7,602	1,256	8,858
205-RET-VIS	Employee and Dependent Insurance	102	0	102	0	102
206	Life Insurance	1,635	0	1,635	0	1,635
206-CSH	Life Insurance	354	354	708	0	708
206-RET-LIF	Life Insurance	325	0	325	0	325
207	Medical Insurance	59,961	0	59,961	0	59,961
207-CSH	Medical Insurance	11,211	0	11,211	0	11,211
208	Dental Insurance	2,400	0	2,400	0	2,400
208-CSH	Dental Insurance	377	377	754	0	754
208-RET-DEN	Dental Insurance	432	0	432	0	432
212	Employer Medicare	4,171	0	4,171	0	4,171
212-CSH	Employer Medicare	1,692	(496)	1,196	174	1,370
355	Travel	400	0	400	0	400
355-CSH	Travel	1,800	1,200	3,000	(1,500)	1,500
399	Other Contracted Services	9,100	0	9,100	0	9,100
399-CSH	Other Contracted Services	500	5,500	6,000	(2,700)	3,300
413	Drugs and Medical Supplies	4,900	0	4,900	0	4,900
435	Office Supplies	1,000	0	1,000	0	1,000
499-CSH	Other Supplies & Materials	7,193	26,750	33,943	(12,274)	21,669
524	In-Service/Staff Development	600	0	600	0	600
524-CSH	In-Service/Staff Development	6,789	211	7,000	(1,400)	5,600
735-CSH	Health Equipment	0	1,000	1,000	3,700	4,700
	Total Health Services	578,444	0	578,444	0	578,444

LCBOE:
CSH amendments
for Quest Camps

Loudon County Board of Education
General Purpose School Fund 141
Fiscal Year Ending June 30, 2019

BUDGET AMENDMENTS								
General Fund 141								
Account Number	3/18/2019 13:42	2018-2019	2018-2019	Approved	Proposed	Proposed		
		Original Budget	Amendments	Amended Budget	Amendments	Amended Budget		
72130	<u>Other Student Support</u>							
117	Career Ladder Program	3,000	0	3,000	0	3,000		
123	Guidance Personnel	655,416	0	655,416	0	655,416		
162	Clerical Personnel	195,290	0	195,290	0	195,290		
201	Social Security	53,000	0	53,000	0	53,000		
204	State Retirement	87,900	0	87,900	0	87,900		
205-RET-VIS	Employee and Dependent Insurance	102	0	102	0	102		
206	Life Insurance	3,351	0	3,351	0	3,351	LCBOE: Moving funds from travel	
206-RET-LIF	Life Insurance	480	0	480	0	480		
207	Medical Insurance	152,131	0	152,131	0	152,131		
207-RET-MED	Medical Insurance	0	0	0	0	0		
208	Dental Insurance	6,200	0	6,200	0	6,200	LCBOE: READ Summer Grant expenses.	
208-RET-DEN	Dental Insurance	432	0	432	0	432		
212	Employer Medicare	12,400	0	12,400	0	12,400		
322	Evaluation and Testing	20,000	0	20,000	0	20,000		
355	Travel	500	0	500	(500)	0		
399-SAFE	Contracted Services	0	2,800	2,800	0	2,800		
499-READSUM	Other Supplies & Materials - READSUM	0	0	0	1,836	1,836		
524	In Service/Staff Development	4,500	0	4,500	500	5,000		
790-SAFE	Other Equipment	0	40,680	40,680	0	40,680		
	Total Other Student Support	1,194,702	43,480	1,238,182	1,836	1,240,018		

Loudon County Board of Education
General Purpose School Fund 141
Fiscal Year Ending June 30, 2019

BUDGET AMENDMENTS							
General Fund 141							
Account Number	3/18/2019 13:42	2018-2019	2018-2019	Approved	Proposed	Proposed	
		Original Budget	Amendments	Amended Budget	Amendments	Amended Budget	
72210	<u>Regular Instruction Program</u>						
105	Supervisor/Director	306,788	0	306,788	0	306,788	LCBOE: READ Summer Grant expenses.
105-READSUM	Supervisor/Director - READSUM	0	0	0	6,500	6,500	
117	Career Ladder Program	4,000	0	4,000	0	4,000	
129	Librarians	491,199	0	491,199	0	491,199	
161	Secretary (s)	286,830	0	286,830	0	286,830	
201	Social Security	67,507	0	67,507	0	67,507	
201-READSUM	Social Security - READSUM	0	0	0	403	403	
204	State Retirement	111,740	0	111,740	0	111,740	
204-READSUM	State Retirement - READSUM	0	0	0	680	680	
205-RET-VIS	Employee and Dependent Insurance	465	0	465	0	465	
206	Life Insurance	4,248	0	4,248	0	4,248	
206-RET-LIF	Life Insurance	1,790	0	1,790	0	1,790	
207	Medical Insurance	217,036	0	217,036	0	217,036	
207-RET-MED	Medical Insurance	5,000	0	5,000	0	5,000	
208	Dental Insurance	8,500	0	8,500	0	8,500	
208-REF-DEN	Dental Insurance	3,610	0	3,610	0	3,610	
212	Employer Medicare	15,788	0	15,788	0	15,788	
212-READSUM	Employer Medicare - READSUM	0	0	0	95	95	
348-READSUM	Postal Charges - READSUM	0	0	0	2	2	
355	Travel	17,000	0	17,000	0	17,000	
355-READSUM	Travel - READSUM	0	0	0	400	400	
432-EES	Library Books/Media - Eaton Elementary School	8,768	0	8,768	0	8,768	LCBOE: LES moving funds to PD.
432-FLM	Library Books/Media - Fort Loudoun Middle School	4,697	0	4,697	0	4,697	
432-GBS	Library Books/Media - Greenback School	8,448	4,937	13,385	0	13,385	
432-HPS	Library Books/Media - Highland Park Elementary School	4,659	(1,000)	3,659	0	3,659	
432-LES	Library Books/Media - Loudon Elementary School	5,606	0	5,606	(606)	5,000	
432-LHS	Library Books/Media - Loudon High School	9,536	0	9,536	0	9,536	
432-NMS	Library Books/Media - North Middle School	8,696	(2,000)	6,696	0	6,696	LCBOE: PES moving funds to PD.
432-PES	Library Books/Media - Philadelphia Elementary School	7,526	(3,389)	4,137	(273)	3,864	
432-SES	Library Books/Media - Steekee Elementary School	3,500	0	3,500	0	3,500	
524	In-Service/Staff Development	12,000	0	12,000	0	12,000	
524-EES	In-Service/Staff Development - Eaton Elementary School	5,500	0	5,500	0	5,500	
524-FLM	In-Service/Staff Development - Fort Loudoun Middle School	5,300	0	5,300	0	5,300	
524-GBS	In-Service/Staff Development - Greenback School	13,300	0	13,300	0	13,300	
524-HPS	In-Service/Staff Development - Highland Park Elem. School	4,900	0	4,900	0	4,900	
524-LES	In-Service/Staff Development - Loudon Elementary School	5,000	0	5,000	1,606	6,606	
524-LHS	In-Service/Staff Development - Loudon High School	6,100	(845)	5,255	0	5,255	
524-NMS	In-Service/Staff Development - North Middle School	6,750	0	6,750	0	6,750	LCBOE: READ Summer Grant expenses.
524-PES	In-Service/Staff Development - Philadelphia Elem. School	6,400	0	6,400	523	6,923	
524-READSUM	In-Service/Staff Development - READSUM	0	0	0	593	593	
524-SES	In-Service/Staff Development - Steekee Elementary School	4,600	(600)	4,000	0	4,000	
790	Other Equipment	0	0	0	0	0	
790-SAFE	Other Equipment	0	108,700	108,700	0	108,700	
	Total Regular Instruction Program	1,672,787	105,803	1,778,590	9,923	1,788,513	

Loudon County Board of Education
General Purpose School Fund 141
Fiscal Year Ending June 30, 2019

BUDGET AMENDMENTS						
General Fund 141						
Account Number	3/18/2019 13:42	2018-2019	2018-2019	Approved	Proposed	Proposed
		Original Budget	Amendments	Amended Budget	Amendments	Amended Budget
72220	<u>Special Education Program</u>					
105	Supervisor/Director	29,103	0	29,103	0	29,103
117	Career Ladder Program	1,000	0	1,000	0	1,000
124	Psychological Personnel	290,823	0	290,823	0	290,823
171	Speech Pathologist	60,728	0	60,728	0	60,728
201	Social Security	23,663	0	23,663	0	23,663
204	State Retirement	39,922	0	39,922	0	39,922
205-RET-VIS	Employee and Dependent Insurance	203	0	203	0	203
206	Life Insurance	1,200	0	1,200	0	1,200
206-RET-LIF	Life Insurance	385	0	385	0	385
207	Medical Insurance	54,800	0	54,800	0	54,800
207-RET-MED	Medical Insurance	3,900	0	3,900	0	3,900
208	Dental Insurance	2,200	0	2,200	0	2,200
208-REF-DEN	Dental Insurance	863	0	863	0	863
212	Employer Medicare	5,534	0	5,534	0	5,534
355	Travel	21,650	0	21,650	0	21,650
399	Other Contracted Services	180,000	39,000	219,000	0	219,000
399-STAR	Other Contracted Services	0	1,400	1,400	0	1,400
524	In-Service/Staff Development	0	0	0	0	0
	Total Special Education Program	715,974	40,400	756,374	0	756,374

Loudon County Board of Education
General Purpose School Fund 141
Fiscal Year Ending June 30, 2019

BUDGET AMENDMENTS							
General Fund 141							
Account Number	3/18/2019 13:42	2018-2019	2018-2019	Approved	Proposed	Proposed	
		Original Budget	Amendments	Amended Budget	Amendments	Amended Budget	
72230	<i>Vocational Education Program</i>						
105	Supervisor/Director	76,688	0	76,688	0	76,688	
162	Clerical Personnel	40,780	0	40,780	0	40,780	
201	Social Security	7,283	0	7,283	0	7,283	
204	State Retirement	11,982	0	11,982	0	11,982	
205-RET-VIS	Employee and Dependent Insurance	102	0	102	0	102	
206	Life Insurance	360	0	360	0	360	
206-RET-LIF	Life Insurance	200	0	200	0	200	
207	Medical Insurance	14,800	0	14,800	0	14,800	
207-RET-MED	Medical Insurance	0	0	0	0	0	
208	Dental Insurance	700	0	700	0	700	
208-REF-DEN	Dental Insurance	440	0	440	0	440	
212	Employer Medicare	1,703	0	1,703	0	1,703	
355	Travel	2,000	0	2,000	0	2,000	
399	Other Contracted Services	500	600	1,100	0	1,100	
524	In-Service/Staff Development	2,000	0	2,000	0	2,000	
	Total Vocational Education Program	159,538	600	160,138	0	160,138	

Loudon County Board of Education
General Purpose School Fund 141
Fiscal Year Ending June 30, 2019

BUDGET AMENDMENTS							
General Fund 141							
Account Number	3/18/2019 13:42	2018-2019	2018-2019	Approved	Proposed	Proposed	
		Original Budget	Amendments	Amended Budget	Amendments	Amended Budget	
72250	<u>Education Technology</u>						
105	Supervisor/Director	97,008	0	97,008	0	97,008	
117	Career Ladder Program	1,000	0	1,000	0	1,000	
120	Computer Programmer	229,555	0	229,555	0	229,555	
201	Social Security	20,309	0	20,309	0	20,309	
204	State Retirement	32,542	0	32,542	0	32,542	
206	Life Insurance	961	0	961	0	961	
207	Medical Insurance	56,733	0	56,733	0	56,733	
208	Dental Insurance	2,142	0	2,142	0	2,142	
212	Employer Medicare	4,750	0	4,750	0	4,750	
350	Internet Connectivity	100,000	0	100,000	0	100,000	
350-IC	Internet Connectivity	0	0	0	0	0	
355	Travel	5,400	0	5,400	0	5,400	
399	Other Contracted Services	12,000	0	12,000	0	12,000	
471	Software	170,000	0	170,000	0	170,000	
499	Other Supplies & Materials	4,000	0	4,000	0	4,000	
524	In Service/Staff Development	12,430	0	12,430	0	12,430	
790	Other Equipment	180,081	8,130	188,211	0	188,211	
790-ROBO	Other Equipment	0	8,438	8,438	0	8,438	
	Total Central & Other Transportation	928,911	16,568	945,479	0	945,479	

Loudon County Board of Education
General Purpose School Fund 141
Fiscal Year Ending June 30, 2019

BUDGET AMENDMENTS							
General Fund 141							
3/18/2019 13:42							
Account Number		2018-2019	2018-2019	Approved	Proposed	Proposed	
		Original Budget	Amendments	Amended Budget	Amendments	Amended Budget	
72310	Board of Education						
191	Board and Committee Members Fees	40,300	0	40,300	0	40,300	
201	Social Security	2,499	0	2,499	0	2,499	
204	State Retirement	1,800	0	1,800	0	1,800	
206	Life Insurance	1,480	0	1,480	0	1,480	
208	Dental Insurance	2,085	0	2,085	0	2,085	
212	Employer Medicare	585	0	585	0	585	
305	Audit Services	12,000	0	12,000	0	12,000	
331	Legal Services	15,000	15,000	30,000	0	30,000	
355	Travel	8,000	0	8,000	0	8,000	
506	Liability Insurance	28,578	0	28,578	0	28,578	
508	Premium on Corporate Surety Bonds	200	0	200	0	200	
509	Refunds	0	8,720	8,720	0	8,720	
510	Trustee's Commission	300,000	0	300,000	0	300,000	
513	Workman's Compensation Insurance	208,940	(5,444)	203,496	0	203,496	
524	In Service/Staff Development	25,000	0	25,000	0	25,000	
533-READSUM	Criminal Investigation of Applicants - TBI - READSUM	0	0	0	200	200	
599	Other Charges	0	0	0	0	0	
	Total Board of Education	646,467	18,276	664,743	200	664,943	

LCBOE:
READ Summer Grant
expenses.

Loudon County Board of Education
General Purpose School Fund 141
Fiscal Year Ending June 30, 2019

BUDGET AMENDMENTS						
General Fund 141						
Account Number	3/18/2019 13:42	2018-2019	2018-2019	Approved	Proposed	Proposed
		Original Budget	Amendments	Amended Budget	Amendments	Amended Budget
72320	<i>Office of the Superintendent</i>					
101	County Official/Administrative Office	134,763	0	134,763	0	134,763
117	Career Ladder Program	1,000	0	1,000	0	1,000
161	Secretary (s)	45,232	0	45,232	0	45,232
189	Other Salaries & Wages	7,200	0	7,200	0	7,200
201	Social Security	11,669	0	11,669	0	11,669
204	State Retirement	19,346	0	19,346	0	19,346
205-RET-VIS	Employee and Dependent Insurance	102	0	102	0	102
206	Life Insurance	500	0	500	0	500
206-RET-LIF	Life Insurance	120	0	120	0	120
207	Medical Insurance	19,510	0	19,510	0	19,510
208	Dental Insurance	1,050	0	1,050	0	1,050
208-REF-DEN	Dental Insurance	435	0	435	0	435
212	Employer Medicare	2,729	0	2,729	0	2,729
302	Advertising	1,000	0	1,000	0	1,000
307	Communication	50,000	0	50,000	0	50,000
320	Dues & Memberships	14,000	0	14,000	0	14,000
348	Postal Charges	2,500	0	2,500	0	2,500
355	Travel	500	0	500	0	500
399	Other Contracted Services	45,000	0	45,000	0	45,000
435	Office Supplies	8,000	0	8,000	0	8,000
524	In Service/Staff Development	7,300	0	7,300	0	7,300
599	Other Charges	3,500	0	3,500	0	3,500
	Total Office of the Superintendent	375,456	0	375,456	0	375,456

Loudon County Board of Education
General Purpose School Fund 141
Fiscal Year Ending June 30, 2019

BUDGET AMENDMENTS						
General Fund 141						
Account Number	3/18/2019 13:42	2018-2019	2018-2019	Approved	Proposed	Proposed
		Original Budget	Amendments	Amended Budget	Amendments	Amended Budget
72410	<i>Office of the Principal</i>					
104	Principals	809,718	0	809,718	0	809,718
117	Career Ladder Program	6,000	0	6,000	0	6,000
201	Social Security	50,448	0	50,448	0	50,448
204	State Retirement	85,104	0	85,104	0	85,104
205-RET-VIS	Employee and Dependent Insurance	182	0	182	0	182
206	Life Insurance	1,693	0	1,693	0	1,693
206-RET-LIF	Life Insurance	2,000	0	2,000	0	2,000
207	Medical Insurance	87,800	0	87,800	0	87,800
207-RET-MED	Medical Insurance	4,350	0	4,350	0	4,350
208	Dental Insurance	3,600	0	3,600	0	3,600
208-REF-DEN	Dental Insurance	3,400	0	3,400	0	3,400
212	Employer Medicare	11,799	0	11,799	0	11,799
307	Communication	101,000	0	101,000	0	101,000
348	Postage	5,000	0	5,000	0	5,000
355	Travel	10,000	0	10,000	0	10,000
524	In Service/Staff Development	3,000	0	3,000	0	3,000
599-MUSIC	Other Charges	0	8,000	8,000	0	8,000
790-MUSIC	Other Equipment	0	47,000	47,000	0	47,000
	Total Office of the Principal	1,185,094	55,000	1,240,094	0	1,240,094
72510	<i>Fiscal Services</i>					
119	Accountants/Bookkeepers	66,774	0	66,774	0	66,774
201	Social Security	4,140	0	4,140	0	4,140
204	State Retirement	6,477	0	6,477	0	6,477
206	Life Insurance	184	0	184	0	184
206-RET-LIF	Life Insurance	86	0	86	0	86
207	Medical Insurance	8,014	0	8,014	0	8,014
208	Dental Insurance	347	0	347	0	347
212	Employer Medicare	969	0	969	0	969
355	Travel	500	0	500	0	500
524	In Service/Staff Development	1,500	0	1,500	0	1,500
	Total Fiscal Services	88,991	0	88,991	0	88,991

Loudon County Board of Education
General Purpose School Fund 141
Fiscal Year Ending June 30, 2019

BUDGET AMENDMENTS						
General Fund 141						
Account Number	3/18/2019 13:42	2018-2019	2018-2019	Approved	Proposed	Proposed
		Original Budget	Amendments	Amended Budget	Amendments	Amended Budget
72610	Operation of Plant					
166	Custodial Personnel	34,166	0	34,166	49,120	83,286
201	Social Security	2,119	0	2,119	3,046	5,165
204	State Retirement	3,314	0	3,314	4,775	8,089
205-RET-VIS	Employee and Dependent Insurance	275	0	275	0	275
206	Life Insurance	180	0	180	352	532
206-RET-LIF	Life Insurance	840	0	840	0	840
207	Medical Insurance	7,360	0	7,360	20,901	28,261
208	Dental Insurance	350	0	350	900	1,250
208-RET-DEN	Dental Insurance	2,102	0	2,102	0	2,102
212	Employer Medicare	496	0	496	713	1,209
399	Other Contracted Services	1,295,000	0	1,295,000	(63,000)	1,232,000
399-FLM	Other Contracted Services- Fort Loudoun Middle School	2,500	0	2,500	0	2,500
399-GBS	Other Contracted Services - Greenback School	12,500	0	12,500	0	12,500
399-LHS	Other Contracted Services - Loudon High School	10,000	0	10,000	0	10,000
399-NMS	Other Contracted Services - North Middle School	2,500	0	2,500	0	2,500
399-PES	Other Contracted Services - Philadelphia Elementary Scho	2,500	0	2,500	0	2,500
415	Electricity	1,130,000	0	1,130,000	0	1,130,000
425	Gasoline	1,000	0	1,000	0	1,000
434	Natural Gas	120,000	0	120,000	0	120,000
454	Water and Sewer	133,211	0	133,211	0	133,211
502	Building and Contents Insurance	341,428	5,444	346,872	502	347,374
	Total Operation of Plant	3,101,841	5,444	3,107,285	17,309	3,124,594

LCBOE:
Moved to Custodial
salaries & benefits.
\$16,807 coming
from fund balance.

LCBOE:
Building & Contents
Insurance for NMS
Arts Building.

Loudon County Board of Education
General Purpose School Fund 141
Fiscal Year Ending June 30, 2019

BUDGET AMENDMENTS						
General Fund 141						
3/18/2019 13:42						
Account Number		2018-2019	2018-2019	Approved	Proposed	Proposed
		Original Budget	Amendments	Amended Budget	Amendments	Amended Budget
72620	<u>Maintenance of Plant</u>					
335	Maintenance and Repair Services-Building	250,000	0	250,000	0	250,000
335-INS	Maintenance and Repair Services-Building	0	900,607	900,607	0	900,607
335-PES	Maintenance and Repair Services-Building	0	7,000	7,000	0	7,000
335-STORM	Maintenance and Repair Services-Building	0	0	0	0	0
335-TNRMT	Maintenance and Repair Services-Building	0	100,766	100,766	1,134	101,900
	Total Maintenance of Plant	250,000	1,008,373	1,258,373	1,134	1,259,507
72710	<u>Transportation</u>					
105	Supervisor/Director	55,785	0	55,785	0	55,785
201	Social Security	3,459	0	3,459	0	3,459
204	State Retirement	5,412	0	5,412	0	5,412
206	Life Insurance	187	0	187	0	187
207	Medical Insurance	12,804	0	12,804	0	12,804
208	Dental Insurance	364	0	364	0	364
212	Employer Medicare	809	0	809	0	809
313	Contracts with Parents	9,070	6,000	15,070	0	15,070
315	Contracts with Vehicle Owners	1,758,320	0	1,758,320	0	1,758,320
327	Freight Expenses	100	0	100	0	100
336	Maintenance and Repair Services - Equipment	6,243	0	6,243	(1,500)	4,743
340	Medical and Dental Services	3,000	0	3,000	0	3,000
348	Postal Charges	100	0	100	0	100
355	Travel	1,750	0	1,750	0	1,750
399	Other Contracted Services	3,200	0	3,200	0	3,200
435	Office Supplies	2,000	0	2,000	0	2,000
524	In-Service/Staff Development	5,000	0	5,000	0	5,000
599	Other Charges	5,985	0	5,985	0	5,985
790	Other Equipment	4,000	0	4,000	1,500	5,500
	Total Transportation	1,877,588	6,000	1,883,588	0	1,883,588
	Total Support Services	12,775,793	1,299,944	14,075,737	30,402	14,106,139
Total Education		39,653,794	1,488,235	41,142,029	60,070	41,202,099
73000	<u>Operation of Non-Instructional Service</u>					
73100	<u>Food Service</u>					
422-READSUM	Food Supplies - READSUM	0	0	0	1,206	1,206
	Total Food Service	0	0	0	1,206	1,206

LCBOE:
GBS scoreboard
insurance claim.

LCBOE:
Moving funds to
equipment for cameras

LCBOE:
READ Summer
Grant expenses.

Loudon County Board of Education
General Purpose School Fund 141
Fiscal Year Ending June 30, 2019

BUDGET AMENDMENTS						
General Fund 141						
Account Number	3/18/2019 13:42	2018-2019	2018-2019	Approved	Proposed	Proposed
		Original Budget	Amendments	Amended Budget	Amendments	Amended Budget
73300	<i>Community Services</i>					
105-CCLC	Supervisor/Director - CCLC Grant	0	11,444	11,444	0	11,444
105-LEAP	Supervisor/Director - LEAP Grant	13,500	4,927	18,427	0	18,427
116-CCLC	Teachers - CCLC Grant	0	140,000	140,000	0	140,000
116-LEAP	Teachers - LEAP Grant	150,098	49,902	200,000	0	200,000
163-CCLC	Educational Assistants - CCLC Grant	0	8,000	8,000	0	8,000
163-LEAP	Educational Assistants - LEAPS Grant	17,788	11,712	29,500	0	29,500
189-FRC	Other Salaries & Wages - FRC Grant	25,192	0	25,192	0	25,192
201-CCLC	Social Security - CCLC Grant	0	9,886	9,886	0	9,886
201-FRC	Social Security - FRC Grant	1,561	0	1,561	0	1,561
201-LEAP	Social Security - LEAPS Grant	11,246	4,125	15,371	0	15,371
204-CCLC	State Retirement - CCLC	0	15,421	15,421	0	15,421
204-FRC	State Retirement - FRC	2,492	0	2,492	0	2,492
204-LEAP	State Retirement - LEAPS Grant	15,300	8,484	23,784	0	23,784
204-READ	State Retirement - READ Grant	0	0	0	0	0
206	Life Insurance	188	0	188	0	188
206-RET-LIF	Life Insurance	216	0	216	0	216
207	Medical Insurance	7,370	0	7,370	0	7,370
208	Dental Insurance	866	0	866	0	866
208-RET-DEN	Dental Insurance	1,011	0	1,011	0	1,011
212-CCLC	Employer Medicare - CCLC	0	2,312	2,312	0	2,312
212-FRC	Employer Medicare - FRC	366	0	366	0	366
212-LEAP	Employer Medicare - LEAPS Grant	2,630	965	3,595	0	3,595
355	Travel	1,500	0	1,500	0	1,500
355-CCLC	Travel - CCLC	0	50	50	0	50
355-LEAP	Travel - LEAPS Grant	400	600	1,000	0	1,000
399-CCLC	Other Contracted Services - CCLC Grant	0	0	0	0	0
399-LEAP	Other Contracted Services - LEAPS Grant	5,831	(1,831)	4,000	0	4,000
422	Food Supplies	5,000	0	5,000	0	5,000
422-CCLC	Food Supplies - CCLC	0	0	0	0	0
422-LEAP	Food Supplies - LEAPS Grant	0	0	0	0	0
422-WSF	Food Supplies - WSF	0	6,800	6,800	0	6,800

Loudon County Board of Education
General Purpose School Fund 141
Fiscal Year Ending June 30, 2019

BUDGET AMENDMENTS								
General Fund 141								
Account Number	3/18/2019 13:42	2018-2019	2018-2019	Approved	Proposed	Proposed		
		Original Budget	Amendments	Amended Budget	Amendments	Amended Budget		
429-CCLC	Instructional Supplies - CCLC	0	2,500	2,500	0	2,500	Donation expenses.	
429-LEAP	Instructional Supplies - LEAP	0	2,500	2,500	0	2,500		
499	Other Supplies and Materials	4,000	0	4,000	0	4,000		
499-CCLC	Other Supplies & Materials - CCLC Grant	0	1,119	1,119	0	1,119		
499-CHR	Other Supplies & Materials - CHR	0	1,500	1,500	0	1,500	LCBOE: Family Day Grant expenses.	
499-CL	Other Supplies & Materials - CL	0	1,000	1,000	1,314	2,314		
499-FAM	Other Supplies & Materials - FAM	0	5,200	5,200	0	5,200		
499-FRC	Other Supplies & Materials - FRC	0	0	0	600	600		
499-FUEL	Other Supplies & Materials - FUEL	0	1,500	1,500	0	1,500		
499-LEAP	Other Supplies & Materials - LEAPS Grant	9,207	(1,759)	7,448	0	7,448		
499-SUP	Other Supplies & Materials - SUP	0	1,848	1,848	0	1,848		
499-WSF	Other Supplies & Materials - WSF	0	0	0	0	0		
524	In Service/Staff Development	500	0	500	0	500		
524-CCLC	In Service/Staff Development - CCLC Grant	0	0	0	0	0		
524-LEAP	In Service/Staff Development - LEAPS Grant	6,000	(2,000)	4,000	0	4,000		
599-FRC	Other Charges - FRC	0	0	0	400	400		
790	Other Equipment	2,300	0	2,300	0	2,300		
790-CCLC	Other Equipment - LEAPS Grant	0	0	0	0	0		
	Total Community Services	284,562	286,205	570,767	2,314	573,081		

Loudon County Board of Education
General Purpose School Fund 141
Fiscal Year Ending June 30, 2019

BUDGET AMENDMENTS						
General Fund 141						
Account Number	3/18/2019 13:42	2018-2019	2018-2019	Approved	Proposed	Proposed
		Original Budget	Amendments	Amended Budget	Amendments	Amended Budget
73400	<u>Early Childhood Education</u>					
116	Teachers	375,691	(9,691)	366,000	0	366,000
163	Educational Assistants	147,333	9,667	157,000	0	157,000
195	Certified Substitute Teachers	1,000	0	1,000	0	1,000
198	Non-Certified Substitute Teachers	6,000	0	6,000	0	6,000
201	Social Security	32,862	0	32,862	0	32,862
204	State Retirement	47,299	4,613	51,912	0	51,912
206	Life Insurance	2,655	(260)	2,395	0	2,395
206-RET-LIF	Life Insurance	652	0	652	0	652
207	Medical Insurance	89,181	3,484	92,665	0	92,665
207-RET-MED	Medical Insurance	1,950	0	1,950	0	1,950
208	Dental Insurance	4,071	429	4,500	0	4,500
208-RET-DEN	Dental Insurance	1,640	0	1,640	0	1,640
212	Employer Medicare	7,686	0	7,686	0	7,686
311-HHA	Contracts with Other School Systems	89,491	(3,929)	85,562	0	85,562
429	Instructional Supplies	4,000	(2,400)	1,600	0	1,600
499	Other Supplies & Materials	0	0	0	0	0
524	In-Service/Staff Development	6,339	(4,739)	1,600	0	1,600
599	Other Charges	420	0	420	0	420
790	Other Equipment	4,500	(4,500)	0	0	0
	Total Early Childhood Education	822,770	(7,326)	815,444	0	815,444
76000	Capital Outlay					
76100	<u>Regular Capital Outlay</u>					
706	Building Construction	0	0	0	0	0
	Total Regular Capital Outlay	0	0	0	0	0

Loudon County Board of Education
General Purpose School Fund 141
Fiscal Year Ending June 30, 2019

BUDGET AMENDMENTS						
General Fund 141						
3/18/2019 13:42						
Account Number		2018-2019	2018-2019	Approved	Proposed	Proposed
		Original Budget	Amendments	Amended Budget	Amendments	Amended Budget
80000	Debt Service					
82130	Principal					
601	Principal On Bonds	0	0	0	0	0
602	Principal on Notes	0	0	0	0	0
		0	0	0	0	0
82300	Other Debt Service					
82330	Education					
699	Other Debt Service	0	0	0	0	0
	Total Education Debt Service	0	0	0	0	0
80000	Total Education Debt Service	0	0	0	0	0
90000	Capital Projects					
99000	Other Uses					
99100	Transfer out					
590	Transfer to other funds	0	0	0	0	0
	Total Expenditures	40,761,126	1,767,114	42,528,240	63,590	42,591,830
	Total Other Uses	0	0	0	0	0
Total General Purpose School		40,761,126	1,767,114	42,528,240	63,590	42,591,830
Beginning Fund Balance (Unaudited)		5,949,242	0	5,949,242	0	5,949,242
Total Revenue		37,623,102	1,688,367	39,311,469	63,590	39,375,059
Total Available Funds		43,572,344	1,688,367	45,260,711	63,590	45,324,301
Total Expenditures		40,761,126	1,767,114	42,528,240	63,590	42,591,830
Estimated Ending Fund Balance		2,811,218	(78,747)	2,732,471	0	2,732,471
* \$300,000 was transferred to sub fund 999 of fund 142 that can be pulled back for regular fund balance purposes at any time.						

Loudon County Board of Education
School Federal Projects Fund 142
Fiscal Year Ending June 30, 2019

	A	B	C	D	E	F	G	H	I
1			Federal Fund 142						
2			3/18/2019 13:44	2018-2019	2018-2019	Approved	Proposed	Proposed	
3	Account Number			Org Bgt	Amds	Amded Bgt	Amds	Amded Budget	
4									
655									
656									
657	Sub Fund		909 - IDEA B Revenue						
658									
659	47000		Federal Government						
660									
661	47100		Federal Through State						
662		47143	Special Education Grants to States	995,605.00	512.00	996,117.00	(1,762.00)	994	LCBOE: New allocation.
663									
664	47143-CAR18		Special Education Grants to States	0.00	105,077.91	105,077.91	0.00	105	
665									
666			Total Federal Through State	995,605.00	105,589.91	1,101,194.91	(1,762.00)	1,099,432.91	
667									
668			Total Federal Government	995,605.00	512.00	996,117.00	(1,762.00)	994,355.00	
669									
670			Total Revenue	995,605.00	105,589.91	1,101,194.91	(1,762.00)	1,099,432.91	
671									
672			Total Other Sources	0.00	0.00	0.00	0.00	0.00	
673									
674			Total IDEA B Revenue	995,605.00	105,589.91	1,101,194.91	(1,762.00)	1,099,432.91	
675									
676									
677	Sub Fund		909 - IDEA B Expenses						
678									
679	70000		Education						
680									
681	71000		Instruction						
682									
683	71200		Special Education Program						
684	116		Teachers	38,865.06	0.00	38,865.06	0.00	38,865.06	
685	128		Home Bound Teachers	0.00	0.00	0.00	0.00	0.00	
686	163		Educational Assistants	378,104.82	51,895.18	430,000.00	0.00	430,000.00	
687	189		Other Salaries & Wages	1,000.00	9,000.00	10,000.00	0.00	10,000.00	
688	201		Social Security	27,117.14	2,882.86	30,000.00	0.00	30,000.00	
689	204		State Retirement	18,608.27	1,391.73	20,000.00	0.00	20,000.00	
690	206		Life Insurance	2,713.20	86.80	2,800.00	0.00	2,800.00	
691	207		Medical Insurance	150,606.11	1,393.89	152,000.00	0.00	152,000.00	
692	208		Dental Insurance	6,371.96	628.04	7,000.00	0.00	7,000.00	
693	212		Employer Medicare	6,359.15	640.85	7,000.00	0.00	7,000.00	
694	399		Other Contracted Services	0.00	0.00	0.00	0.00	0.00	
695	429		Instructional Supplies	2,000.00	15,640.65	17,640.65	(1,762.00)	15,878.65	
696	499		Other Supplies & Materials	0.00	0.00	0.00	0.00	0.00	
697									
698			Total Regular Instruction Program	631,745.71	83,560.00	715,305.71	(1,762.00)	713,543.71	
699									

Loudon County Board of Education
School Federal Projects Fund 142
Fiscal Year Ending June 30, 2019

	A	C	D	E	F	G	H	I
1		Federal Fund 142						
2	Account Number	3/18/2019 13:44	2018-2019	2018-2019	Approved	Proposed	Proposed	
3			Org Bgt	Amds	Amded Bgt	Amds	Amded Budget	
4								
745								
746	Sub Fund	919 - Preschool Revenue						
747								
748	47000	Federal Government						
749								
750	47100	<i>Federal Through State</i>						
751	47145	Special Education Preschool Grants	13,290.00	1,736.00	15,026.00	3,799.00	LCBOE: Additional Allocation.	
752								
753	47145-CAR18	Special Education Preschool Grants	0.00	7,699.40	7,699.40	0.00		
754								
755		Total Federal Through State	13,290.00	9,435.40	22,725.40	3,799.00		26,524.40
756								
757		Total Federal Government	13,290.00	9,435.40	22,725.40	3,799.00		26,524.40
758								
759		Total Revenue	13,290.00	9,435.40	22,725.40	3,799.00		26,524.40
760								
761		Total Other Sources	0.00	0.00	0.00	0.00		0.00
762								
763		Total Preschool Revenue	13,290.00	9,435.40	22,725.40	3,799.00		26,524.40
764								
765								
766	Sub Fund	919 - Preschool Expenses						
767								
768	70000	Education						
769								
770	71000	Instruction						
771								
772	71200	<i>Special Education Program</i>						
773	399	Other Contracted Services	0.00	0.00	0.00	0.00		0.00
774	429	Instructional Supplies	5,000.00	0.00	5,000.00	3,799.00		8,799.00
775								
776	72220	<i>Special Education Program</i>						
777	399	Other Contracted Services	8,290.00	9,435.40	17,725.40	0.00		17,725.40
778								
779		Total Expenditures Preschool	13,290.00	9,435.40	22,725.40	3,799.00		26,524.40
780								
781		Beginning Fund Balance	0.00	0.00	0.00	0.00		0.00
782								
783		Revenues	13,290.00	9,435.40	22,725.40	3,799.00		26,524.40
784								
785		Expenditures	13,290.00	9,435.40	22,725.40	3,799.00		26,524.40
786								
787		Ending Fund Balance	0.00	0.00	0.00	0.00		0.00
788								

Loudon County Board of Education
School Federal Projects Fund 142
Fiscal Year Ending June 30, 2019

1	A	B	C	D	E	F	G	H	I
2			Federal Fund 142						
3	Account Number		3/18/2019 13:44	2018-2019	2018-2019	Approved	Proposed	Proposed	
4				Org Bgt	Amds	Amded Bgt	Amds	Amded Budget	
700	Sub Fund		909 - IDEA B						
701									
702	70000		Education						
703									
704	72000		Support Services						
705									
706	72220		<i>Special Education Program</i>						
707	1051		Supervisor/Director	67,907.00	0.00	67,907.00	0.00	67,907.00	
708	161		Secretary	81,560.00	0.00	81,560.00	0.00	81,560.00	
709	189		Other Salaries & Wages	64,060.00	(64,060.00)	0.00	0.00	0.00	
710	201		Social Security	12,238.78	(1,000.00)	12,238.78	0.00	12,238.78	
711	204		State Retirement	21,795.23	(1,000.00)	20,795.23	0.00	20,795.23	
712	206		Life Insurance	638.40	0.00	638.40	0.00	638.40	
713	207		Medical Insurance	22,295.84	0.00	22,295.84	0.00	22,295.84	
714	208		Dental Insurance	1,124.64	0.00	1,124.64	0.00	1,124.64	
715	212		Employer Medicare	3,096.14	0.00	3,096.14	0.00	3,096.14	
716	355		Travel	5,000.00	0.00	5,000.00	0.00	5,000.00	
717	399		Other Contracted Services	50,000.00	88,089.91	138,089.91	(7,000.00)	131,089.91	
718	524		In-Service/Staff Development	33,143.26	0.00	33,143.26	7,000.00	40,143.26	
719									
720			Total Special Education Program	363,859.29	22,029.91	385,889.20	0.00	385,889.20	
721									
722	Sub Fund		909 - IDEA B						
723									
724	70000		Education						
725									
726	72000		Support Services						
727									
728	72710		<i>Transportation</i>						
729	313		Contracts with Parents	0.00	0.00	0.00	0.00	0.00	
730	315		Contracts with Vehicle Owners	0.00	0.00	0.00	0.00	0.00	
731									
732			Total Transportation	0.00	0.00	0.00	0.00	0.00	
733									
734									
735			Total Expenditures 909	995,605.00	105,589.91	1,101,194.91	(1,762.00)	1,099,432.91	
736									
737			Beginning Fund Balance	0.00	0.00	0.00	0.00	0.00	
738									
739			Revenues	995,605.00	105,589.91	1,101,194.91	(1,762.00)	1,099,432.91	
740									
741			Expenditures	995,605.00	105,589.91	1,101,194.91	(1,762.00)	1,099,432.91	
742									
743			Ending Fund Balance	0.00	0.00	0.00	0.00	0.00	
744									

Loudon County Board of Education
School Federal Projects Fund 142
Fiscal Year Ending June 30, 2019

1	A	B	C	D	E	F	G	H	I
2	Account Number		Federal Fund 142	2018-2019	2018-2019	Approved	Proposed	Proposed	
3			3/18/2019 13:44	Org Bgt	Amds	Amded Bgt	Amds	Amded Budget	
4									
789									
790	Sub Fund		999 - RESTRICTED FOR CASH FLOW						
791									
792									
793									
794	49000		Other Revenue Sources						
795		49800	Transfers In	0.00	0.00	0.00	0.00	0.00	
796									
797			Total Other Revenue	0.00	0.00	0.00	0.00	0.00	
798									
799									
800			Total Revenue	0.00	0.00	0.00	0.00	0.00	
801									
802									
803			Total RESTRICTED FOR CASH FLOW	0.00	0.00	0.00	0.00	0.00	
804									
805									
806									
807									
808									
809									
810			Fund 142 Total Beginning Fund Balance	0.00	0.00	0.00	0.00	0.00	
811									
812			Fund 142 Total Expenditures	2,146,799.93	427,559.32	2,574,359.25	2,037.00	2,576,396.25	
813									
814			Fund 142 Total Revenues	2,146,799.93	427,559.32	2,574,359.25	2,037.00	2,576,396.25 *	
815									
816			Fund 142 Total Ending Fund Balance	0.00	0.00	0.00	0.00	0.00	
817									
818			* \$300,000 in sub fund 999 was transferred from Fund 141 fund balance and can be transferred back to Fund 141 fund balance at any time.						
819									
820									

LOUDON COUNTY COMMISSION
EXHIBIT 030419-U

LOUDON COUNTY CLERK
CARRIE MCKELVEY, COUNTY CLERK
101 MULBERRY ST., SUITE 200
LOUDON, TN 37774
TELEPHONE: 865-458-3314
FAX: 865-458-9891

Notaries & Bonds to be elected April 01, 2019

Yvette K. Arnold

Deborah Lynn Miller

Allison Cooper

Loree Sledge

Teresa J. Everett

Betty Lou Steele

Kathy E. Finger

Joanna R. Tuck

Malia D. Hodge

Angela F. Wildermuth

Margie W. Kirkland

LOUDON COUNTY COMMISSION
EXHIBIT 040119-V



SURETY'S BOND NO. 69871793 STATE OF TENNESSEE
COUNTY OF Loudon
OFFICIAL STATUTORY BOND
FOR
COUNTY PUBLIC OFFICIALS
OFFICE OF Budget Director

KNOW ALL MEN BY THESE PRESENTS:

That Tracy Blair
of Loudon (City or Town), County of Loudon
Tennessee, as Principal, and WESTERN SURETY COMPANY

as Surety, are held and firmly bound unto THE STATE OF TENNESSEE in the full amount of
One Hundred Thousand and 00/100 Dollars (\$100,000.00)
lawful money of the United States of America for the full and prompt payment whereof we bind ourselves, our representatives,
successors and assigns, each jointly and severally, firmly and unequivocally by these presents.

WHEREAS, The said Principal was duly _____ elected X appointed to the office of Budget Director

of and for Loudon County for the 1 year term beginning on the 9th day of
March, 2019 and ending on the 9th day of March, 2020

NOW, THEREFORE, THE CONDITION OF THIS OBLIGATION IS SUCH:

That if the said Tracy Blair, Principal, shall:

1. Faithfully perform the duties of the office of Budget Director of Loudon County during such person's term of office or his continuance therein; and,
2. Pay over to the persons authorized by law to receive them, all moneys, properties, or things of value that may come into such Principal's hands during such Principal's term of office or continuance therein without fraud or delay, and shall faithfully and safely keep all records required in such Principal's official capacity, and at the expiration of the term, or in case of resignation or removal from office, shall turn over to the successor all records and property which have come into such Principal's hands, then the obligation shall be null and void; otherwise to remain in full force and effect.

WITNESS our hands and seals this 17th day of December, 2018

WITNESS — ATTEST

PRINCIPAL:

Tracy Blair

SURETY: WESTERN SURETY COMPANY

by: Paul T. Brufat
Paul T. Brufat, Vice President

COUNTERSIGNED BY:

NOT NEEDED

Tennessee Resident Agent

(Attach evidence of authority to execute bond)

ACKNOWLEDGEMENT OF PRINCIPAL

STATE OF TENNESSEE
COUNTY OF Loudon

Before me, a Notary Public, of the State and County aforesaid, personally appeared _____,
to me known (or proved to me on the basis of satisfactory evidence) to be the individual described in the foregoing bond as
Principal, and who, upon oath acknowledged that such individual executed the foregoing bond as such individual's free act and
deed.

WITNESS my hand and seal this 4 day of MARCH

My Commission Expires:

JUL 6, 2019

Notary Public

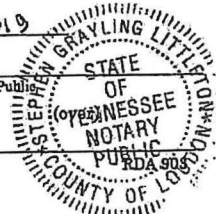

ACKNOWLEDGEMENT OF SURETY

STATE OF South Dakota
COUNTY OF Minnehaha

Before me, a Notary Public, of the State and County aforesaid, personally appeared Paul T. Bruflat with whom I am personally acquainted and, who, upon oath, acknowledged himself/herself to be the individual who executed the foregoing bond on behalf of WESTERN SURETY COMPANY, the within named Surety, a corporation duly licensed to do business in the State of Tennessee, and that he/she as such individual being authorized so to do, executed the foregoing bond on behalf of the Surety, by signing the name of the corporation by himself/herself as such individual.

WITNESS my hand and seal this 17th day of December, 2018

My Commission Expires:

March 2, 2020

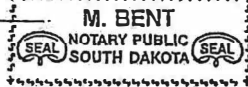

M. Bent
Notary Public

APPROVAL AND CERTIFICATION

SECTION I. (Applicable to all County Officials except Clerks of all Courts)

Bond and Sureties approved by ROSEN "BUDDY" BRADSHAW, County Executive/Mayor
of LONDON County, on this 4 day of MARCH, 2019

Signed:

Buddy Bradshaw
County Executive/Mayor

CERTIFICATION:

I, Carrie McKelvey, County Clerk of LONDON County,
hereby certify that the foregoing bond was approved by the Legislative Body of said county, in open session on the
day of _____, and entered upon the minutes thereof.

Signed:

Carrie McKelvey
County Clerk

SECTION II. (Applicable to all Clerks of all Courts)

CERTIFICATION:

This is to certify that I have examined the foregoing bond and found the same to be sufficient and in conformity to law, that the sureties on the same are good and worth the penalty thereof and that the same has been entered upon the minutes of said court.

Signed:

Judge of the _____ Court of and for said County on
this _____ day of _____.

SECTION III. (Applicable to all County Officials' Bonds)
FOR USE BY REGISTER OF DEEDS

SECTION IV. (Applicable to all County Officials' Bonds)

ENDORSEMENT:

Filed with the Office of the County Clerk, County of _____, this _____ day of _____.

Signed:

County Clerk

Form Prescribed by the Comptroller of the Treasury, State of Tennessee
Form Approved by the Attorney General, State of Tennessee

WESTERN SURETY COMPANY
101 S. Reid St., Ste. 300
Sioux Falls, SD 57103-7046
605-336-0850

Western Surety Company

POWER OF ATTORNEY

KNOW ALL MEN BY THESE PRESENTS:

That WESTERN SURETY COMPANY, a corporation organized and existing under the laws of the State of South Dakota, and authorized and licensed to do business in the States of Alabama, Alaska, Arizona, Arkansas, California, Colorado, Connecticut, Delaware, District of Columbia, Florida, Georgia, Hawaii, Idaho, Illinois, Indiana, Iowa, Kansas, Kentucky, Louisiana, Maine, Maryland, Massachusetts, Michigan, Minnesota, Mississippi, Missouri, Montana, Nebraska, Nevada, New Hampshire, New Jersey, New Mexico, New York, North Carolina, North Dakota, Ohio, Oklahoma, Oregon, Pennsylvania, Rhode Island, South Carolina, South Dakota, Tennessee, Texas, Utah, Vermont, Virginia, Washington, West Virginia, Wisconsin, Wyoming, and the United States of America, does hereby make, constitute and appoint

Paul T. Bruflat of Sioux Falls
State of South Dakota, its regularly elected Vice President
as Attorney-in-Fact, with full power and authority hereby conferred upon him to sign, execute, acknowledge and deliver for and on its behalf as Surety and as its act and deed, the following bond:

One Budget Director County of Loudon

bond with bond number 69871793

for Tracy Blair

as Principal in the penalty amount not to exceed: \$100,000.00

Western Surety Company further certifies that the following is a true and exact copy of Section 7 of the by-laws of Western Surety Company duly adopted and now in force, to-wit:

Section 7. All bonds, policies, undertakings, Powers of Attorney, or other obligations of the corporation shall be executed in the corporate name of the Company by the President, Secretary, any Assistant Secretary, Treasurer, or any Vice President, or by such other officers as the Board of Directors may authorize. The President, any Vice President, Secretary, any Assistant Secretary, or the Treasurer may appoint Attorneys-in-Fact or agents who shall have authority to issue bonds, policies, or undertakings in the name of the Company. The corporate seal is not necessary for the validity of any bonds, policies, undertakings, Powers of Attorney or other obligations of the corporation. The signature of any such officer and the corporate seal may be printed by facsimile.

In Witness Whereof, the said WESTERN SURETY COMPANY has caused these presents to be executed by its Vice President with the corporate seal affixed this 17th day of December, 2018

ATTEST

J. Nelson
J. Nelson, Assistant Secretary

WESTERN SURETY COMPANY
By Paul T. Bruflat
Paul T. Bruflat, Vice President



STATE OF SOUTH DAKOTA }
COUNTY OF MINNEHAHA } ss

On this 17th day of December, 2018, before me, a Notary Public, personally appeared Paul T. Bruflat and J. Nelson who, being by me duly sworn, acknowledged that they signed the above Power of Attorney as Vice President and Assistant Secretary, respectively, of the said WESTERN SURETY COMPANY, and acknowledged said instrument to be the voluntary act and deed of said Corporation.

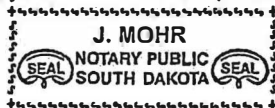

My Commission Expires June 23, 2021

J. Mohr
Notary Public

